

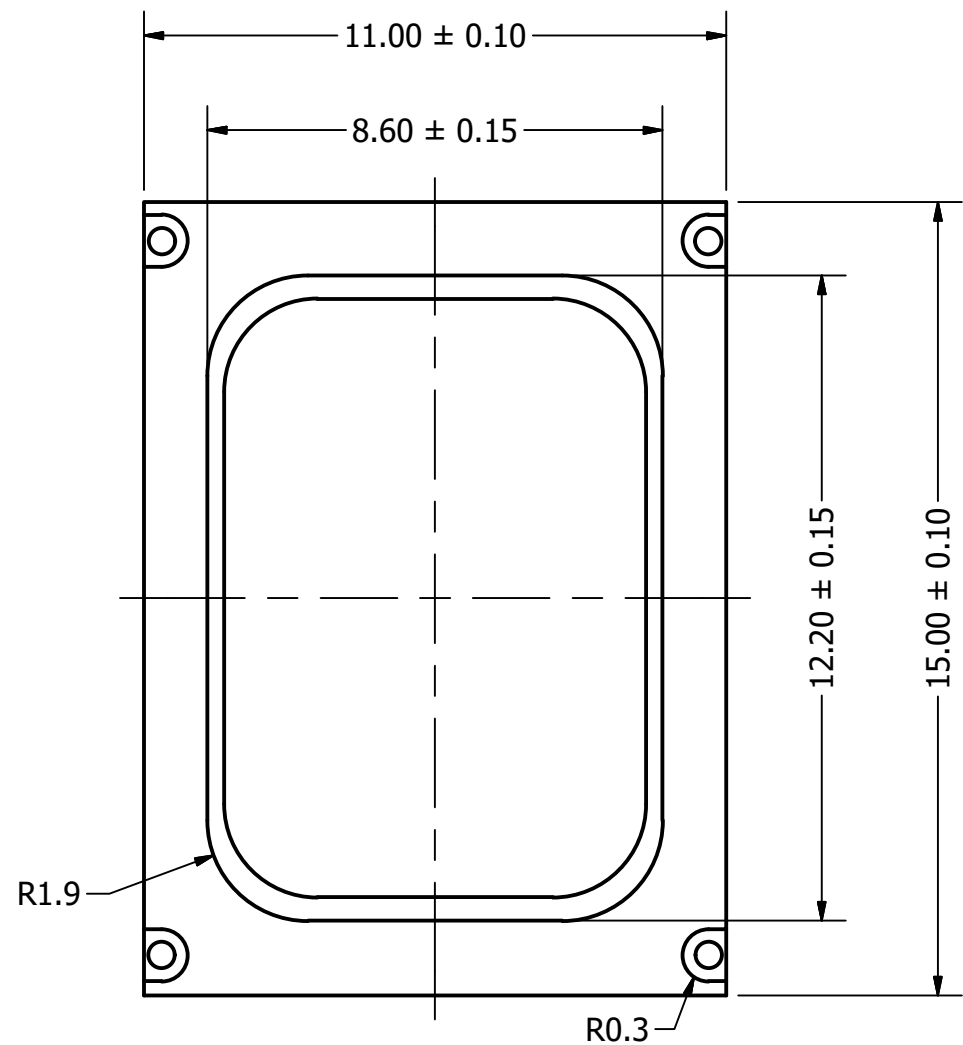

DB UNLIMITED

Part Number:	DRAWN	10/8/2015
	CJ	
	CHECKED	10/8/2015
Description:	P.D	10/8/2015
	APPROVED	10/8/2015
J.S		
This document contains data proprietary to DB Unlimited. Any use or reproduction, in any form, without prior written permission of DB Unlimited is prohibited. All terms and conditions can be found at www.dbunlimitedco.com		

Top View



Side View

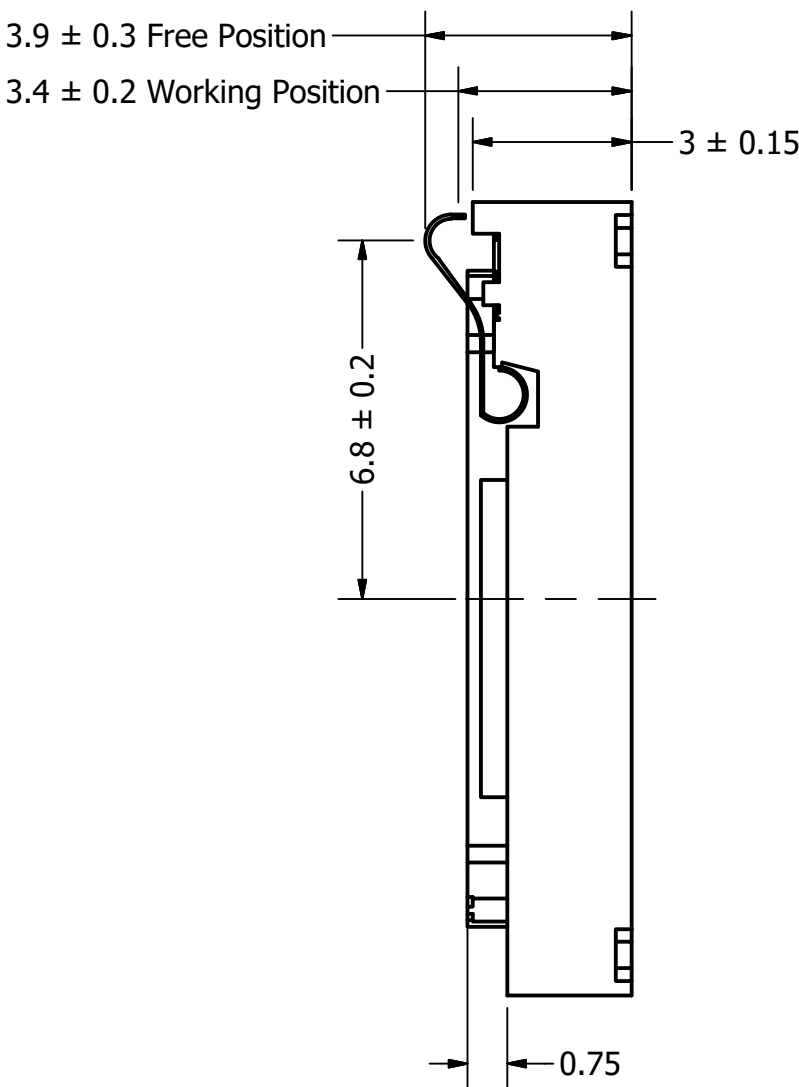

Bottom View

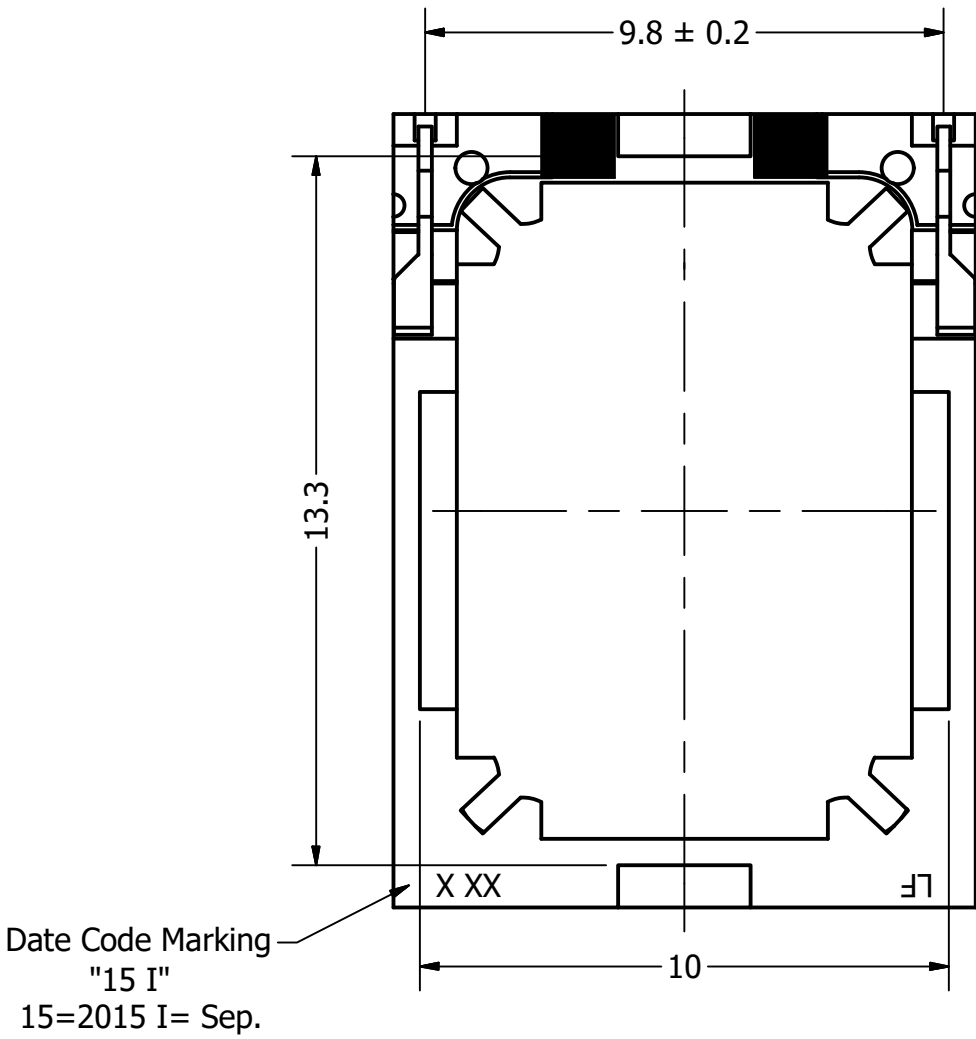

Items	Specifications	Conditions	REVISION HISTORY			
Sound Pressure Level	92	± 3 dB (@ 10cm)	REV	DESCRIPTION	DATE	APPROVED
Resonant Frequency	500	± 20% Hz	1	Released from Engineering	10/8/2015	J.S.
Frequency Range	500 ~ 10,000	Hz	2	Relocated Date Code Markings	1/11/2016	J.S.
Nominal Power	0.7	W	3	Switched top view and bottom view	5/9/2017	C.E.
Max. Power	1	W	4	Update Operating Temp	3/15/2018	C.E.
Impedance	6	± 30% Ω		Update Operating Temp	3/22/2018	C.E.
Cone Material	Mylar		NOTES			
Mount Type	Flush Mount		1) All dimensions are in mm unless otherwise noted			
Storage Temperature	-40 ~ +85	°C	2) All tolerances are ± 0.5 mm unless otherwise noted			
Operating Temperature	-40 ~ +85	°C	3) All parts meet RoHS			
Weight	1.6	g	4) Subject to change or redrawn without notice			

Mouser Electronics

Authorized Distributor

Click to View Pricing, Inventory, Delivery & Lifecycle Information:

[DB Unlimited:](#)

[SM150506-3](#)