

CTLZ3V9 THRU CTLZ8V2

SURFACE MOUNT SILICON ZENER DIODES

TLPTM
Tiny
Leadless
Package



Top View Bottom View

TLM2D3D6 CASE

FEATURES:

- Ultra small, ultra low profile
0.3mm x 0.6mm x 0.3mm TLPTM leadless
surface mount package.

MAXIMUM RATINGS: (T_A=25°C)

Power Dissipation

Operating and Storage Junction Temperature

SYMBOL

P_D

T_J, T_{stg}

100

-55 to +150

UNITS

mW

°C

ELECTRICAL CHARACTERISTICS: (T_A=25°C) V_F=0.9V MAX @ I_F=10mA (for all types)

TYPE	ZENER VOLTAGE			TEST CURRENT I _{ZT} mA	MAXIMUM REVERSE LEAKAGE CURRENT		MARKING CODE
	V _Z @ I _{ZT}				I _R	@ V _R	
	MIN V	NOM V	MAX V		μA	V	
CTLZ3V9	3.74	3.9	4.16	5.0	5.0	1.0	F
CTLZ4V7	4.42	4.7	4.90	5.0	2.0	1.0	H
CTLZ5V1	4.84	5.1	5.37	5.0	2.0	1.5	K
CTLZ5V6	5.31	5.6	5.92	5.0	1.0	2.5	L
CTLZ6V2	5.86	6.2	6.53	5.0	1.0	3.0	N
CTLZ6V8	6.47	6.8	7.14	5.0	0.5	3.5	P
CTLZ7V5	7.06	7.5	7.84	5.0	0.5	4.0	T
CTLZ8V2	7.76	8.2	8.64	5.0	0.5	5.0	U



www.centrasemi.com

DESCRIPTION:

The CENTRAL SEMICONDUCTOR CTLZ3V9 thru CTLZ8V2 silicon Zener diodes are high quality voltage regulators, each packaged in the ultra small, ultra low profile TLM2D3D6 leadless surface mount case.

MARKING CODE: SEE MARKING CODES ON ELECTRICAL CHARACTERISTICS TABLE

APPLICATIONS:

- Reference voltage
- Voltage regulation
- Over-voltage protection
- Medical electronics
- Handheld devices such as mobile phones and MP3 players.

CTLZ3V9 THRU CTLZ8V2

SURFACE MOUNT SILICON
ZENER DIODES



TLM2D3D6 CASE - MECHANICAL OUTLINE

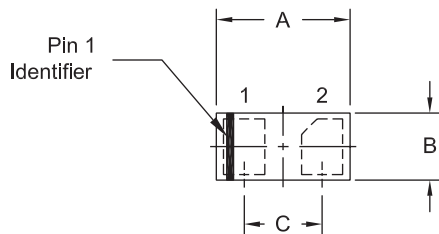

TOP VIEW

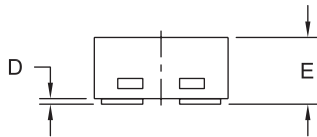

SIDE VIEW

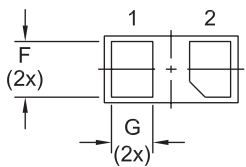

BOTTOM VIEW

R2

DIMENSIONS

SYMBOL	INCHES		MILLIMETERS	
	MIN	MAX	MIN	MAX
A	0.022	0.026	0.55	0.65
B	0.010	0.014	0.25	0.35
C	0.014		0.35	
D	0.000	0.002	0.00	0.05
E	0.011	0.013	0.28	0.32
F	0.008	0.012	0.20	0.30
G	0.005	0.009	0.13	0.24

TLM2D3D6 (REV: R2)

LEAD CODE:

- 1) Cathode
- 2) Anode

**MARKING CODE: SEE MARKING CODES ON
ELECTRICAL CHARACTERISTICS TABLE**

OUTSTANDING SUPPORT AND SUPERIOR SERVICES



PRODUCT SUPPORT

Central's operations team provides the highest level of support to insure product is delivered on-time.

- Supply management (Customer portals)
- Inventory bonding
- Consolidated shipping options
- Custom bar coding for shipments
- Custom product packing

DESIGNER SUPPORT/SERVICES

Central's applications engineering team is ready to discuss your design challenges. Just ask.

- Free quick ship samples (2nd day air)
- Online technical data and parametric search
- SPICE models
- Custom electrical curves
- Environmental regulation compliance
- Customer specific screening
- Up-screening capabilities
- Special wafer diffusions
- PbSn plating options
- Package details
- Application notes
- Application and design sample kits
- Custom product and package development

REQUESTING PRODUCT PLATING

1. If requesting Tin/Lead plated devices, add the suffix "TIN/LEAD" to the part number when ordering (example: 2N2222A TIN/LEAD).
2. If requesting Lead (Pb) Free plated devices, add the suffix "PBFREE" to the part number when ordering (example: 2N2222A PBFREE).

CONTACT US

Corporate Headquarters & Customer Support Team

Central Semiconductor Corp.
145 Adams Avenue
Hauppauge, NY 11788 USA
Main Tel: (631) 435-1110
Main Fax: (631) 435-1824
Support Team Fax: (631) 435-3388
www.centrasemi.com

Worldwide Field Representatives:
www.centrasemi.com/wwreps

Worldwide Distributors:
www.centrasemi.com/wwdistributors

For the latest version of Central Semiconductor's **LIMITATIONS AND DAMAGES DISCLAIMER**, which is part of Central's Standard Terms and Conditions of sale, visit: www.centrasemi.com/terms

Mouser Electronics

Authorized Distributor

Click to View Pricing, Inventory, Delivery & Lifecycle Information:

Central Semiconductor:

[CTLZ7V5 TR PBFREE](#) [CTLZ8V2 TR PBFREE](#) [CTLZ3V9 TR PBFREE](#) [CTLZ4V7 TR PBFREE](#) [CTLZ5V1 TR PBFREE](#) [CTLZ5V6 TR PBFREE](#) [CTLZ6V2 TR PBFREE](#)