

2N2326A

SILICON CONTROLLED RECTIFIER
1.6 AMP, 400 VOLT



TO-39 CASE



www.centralemi.com

DESCRIPTION:

The CENTRAL SEMICONDUCTOR 2N2326A is a hermetically sealed silicon controlled rectifier designed for sensing circuit applications and control systems.

MARKING: FULL PART NUMBER

MAXIMUM RATINGS: ($T_C=25^{\circ}\text{C}$ unless otherwise noted)

| | SYMBOL | | UNITS |
|---|---------------------|-------------|--------------------|
| Peak Repetitive Forward Voltage | V_{DRM} | 200 | V |
| Peak Repetitive Reverse Voltage | V_{RRM} | 200 | V |
| Non-Repetitive Peak Reverse Voltage | V_{RSM} | 300 | V |
| RMS On-State Current | $I_{\text{T(RMS)}}$ | 1.6 | A |
| Average On-State Current ($T_C=85^{\circ}\text{C}$) | $I_{\text{T(AV)}}$ | 1.0 | A |
| Peak One Cycle Surge Current ($t=8.3\text{ms}$) | I_{TSM} | 15 | A |
| Peak Gate Power Dissipation | P_{GM} | 100 | mW |
| Average Gate Power Dissipation | $P_{\text{G(AV)}}$ | 10 | mW |
| Peak Gate Current | I_{GM} | 100 | mA |
| Peak Gate Voltage | V_{GM} | 6.0 | V |
| Operating Junction Temperature | T_{J} | -65 to +125 | $^{\circ}\text{C}$ |
| Storage Temperature | T_{stg} | -65 to +150 | $^{\circ}\text{C}$ |

ELECTRICAL CHARACTERISTICS: ($T_C=25^{\circ}\text{C}$ unless otherwise noted)

| SYMBOL | TEST CONDITIONS | MIN | MAX | UNITS |
|------------------|--|-----|-----|---------------|
| I_{DRM} | $V_{\text{DRM}}=200\text{V}$, $R_{\text{GK}}=2.0\text{K}\Omega$ | | 5.0 | μA |
| I_{RRM} | $V_{\text{RRM}}=200\text{V}$, $R_{\text{GK}}=2.0\text{K}\Omega$ | | 5.0 | μA |
| I_{GT} | $V_{\text{D}}=6.0\text{V}$, $R_{\text{L}}=100\Omega$ | | 20 | μA |
| I_{H} | $V_{\text{D}}=6.0\text{V}$, $R_{\text{GK}}=2.0\text{K}\Omega$ | | 2.0 | mA |
| V_{GT} | $V_{\text{D}}=6.0\text{V}$, $R_{\text{L}}=100\Omega$ | | 0.6 | V |
| V_{TM} | $I_{\text{T}}=1.0\text{A}$, $t_{\text{p}}=380\mu\text{s}$ | | 1.5 | V |

R0 (29-June 2016)

2N2326A

SILICON CONTROLLED RECTIFIER
1.6 AMP, 400 VOLT



TO-39 CASE - MECHANICAL OUTLINE

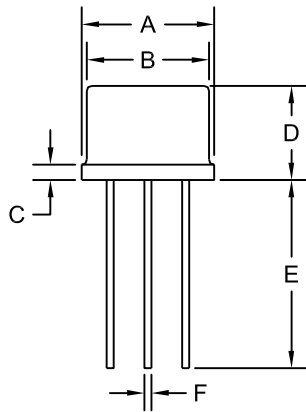

| DIMENSIONS | | | | |
|------------|--------|-------|-------------|------|
| SYMBOL | INCHES | | MILLIMETERS | |
| | MIN | MAX | MIN | MAX |
| A (DIA) | 0.335 | 0.370 | 8.51 | 9.40 |
| B (DIA) | 0.315 | 0.335 | 8.00 | 8.51 |
| C | - | 0.040 | - | 1.02 |
| D | 0.240 | 0.260 | 6.10 | 6.60 |
| E | 0.500 | - | 12.70 | - |
| F (DIA) | 0.016 | 0.021 | 0.41 | 0.53 |
| G (DIA) | 0.200 | | 5.08 | |
| H | 0.100 | | 2.54 | |
| I | 0.028 | 0.034 | 0.71 | 0.86 |
| J | 0.029 | 0.045 | 0.74 | 1.14 |

TO-39 (REV: R1)

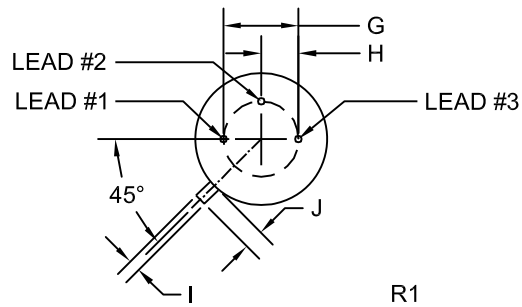

LEAD CODE:

- 1) Cathode
- 2) Gate
- 3) Anode (case)

MARKING: FULL PART NUMBER

R0 (29-June 2016)

OUTSTANDING SUPPORT AND SUPERIOR SERVICES



PRODUCT SUPPORT

Central's operations team provides the highest level of support to insure product is delivered on-time.

- Supply management (Customer portals)
- Inventory bonding
- Consolidated shipping options
- Custom bar coding for shipments
- Custom product packing

DESIGNER SUPPORT/SERVICES

Central's applications engineering team is ready to discuss your design challenges. Just ask.

- Free quick ship samples (2nd day air)
- Online technical data and parametric search
- SPICE models
- Custom electrical curves
- Environmental regulation compliance
- Customer specific screening
- Up-screening capabilities
- Special wafer diffusions
- PbSn plating options
- Package details
- Application notes
- Application and design sample kits
- Custom product and package development

REQUESTING PRODUCT PLATING

1. If requesting Tin/Lead plated devices, add the suffix " TIN/LEAD" to the part number when ordering (example: 2N2222A TIN/LEAD).
2. If requesting Lead (Pb) Free plated devices, add the suffix " PBFREE" to the part number when ordering (example: 2N2222A PBFREE).

CONTACT US

Corporate Headquarters & Customer Support Team

Central Semiconductor Corp.
145 Adams Avenue
Hauppauge, NY 11788 USA
Main Tel: (631) 435-1110
Main Fax: (631) 435-1824
Support Team Fax: (631) 435-3388
www.centrasemi.com

Worldwide Field Representatives:
www.centrasemi.com/wwreps

Worldwide Distributors:
www.centrasemi.com/wwdistributors

For the latest version of Central Semiconductor's **LIMITATIONS AND DAMAGES DISCLAIMER**, which is part of Central's Standard Terms and Conditions of sale, visit: www.centrasemi.com/terms

Mouser Electronics

Authorized Distributor

Click to View Pricing, Inventory, Delivery & Lifecycle Information:

Central Semiconductor:

[2N2326A](#) [2N2326A TIN/LEAD](#)