

AHM5 - AHK5 - AHO5 SERIES

ABSOLUTE SINGLE-TURN IO-LINK ENCODERS

Introduction

Built from a solid and reliable mechanical and electrical platform, this IO-Link Encoder series was built from the ground up for reliability and robustness. Electrical protection is built in to reduce "first installation" errors. Mechanically, the high precision sealed bearings mean long life, even in harsh conditions. The product is rated to perform from -40 to +85°C and is offered with a protection level up to IP67, making this the perfect solution in a 58mm package for heavy duty industrial use.



Features

- Absolute single-turn position with 16bits of resolution
- IO-Link COM3 with minimal cycle time of 1ms
- Easy programming with standard IO-Link tool
- Simple device replacement with Data Storage capability
- Universal power supply by IO-Link Master
- Robust and excellent resistance to shock and vibration
- High protection level IP65, IP67 option with a sealing flange
- Operating temperature range from -40°C to 85°C
- Standard M12 connector

Applications

- Factory automation
- Motor feedback
- Conveyors
- Automated warehousing
- General industrial system monitoring and feedback

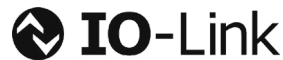

SPECIFICATIONS

Mechanical

		AHM5	AHK5	AH05
Material		Cover: Zinc Alloy Body: Aluminium Shaft: Stainless Steel		
Bearings		6000 Series	6803 Series	
Maximum Loads	Axial	50 N	20 N	
	Radial	100 N	50 N	
Shaft inertia		2,5.10 ⁻⁶ kg.m ² (10mm)	2,9.10-6 kg.m ² (14mm)	3,2.10-6 kg.m ² (14mm)
Torque		4.10 ⁻³ N.m	16.10-3 N.m	20.10 ⁻³ N.m
Permissible Max. Speed		12 000 min ⁻¹	6 000 min ⁻¹	
Continuous Max. Speed		10 000 min ⁻¹	6 000 min ⁻¹	
Encoder Weight (Approx.)		0,300 kg		
Theoretical Mechanical Lifetime 10 ⁹ turns (F _{axial} / F _{radial})		30 N / 60 N : 26	20 N / 40 N : >36	

Electrical

Ver.	Output signals	Operating Voltage	Supply Current (no loads)	Current per Channel Pair	Short Circuits Proof	Reverse Polarity Tolerant	Frequency Capability	Resolutions category	Operating Temperature Range
ZIO	IO-Link	18-30V	<75mA	<40mA	Yes	Yes	Up to IO-Link COM3 (230,4 kbits/s)	Full Programmable (1 to 16 bits)	-40°C...+85°C

Environmental

Shocks (EN 60068-2-27)	$\leq 500 \text{ m.s}^{-2}$ (during 6 ms)
Vibrations (EN 60068-2-6)	$\leq 200 \text{ m.s}^{-2}$ (10...2 000Hz)
EMC	EN 61000-6-2, EN 61000-6-4
Isolation	1 000V eff
Operating Temperature	-40 ... + 85°C (encoder T°)
Storage Temperature	-40 ... + 85°C
Protection (EN 60529)	IP 65 (IP 67 option with a sealing flange)
Humidity	98% RH non-condensing at 20 °C



IO-LINK FEATURES

Process data

- Position : single turn 16 bits max
- Speed : calculated speed in rpm (signed)

Programmable Parameters

- Resolution per turn: 1 to 16 bits
- Direction : clockwise or counter-clockwise, changes counting direction and speed sign.
- Speed window calculation : time between each speed data update.
- Reset/Preset value : The position process data is set to the preset parameter. The preset parameter shall be a valid position value according to the resolution chosen. Zero position shall be set using this parameter.

Diagnostics

- Operating Hours : number of hours since factory reset
- Temperature : event triggers when temperature exceeds specifications

Factory settings parameters

Name	Index	Factory Setting	Comment
Position Preset value	65	0	Value of the position preset
Rotation direction	72	false : CW	Set the rotation direction
Enter in Factory setup mode	75	0: Encoder mode	Do not use
Speed calculation window	80	1 : 200ms	Time between each speed data update
Absolute Position Resolution	90	16	Resolution of the turn counter (in bits)
Operating-hours	110	0	Number of hours with device on



STANDARD CONNECTIONS

		L-	N.C	L+	C/Q	N.C
BF	M12 - 5 Pins	1	2	3	4	5
BD	PUR Cable - M12 - 5 Pins	1	2	3	4	-
BJ	PVC Cable - 3 wires	WH (White)	-	BN (Brown)	GN (Green)	-



DIMENSIONS

All dimensions are in millimeters.

AHM5_06 Connection BFA (Axial M12)

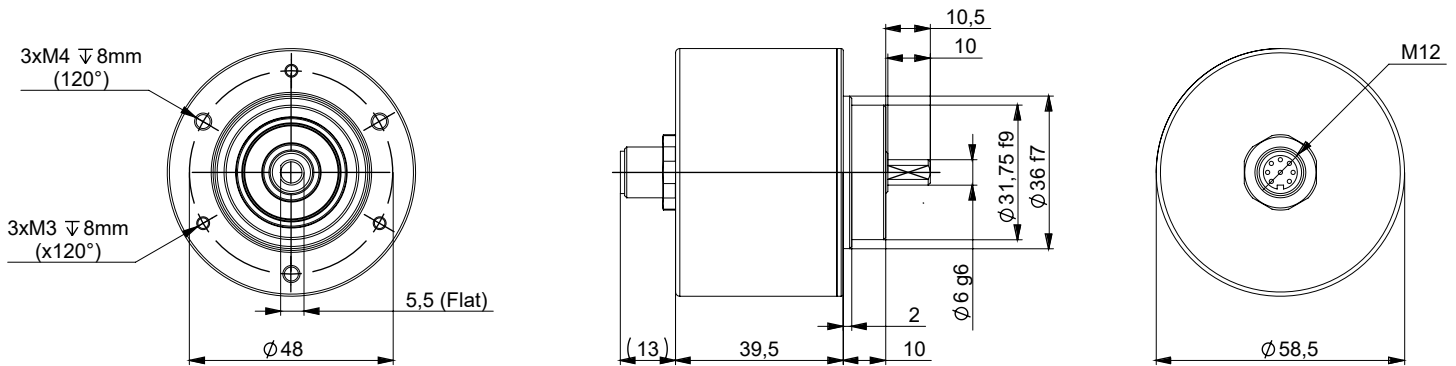

AH05_14 Standard clamping, Connection BJR (Radial Cable)

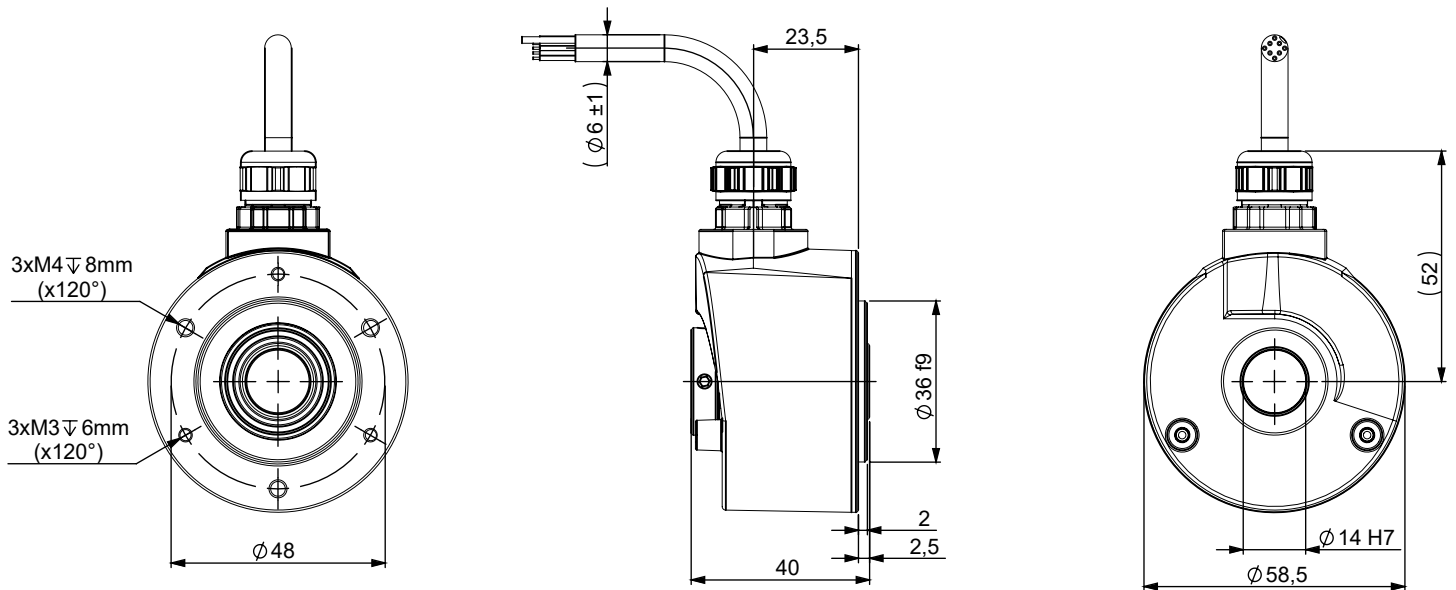

AH05S14/0M/ Flange side clamping, Connection BFR (Radial M12)

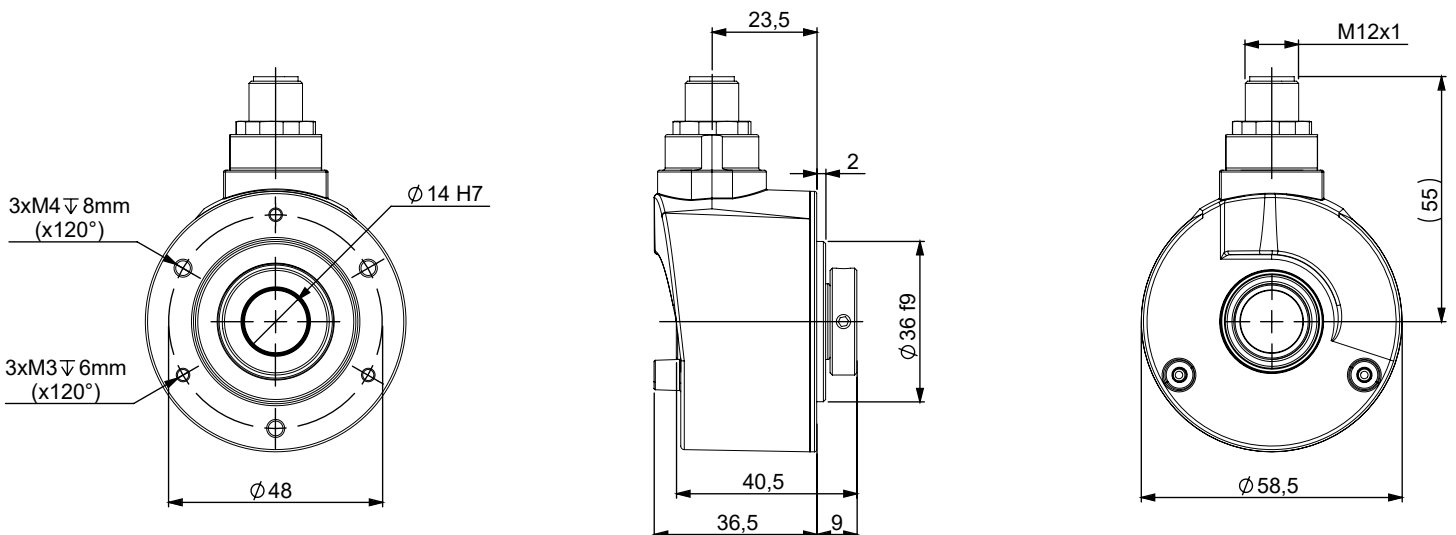



CONNECTION DIMENSIONS

Radial

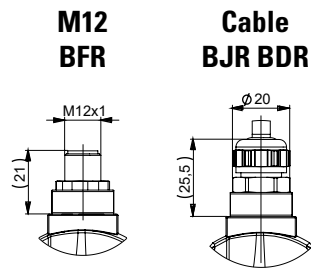

Axial

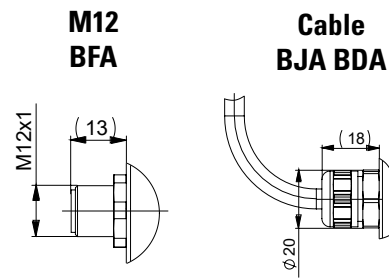

FLANGE AND COUPLING INTERFACES

The flange or coupling configurations can be defined in the ordering options for being installed on encoder in factory.
All flange or coupling kits can also be ordered separately (see accessories section).

AHM5_10 Connection BJR (Radial cable), flange 9500/005 mounted on the body

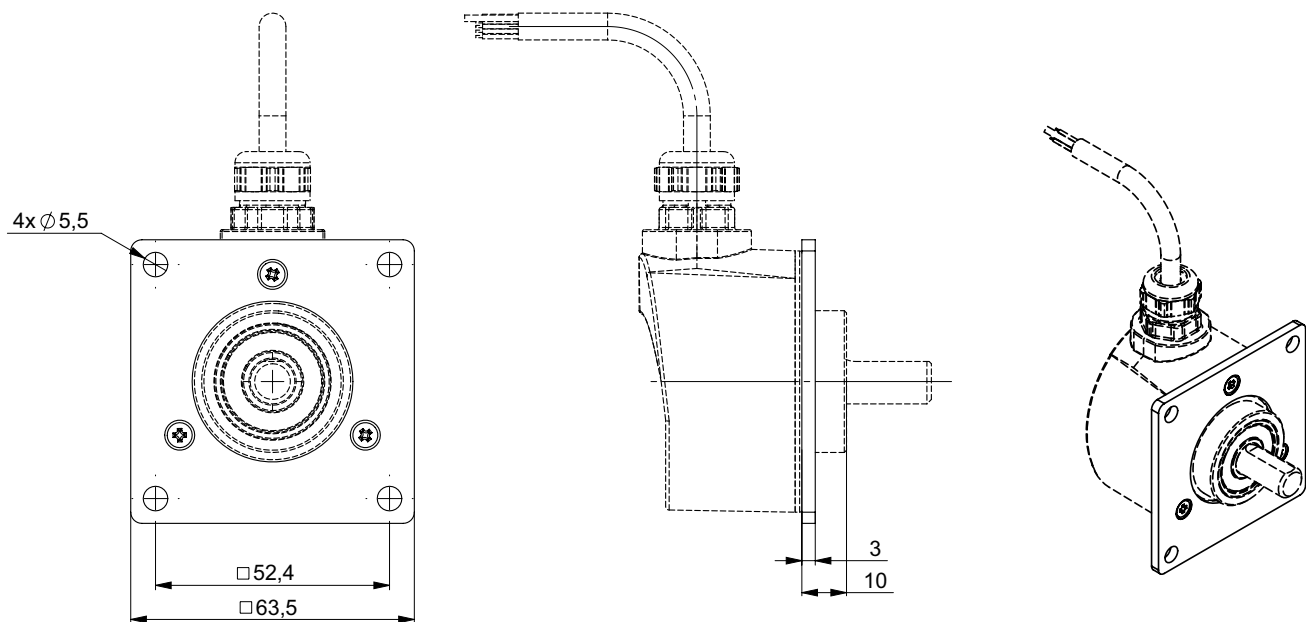

AH05_14 Standard clamping, Connection BJR (Radial Cable), coupling 9445/012 mounted on the body

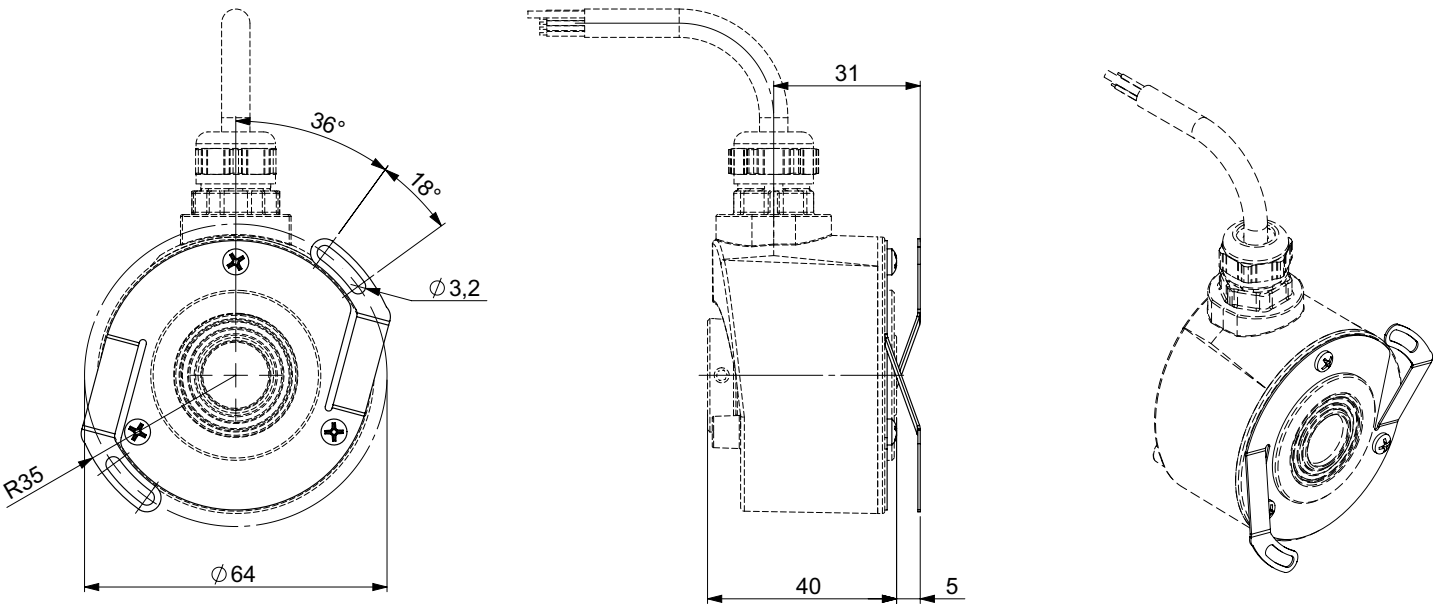

AH05_14 Standard clamping, Connection BJR (Radial Cable), coupling 9445/015 mounted on the body

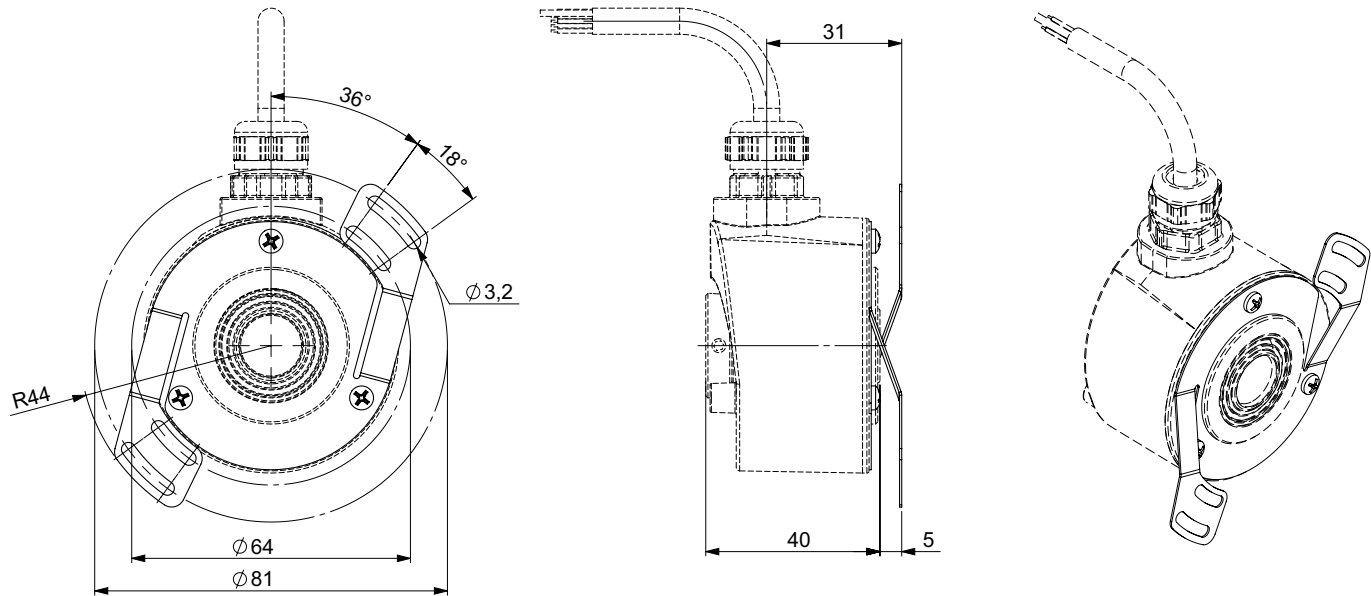



ORDERING OPTIONS

Example: AHM5_06//ZIOB//16//BDR020/**03**

Family	AHM5	06	/	ZIO	B	//	16	//	BD	R	020	//	**03**
AHM5: Solid Shaft Encoder AHK5: Blind Shaft Encoder AH05: Hollow Shaft Encoder													
Shaft Size													
AHM5 06: 6 mm 09: 9.52 mm 10: 10 mm 08: 8mm (Option)													
AHK5 or AH05: 10: 10 mm 12: 12 mm 14: 14 mm 15: 15mm (Option)													
Contact factory for other configurations													
Mechanical Option													
Blank: No option OM: Flange side clamping													
Voltage Output													
ZIO: 18-30V IO-Link													
Code													
B: Binary													
Resolution													
16: 16bits single turn position													
Output Termination													
BF: M12 5 Pins BD: PUR Cable with M12 - 5 Pins BJ: PVC Cable - 3 wires													
Output orientation													
R: Radial (All configurations) A: Axial (AHM5 and AHK5 only)													
Cable Length													
xxx: Cable Length (ex.: 020 = 2 Meters) Blank: No Cable													
Accessories													
D0****: AH05 with aluminum reduction sleeve D1****: AH05 with insulated reduction sleeve D2****: AHK5 with aluminum reduction sleeve **D2**: 9445/012 AH05 Stator coupling **D4**: 9445/015 AH05 Stator coupling **DK**: 9445/016 AHK5 & AH05.../OM/ Stator coupling **03**: 9500/003 Synchro flange **05**: 9500/005 Square flange													



GENERAL NOTES

For an optimized installation meeting industrial standards, refer to the Instructions Manual.
The Instructions Manual provides the technical information (drawings, electrical data, etc...) for a proper integration.



AGENCY APPROVALS & CERTIFICATIONS

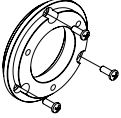
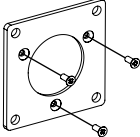
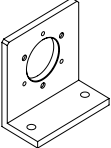
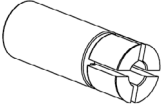
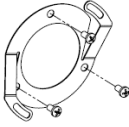
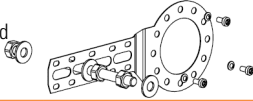
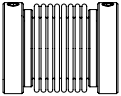
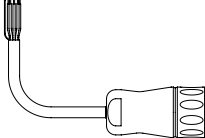

IO-Link

Description		Part Number		
Synchro flange kit Hardware included 		M9500/003		
		Other synchro flanges dimensions available on request		
Square flange kit Hardware included 		M9500/005		
		Other square flanges dimensions available on request		
Mounting bracket Hardware included 		M9202		
		(Compatible with all models)		
Reduction sleeve 		Insulated (PEEK)	Non insulated (Aluminum)	
		AH05	AH05	AHK5
		9431/I06	9431/A06	9431/K06
		9431/I08	9431/A08	9431/K08
		9431/I10	9431/A10	9431/K10
		9431/I12	9431/A12	9431/K12
Stator coupling kit Hardware included 		P/N	Recommended use/Compatibility	
		M9445/012	AH05	Fixing points
		M9445/015	AHK5 & AH05	2
		M9445/016	AHK5 & AH05 with /OM/ option	4
		Other stator coupling configurations available on request		
Tether arm kit Hardware included 		M9445/047		
		(Compatible with DHK5 and DH05 models)		
Bellow coupling 		9403/xx-yy with:		
		xx = 06 to 12 (side 1 bore diameter in mm)		
		yy = 06 to 12 (side 2 bore diameter in mm)		
		+ Imperial sizes available: 6.35, 9.52, 12.7 (mm)		
Standard Mating Connector 2m, 5m, 10m Mating Cable Assembly 		Installation: Refer to Instruction Manual		
		Extension cords compatible with G6 connection option:	Extension cords compatible with G8 connection option:	Extension cords compatible with GM connection option:
		RAL-020-001 = M23, PVC cable, 2m	RAL-020-xxx = M23, PUR cable, 2m	8230/366 = M12 overmolded, PUR cable, 2m
		RAL-050-001 = M23, PVC cable, 5m	RAL-050-xxx = M23, PUR cable, 5m	8230/370 = M12 overmolded, PUR cable, 5m
		RAL-100-001 = M23, PVC cable, 10m	RAL-100-xxx = M23, PUR cable, 10m	8230/368 = M12 overmolded, PUR cable, 10m

Made in France

Page 7

Sensata Technologies, Inc. ("Sensata") data sheets are solely intended to assist designers ("Buyers") who are developing systems that incorporate Sensata products (also referred to herein as "components"). Buyer understands and agrees that Buyer remains responsible for using its independent analysis, valuation, and judgment in designing Buyer's systems and products. Sensata data sheets have been created using standard laboratory conditions and engineering practices. Sensata has not conducted any testing other than that specifically described in the published documentation for a particular data sheet. Sensata may make corrections, enhancements, improvements, and other changes to its data sheets or components without notice.

Buyers are authorized to use Sensata data sheets with the Sensata component(s) identified in each particular data sheet. HOWEVER, NO OTHER LICENSE, EXPRESS OR IMPLIED, BY ESTOPPEL OTHERWISE TO ANY OTHER SENSATA INTELLECTUAL PROPERTY RIGHT, AND NO LICENSE TO ANY THIRD PARTY TECHNOLOGY OR INTELLECTUAL PROPERTY RIGHT, IS GRANTED HEREIN. SENSATA DATA SHEETS ARE PROVIDED "AS IS". SENSATA MAKES NO WARRANTIES OR REPRESENTATIONS WITH REGARD TO THE DATA SHEETS OR USE OF THE DATA SHEETS, EXPRESS, IMPLIED, OR STATUTORY, INCLUDING ACCURACY OR COMPLETENESS. SENSATA DISCLAIMS ANY WARRANTY OF TITLE AND ANY IMPLIED WARRANTIES OF MERCHANTABILITY, FITNESS FOR A PARTICULAR PURPOSE, QUIET ENJOYMENT, QUIET POSSESSION, AND NON-INFRINGEMENT OF ANY THIRD PARTY INTELLECTUAL PROPERTY RIGHTS WITH REGARD TO SENSATA DATA SHEETS OR USE THEREOF.

All products are sold subject to Sensata's terms and conditions of sale supplied at www.sensata.com SENSATA ASSUMES NO LIABILITY FOR APPLICATIONS ASSISTANCE OR THE DESIGN OF BUYERS' PRODUCTS. BUYER ACKNOWLEDGES AND AGREES THAT IT IS SOLELY RESPONSIBLE FOR COMPLIANCE WITH ALL LEGAL, REGULATORY, AND SAFETY-RELATED REQUIREMENTS CONCERNING ITS PRODUCTS, AND ANY USE OF SENSATA COMPONENTS IN ITS APPLICATIONS, NOTWITHSTANDING ANY APPLICATIONS-RELATED INFORMATION OR SUPPORT THAT MAY BE PROVIDED BY SENSATA.

Mailing Address: Sensata Technologies, Inc., 529 Pleasant Street, Attleboro, MA 02703, USA

CONTACT US

Americas

+1 (800) 350 2727

sensors@sensata.com

Europe, Middle East & Africa

+33 (3) 88 20 8080

position-info.eu@sensata.com

Asia Pacific

sales.isasia@list.sensata.com

China +86 (21) 2306 1500

Japan +81 (45) 277 7117

Korea +82 (31) 601 2004

India +91 (80) 67920890

Rest of Asia +886 (2) 27602006

ext 2808

Mouser Electronics

Authorized Distributor

Click to View Pricing, Inventory, Delivery & Lifecycle Information:

Sensata:

[AHK514-16BT-001](#) [AHK514-16BT-002](#) [AHM506-16BT-001](#) [AHM506-16BT-002](#) [AHM510-16BT-001](#) [AHM510-16BT-002](#) [AHO514-16BT-001](#)