

# Between-Series Adapters

## N Bulkhead to SMA

### N Bulkhead Female Jack to SMA Male Plug

Model Number

ADT-2810-NF-SMM-02

#### SPECIFICATIONS

**Frequency:** DC - 18.0 GHz

**VSWR:** 1.20 max

**Impedance:** 50 Ohms

**Finish:** Passivated Stainless Steel

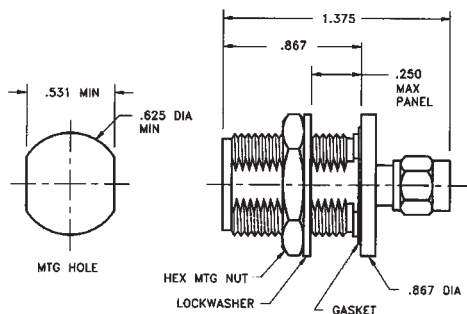

### N Bulkhead Female Jack to SMA Female Jack

Model Number

ADT-2840-NF-SMF-02

#### SPECIFICATIONS

**Frequency:** DC - 18.0 GHz

**VSWR:** 1.20 max

**Impedance:** 50 Ohms

**Finish:** Passivated Stainless Steel

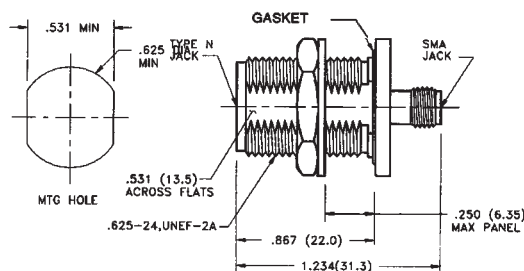

### N Rear Mount Bulkhead Female Jack to SMA Male Plug

Model Number

ADT-2599-NF-SMM-02

#### SPECIFICATIONS

**Frequency:** DC - 18.0 GHz

**VSWR:** 1.20 max

**Impedance:** 50 Ohms

**Finish:** Passivated Stainless Steel

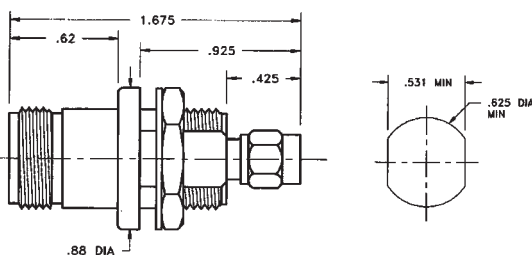

### N Rear Mount Bulkhead Female Jack to SMA Female Jack

Model Number

ADT-2599-NF-SMF-02

#### SPECIFICATIONS

**Frequency:** DC - 18.0 GHz

**VSWR:** 1.04 @ DC-4.0 GHz

1.07 @ 4.0-8.0 GHz

1.12 @ 8.0-18.0 GHz

**Impedance:** 50 Ohms

**Finish:** Passivated Stainless Steel

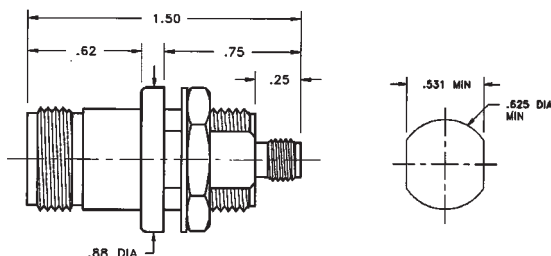

# Mouser Electronics

Authorized Distributor

Click to View Pricing, Inventory, Delivery & Lifecycle Information:

[Cinch Connectivity Solutions:](#)

[ADT-2840-NF-SMF-02](#)