

### SMA Female Jack to BMA Male Plug

#### Model Number

**ADT-2769-SF-BMM-02**

#### SPECIFICATIONS

**Frequency:** DC - 18.0 GHz

**VSWR:**  $1.05 + .005 f$  (GHz)

**Impedance:** 50 Ohms

**Finish:** Passivated Stainless Steel

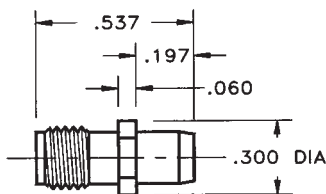

### SMA Female Jack to BMA Male Plug - Bulkhead Mount

#### Model Number

**ADT-2797-SF-BMM-02**

#### SPECIFICATIONS

**Frequency:** DC - 18.0 GHz

**VSWR:**  $1.05 + .005 f$  (GHz)

**Impedance:** 50 Ohms

**Finish:** Passivated Stainless Steel

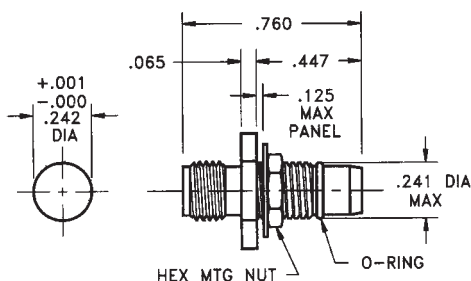

### SMA Male Plug to BMA Male Plug

#### Model Number

**ADT-2770-SM-BMM-02**

#### SPECIFICATIONS

**Frequency:** DC - 18.0 GHz

**VSWR:**  $1.05 + .005 f$  (GHz)

**Impedance:** 50 Ohms

**Finish:** Passivated Stainless Steel

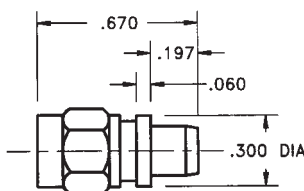

### SMA Male Plug to BMA Male Plug - Bulkhead Mount

#### Model Number

**ADT-2798-SM-BMM-02**

#### SPECIFICATIONS

**Frequency:** DC - 18.0 GHz

**VSWR:**  $1.05 + .005 f$  (GHz)

**Impedance:** 50 Ohms

**Finish:** Passivated Stainless Steel

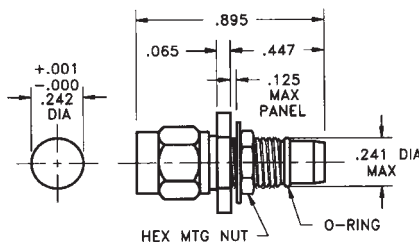

# Mouser Electronics

Authorized Distributor

Click to View Pricing, Inventory, Delivery & Lifecycle Information:

[Cinch Connectivity Solutions:](#)

[ADT-2769-SF-BMM-02](#)