

| TABLE 1      |                           |      |              |    |
|--------------|---------------------------|------|--------------|----|
| MODEL NUMBER | CABLES ACCOMMODATED       | "A"  | ASSEMBLE PER | SH |
| PL75C-201    | M17/176-00002             | 1.70 | TAI-166      | 1  |
| PL75C-202    | TWC-78-1                  |      |              |    |
| PL75C-203    | TWC-124-1A                |      |              |    |
| PL75C-204    | 10602, RAYCHEM            |      |              |    |
| PL75C-205    | TWAC-78-1F2               |      |              |    |
| PL75C-206    | 7826D0130, RAYCHEM        |      |              |    |
| PL75C-207    | 83310, BELDEN             |      |              |    |
| PL75C-208    | 202-3927, MICRODOT        |      |              |    |
| PL75C-209    | 202-3942, MICRODOT        |      |              |    |
| PL75C-210    | 8451, BELDEN              |      |              |    |
| PL75C-211    | 202-3934, MICRODOT        | 1.44 | TAI-138      | 1  |
| PL75C-212    | 2524E0114, RAYCHEM        |      |              | 2  |
| PL75C-213    | TWC-78-2                  |      |              |    |
| PL75C-213-1U | TWC-78-2                  |      |              | 1  |
| PL75C-214    | TWC-124-2                 |      |              |    |
| PL75C-215    | BL982, TIMES              |      |              |    |
| PL75C-216    | BL1242, TIMES             |      |              |    |
| PL75C-217    | GC875TM24H, GRUMMAN       | 1.70 | TAI-166      | 1  |
| PL75C-218    | EDP221888, RAYCHEM        |      |              |    |
| PL75C-219    | 2526D1114, RAYCHEM        |      |              |    |
| PL75C-220    | GC875RR1, GRUMMAN         |      |              |    |
| PL75C-221    | 10614, RAYCHEM            |      |              |    |
| PL75C-222    | 10613, RAYCHEM            |      |              |    |
| PL75C-223    | HMS2-1149, HUGHES         |      |              |    |
| PL75C-224    | TWCP-124-3                | 1.44 | TAI-138      | 1  |
| PL75C-225    | PS665PL, PRIME STOCK      | 1.70 | TAI-168      | 1  |
| PL75C-301    | GC875GC1, GRUMMAN         |      |              |    |
| PL75C-302    | GC875GB1, GRUMMAN         |      |              |    |
| PL75C-303    | 7528A5314, RAYCHEM        |      |              |    |
| PL75C-305    | M17/177-00001, THERMATICS |      |              |    |
| PL75C-306    | TRC-50-2<br>M17/134-00002 | 1.70 | TAI-218      | 1  |
| PL75C-307    | TRC-75-1                  | 1.70 | TAI-168      | 1  |
| PL75C-308    | TRC-75-2                  | 1.70 | TAI-218      | 1  |
| PL75C-309    | TRC-50-1                  | 1.70 | TAI-168      | 1  |

NOTES: UNLESS OTHERWISE SPECIFIED.

1. MATERIAL & FINISH:
- 1.1 BODY, CRIMP RING & CRIMP BUSHING: NICKEL PLATED BRASS
  - 1.2 FINGER SPRING: NICKEL PLATED BERYLLIUM COPPER
  - 1.3 INSULATORS & DIELECTRICS: PTFE (TEFLON)
  - 1.4 INTERMEDIATE CONTACT: GOLD PLATED BERYLLIUM COPPER
  - 1.5 CENTER CONTACT: GOLD PLATED BRASS
  - 1.6 GASKET: SILICONE RUBBER
  - 1.7 STRAIN RELIEF & SEALING SLEEVE: POLYOLEFIN

2. ELECTRICAL:
- 2.1 FREQUENCY (MAX): 500 MHZ
  - 2.2 IMPEDANCE: NON-CONSTANT

3. EXAMPLE OF COMPLETE MODEL NUMBER:
- PL75C A -BBB
- ASSEMBLY DASH NO.
- KEYING LETTER PER TABLE 2 (IF APPLICABLE)
- BASE MODEL NO.

| TABLE 2            |      |      |      |
|--------------------|------|------|------|
| POLARIZATION CHART |      |      |      |
| KEYING LETTER      | "D°" | "E°" | "F°" |
| NONE               | 120  | 120  | 120  |
| T                  | 100  | 150  | 110  |
| U                  | 120  | 130  | 110  |
| V                  | 115  | 130  | 115  |
| W                  | 125  | 110  | 125  |
| X                  | 130  | 100  | 130  |
| Y                  | 110  | 140  | 110  |
| Z                  | 100  | 160  | 100  |
| S                  | 135  | 135  | 90   |

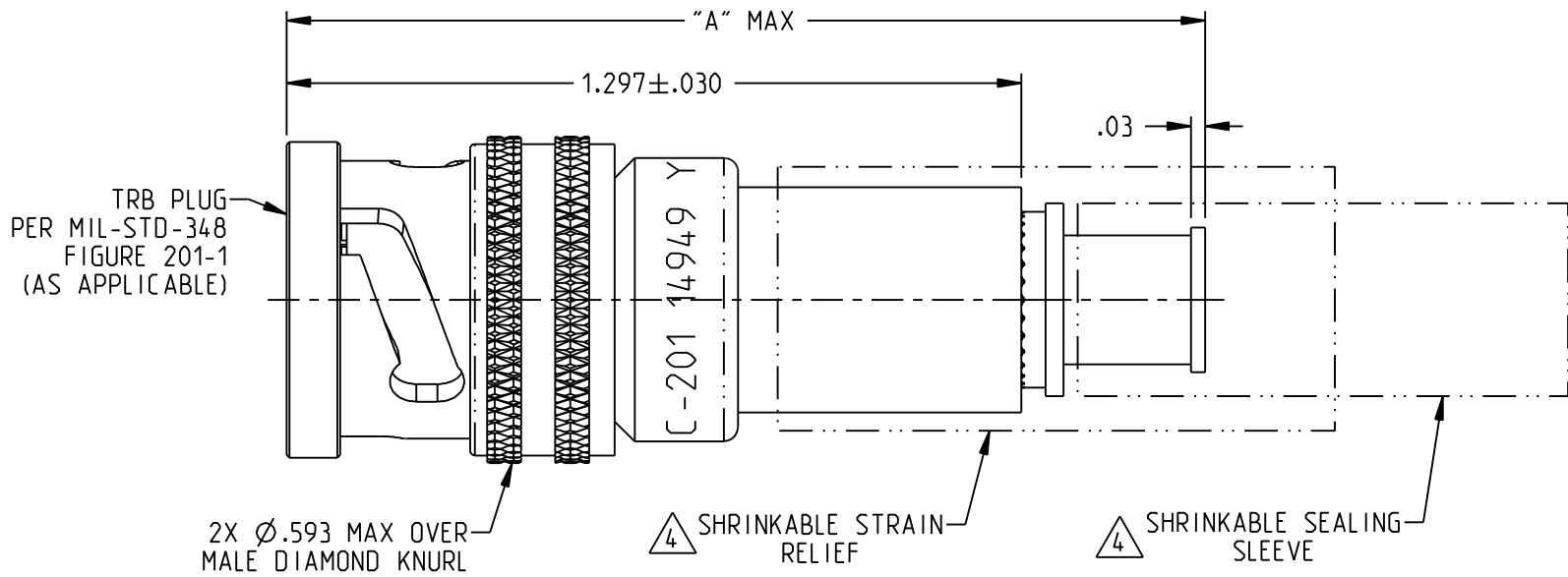
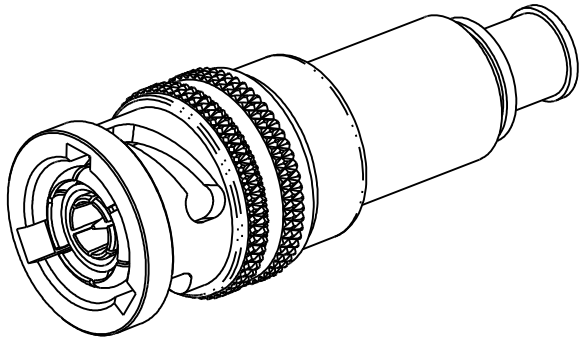
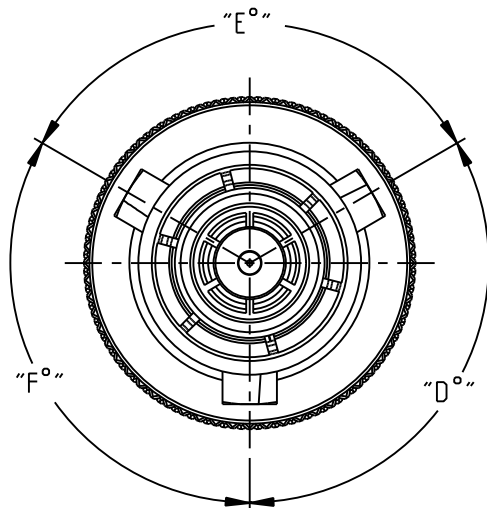

PL75C-201 SHOWN

4. SHRINKABLE STRAIN RELIEF AND/OR SHRINKABLE SEALING SLEEVE SUPPLIED LOOSE AS FOLLOWS:
- 4.1 CABLE GROUPS -201 THRU -210, -217 THRU -223, -301, -302, - 303, -305, -307 & -309
    - 1 SHRINKABLE STRAIN RELIEF
    - 1 SHRINKABLE SEALING SLEEVE
  - 4.2 CABLE GROUPS -211 THRU -216, -224, -225, -306 & -308
    - 1 SHRINKABLE STRAIN RELIEF

|   |   |                                   |                      |                             |
|---|---|-----------------------------------|----------------------|-----------------------------|
| <br><small>This PROPRIETARY Document is property of Cinch Connectivity Solutions. It is confidential in nature, non-transferable, and issued with the clear understanding that it is not traced or copied without permission and is returnable upon demand.</small><br><small>INTERPRET DRAWING IN ACCORDANCE WITH ASME Y14.5-2009.</small> | <br><b>RoHS2</b> <input checked="" type="checkbox"/><br>2011/65/EU<br><small>UNLESS OTHERWISE SPECIFIED UNITS: INCH</small><br>.XX ±.02<br>.XXX ±.010<br>ANGLES ±1° | <b>TROMPETER</b>                  |                      |                             |
|   |   | Title: TRB CABLE PLUG, TOOL CRIMP |                      |                             |
|   |   | Model No. PL75CA-BBB              |                      |                             |
|   |   | Size B                            | DO NOT SCALE DRAWING | Date 8/22/2018 Sheet 1 OF 2 |

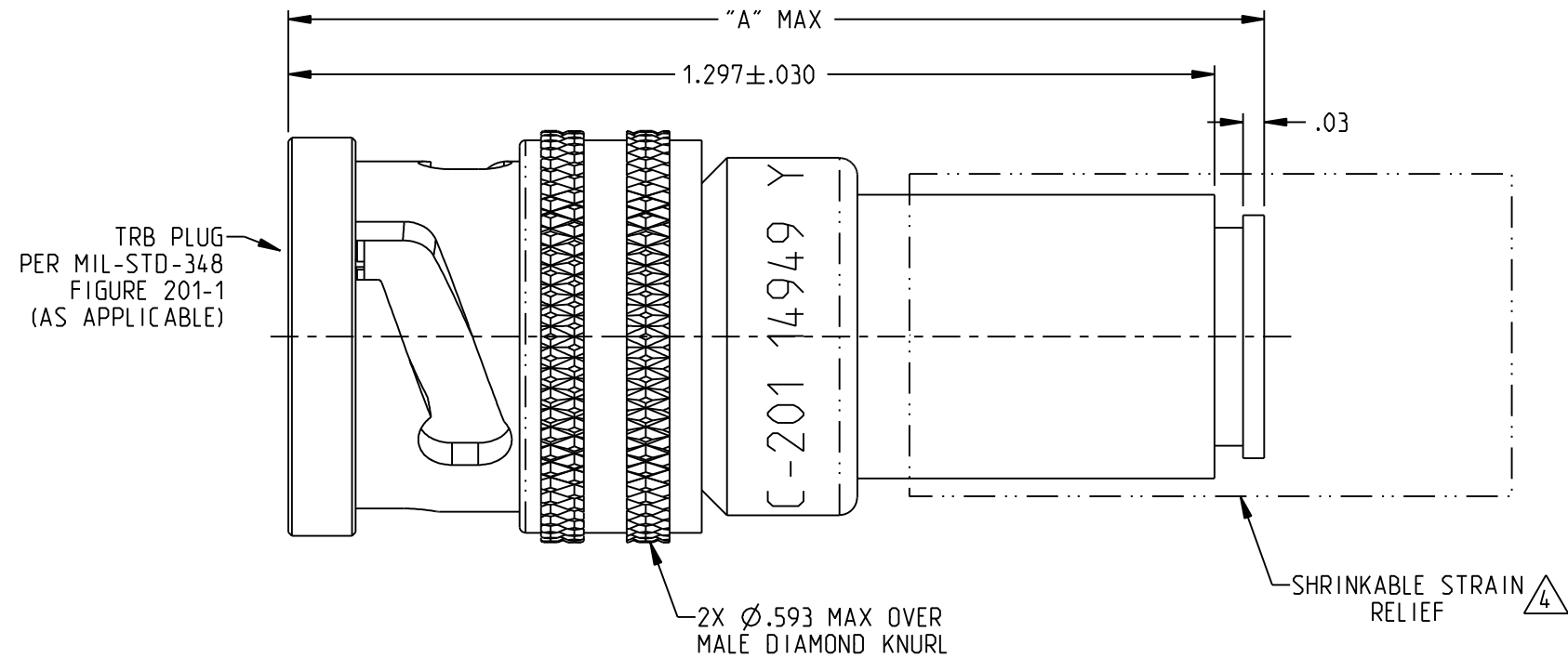
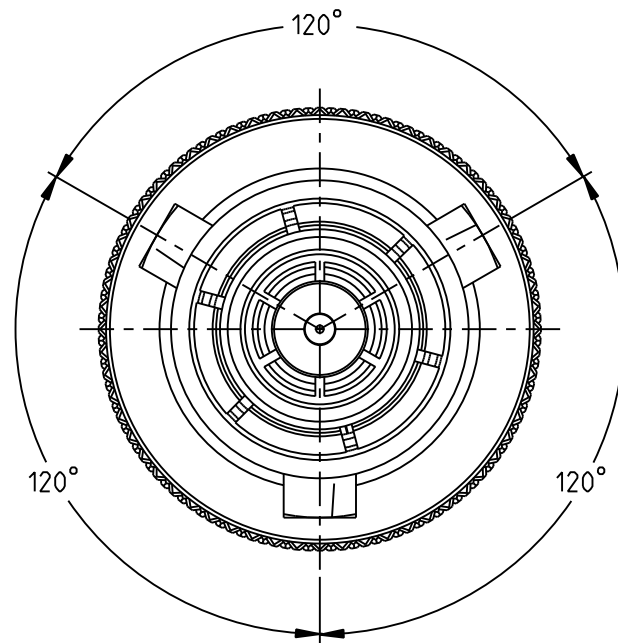

PL75C-213-1U SHOWN

NOTES: UNLESS OTHERWISE SPECIFIED (THIS PAGE).

1. MATERIAL & FINISH:
  - 1.1 BODY, CRIMP RING & CRIMP BUSHING: NICKEL PLATED BRASS
  - 1.2 FINGER SPRING: NICKEL PLATED BERYLLIUM COPPER
  - 1.3 INSULATORS & DIELECTRICS: PTFE (TEFLON)
  - 1.4 INTERMEDIATE CONTACT: GOLD PLATED BERYLLIUM COPPER
  - 1.5 CENTER CONTACT: GOLD PLATED BRASS
  - 1.6 GASKET: SILICONE RUBBER
  - 1.7 STRAIN RELIEF & SEALING SLEEVE: POLYOLEFIN

|  |   |                                   |                      |
|--|---|-----------------------------------|----------------------|
| <p>This PROPRIETARY Document is property of Cinch Connectivity Solutions. It is confidential in nature, non-transferable, and issued with the clear understanding that it is not traced or copied without permission and is returnable upon demand.</p> <p>INTERPRET DRAWING IN ACCORDANCE WITH ASME Y14.5-2009.</p> | <p>RoHS2 <input checked="" type="checkbox"/> 2011/65/EU</p> <p>UNLESS OTHERWISE SPECIFIED UNITS: INCH</p> <p>.XX ±.02<br/>.XXX ±.010<br/>ANGLES ±1°</p> | <b>TROMPETER</b>                  |                      |
|  |   | Title: TRB CABLE PLUG, TOOL CRIMP |                      |
|  |   | Model No.: PL75CA-BBB             |                      |
|  |   | Size: B                           | DO NOT SCALE DRAWING |

Date: 8/22/2018 Sheet: 2 OF 2

# Mouser Electronics

Authorized Distributor

Click to View Pricing, Inventory, Delivery & Lifecycle Information:

[Cinch Connectivity Solutions:](#)

[PL75C-201](#)