

RoHS COMPLIANT

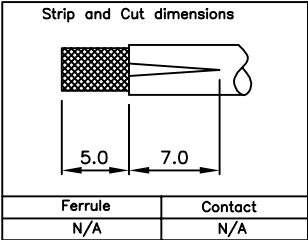
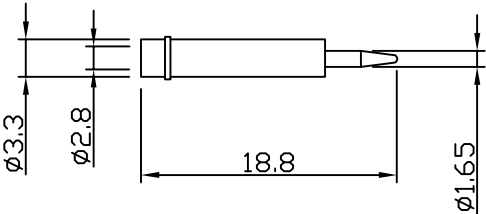
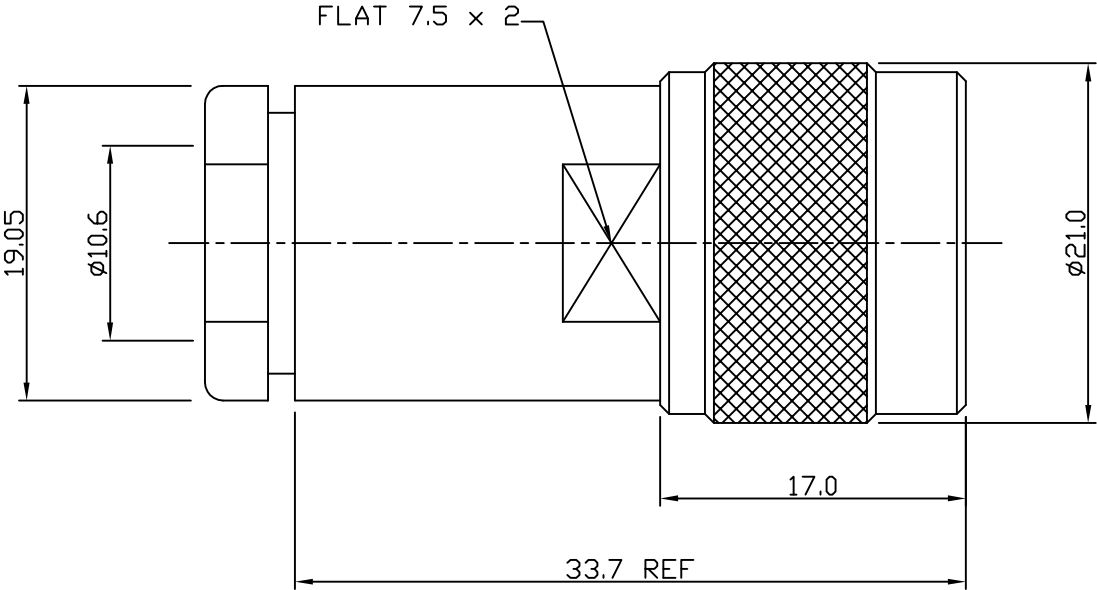

Electrical Characteristics

Nominal Impedance:	50 ohms
Frequency Range:	DC to 11 GHz
VSWR:	1.35:1 maximum
Insertion Loss:	0.17 dB max
Operating Voltage (rms):	1500 V maximum at sea level
Dielectric Withstand Voltage (rms):	2500 V maximum at sea level
Contact Resistance:	1.0 milliohms maximum
Insulation Resistance:	5000 megohms minimum

Mechanical Characteristics

Mating Cycles:	500 cycles minimum
Interface Dimensions:	Conform to MIL-C-39012

Environmental Characteristics

Temperature Range:	-55 °C to +85 °C
--------------------	------------------

	PART	DESCRIPTION
1	Back Nut	Brass, nickel plated
2	Washer	Brass, nickel plated
3	Gasket	Rubber
4	Clamp	Brass, nickel plated
5	Body	Brass, nickel plated
6	Insulator	Teflon
7	Insulator	Teflon
8	Contact	Brass, gold plated

Design Change	JC	2	28 June 12
First Issue	RP	1	19 Apr 07
DESCRIPTION OF REVISION	APPVD	ISS	DATE

For stripping and assembly instnuctions see Drawing Number: VAIN1206



Cinch Connectivity Solutions
7-13 Russel Way,
Widford Industrial Estate,
Chelmsford,Essex,
CM1 3AA, UK.
Tel: +44 (0) 1245 359515
Fax: +44 (0) 1245 358938

SCALE: Not To Scale

DIMENSIONS: mm

TOLERANCES:
± 0.2mm unless
otherwise stated

DRAWN BY:

R Presland

CHECKED BY:

M Spooner

APPROVED BY:

M Spooner

DATE:

19 Apr 07

TITLE:

N Clamp Plug for
RA519/LMR400

PART NUMBER:

VNS10-2021

PAGE: 1 of 1

Mouser Electronics

Authorized Distributor

Click to View Pricing, Inventory, Delivery & Lifecycle Information:

[Cinch Connectivity Solutions:](#)

[VNS10-2021](#)