

DATA CONTAINED IN THIS DOCUMENT IS PROPRIETARY TO TROMPETER ELECTRONICS INC. AND SHALL NOT BE DISCLOSED, COPIED OR USED FOR PROCUREMENT OR MANUFACTURE WITHOUT EXPRESS WRITTEN PERMISSION.

DASH NO	MODEL NO	IMPED OHMS
-1	PL121	50
-2	UPL121	75

INCH	MM
.005	0.13
.030	0.76
.068	1.73
.093	2.36
.380	9.65
.437	11.10
.500	12.70
.628	15.95
1.060	26.92

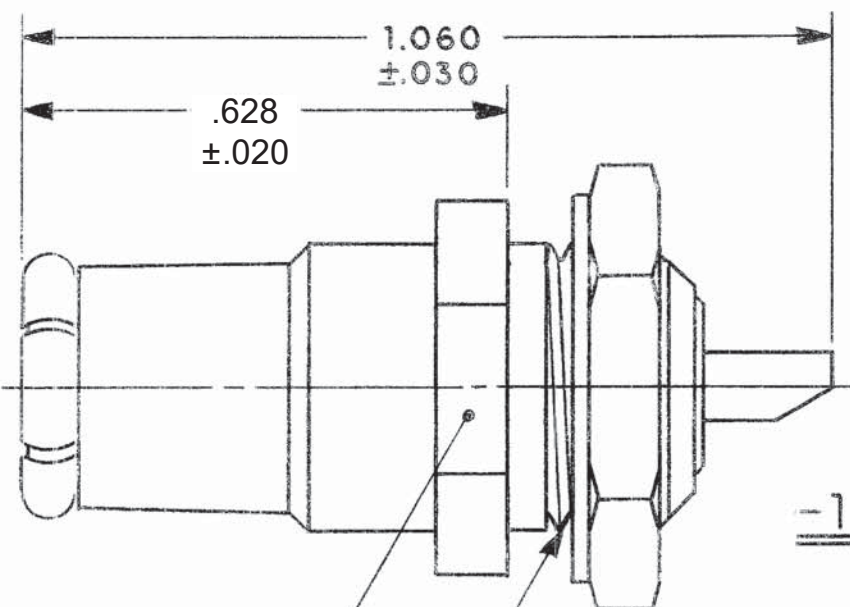

-1 SHOWN

.500 HEX NUT

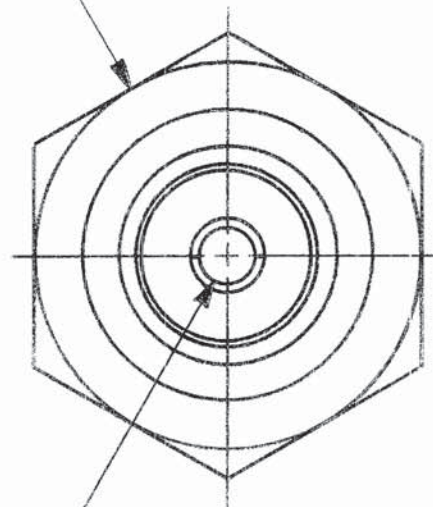

SOLDER POT ACCEPTS
.068 DIA CONDUCTOR

4. MAX PNL THK .093
3. 50 & 75 OHM COAXIAL BULKHEAD MOUNT PUSH-ON SOLDER POT PLUG, BNC INTERFACE
2. FINISH: NICKEL
1. ALL DIM ARE IN INCHES

RECOMMENDED
PANEL CUTOUT
SCALE: 2/1

QTY	DESCRIPTION			PART NUMBER		ITEM
TOL UNLESS SPECIFIED .XX ± .XXX ± .005 .XXXX ± ANGLES ±			TROMPETER ELECTRONICS, INC.		PL121/UPL121	
DWN	RJS	9-3-84	MATERIAL	CODE IDENT	DRAWING NO.	REV
CHK	DC	9-10-84	—	14949	105-0414	E
ENGR	DM	9-14-84				
APPR	JS	9-14-84	SCALE 4/1	DATE 1-15-74	SHEET 1 OF 2	

REVISIONS

105-0414 SH 1

REV	EO	DESCRIPTION	DWN	APPROVED	DATE
C	6533	REV & REDWN	RJS	DC	9-10-84
D	6747	'D' FLAT DELETED	MRH	DC	4-25-85
E	7899	ITEM 2 P/N WAS 8000-1295 ①, DWG NO WAS 1005-0414	DKC	JS	1-15-85

Mouser Electronics

Authorized Distributor

Click to View Pricing, Inventory, Delivery & Lifecycle Information:

[Cinch Connectivity Solutions:](#)

[UPL121](#)