

RED INDICATES ORIGINAL

DASH NO	FIG NO	CABLE ACCOMMODATED	A DIM	B DIM	C HEX	D DIA	E FLATS	ASSEMBLE PER
-003	1,2	RG-174, -188, -316	2.730	1.500	.178	.516	.437	TAI-117
-004		RG-179, RG-187	2.450	1.220				
-008		RG-195, RG-180 421-111 ESSEX	2.730	1.500				
-009		8218 BELDEN YR23023 BELDEN 21-597 ESSEX	2.450	1.220				
-010		RG-122	2.730	1.500				
-011		RG-58, -141, -303 21-597 ESSEX	2.450	1.220				
-012		RG-55, -142, -223 RG-400	2.730	1.500				
-013		RG-59, RG-62	2.450	1.220				
-013A		TCC-75-2	2.730	1.500				
-014		8212 BELDEN	2.450	1.220				
-015		RG-71 730A AT&T	2.730	1.500				
-016		724 AT&T 8281 BELDEN	2.450	1.220				
-017		RG-6	2.730	1.500				
-018	1,2	9268 BELDEN	2.450	1.220	.255	.516	.437	
-019		8279 BELDEN	2.730	1.500				
-020	1	9248 BELDEN	2.450	1.220	.290	.578	.500	
-023	1,2	89108 BELDEN	2.730	1.500	.255	.516	.437	
-025		734A AT&T	2.450	1.220				
-026		735A AT&T	2.730	1.500				
-027		KS19224L2 AT&T	2.450	1.220				
			2.730	1.500				

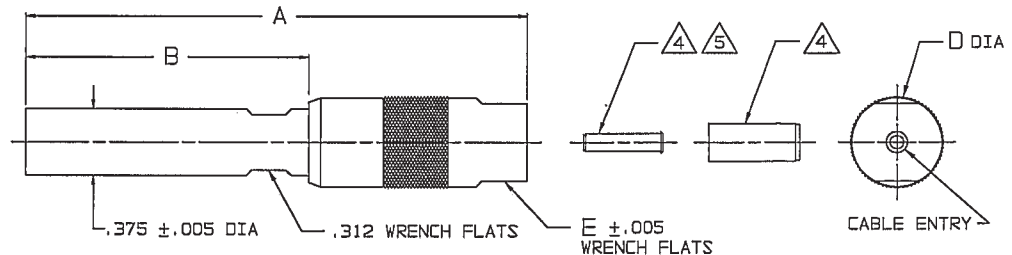

FIG 1
-003 SHOWN

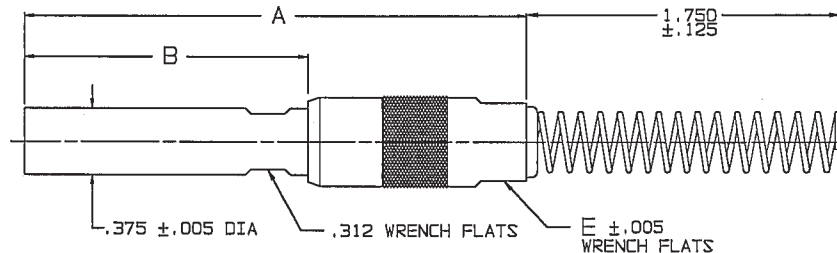

FIG 2
-003 SHOWN

INCH	MM
.005	0.13
.030	0.76
.070	1.78
.090	2.29
.125	3.18
.178	4.52
.213	5.41
.255	6.48
.290	7.37
.312	7.92
.324	8.23
.340	8.65
.375	9.53
.437	11.10
.500	12.70
.516	13.11
.578	14.68
1.220	30.99
1.500	38.10
1.750	44.45
2.450	62.23
2.730	69.34

7. IF BEND RELIEF SPRING REQUIRED (FIG 2)
ADD SUFFIX "BR" TO CABLE GROUP DASH NO
(NOT AVAILABLE FOR CABLE GROUPS -015
THRU -W017, -020, -W020, -027 & -W027)

6. DASH NO DENOTES CABLE GROUP

5. SLEEVE REQUIRED ON -003 THRU-W004 ONLY

4. SLEEVE AND CRIMP SLEEVE ARE SUPPLIED LOOSE

3. COAXIAL STD .375 SIZE TOOL CRIMP PATCH PLUG
BOTH RCA/AT&T VERSIONS (.070/.090 PIN CONTACT DIA)

2. FINISH: TFS-1A (NICKEL)

1. ALL DIM ARE IN INCHES

8. EXAMPLE OF COMPLETE MODEL NO:
PL1WC-003 BR

BASIC MODEL NO
PL1C = 50 OHM (.070)
PL1WC = 75 OHM (.090) DASH NO

RECOMMENDED
HEX CRIMP
SCALE: NONE

REV	ED	DESCRIPTION	DWN	APPROVED	DATE
V	13436	ADDED -023 TO CABLES ACCOMMODATED AND -023/ -W023 TO BDM; SEE ECO	DKC		5/24/00

QTY	DESCRIPTION	PART NUMBER	ITEM
11-03	TOL UNLESS SPECIFIED		
11-02	.XX ± .030		
105-0998	.XXXXX		
105-0972	ANGLES		
1-0319	DWN DKC 5-12-00		
1-0304	CHK		
1-0301	ENGR		
NEXT ASSY	APPR		

PL1C/BR/PL1WC/BR	DRAWING NO. 1-0453	REV V
MATERIAL	CODE IDENT 14949	
SCALE 2/1	DATE 4-30-79	SHEET 1C

Mouser Electronics

Authorized Distributor

Click to View Pricing, Inventory, Delivery & Lifecycle Information:

[Cinch Connectivity Solutions:](#)

[PL1WC-013](#)