

TREK-303RH



7" In-Vehicle Smart Display

Features

- Vehicle grade 7" (16:10) WVGA resolution TFT LCD with 4-wire Resistive Touchscreen
- Five User-programmable function keys
- Two 2-watt Speakers
- Optional to support built-in light sensor for auto dimming application
- Easy installation, Paired with TREK computing box (TREK-5xx/6xx) by one-cable-connection
- Extended I/O ports (USB 2.0 Type A, Power button and Reset button) for TREK computing box maintenance
- -30 to 70° C wide working temperature



Introduction

The TREK-303 is a vehicle display system for Mobile Resource Management (MRM) applications in trucks, buses and taxis. The TREK-303 touch panel is the perfect size for tight spaces; ideal for fleet management and dispatch applications. It also meets requirements for automotive grade working temperatures (-30 ~ 70° C). TREK-303 provides excellent display capabilities, featuring light-weight housing, compatible with RAM mounting solutions that customers can easily install. TREK-303 is designed with drivers in mind: when the system requires powering up or waking up, it can be easily controlled from the button located in back; and for night driving, the panel has an auto detecting light sensor to automatically adjust brightness. TREK-303 is a smart display designed especially for truck, bus, and taxi drivers.

Specifications

| | | |
|-------------|---------------------------------|---|
| LCD | Design Compatible Models | Paired with TREK computing box (i.e. TREK-5xx/6xx) |
| | Resolution (pixel) | WVGA (800 x 480) |
| | Video Input | Single channel, 18 bit LVDS |
| | Pixel Pitch | 0.2168 (H) x 0.2168 (V) |
| | Brightness (cd/m ²) | 500 (typical) |
| | View Angle ((H/V)) | 140° /120° |
| | Contrast Ratio | 500 |
| | Backlight Life (Hrs) | 50K |
| Touchscreen | Backlight Type | LED |
| | Size | 7" format |
| | Type | 4-wire Resistive |
| | Transparency | 84% ± 3% |
| | Hardness | 3H |
| Front Panel | Durability | Knock test > 200,000 times (Stylus= R0.8,<=250g) |
| | Speaker | 2 x 2-watt speaker |
| | Hotkey | 5 x User-programmable Function keys with green LED |
| | Brightness Control | Manually controlled by button (default), Light sensing (optional) |
| | USB Port | 1 x USB 2.0 Host Type A (Data access from/to TREK computing box) |
| Rear I/O | Smart Display Port | 1 x 36-pin locking type high density connector to be paired with TREK-5xx/6xx |
| | Power button | 1 x Power button (To power on/off TREK computing box) |
| | Reset button | 1 x Reset button (To Reset TREK computing box) |
| Power | DC Input | 12 V ± 5% (Powered by TREK computing box directly) |
| | Power Consumption | 7W (Nominal), 12W (Max.) |
| Mechanical | Mounting | Design compatible with RAM mount |
| | Material | PC |
| | Weight | 1.0 kg |
| | Dimensions (W x H x D) | 244 x 160 x 41 mm |
| Environment | Operating Temperature | -30 to + 70° C |
| | Storage Temperature | -40 to + 80° C |
| | Vibration | MIL-STD-810G, SAE J1455 4.9.4.2 |
| | Certifications | CE, FCC, CCC, E-MARK (E13) |
| | IP Rating | IP 31 (entire system), IP 54 (with I/O Cover) |

TREK-303RH

Dimensions

Unit: mm

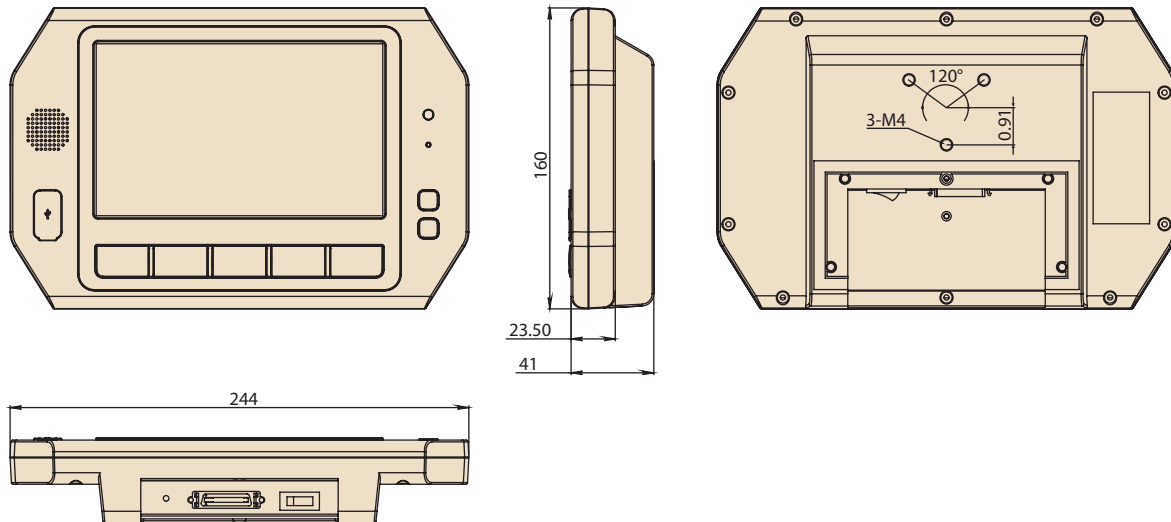

I/O Connectors

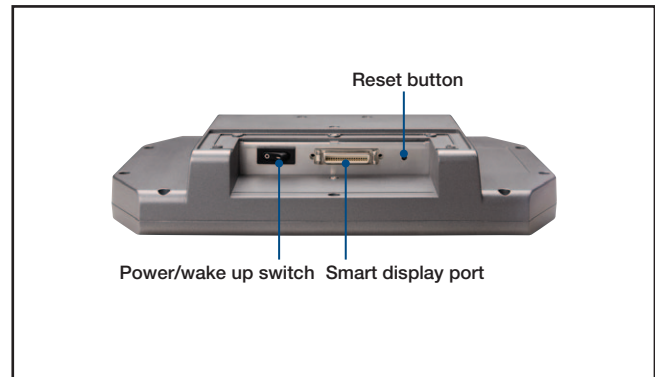

- A. USB Host
- B. 5 programmable hotkeys
- C. D. Brightness control
- D. Brightness control
- E. Power LED
- F. Light sensor
- G. Speaker

Note: Backlight off: Press C button to the lowest level

Ordering Information

| Part Number | Description |
|----------------|---|
| TREK-303R-HA0E | 7" WVGA in-vehicle Smart Display, with 4-wire Resistive Touchscreen |

Optional Items

| Part Number | Description |
|--------------|--|
| RAM-MOUNT-02 | RAM mount with 1.5" ball, VESA mount base |
| 1700020007 | 2-meter smart display cable (Paired with TREK-5xx/6xx) |
| 1700020008 | 5-meter smart display cable (Paired with TREK-5xx/6xx) |

Mouser Electronics

Authorized Distributor

Click to View Pricing, Inventory, Delivery & Lifecycle Information:

[Advantech:](#)

[C-TREK303RHA0E](#)