

# IPC-603

## 2U 3-Slot Rackmount Chassis for ATX/MicroATX Motherboard with Front I/O



CE FCC

### Features

- Front I/O, short depth 2U chassis (308 mm)
- Shockproof drive for slim ODD and one 3.5" HDD
- Equipped with 350W single power supply
- Easy-to-replace air filters

### Specifications

Drive Bay	Slim Optical Disk Drive 3.5"	External	Internal
		1	-
Cooling	Fan	2 (8 cm/47 CFM each)	-
		Air Filters	3 (85 x 80 mm)
Miscellaneous	Notification LEDs	Power & HDD activity	
Environment	Temperature	Operating 0 ~ 40 °C (32 ~ 104 °F)	Non-Operating -20 ~ 60 °C (-4 ~ 140 °F)
	Humidity	10 ~ 85% @ 40 °C, non-condensing	10 ~ 95% @ 40 °C, non-condensing
	Vibration (5 ~ 500 Hz)	1 Grms	2 G
	Shock	10 G (with 11 ms duration, half sine wave)	
	Dimensions (W x H x D)	482 x 88 x 308 mm (19" x 3.46" x 12.1")	
Physical Characteristics	Weight	6.4 kg (14.1 lb)	

### Front View

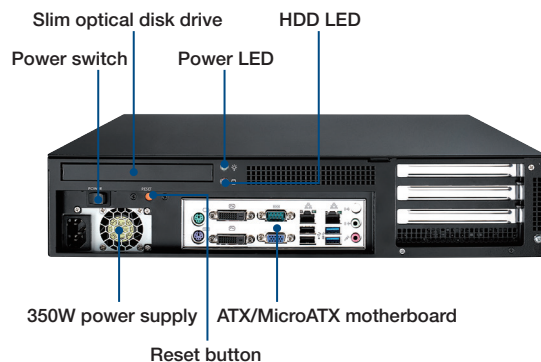

### Inside View

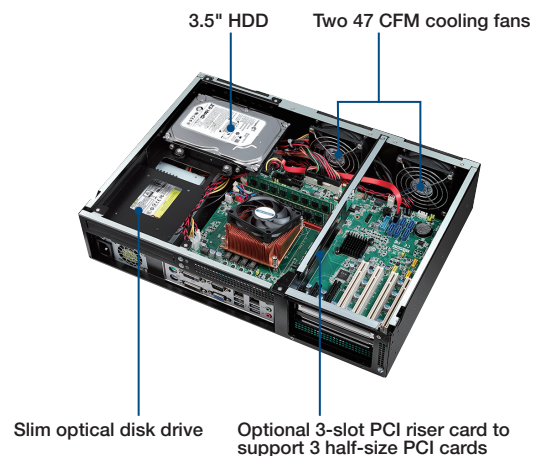

## Dimensions

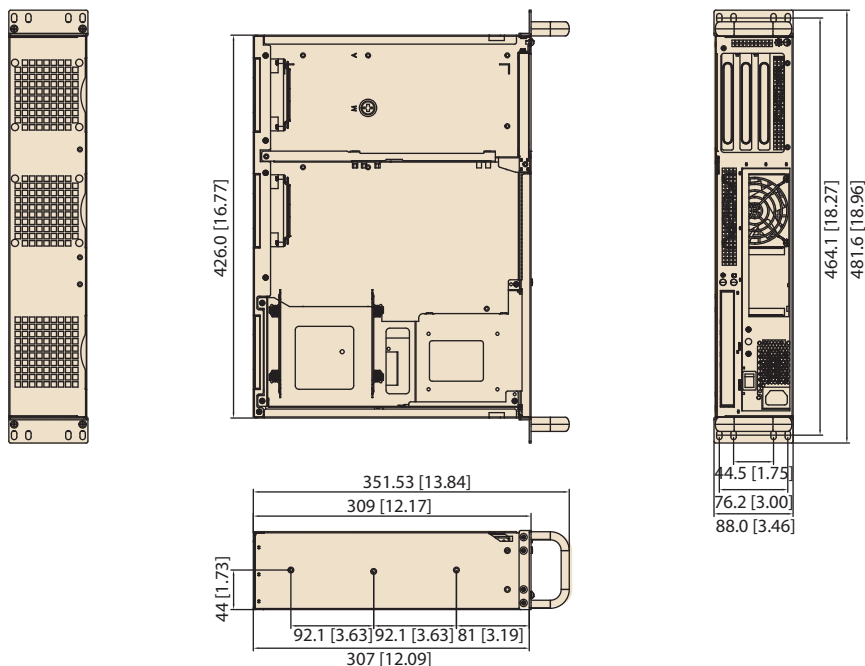

Unit: mm [inch]

## Ordering Information

Part Number	Power Supply	Wattage	Type	Input
IPC-603MB-35BE	PS8-350FATX-XE	350W	Single	AC 100 ~ 240 V full range

## Optional Accessories

Part Number	Description
96CB-SATAPOWER-6P2	SATA power wire 6-pin to big 4-pin (for slim ODD)

## Spare Parts

Part Number	Description
2130004795S000	Fan filter 80 x 85 x 5 mm

# Mouser Electronics

Authorized Distributor

Click to View Pricing, Inventory, Delivery & Lifecycle Information:

[Advantech:](#)

[IPC-603MB-35BE](#)