

EAO – Your Expert Partner for Human Machine Interfaces

K14-131.211081 - Illuminated pushbutton

K14-131.211081 - Illuminated pushbutton



Attention: The preview is based on a sample product. This can differ from your current configuration.

Mounting

| | |
|------------------|-----------|
| Design | flush |
| Mounting cut-out | Ø 30,5 mm |

Front

| | |
|-----------------|---------|
| Front dimension | Ø 35 mm |
| Front shape | round |

Other Attributes

| | |
|-------------------|--------------|
| Weight | 0.031 kg |
| Operation current | 4/7 mA ±15 % |
| Operating voltage | 24 V AC/DC |

Operating-/Indication part

| | |
|-------------------|--------------|
| Lens illumination | illuminative |
| Lens colour | green |
| Lens material | Plastic |
| Lens optics | transparent |
| Lens profile | flush |

IP-Rating

| | |
|------------------|------|
| Front protection | IP67 |
|------------------|------|

Connection Method

| | |
|----------|-----------------------------|
| Terminal | Solder/Plug-in 2.8 x 0.8 mm |
|----------|-----------------------------|

Actuator

| | |
|------------------|-----------|
| Switching action | Momentary |
| Housing colour | black |
| Housing material | Plastic |

Switching element

| | |
|-------------------|-------------------------------|
| Switching system | Snap-action switching element |
| Switching current | 5 A |
| Contacts | 1 NC + 1 NO |
| Contact material | |
| Switching voltage | 250 V AC |

Illumination

| | |
|------------|-------|
| LED colour | green |
|------------|-------|

Function

| |
|------------------------|
| Illuminated pushbutton |
|------------------------|

EAO – Your Expert Partner for Human Machine Interfaces

K14-131.211081 - Illuminated pushbutton

Dimensions

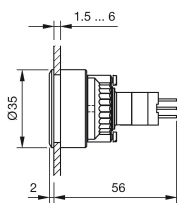

Mounting cut-outs

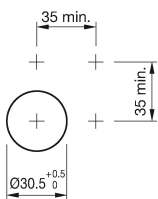

Wiring diagram

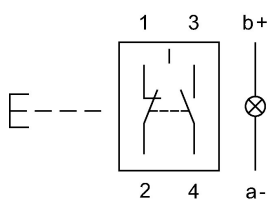

Legend

Contacts: NC = Normally closed, NO = Normally open

Mouser Electronics

Authorized Distributor

Click to View Pricing, Inventory, Delivery & Lifecycle Information:

EAO:

[K14-131.211081](#)