

# EAO – Your Expert Partner for Human Machine Interfaces

K14-040.210021 - Indicator

## K14-040.210021 - Indicator



*Attention: The preview is based on a sample product. This can differ from your current configuration.*

### Mounting

Design	flush
Mounting cut-out	Ø 30,5 mm

### Front

Front dimension	Ø 35 mm
Front shape	round

### Other Attributes

Weight	0.031 kg
Operation current	7/14 mA ±15 %
Operating voltage	24 V AC/DC

### Operating-/Indication part

Lens illumination	illuminative
Lens colour	yellow
Lens material	Plastic
Lens optics	transparent
Lens profile	raised

### IP-Rating

Front protection	IP67
------------------	------

### Connection Method

Terminal	Solder/Plug-in 2.8 x 0.8 mm
----------	-----------------------------

### Actuator

Housing colour	black
Housing material	Plastic

### Illumination

LED colour	yellow
------------	--------

### Function

Indicator
-----------

# EAO – Your Expert Partner for Human Machine Interfaces

K14-040.210021 - Indicator

## Dimensions

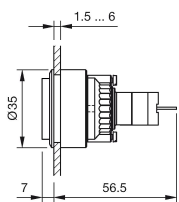

## Mounting cut-outs

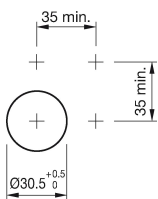

## Wiring diagram



# Mouser Electronics

Authorized Distributor

Click to View Pricing, Inventory, Delivery & Lifecycle Information:

EAO:

[K14-040.210021](#)