

# EAO – Your Expert Partner for Human Machine Interfaces

## 61-3440.4/D - Stop switch actuator

### 61-3440.4/D - Stop switch actuator

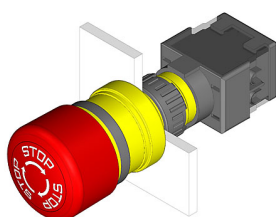

*Attention: The preview is based on a sample product. This can differ from your current configuration.*

#### Mounting

Mounting cut-out	Ø 16 mm
Design	raised

#### Front

Front shape	round
Front dimension	Ø 27 mm

#### Other Attributes

Marking	Arrows
Weight	0,02 kg

#### Operating-/Indication part

Lens material	Plastic
Lens colour	red
Lens profile	Mushroom
Lens illumination	non-illuminative
Lens optics	opaque

#### IP-Rating

Front protection	IP65
------------------	------

#### Actuator

Switching action	Maintained
Housing colour	yellow
Housing material	Plastic

#### Switching element

max. number of switching elements	1
-----------------------------------	---

#### Function

Stop switch
-------------

# EAO – Your Expert Partner for Human Machine Interfaces

61-3440.4/D - Stop switch actuator

## Dimensions

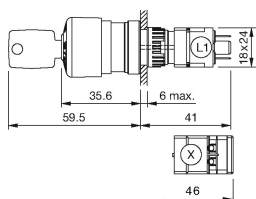

L1 = Solder/Plug-in terminal 2.8 x 0.5 mm

## Mounting cut-outs

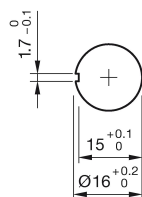

## Wiring diagram

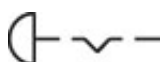

## Additional information

Twist to unlock clockwise  
Position indication ring black  
with metal fixing nut

## Legend

Switching action: C = Maintained

# Mouser Electronics

Authorized Distributor

Click to View Pricing, Inventory, Delivery & Lifecycle Information:

EAO:

[61-3440.4/D](#)