

EAO – Your Expert Partner for Human Machine Interfaces

18-257.035 - Pushbutton actuator

18-257.035 - Pushbutton actuator

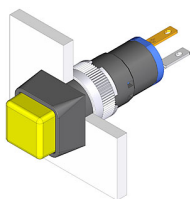

Attention: The preview is based on a sample product. This can differ from your current configuration.

Mounting

Mounting cut-out	Ø 8 mm
Design	raised

Front

Front dimension	9 mm x 9 mm
Front shape	square
Front bezel colour	black
Front bezel material	Plastic

Other Attributes

Weight	0,002 kg
--------	----------

Operating-/Indication part

Lens illumination	illuminative
-------------------	--------------

IP-Rating

Front protection	IP40
------------------	------

Connection Method

Terminal	Solder
----------	--------

Actuator

Switching action	Maintained
Housing colour	black
Housing material	Plastic

Switching element

Switching system	Snap-action switching element
Contacts	1 NO
Switching voltage	42 V AC/DC
Switching current	0.1 A
Contact material	

Function

Pushbutton

EAO – Your Expert Partner for Human Machine Interfaces

18-257.035 - Pushbutton actuator

Dimensions

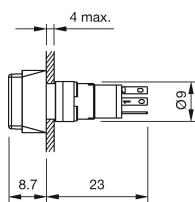

Mounting cut-outs

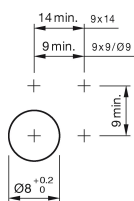

Wiring diagram

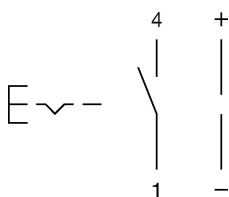

Component layout

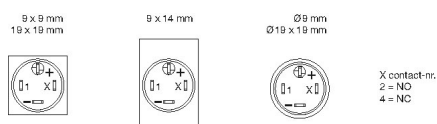

Additional information

+/- terminals are not connected

Legend

Contacts: NO = Normally open

Switching action: C = Maintained

Mouser Electronics

Authorized Distributor

Click to View Pricing, Inventory, Delivery & Lifecycle Information:

EAO:

18-257.035