

# EAO – Your Expert Partner for Human Machine Interfaces

## 18-237.035 - Pushbutton actuator

### 18-237.035 - Pushbutton actuator

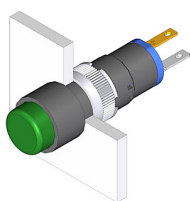

*Attention: The preview is based on a sample product. This can differ from your current configuration.*

#### Mounting

Mounting cut-out	Ø 8 mm
Design	raised

#### Front

Front dimension	Ø 9 mm
Front shape	round
Front bezel colour	black
Front bezel material	Plastic

#### Other Attributes

Weight	0,002 kg
--------	----------

#### Operating-/Indication part

Lens illumination	illuminative
-------------------	--------------

#### IP-Rating

Front protection	IP40
------------------	------

#### Connection Method

Terminal	Solder
----------	--------

#### Actuator

Switching action	Maintained
Housing colour	black
Housing material	Plastic

#### Switching element

Switching system	Snap-action switching element
Contacts	1 NO
Switching voltage	42 V AC/DC
Switching current	0.1 A
Contact material	

#### Function

Pushbutton
------------

# EAO – Your Expert Partner for Human Machine Interfaces

18-237.035 - Pushbutton actuator

## Dimensions

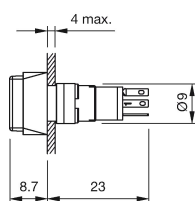

## Mounting cut-outs

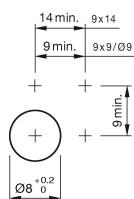

## Wiring diagram

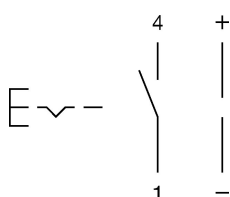

## Component layout

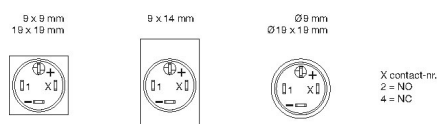

## Additional information

+/- terminals are not connected

## Legend

Contacts: NO = Normally open

Switching action: C = Maintained

# Mouser Electronics

Authorized Distributor

Click to View Pricing, Inventory, Delivery & Lifecycle Information:

EAO:

18-237.035