

EAO – Your Expert Partner for Human Machine Interfaces

82-6152.1000 - Pushbutton 22 mm stainless-steel

82-6152.1000 - Pushbutton 22 mm stainless-steel



Attention: The preview is based on a sample product. This can differ from your current configuration.

Mounting

Design	flush
Mounting cut-out	Ø 22,3 mm

Front

Front shape	round
Front ring shape	flush
Front dimension	Ø 25 mm
Front bezel material	Stainless steel

Other Attributes

Weight	0,018 kg
--------	----------

Operating-/Indication part

Lens optics	opaque
Lens material	Stainless steel
Lens colour	Stainless steel
Lens profile	flat
Lens illumination	non-illuminative

IP-Rating

Front protection	IP65, IP67
------------------	------------

Connection Method

Terminal	Screw terminal
----------	----------------

Actuator

Switching action	Momentary
------------------	-----------

Switching element

Switching current	3 A
Contact material	Silver
Contacts	1 C
Switching system	Snap-action switching element
Switching voltage	240 V AC/DC

Function

Pushbutton

EAO – Your Expert Partner for Human Machine Interfaces

82-6152.1000 - Pushbutton 22 mm stainless-steel

Dimensions

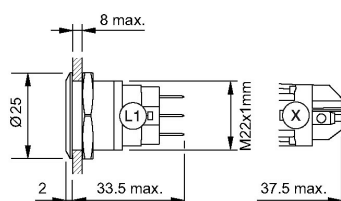

Mounting cut-outs



Wiring diagram

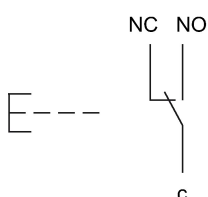

Component layout

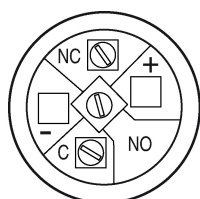

Legend

Switching action: B = Momentary

Contacts: C = Changeover

Mouser Electronics

Authorized Distributor

Click to View Pricing, Inventory, Delivery & Lifecycle Information:

EAO:

[82-6152.1000](#)