

EAO – Your Expert Partner for Human Machine Interfaces

704.102.0 - Selector switch actuator 2 positions, long lever

704.102.0 - Selector switch actuator 2 positions, long lever

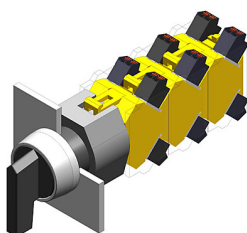

Attention: The preview is based on a sample product. This can differ from your current configuration.

Mounting

Mounting cut-out	Ø 22,3 mm
Design	raised

Front

Front dimension	Ø 29 mm
Front shape	round
Front bezel colour	grey
Front bezel material	Plastic

Other Attributes

Weight	0,034 kg
--------	----------

Operating-/Indication part

Lever material	Plastic
Lever colour	black
Switching angle	42° right
Lever illumination	non-illuminative
Lever shape	long

IP-Rating

Front protection	IP65
------------------	------

Actuator

Switching action	Rest - Momentary
------------------	------------------

Switching element

Rotary positions	2
max. number of switching elements	3

Function

Selector switch

EAO – Your Expert Partner for Human Machine Interfaces

704.102.0 - Selector switch actuator 2 positions, long lever

Dimensions

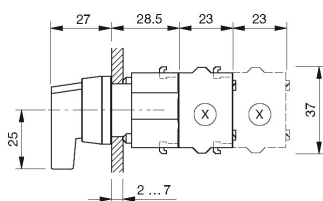

X = Screw terminal

Mounting cut-outs

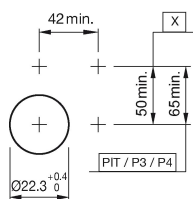

PIT = Push-in terminal

Wiring diagram



Switching positions

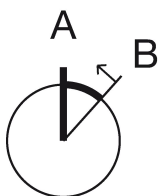

Additional information

Max. 3 switching elements can be clipped on

Legend

Switching action: A = Rest, B = Momentary

Mouser Electronics

Authorized Distributor

Click to View Pricing, Inventory, Delivery & Lifecycle Information:

EAO:

704.102.0