

## Basket

Your basket is empty.

## Product Configuration

**Product is incomplete****61-4210.0**Selector switch  
actuator 2 positions  
square

Save

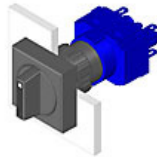

Attention: The preview is based on a sample product. This can differ from your current configuration.



## Additional Information

- illuminative
- If mounted with anti-twist device, the lug is on the left side
- Anti-twist ring not needed by using anti-twist device

## Information For Download

[Create datasheet](#)[Dimensions \(eps, 527.4 kB\)](#)[Mounting cut-outs \(eps, 713.1 kB\)](#)[Wiring diagram \(eps, 182.0 kB\)](#)[Tech. Data Serie.pdf \(435.8 kB\)](#)[3D Data](#)

## Specification

**Mounting**  
Mounting cut-out Ø 16 mm

**Other Attributes**  
Weight 0.006 kg

**Operating-/Indication part**  
Switching angle C = 90°

**IP-Rating**  
Front protection IP 65

**Actuator**  
Switching action Rest - Maintained

**Switching element**  
Rotary positions 2

**Function**  
Selector switch

**Legend**  
Switching action: A = Rest, C = Maintained

## Select Necessary Components

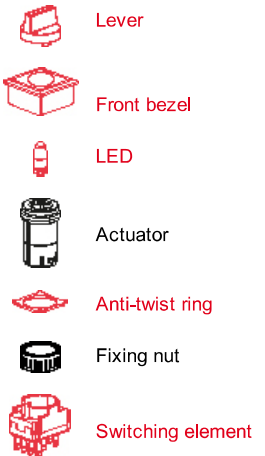

## Select Optional Accessories

# Mouser Electronics

Authorized Distributor

Click to View Pricing, Inventory, Delivery & Lifecycle Information:

EAO:

[61-4210.0](#)