

Illuminated pushbutton Ø 22 mm silver contact

82-6552.2123



<https://eao.com/p/82-6552.2123>

Your product:



82-6552.2123

Illuminated pushbutton Ø
22 mm silver contact

FRONT

Front dimension:	Ø 25 mm
Front form:	round
Front bezel material:	Aluminium
Front bezel shape:	flush

MOUNTING

Mounting cut-out:	Ø 22 mm
Mounting type:	Panel mounting

OPERATING-/INDICATION PART

Lens colour:	Nature
Lens material:	Aluminium
Lens illumination:	illuminative
Lens shape:	flush
Lens optics:	opaque
Illumination colour:	Blue
Shape of illumination:	Ring

ELECTRICAL CHARACTERISTICS

Contacts:	1 C
Operating voltage:	12 V AC/DC
Operation current:	7 mA

Switching voltage and switching current:

according to IEC 60947-5-1 (Silver contacts)		
Service categorie AC-15		
Voltage		Current
24 VAC		1 A
35 VAC		1 A (M12 versio
110 VAC		1 A
220 VAC		0.5 A
Switch rating DC service categorie DC-13 (Silver contacts)		
Voltage		Current
24 VDC		0.7 A
35 VDC		0.5 A (M12 vers
110 VDC		0.2 A
220 VDC		0.1 A

according to UL 508 (Silver contacts)

$\cos\phi$ 0,75 ... 0,8

Voltage	Current
120 VAC	5 A
240 VAC	3 A
24 VAC	1 A

Rated Operational Voltage Ue:

250 VAC

Rated insulation voltage Ui:

250 V

Switching rating:

240 V AC @ 3 A

Electrical lifetime:

50 000 cycles of operation

Electric strength:

1500 VAC, 50 Hz 1 minute between life terminals and ground

Pollution degree:

2, according to EN IEC 60947-1

Thermal current Ith:

5 A

MECHANICAL CHARACTERISTIC**Terminal:**

Screw terminal

Contact material:

Silver

Switching action:

Maintained

Switching system:

Snap-action switching element

Mechanical lifetime:

500 000 cycles of operation

Operating force:

4 N ... 7 N

Operating Travel:

ca. 3 mm

Tightening torque:

0.5 ... 0.6 Nm, Screw terminal 0.1 Nm

Weight:

0.018 kg

AMBIENT CONDITION**IP front protection:**

IP65, IP67

Operating temperature:

– 30 °C ... + 70 °C

Storage temperature:

– 40 °C ... + 80 °C

Shock resistance:

Max. 500 m / s² as per IEC 60068-2-27

Vibration resistance:

10 ... 500 Hz, amplitude 1.5 mm p-p according to IEC 60068-2-6

Climate resistance:

Damp heat, 21 days according to IEC 60512-11

CERTIFICATE

Approbations:

CB, CCC, C UL, UL

Conformities:

CE, 2011 / 65 / EC (RoHS), 2014 / 35 / EU (LVD)

REACH:

REACH compliant

RoHS:

RoHS compliant

OTHER

Short Description:

Illuminated pushbutton Ø 22 mm silver contact, Maintained, 240 V AC @ 3 A, 12 V AC/DC, 1 C, Screw terminal, round, Aluminium, Blue, Nature

Kind of illumination:

Single-LED

Wiring diagrams:

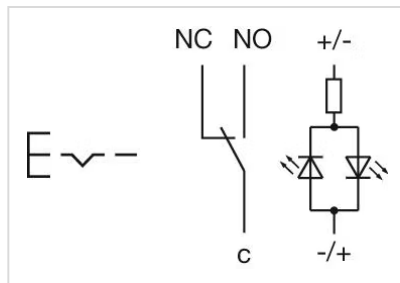

Component layouts:

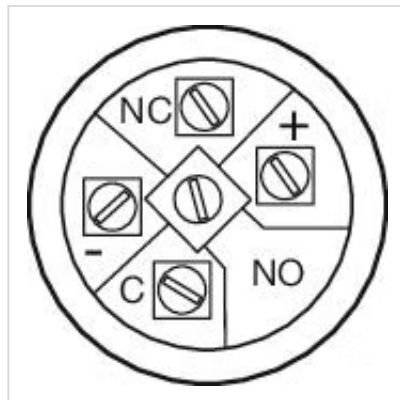

Mounting cut-outs:

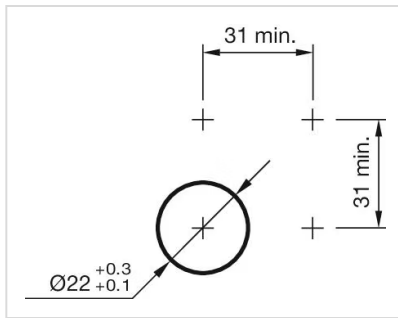



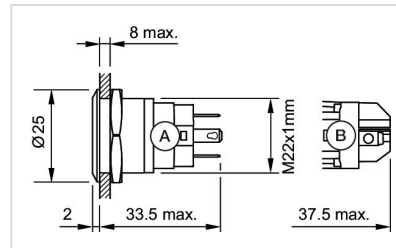







Dimension drawings:



A = Solder terminal
B = Screw terminal

Where to Buy

Distributor		Quantity in Stock		
	Farnell UK	10 in stock	Buy	
	Distrelec	10 in stock	Buy	
	element14 Singapore	10 in stock	Buy	
	DigiKey	5 in stock	Buy	
	RS UK	2 in stock	Buy	

Show more 

Powered by oemsecrets.com

Mouser Electronics

Authorized Distributor

Click to View Pricing, Inventory, Delivery & Lifecycle Information:

[EAO:](#)

[82-6552.2123](#)