

# Actuator

704.259.700



<https://eao.com/p/704.259.700>

Your product:

---



## 704.259.700 Actuator

### FRONT

|                       |               |
|-----------------------|---------------|
| Front dimension:      | 35 mm x 35 mm |
| Front form:           | square        |
| Front bezel colour:   | Black         |
| Front bezel material: | Plastic       |

### MOUNTING

|                   |                |
|-------------------|----------------|
| Design:           | flush          |
| Mounting cut-out: | 30 mm x 30 mm  |
| Mounting type:    | Panel mounting |

### OPERATING-/INDICATION PART

|                    |              |
|--------------------|--------------|
| Lens colour:       | Colourless   |
| Lens material:     | Plastic      |
| Lens illumination: | illuminative |
| Lens shape:        | flush        |
| Lens optics:       | transparent  |

### ELECTRICAL CHARACTERISTICS

|            |   |
|------------|---|
| Standards: | The switches comply with the "Standards for low-voltage switching devices" DIN EN 60947-1 |
|------------|---|

### MECHANICAL CHARACTERISTIC

|           |                |
|-----------|----------------|
| Terminal: | Screw terminal |
|-----------|----------------|

|                             |                             |
|-----------------------------|-----------------------------|
| <b>Switching action:</b>    | Maintained                  |
| <b>Mechanical lifetime:</b> | ≤3 Mio. cycles of operation |
| <b>Operating force:</b>     | 6.2 N                       |
| <b>Operating Travel:</b>    | ca. 5.8 mm ± 0.2 mm         |
| <b>Weight:</b>              | 0.051 kg                    |

## AMBIENT CONDITION

|                               |                     |
|-------------------------------|---------------------|
| <b>IP Protection:</b>         | IP65 front side     |
| <b>Operating temperature:</b> | – 40 °C ... + 55 °C |
| <b>Storage temperature:</b>   | – 40 °C ... + 85 °C |

## CERTIFICATE

|               |                 |
|---------------|-----------------|
| <b>REACH:</b> | REACH compliant |
| <b>RoHS:</b>  | RoHS compliant  |

## OTHER

|   |   |
|---|---|
| <b>Short Description:</b>                 | Actuator, 30 mm x 30 mm, 35 mm x 35 mm, flush, illuminative, Colourless, Plastic, transparent, square, Black, Plastic, Maintained, Screw terminal |
| <b>Housing colour:</b>                    | Black   |
| <b>Housing material:</b>                  | Plastic   |
| <b>Hints:</b>                             | Max. 3 switching elements can be clipped on, The lamp block will be delivered with screw terminal   |
| <b>max. number of switching elements:</b> | 3   |
| <b>Wiring diagrams:</b>                   |   |

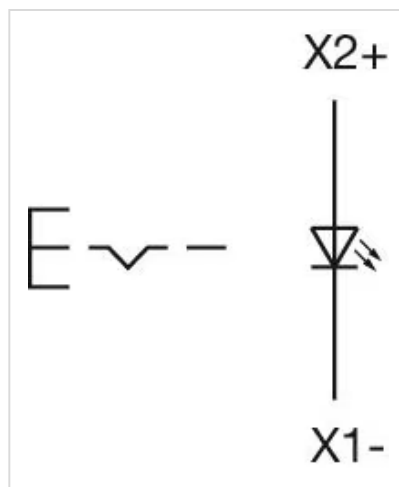

Mounting cut-outs:

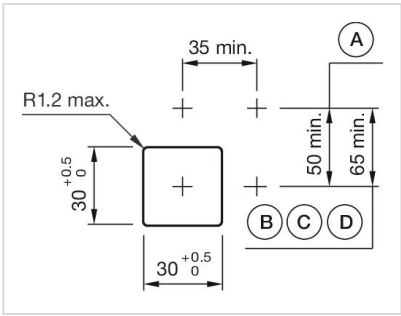





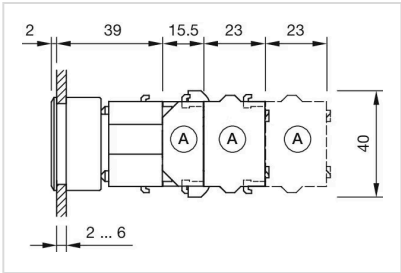

- A = Screw terminal
- B = Push-in terminal (PIT)
- C = Plug-in terminal 6.3 mm x 0.8 mm
- D = Double plug-in terminal 6.3 mm x 0.8 mm

Dimension drawings:



- A = Screw terminal

Where to Buy

| Distributor   |                    | Quantity in Stock |   |
|---|--------------------|-------------------|---|
|  | Digi-Key           | 9 in stock        | <div>Buy</div> |
|  | Mouser Electronics | 0 in stock        | <div>Buy</div> |
|  | Sager              | 0 in stock        | <div>Buy</div> |
|  | RS Americas        | 0 in stock        | <div>Buy</div> |

# Mouser Electronics

Authorized Distributor

Click to View Pricing, Inventory, Delivery & Lifecycle Information:

[EAO:](#)

[704.259.700](#)