

Actuator

704.066.2

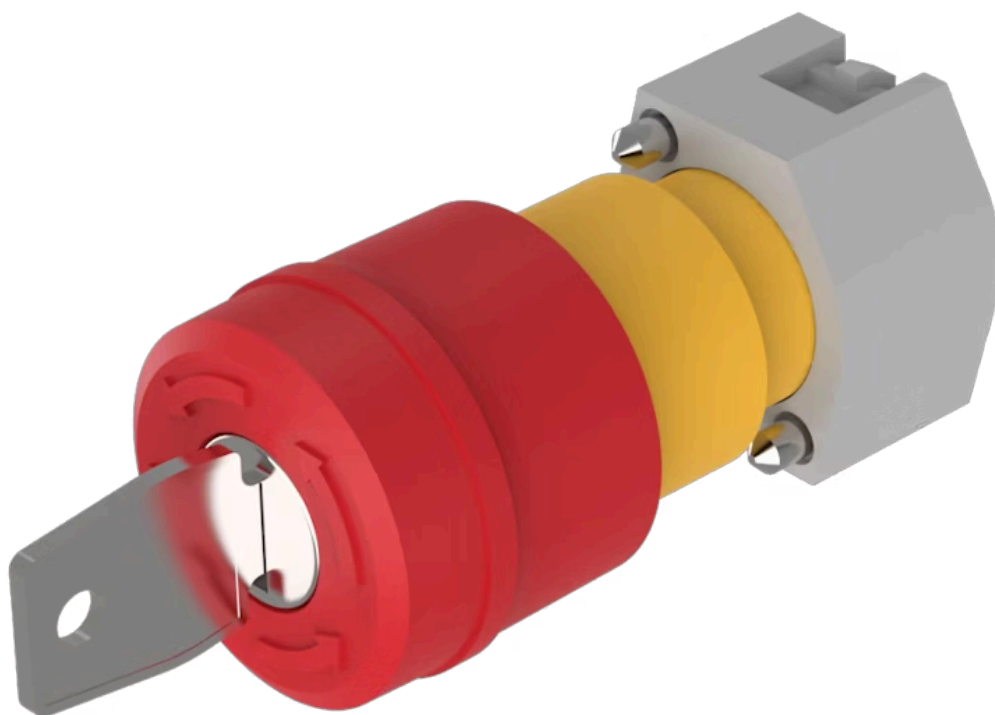

<https://eao.com/p/704.066.2>

Your product:



704.066.2 Actuator

FRONT

Front dimension: Ø 37 mm

Front form: round

MOUNTING

Design: raised

Mounting type: Panel mounting

OPERATING-/INDICATION PART

Lens colour: Red

Lens material: Plastic

Lens illumination: non illuminative

Lens shape: mushroom-head

Lens optics: opaque

ELECTRICAL CHARACTERISTICS

Standards: The switches comply with the “Standards for low-voltage switching devices” DIN EN 60947-1

MECHANICAL CHARACTERISTIC

Switching action: Maintained

Mechanical lifetime: ≤50 000 cycles of operation

Operating force: 8 N

Operating Travel: ca. 5.8 mm ± 0.2 mm

Weight: 0.3 kg

AMBIENT CONDITION

IP Protection: IP65 front side

Operating temperature: – 40 °C ... + 55 °C

Storage temperature: – 40 °C ... + 85 °C

CERTIFICATE

REACH: REACH compliant

RoHS: RoHS compliant

OTHER

Short Description: Actuator, Ø 37 mm, mushroom-head, non illuminative, Red, Plastic, opaque, round, Maintained

Housing colour: Yellow

Housing material: Plastic

Marking: Arrows

Hints: Shaft yellow

max. number of switching elements: 2

Wiring diagrams:



Mounting cut-outs:

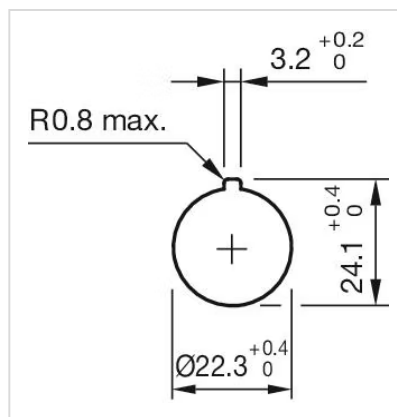



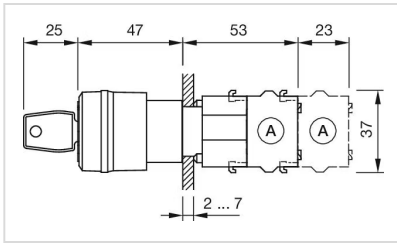







Dimension drawings:



A = Screw terminal

Where to Buy

Distributor		Quantity in Stock	
	Distrelec	25 in stock	Buy 
	Digi-Key	10 in stock	Buy 
	RS UK	10 in stock	Buy 
	Transfer Multisort Elektronik	5 in stock	Buy 
	Mouser Electronics	3 in stock	Buy 

[Show more](#) 

Mouser Electronics

Authorized Distributor

Click to View Pricing, Inventory, Delivery & Lifecycle Information:

[EAO:](#)

[704.066.2](#)