

Actuator

61-1220.0

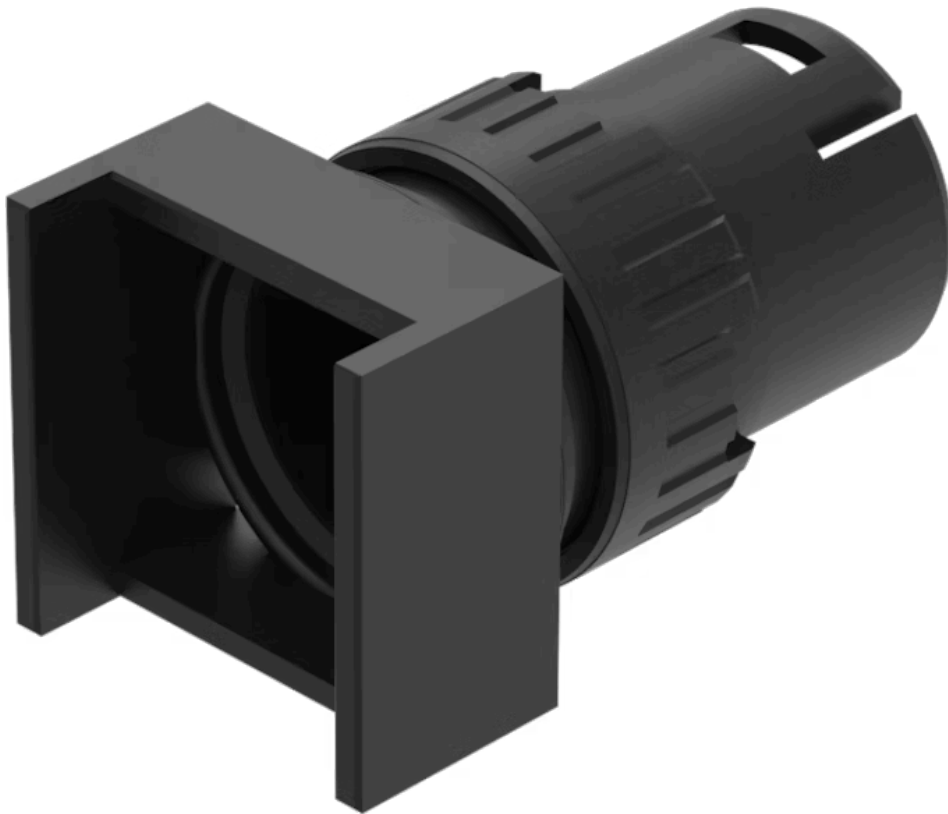

<https://eao.com/p/61-1220.0>

Your product:



61-1220.0 Actuator

FRONT

Front dimension:	18 mm x 18 mm
Front form:	square
Front bezel colour:	Black
Front bezel material:	Plastic

MOUNTING

Mounting cut-out:	Ø 16 mm
Mounting type:	Panel mounting

OPERATING-/INDICATION PART

Lens illumination:	illuminative
--------------------	--------------

MECHANICAL CHARACTERISTIC

Switching action:	Maintained
Mechanical lifetime:	According to DIN/IEC 60512-5-6 and EN/IEC 60947-5-1, 1 Mio. cycles of operation
Operating force:	3 N ... 5 N snap-action switching element, 3.5 ... 11 N slow-make switching element
Operating Travel:	3 mm
Tightening torque:	Max. 0.5 Nm
Weight:	0.005 kg

AMBIENT CONDITION

IP Protection:	IP40 rear side, according to EN IEC 60529, IP67 front side, according to EN IEC 60529
Operating temperature:	– 25 °C ... + 55 °C
Storage temperature:	– 40 °C ... + 85 °C

CERTIFICATE

REACH:	REACH compliant
RoHS:	RoHS compliant

OTHER

Short Description:	Actuator, Ø 16 mm, 18 mm x 18 mm, illuminative, square, Black, Plastic, Maintained
Internal size:	15,3 mm x 15,3 mm
Housing colour:	Black
Housing material:	Plastic, according to UL 94 V0, self-extinguishing
Wiring diagrams:	

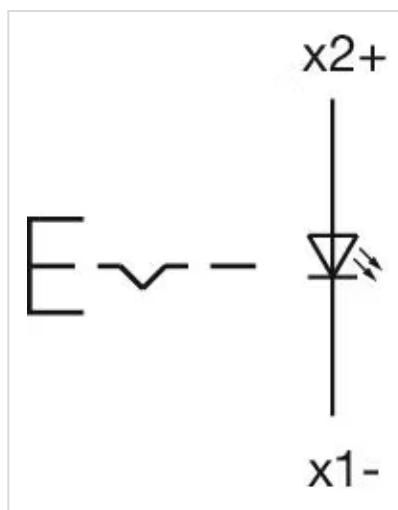

Mounting cut-outs:

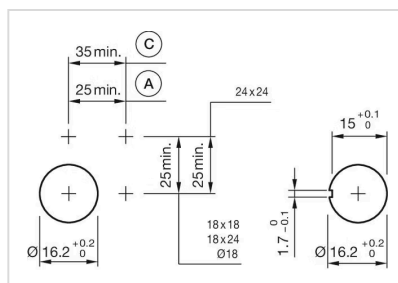





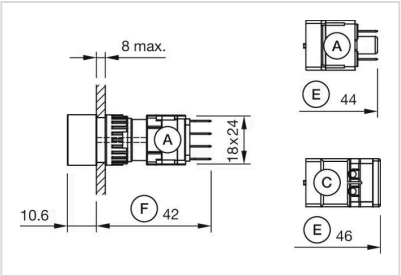



A = Solder/Plug-in terminal 2.8 mm x 0.5 mm
C = Screw terminal

Dimension drawings:



A = Plug-in terminal 2.8 mm x 0.5 mm
C = Screw terminal
E = Slow-make switching element
F = Snap-action switching element

Where to Buy

Distributor		Quantity in Stock	
	RS UK	32 in stock	<div>Buy</div>
	Mouser Electronics	24 in stock	<div>Buy</div>
	Digi-Key	24 in stock	<div>Buy</div>
	Transfer Multisort Elektronik	9 in stock	<div>Buy</div>
	Distrelec	8 in stock	<div>Buy</div>

Show more +

Mouser Electronics

Authorized Distributor

Click to View Pricing, Inventory, Delivery & Lifecycle Information:

[EAO:](#)

[61-1220.0](#)