

Actuator

44-745.20-
10K1

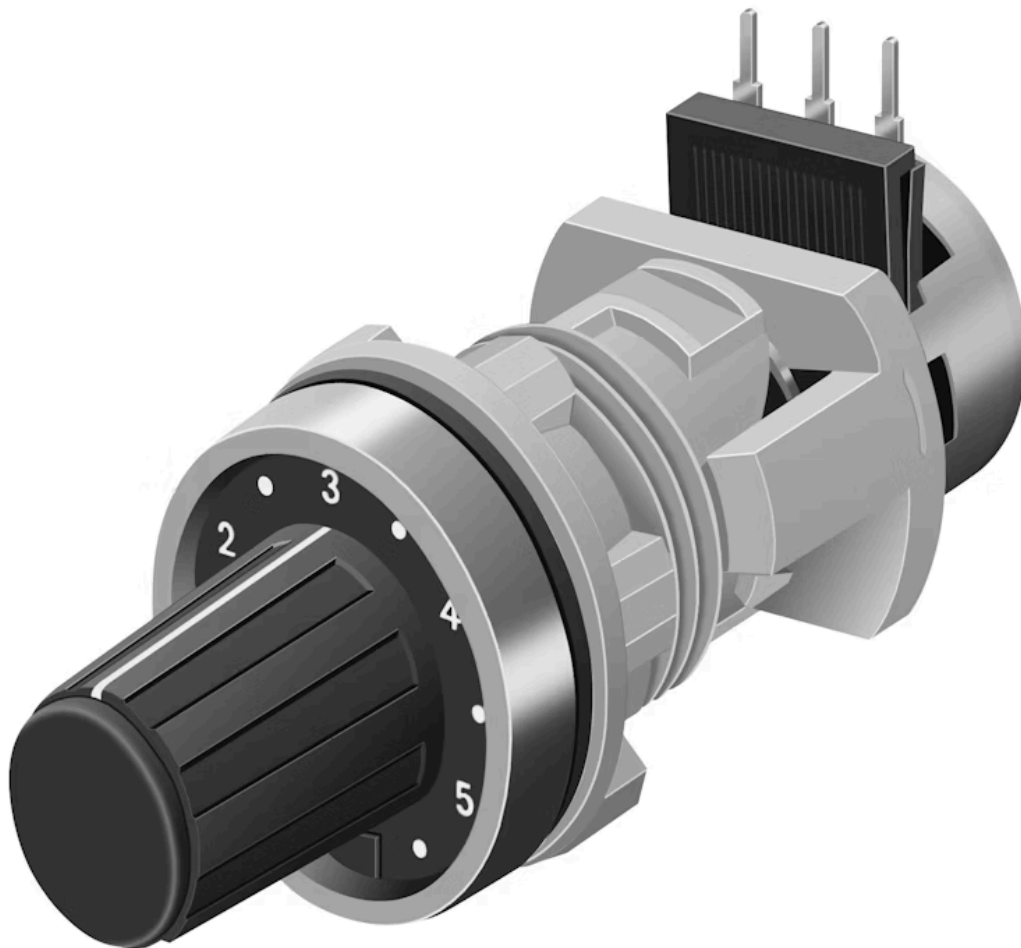

<https://eao.com/p/44-745.20-10K1>

Your product:



44-745.20-10K1 Actuator

FRONT

Front bezel material: Metal

MOUNTING

Mounting type: Panel mounting

ELECTRICAL CHARACTERISTICS

Resistance: 10 kΩ

MECHANICAL CHARATERISTIC

Terminal: Soldering terminal

Weight: 0.03 kg

CERTIFICATE

REACH: REACH compliant

RoHS: RoHS compliant

OTHER

Short Description: Actuator, Metal, matt chrome, Soldering terminal

Housing material: Plastic

Wiring diagrams:

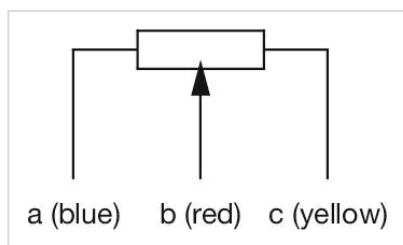

A = blue
B = red
C = yellow

Mounting cut-outs:

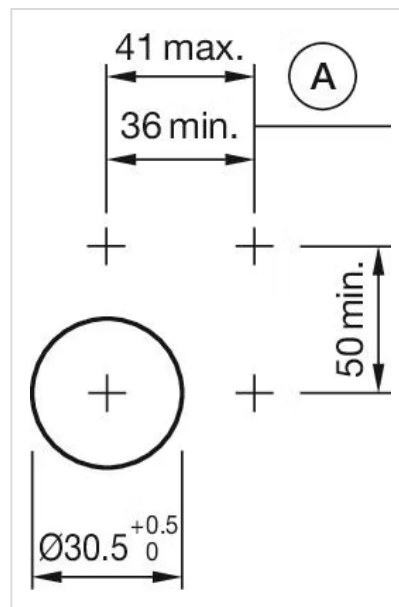
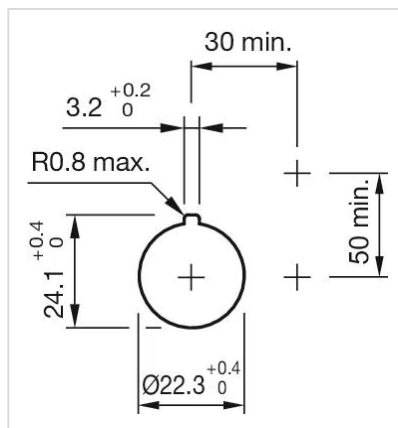





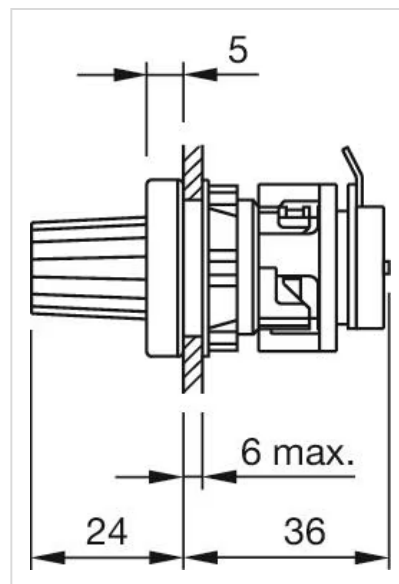
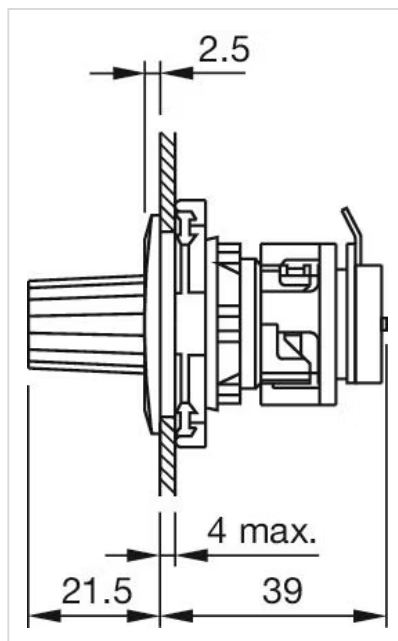

A = Action range of aligning pins

Dimension drawings:



Where to Buy

	Distributor	Quantity in Stock	
	Mouser Electronics	1 in stock	Buy 
	RS Americas	1 in stock	Buy 
	Digi-Key	0 in stock	Buy 

Powered by oemsecrets.com

Mouser Electronics

Authorized Distributor

Click to View Pricing, Inventory, Delivery & Lifecycle Information:

[EAO:](#)

[44-745.20-10K1](#)