

## MOMENTARY ACTION

The PE2 with solder termination is qualified under MIL-PRF-8805/99. The PE2 is a rugged sealed switch; it meets high shock and vibration requirements and is ideal for tough environments. A variety of button colors and easy panel mounting options are provided. The PE2 is a momentary 2 circuit or DPDT, and has a 2A resistive 1.5A inductive 28VDC/115VAC rating. Splashproof with panel seal dress ring per MIL-PRF-8805, symbol 6.

### Features:

- MIL-PRF-8805/99 qualified
- Momentary snap-action
- Black, white or red button colors available
- Splashproof
- RoHS compliant



### Standard Characteristics/Ratings:

#### ELECTRICAL RATINGS:

Load	Sea Level @ 28VDC or 115VAC, 60/400Hz	70,000 feet @ 28VDC or 115VAC, 60/400Hz
Resistive	2A	2A
Inductive	1.5A	1.5A
Lamp	0.5A	0.5A
DWV	1000Vrms	500Vrms

**Electrical Life:** 25,000 cycles at full load

**Mechanical Life:** 50,000 cycles

**Seal:** Splashproof with panel seal dress ring per MIL-PRF-8805, symbol 6

**Operating Temp Range:** -55°C to +85°C

**Operating Force:** 4.5 lbs. +/- 1.5 lbs.

**Total Travel:** 0.176 inches max

#### MATERIALS:

**Case:** Anodized aluminum alloy, black

**Button:** Thermoplastic

**Terminals:** Brass, silver plate

**Mounting Hardware:** Hex nut, lockwasher, keying washer, dress ring with O-ring seal, panel gasket when applicable

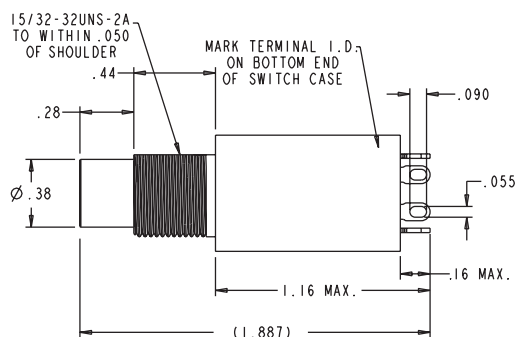
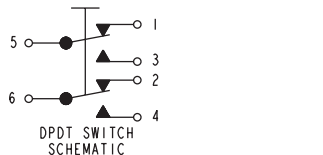
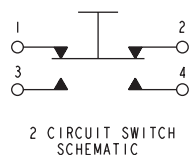
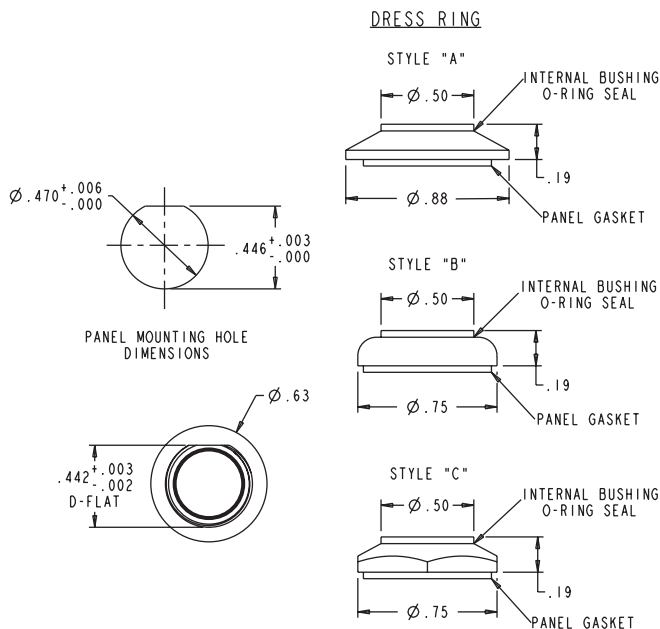

### PE2 PART NUMBER CODE

Dress Ring	Switch Action	Circuit Type	Button Color	Terminal Type
PE2 - X	X	X	X	X
1. Style A 2. Style B 3. Style C	1. Momentary	1. 2 Circuit 2. DPDT	1. Red 2. Black 3. White	1. Solder Lug

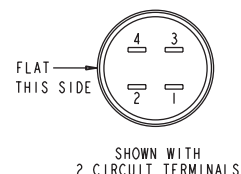
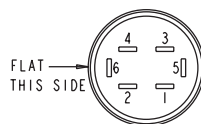

# Mouser Electronics

Authorized Distributor

Click to View Pricing, Inventory, Delivery & Lifecycle Information:

[OTTO:](#)

[PE2-31211](#) [PE2-31131](#) [M8805/99-011](#) [M8805/99-025](#) [M8805/99-027](#) [M8805/99-009](#)