

ILLUMINATED & SEALED PUSHBUTTONS

LP3
ILLUMINATED
PUSHBUTTONS

MOMENTARY ACTION COMMERCIAL GRADE LED ILLUMINATED & SEALED

Raised Dome



Front Mount



The LP3 offers rugged, sealed construction with the added benefit of reliable LED illumination. This precision snap-action switch is designed for use in off-highway, material handling, industrial controls, marine, medical and demanding commercial applications. Choose from the standard mounting styles and electrical ratings, or contact us for custom configurations.

On sealed models, a silicone boot operating on our patented "rolling sleeve" principle protects the contact area against contamination at the button area. This boot provides long life and smooth operation over a wide temperature range. Sealed terminals protect the contact area from hostile environments and solder flux on both sealed and unsealed models.

High contact pressure, amazingly low contact resistance and extremely low contact bounce are all the result of the OTTO snap-action mechanism. Extra long electrical life and precise trip point offer added value and precision operation.

Features:

- Watertight to IP68S or moistureproof & dusttight to IP64
- LED lighted with the ability to accommodate 2, 6, 12 & 24VDC power & includes reverse voltage protection
- Tall & dome style buttons permitting sublimated & pad printed legends
- Less than 25mΩ contact resistance, low level option
- Quick disconnect terminals
- 15/32" & 5/8" thread, press fit & dome case options
- RoHS/WEEE/Reach compliant

Standard Characteristics/Ratings:

ELECTRICAL RATINGS:

Load	Sea Level @ 28VDC or 115VAC, 60/400Hz
Resistive	5A
Inductive	3A
Lamp	1A
Motor	3A
DVV	1050Vrms through switch contacts only
Low Level	10mA @ 30mV

Electrical Life: 25,000 cycles

LIGHTING:

Light Source Voltage (DC)	Actual Voltage Nominal (DC)	Voltage Max (DC)
2	2	2.6
6	7	8
12	13.5	14.5
24	28	28.6

Mechanical Life: 250,000 cycles @ +85°C
25,000 cycles @ -40°C

Seal: IP64 or IP68S

Operating Temp Range: -40°C to +85°C

Operating Force: 2.5 +/- .5 lbs. or 5.0 +/- 1.0 lb.

Total Travel: 0.080 inches max

Overtravel: 0.010 inches min

MATERIALS:

Case: Anodized aluminum alloy

Button: Thermoplastic

Terminals: Standard and low level options available

Mounting Hardware: Hex nut, lockwasher and panel gasket when applicable

LP3 PART NUMBER CODE

Case Style	Circuit Rating	Light Source Type* w/ Rev. Pol Protection	Seal Level	Operating Force	Case Color	Button Color	Legend Style
E. Exposed Dome	1. SPST N.O./Std.	A. 2V Red LED	1. Unsealed	2. 2.5 ± .5 lbs.	1. Silver	A. Amber, Translucent (use Amber LED)	Refer to Legend Table for legend codes in Appendix. Legends will be printed in white on amber and red buttons and in black on white buttons.
F. Flush Dome	2. SPST N.C./Std.	B. 2V Green LED	2. Dusttight	5. 5.0 ± 1 lbs.	2. Black	R. Red, Translucent (use Red LED)	
R. Raised Dome	3. SPDT 2 Circuit/Std.	C. 2V Amber LED	3. Watertight			W. White, Translucent	
1. Press Fit Mount	4. SPST N.O./Low Level	D. 6V Red LED					
3. 5/8" Thread Front Mount	5. SPST N.C./Low Level	E. 6V Green LED					
4. 15/32" Thread Rear Mount	6. SPDT 2 Circuit/Low Level	F. 6V Amber LED					
6. 5/8" Thread Rear Mount		G. 12V Red LED					
		H. 12V Green LED					
		J. 12V Amber LED					
		K. 24V Red LED					
		L. 24V Green LED					
		M. 24V Amber LED					
		N. 2V Blue LED					
		P. 6V Blue LED					
		Q. 12V Blue LED					
		R. 24V Blue LED					
		S. 2V Deep Green LED					
		T. 6V Deep Green LED					
		U. 12V Deep Green LED					
		V. 24V Deep Green LED					

* For super bright LEDs, contact factory.

STOP HERE for
illuminated switches
without legends.

MOMENTARY ACTION COMMERCIAL GRADE LED ILLUMINATED & SEALED

LP3-E

Momentary, Exposed Dome Button

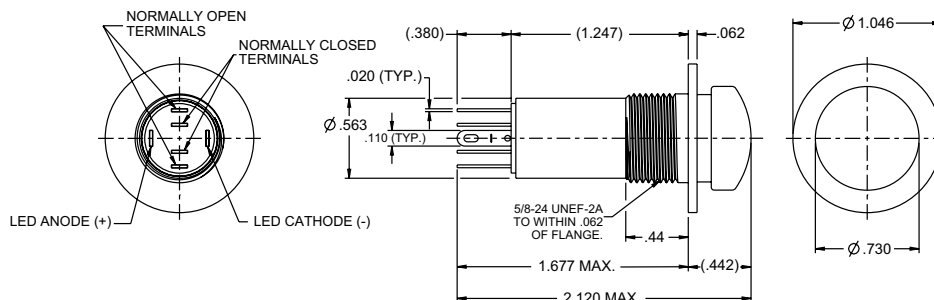
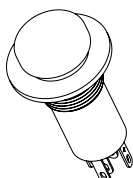

LP3-F

Momentary, Flush Dome Button

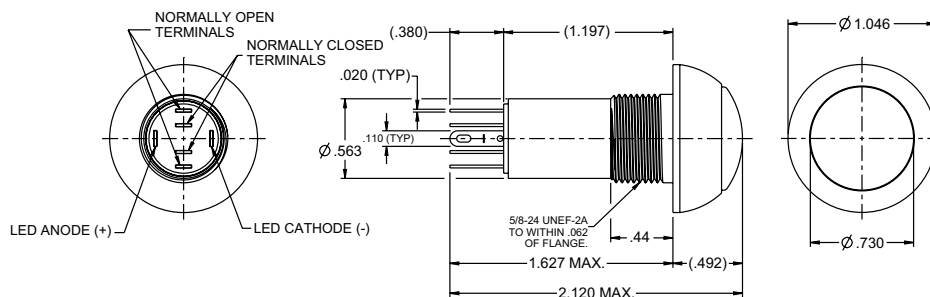
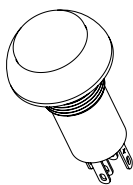

LP3-R

Momentary, Raised Dome Button

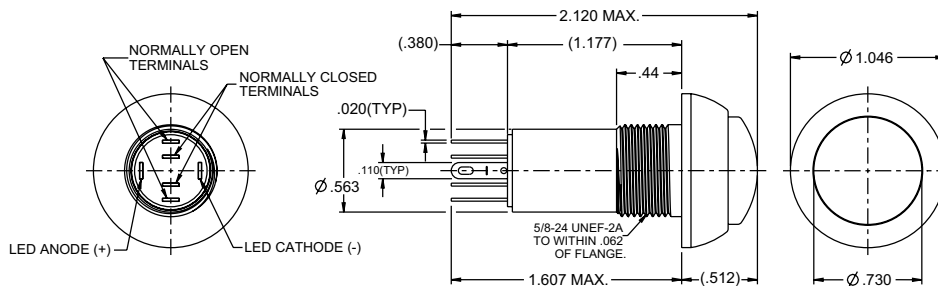
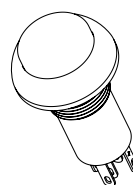

LP3-1

Momentary, Press Fit Mount

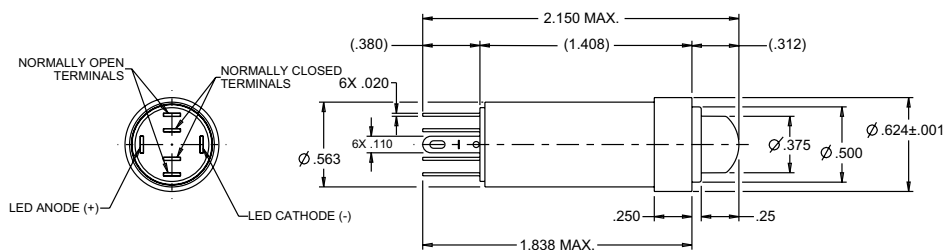
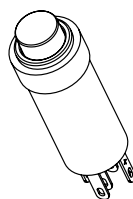

ILLUMINATED & SEALED PUSHBUTTONS

LP3
ILLUMINATED
PUSHBUTTONS

MOMENTARY ACTION COMMERCIAL GRADE LED ILLUMINATED & SEALED

LP3-3
Momentary, 5/8" Threaded Front Mount

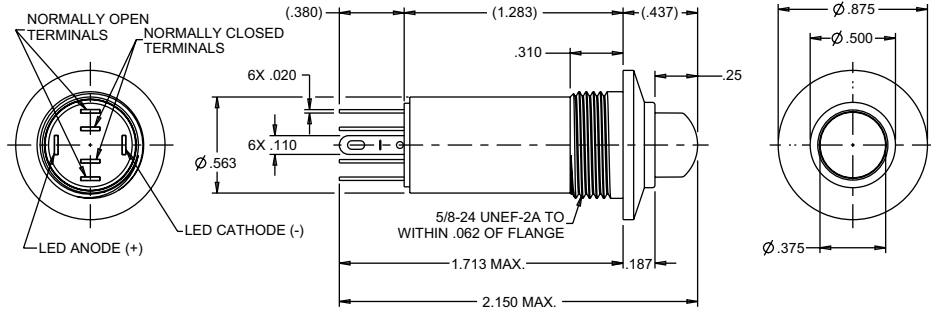
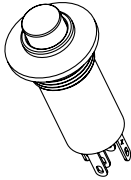

LP3-4
Momentary, 15/32" Threaded Rear Mount

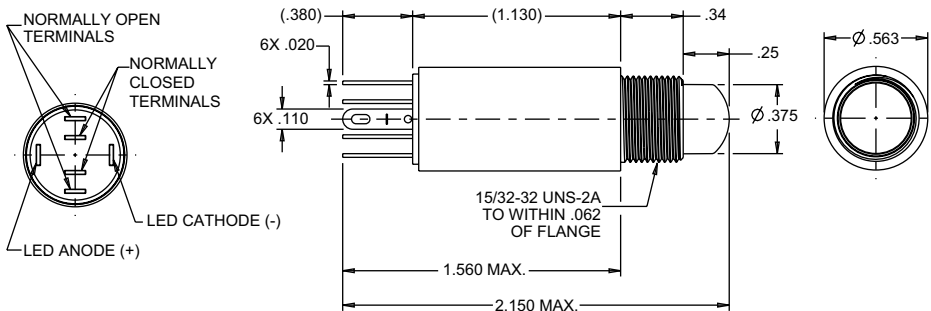
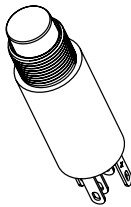

LP3-6
Momentary, 5/8" Threaded Rear Mount

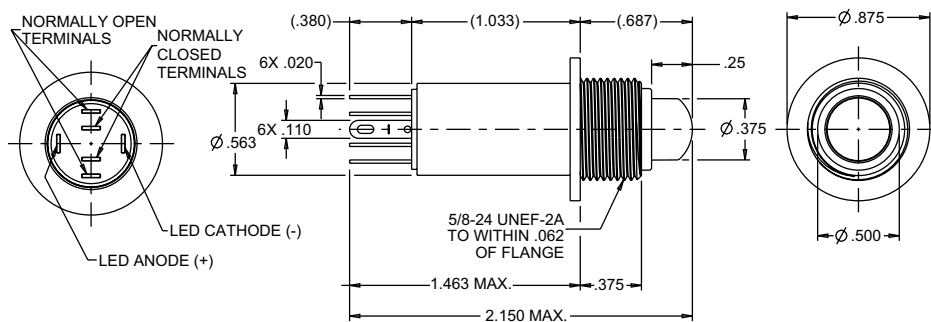
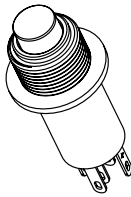

NOTE:
For indicator light only,
see LPL indicator light pages 105-107.

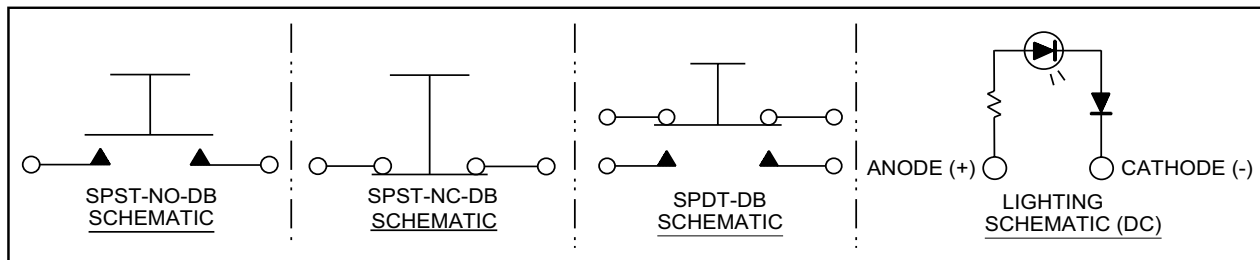

SNAP-IN PANEL MOUNTING

Standard Legends Per SAE Specifications

STANDARD LEGENDS PER SAE SPECIFICATIONS					
A1		ANCHOR	K2		UNLOCK
B1		BATTERY	L1		LIGHT
B2		ELECTRIC POWER	L2		MASTER LIGHTING SWITCH
C1		AC/COOLING SYSTEMS	L3		HEADLIGHTS
C2		DEHUMIDIFIER	L4		HEADLIGHTS-LOW / DIPPED BEAM
C3		HEATER/INTERIOR HEATING	L5		HEADLIGHTS-HIGH / UPPER BEAM
D1		WINDSHIELD DEFROSTER	L6		PARKING LIGHT
D2		REAR WINDOW DEFROSTER	L7		WORK LAMP
D3		MIRROR DEFROSTER	L8		WORK LAMP
E1		ENGINE/START	L9		INTERIOR DOME LIGHT
E2		ENGINE/STOP	M1		BEACON
E3		ON/START	M2		HAZARD/POSITION LIGHTS
E4		OFF/STOP	M3		CLEARANCE LIGHTS
E5	ON	ON	M4		SIDE MARKER LIGHT
E6	OFF	OFF	M5		RUNNING LIGHTS (UNDER POWER)
E7		ENGINE ELECTRIC PREHEAT	M6		ANCHOR LIGHT
E8		ENGINE-GAS INJECTION	M7		RUNNING/ANCHOR LIGHTS
F1		FRONT FOG LIGHTS	M8		SEARCH LIGHT
F2		REAR FOG LIGHTS	M9		LEFT TURN SIGNAL
G1		FUEL	MA		RIGHT TURN SIGNAL
H1		HORN	P1		BILGE PUMP #1
H2		HORN REAR	P2		BILGE PUMP #2
K1		LOCK	P3		BILGE PUMP #3
			P4		BILGE PUMP
P5		BILGE BLOWER	R1		LIFT
R2		LOWER	R3		UP
R4		DOWN	R5		RIGHT
R6		LEFT	R7	FWD	FORWARD
R8	REV	REVERSE	S1		RADIO
S2		MUTE	T1		FAST
T2		SLOW	T3		TRIM TAB / TRIMMING OPERATION
T4		TRANSMISSION	V1		VENTILATING / AC FAN
W1		WINDSHIELD WIPER	W2		WINDSHIELD-WASHER
W3		WINDSHIELD-WASHER/WIPER	W4		REAR WINDOW WIPER
W5		REAR WINDOW-WASHER	W6		REAR WINDOW-WASHER/WIPER
ZZ		NO LEGEND			

For legends not shown, please consult an OTTO representative.

Mouser Electronics

Authorized Distributor

Click to View Pricing, Inventory, Delivery & Lifecycle Information:

OTTO:

[LP3-33A122R](#)