

ATTRACTIVE & RUGGED FOR WET & DUSTY ENVIRONMENTS

The rugged P5-D switch is an alternate action "push on, push off" pushbutton switch with contoured dome styling. With two design versions, a flush dome and raised dome button profile, the P5-D offers excellent mechanical and electrical performance while operating under severe conditions found in demanding applications.

The P5-D features unsealed, dusttight, moistureproof and watertight seal options. A mechanical life of one million cycles, 25,000 cycles at full load.

The P5-D is a quality precision, snap-action switch designed for use in panels, instruments and other demanding applications where attractive, rugged pushbutton switches are required.

"Push On, Push Off" action



Flush Dome Button



## Features:

- 2 contoured button styles
- Button sealed with patented "rolling sleeve" principle
- Contact area sealed at case & terminals
- Less than 25mΩ contact resistance
- Handles low level up to 10 amps
- Moistureproof & dusttight to IP64 & MIL-PRF-8805 Design 2 or watertight to IP68S options
- Unsealed construction also available
- RoHS/WEEE/Reach compliant

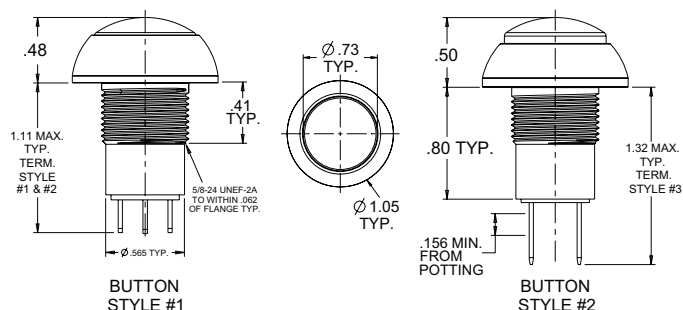

## Standard Characteristics/Ratings:

### ELECTRICAL RATINGS:

Load	Sea Level @ 28VDC or 115VAC, 60/400Hz
Resistive	10A
Inductive	5A
Lamp	1A
Motor	3A
DWV	1050Vrms
Electrical Life:	25,000 cycles
Mechanical Life:	1,000,000 cycles
Seal:	IP64 & MIL-PRF-8805 Design 2 or IP68S
Operating Temp Range:	-55°C to +85°C
Operating Force:	3.0 lbs. +1/-0.5 lb.
Total Travel:	0.180 inches max
Overtravel:	0.012 inches min

### MATERIALS:

Case:	Anodized aluminum alloy
Button:	Thermoplastic
Terminals:	Brass with gold over silver
Terminal Hardware:	Screws, lockwashers and terminal lugs for screw terminal option
Mounting Hardware:	Hex nut, lockwasher

### TERM. STYLES 1

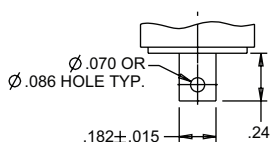

### TERM. STYLES 2

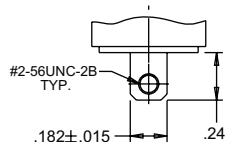

### TERM. STYLES 3

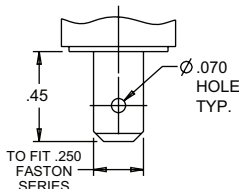

## P5-D PART NUMBER CODE

<b>P5-D</b>	<b>X</b>	<b>X</b>	<b>X</b>	<b>X</b>	<b>X</b>	<b>X</b>
<b>Button Style</b>	<b>Terminal Style/Rating</b>	<b>Circuit Form/Contact Material/Grade</b>	<b>Seal Level</b>	<b>Bezel Color</b>	<b>Button Color</b>	
1. Flush 2. Raised	1. Solder 2. Screw ① 3. 0.250" Quick Connect	1. SPST/Silver/Commercial 2. SPST/Gold/Commercial 3. SPDT/Silver/Commercial 4. SPDT/Gold/Commercial 5. SPST/Silver/Military Grade 6. SPST/Gold/Military Grade 7. SPDT/Silver/Military Grade 8. SPDT/Gold/Military Grade	1. Unsealed 2. Dusttight 3. Watertight	1. Clear 2. Black	1. Red 2. Black 3. Orange 4. Yellow 5. Green 6. Blue 7. Purple 8. Gray	

① Screw terminals available on SPST circuit forms only.

# Mouser Electronics

Authorized Distributor

Click to View Pricing, Inventory, Delivery & Lifecycle Information:

[OTTO:](#)

[P5-D135227](#)