

700231

REV	ECN #	DATE
U	B8168	07 NOV 18

## NOTES:

1. CHANGE OF MATERIAL IS NOT PERMITTED UNLESS APPROVED IN WRITING BY OTTO ENGINEERING PERSONNEL.
2. DRAWING TO BE INTERPRETED IN ACCORDANCE WITH THE CURRENT REVISION OF ASME Y14.5.
3. TSI TO BE INTERPRETED AS THEORETICAL SHARP INTERSECTION.
4. THIS PART/PRODUCT IS TO BE MANUFACTURED WITH THE LATEST APPLICABLE REGULATIONS OF EC DIRECTIVES FOR THE RESTRICTION OF THE USE OF HAZARDOUS SUBSTANCES IN ELECTRICAL AND ELECTRONIC EQUIPMENT (ROHS), WASTE ELECTRICAL AND ELECTRONIC EQUIPMENT (WEEE) AND REGISTRATION, EVALUATION, AUTHORIZATION AND RESTRICTION OF CHEMICALS (REACH).

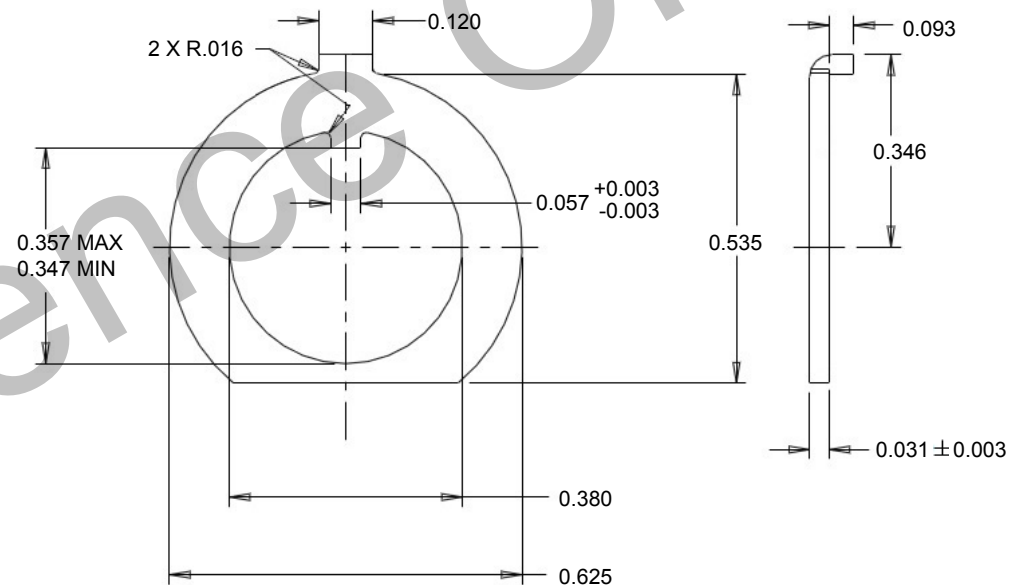

PROCESS:  
PASSIVATE PER SAE AMS 2700

MATERIAL:  
TYPE 304 STAINLESS STEEL  
PER SAE-AIR4127 & ASTM  
A 240/A 240M

**OTTO**  
CARPENTERSVILLE, ILLINOIS USA

DESCRIPTION

WASHER, KEY

UNLESS OTHERWISE SPECIFIED:  
DIMENSIONS ARE IN INCHES.  
TOLERANCES ARE AS LISTED.  
MUST BE FREE FROM BURRS  
AND SHARP EDGES.

TOLERANCES  
.XX ± .01  
.XXX ± .005  
ANGLES ± 1°  
SURFACES 64 MICROINCH  
DO NOT SCALE DRAWING.

THIS DOCUMENT IS THE CONFIDENTIAL  
PROPERTY OF OTTO ENGINEERING, INC..  
IT IS NOT TO BE USED IN ANY WAY  
DETRIMENTAL TO THE INTERESTS  
OF OTTO ENGINEERING, INC..

SIZE

A

FSCM NO

21649

DRAWING NO.

700231

REV.

U

THIRD ANGLE  
PROJECTION

Sheet 1 OF 1

# Mouser Electronics

Authorized Distributor

Click to View Pricing, Inventory, Delivery & Lifecycle Information:

[OTTO:](#)

[700231](#)