

## Pushbutton

- **Alarm systems**
- **Computers**
- **Detector switch application**



TERMINAL SEAL: Epoxy.

NOTE: Specifications and materials listed above are for switches with standard options. For information on specific and custom switches, consult Customer Service Center.

To order, simply select desired option from each category and place in the appropriate box. Available options are shown and described on pages A-68 and A-70. For additional options not shown in catalog, consult Customer Service Center.



[www.ckswitches.com](http://www.ckswitches.com)



# KM Series Subminiature Pushbutton Switches

## SWITCH FUNCTION

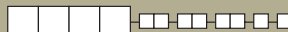

NO. POLES	MODEL NO.	SWITCH FUNCTION		CONNECTED TERMINALS		SCHEMATIC
		POS. 1	POS. 2	POS. 1	POS. 2	
SP	<b>KM11</b>	OFF	MOM.	OPEN	2-1	SPST N.O.
	<b>KM33</b>	ON	MOM.	2-1	OPEN	SPST N.C.
<b>SPST</b>						
SP	<b>KM12</b>	ON	MOM.	2-1	4-3	SPDT
<b>SPDT</b>						

## ACTUATOR



**02** .398" HIGH, .122" DIA.

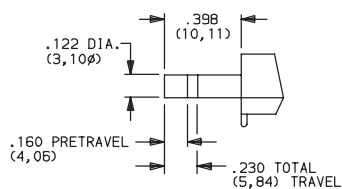

KM12 models only.

**01** .122" DIA.

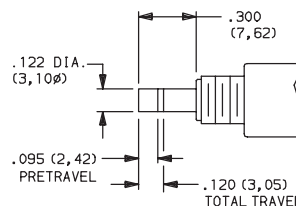

KM11 models only.

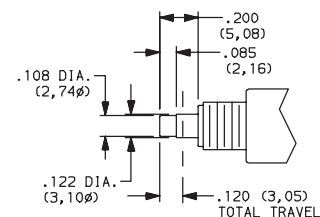

KM33 models only.

**NOTE:** Caps available for plunger options, see page A-70.



Dimensions are shown: Inches (mm)  
Specifications and dimensions subject to change

# KM Series Subminiature Pushbutton Switches



A  
Pushbutton

## BUSHING/ MOUNTING STYLE



**A** RIGHT ANGLE

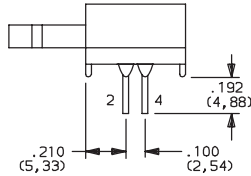

KM12 models only.

**RR** 1/4-40 THREAD, .225" HIGH

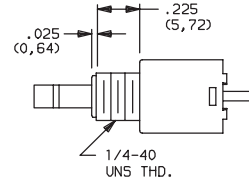

KM11 & KM33 models only.

### PANEL MOUNTING

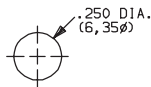

KM11 & KM33 models.

### PC MOUNTING

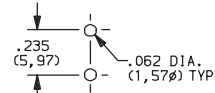

KM11 models only.

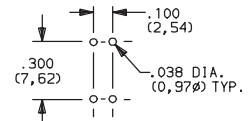

KM12 models only.

## TERMINATIONS



**05** .110" QUICK CONNECT

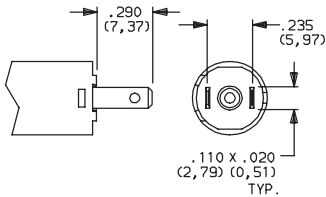

**08** RIGHT ANGLE, PC THRU-HOLE

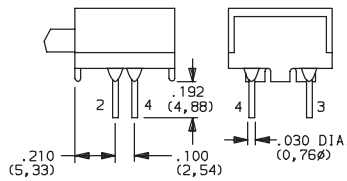

KM12 models only.

**02** PC THRU-HOLE

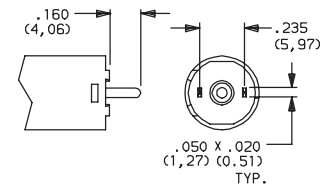

KM11 models only.

## CONTACT MATERIAL



OPTION CODE	RoHS COMPLIANT *	RoHS COMPATIBLE *	CONTACT AND TERMINAL MATERIAL	RATINGS	
<b>B</b>	YES	YES	GOLD <sup>1</sup>	LOW LEVEL/DRY CIRCUIT	0.4 VA MAX. @ 20 V AC OR DC MAX.
<b>Q</b>	YES	YES	SILVER <sup>2</sup>	POWER	0.25 AMPS @ 125 V AC OR DC (KM11, KM12) (UL) 1 AMP @ 125 V AC OR 28 V DC (KM33).

\* Note: See Technical Data section of this catalog for RoHS compliant and compatible definitions and specifications.

<sup>1</sup> STATIONARY CONTACTS & TERMINALS: Copper, with gold plate over nickel plate.  
MOVABLE CONTACT: Phosphor bronze or beryllium copper, with gold plate over nickel plate.

<sup>2</sup> STATIONARY CONTACTS & TERMINALS: Copper, silver plated (standard with all termination options).  
MOVABLE CONTACT: Phosphor bronze or beryllium copper, silver plated.

<sup>3</sup> STATIONARY CONTACTS & TERMINALS: Copper, with gold plate over nickel plate over silver plate.  
MOVABLE CONTACT: Phosphor bronze or beryllium copper, with gold plate over nickel plate over silver plate.

**NOTE:** Any models supplied with Q or B contact material are RoHS compliant.

KM11, KM12 models  when ordered with 'Q' contact material.

## SEAL



**NONE** NO SEAL

**E** EPOXY SEAL

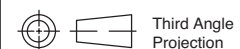
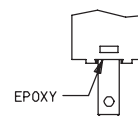

Dimensions are shown: Inches (mm)  
Specifications and dimensions subject to change

**C&K**



# KM Series Subminiature Pushbutton Switches

## AVAILABLE HARDWARE

A  
Pushbutton

Cap, KM33 models

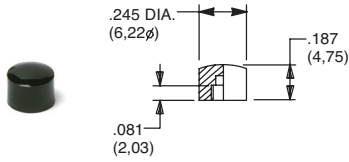

**PART NO.**

**785101000** WHITE  
**785102000** BLACK  
**785103000** RED

Material: Nylon  
Finish: Gloss

Cap, KM11 and KM12 models

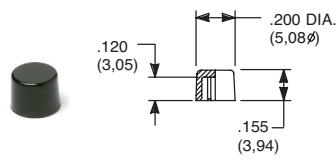

**PART NO.**

**708901000** WHITE  
**708902000** BLACK  
**708903000** RED

Material: Nylon  
Finish: Gloss

Cap, KM11 and KM12 models

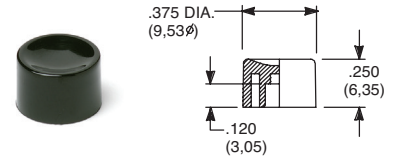

**PART NO.**

**752701000** WHITE  
**752702000** BLACK  
**752703000** RED

Material: Nylon  
Finish: Gloss

Cap, KM11 and KM12 models

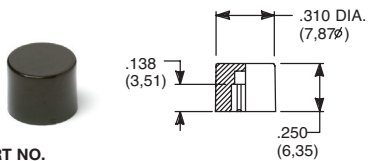

**PART NO.**

**801801000** WHITE  
**801802000** BLACK  
**801803000** RED

Material: Nylon  
Finish: Gloss

Cap, KM11 models

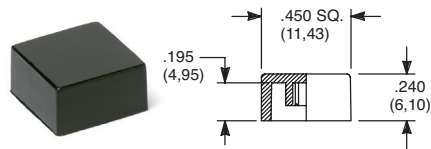

**PART NO.**

**484601000** WHITE  
**484602000** BLACK  
**484603000** RED

Material: Nylon  
Finish: Gloss

**PART NO.**

**798201000** WHITE  
**798202263** BLACK  
**798203000** RED

Material: Nylon  
Finish: Matte

**NOTE:** Other cap colors available, consult Customer Service Center.

# Mouser Electronics

Authorized Distributor

Click to View Pricing, Inventory, Delivery & Lifecycle Information:

## C&K Switches:

[KM1101RR02B](#) [KM1101RR02Q](#) [KM1101RR02QE](#) [KM1101RR05B](#) [KM1101RR05BE](#) [KM1101RR05Q](#)  
[KM3301RR05Q](#) [KM3301RR05QE](#) [KM3301RR05BE](#)