

D Series

Miniature Snap-in Power Rocker Switches

Features/Benefits

- **Momentary and maintained models**
- **PC and quick connect terminals**
- **Recessed bracket available — prevents accidental actuation**
- **RoHS compliant**
- **Gold plated options available**

Typical Applications

- **Small appliances**
- **Computers and peripherals**
- **Medical instrumentation**



UL 61058-1



Specifications

CONTACT RATING:

D101, D102, D103, D105, D108, D201, D202, D203

GP (general purpose)

4 AMPS 125 VAC 50/60 Hz T85 10,000 cycles

2 AMPS 250 VAC 50/60 Hz T85 10,000 cycles

R (resistive)

4 AMPS 30 VDC T85 10,000 cycles

D501, D502, D503, D508, D601, D602, D608

GP (general purpose)

10 AMPS 125 VAC 50/60 Hz T85 10,000 cycles

5 AMPS 250 VAC 50/60 Hz T85 10,000 cycles

R (resistive)

10 AMPS 30 VDC T85 10,000 cycles

0.4VA @ 20V AC/DC (gold plating) available upon request

ELECTRICAL LIFE: 10,000 make-and-break cycles at full load.

INSULATION RESISTANCE: $10^9 \Omega$ min.

DIELECTRIC STRENGTH: 1,000 Vrms min. @ sea level.

Materials

ACTUATOR & HOUSING: 6/6 nylon (UL 94V-2), color black, finish: matte.

MOVABLE CONTACTS: D10X and D20X Models: Copper, silver plated.
D50X and D60X Models: Coin silver, silver plated.

STATIONARY CONTACTS AND TERMINALS: Copper or brass, silver plated. Gold plating available.

CONTACT SPRING: Music wire or stainless steel.

OPERATING TEMPERATURE: -30°C to +65°C

NOTE: Specifications and materials listed above are for standard switches. For information on specific and custom switches, consult Customer Service Center.

Build-A-Switch

To order, simply select desired option from each category and place in the appropriate box. Available options are shown and described on pages G-61 through G-65. For additional options not shown in catalog, consult Customer Service Center.

| Switch Function | Actuator | Actuator Color | Mounting Style/Color | Terminations | Actuator Markings | Contact Material |
|--------------------------------------------------------------------------------------------------------------------------------------------------------------------------------------------------------------------------------------------------------------------------------------------------------------------------------------------------------------------------------------------------------------------------------------------------------------------------------------------------------|-------------------------------------|--------------------------------------------------|---------------------------------------------------------------------------------------------------------------------------------------------|---------------------------------------------------------------------------------------------------------------------------------------------------------------------------------------------------|---------------------------------------------------------------------------------------------------------------------------------------------------------------|-----------------------------------------------------------------------------|
| D101 SPDT, On-None-On D102 SPST, On-None-Off D103 SPDT, On-Off-On D105 SPDT, Mom.-Off-Mom. D108 SPDT, Mom.-None-On D201 DPDT, On-None-On D202 DPST, On-None-Off D203 DPDT, On-Off-On D501 SPDT, On-None-On D502 SPST, On-None-Off D503 SPDT, On-Off-On D508 SPDT, Mom.-None-On D601 DPDT, On-None-On D602 DPST, On-None-Off D608 DPDT, Mom.-None-On | J1 Rocker J5 Lever | 2 Black 1 White 3 Red | S2 Snap-in, black B2 Recessed snap-in actuator guard, black G2 Actuator guard, black S1 Snap-in, white | 15 Quick connect A Right angle, PC thru-hole 02 PC Thru-hole 05 Twisted quick connect 06 Extended PC thru-hole 17 Wireable quick connect | NONE No marking D ON-OFF H 0 I N Large dot P 0 – R Red rectangle on end U Large dot on end | QA Silver Gold plating options available contact Customer Service |











15 May 20



D Series Miniature Snap-in Power Rocker Switches

SWITCH FUNCTION



| NO. POLES | MODEL NO. | AMP RATING* | SWITCH FUNCTION | | | CONNECTED TERMINALS | | | SCHEMATIC | |
|-----------|--------------|-------------|-----------------------------------------------------------------------------------|-----------------------------------------------------------------------------------|-----------------------------------------------------------------------------------|-----------------------------------------------------------------------------------|------------------------------------------------------------------------------------|-------------------------------------------------------------------------------------|-----------|-------------------------------------------------------------------------------------|
| | | | POS. 1 | POS. 2 | POS. 3 | POS. 1 | POS. 2 | POS. 3 | | |
| | | |  |  |  |  |  |  | | |
| SP | D102 D502 | 4 10 | ON | NONE | OFF | 1-1A | N/A | OPEN | SPST |  |
| | D101 D501 | 4 10 | ON | NONE | ON | | | 1-1B | SPDT |  |
| | D103 D503 | 4 10 | | OFF | | | | | | |
| | D105 | 4 | | MOM. | OFF | | MOM. | | | |
| | D108 D508 | 4 10 | MOM. | NONE | ON | | | | | |

SPDT

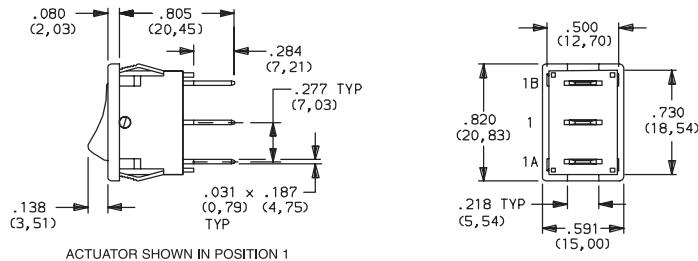

ACTUATOR SHOWN IN POSITION 1

TERMINAL NOS.
FOR REF. ONLY

Part number shown: D101J12S215QA

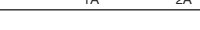
| | | | | | | | | | | |
|-------------|-------------|------|------|------|-----|------------|------|------------|------|---------------------------------------------------------------------------------------|
| DP | D202 | 4 | ON | NONE | OFF | 1-1A, 2-2A | N/A | OPEN | DPST |  |
| | D602 | 10 | | | | | | 1-1B, 2-2B | | |
| | D201 | 4 | ON | NONE | ON | | OPEN | 1-1B, 2-2B | DPDT |  |
| | D601 | 10 | | OFF | | | | | | |
| | D203 | 4 | | | | | | | | |
| D608 | 10 | MOM. | NONE | | N/A | | | | | |

DPDT

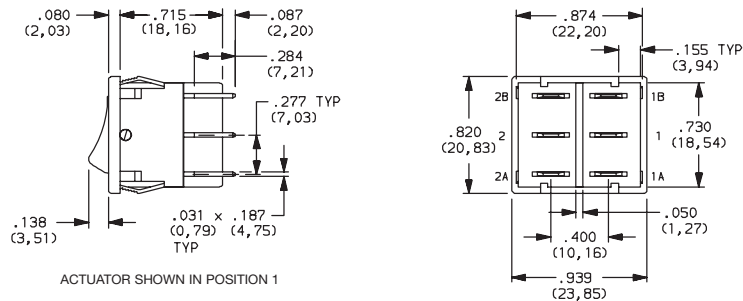

ACTUATOR SHOWN IN POSITION 1

TERMINAL NOS.
FOR REF. ONLY

Part number shown: D201J12S215QA

MOM. = Momentary

*AMP RATING: see G-60

See CONTACT MATERIALS, page G-64.



Rocker

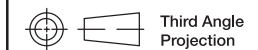

Third Angle Projection

Dimensions are shown: Inches (mm)
Specifications and dimensions subject to change



15 May 20

D Series Miniature Snap-in Power Rocker Switches



J1 ROCKER

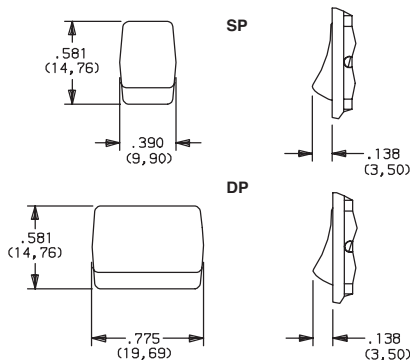

J5 LEVER

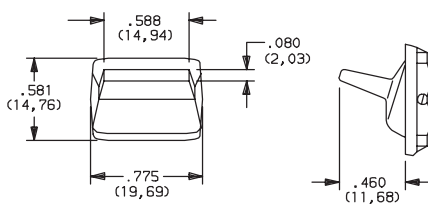

| OPTION CODE | ACTUATOR COLOR |
|-------------|----------------|
| 2 | BLACK |
| 1 | WHITE |
| 3 | RED |

NOTE: Actuator finish: matte. Other colors available, consult Customer Service Center.

'J5' actuator available only with DP models D201, D202, D601 and D602.

MOUNTING STYLE/COLOR

S SNAP-IN

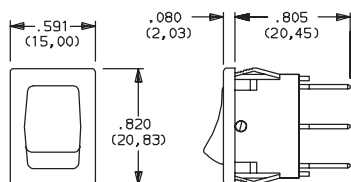

| OPTION CODE | HOUSING COLOR |
|-------------|---------------|
| 2 | (STD.) BLACK |
| 1 | WHITE |

NOTE: Frame finish on housing: matte. Other colors available, consult Customer Service Center.

B2 RECESSED SNAP-IN ACTUATOR GUARD, BLACK

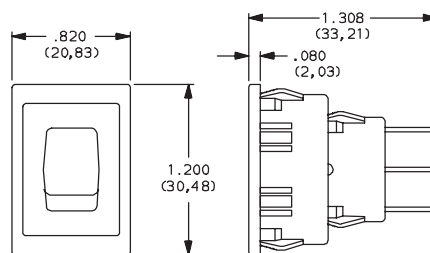

NOTE: Vertical mount, SP models only.

G2 ACTUATOR GUARD, BLACK

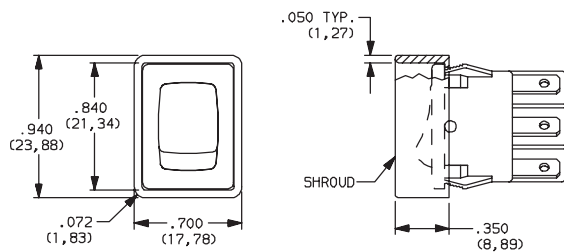

NOTE: Vertical mount, SP models only.

PANEL MOUNTING

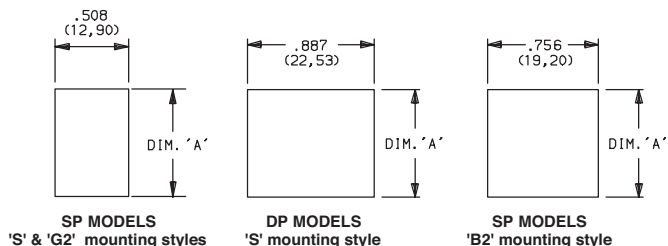

| PANEL THICKNESS | DIM 'A' SP & DP MODELS 'S' MOUNTING STYLE | DIM 'A' WITH 'G2' OPTION SP MODELS ONLY | DIM 'A' SP MODELS 'B' MOUNTING STYLE |
|-------------------------|-------------------------------------------|-----------------------------------------|--------------------------------------|
| .030-.049 (0,76) (1,24) | .756 (19,20) | .764 (19,41) | 1.068 (27,13) |
| .049-.079 (1,24) (2,01) | .764 (19,41) | .780 (19,81) | 1.076 (27,33) |
| .079-.118 (2,01) (3,00) | .780 (19,81) | n/a | 1.092 (27,74) |

NOTE: Blank insert available for SP models only, see page G-64.

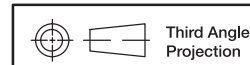

Dimensions are shown: Inches (mm)
Specifications and dimensions subject to change



15 May 20



D Series Miniature Snap-in Power Rocker Switches

TERMINATIONS

A RIGHT ANGLE, PC THRU-HOLE

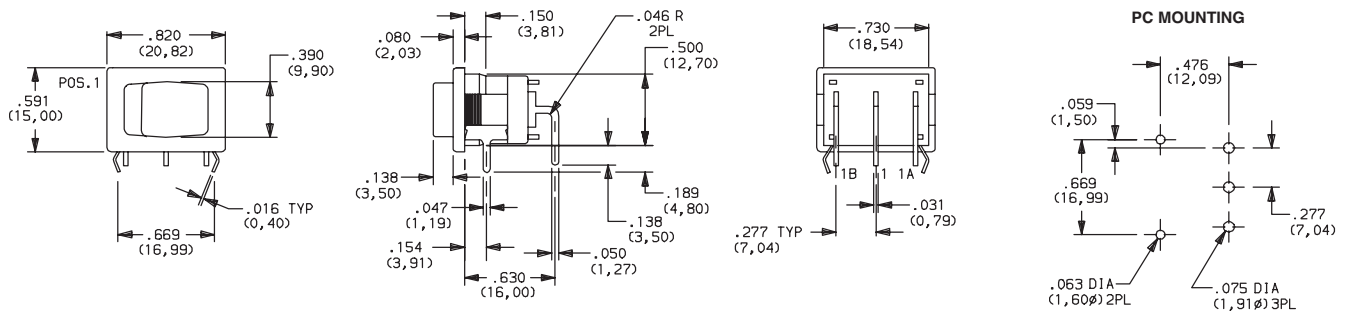

Available with D101, D102, D501, D502 SP models only.

TERMINATIONS

02 PC THRU-HOLE

06 EXTENDED PC THRU-HOLE

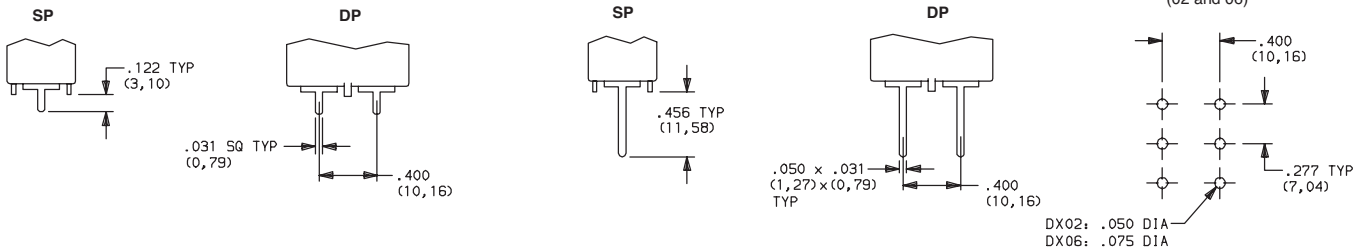

Available with DX01 and DX02 models only.

Available with DX01 and DX02 models only.

15 QUICK CONNECT

05 TWISTED QUICK CONNECT

17 WIRABLE QUICK CONNECT

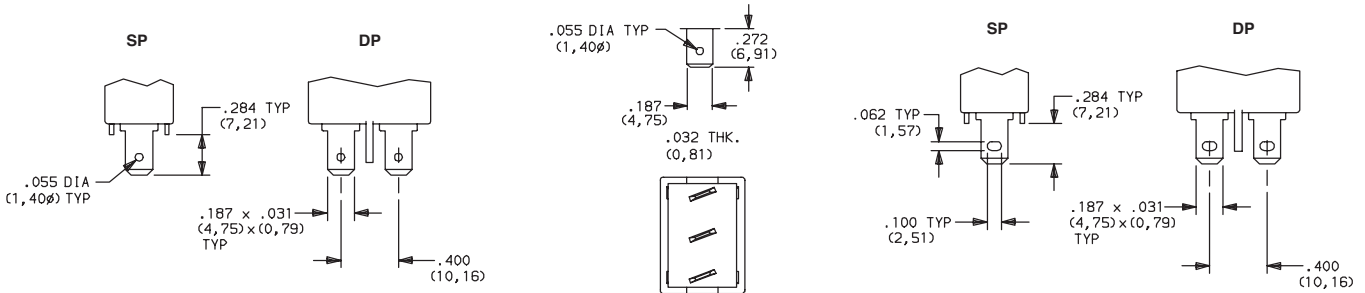

Available with DX01 and DX02 models only.

NOTE: Terminals are twisted.

Available with DX01 and DX02 models only.

ACTUATORS

NONE NO MARKING

D ON-OFF

H O |

N LARGE DOT

P O -

R RED RECTANGLE ON END

U LARGE DOT ON END



'D, H, P & U' marking options: marking color white, standard for all actuator colors except white. Black marking color, standard for white actuators. 'R & N' marking option: red marking color, standard. Consult Customer Service Center for other available marking colors.

NOTE: Orientation of actuator markings and terminals.



Dimensions are shown: Inches (mm)
Specifications and dimensions subject to change

C&K

15 May 20

G-64

www.ckswitches.com

Rocker



G

Miniature Snap-in Power Rocker Switches

| OPTION CODE | CONTACT AND TERMINAL MATERIAL | RATINGS |
|-------------|-------------------------------|-----------------------------------------------------------------|
| QA | SILVER ¹ | D101, D102, D103, D105, D108, D201, D202, D203 |
| | | GP (general purpose) 4 AMPS 125 VAC 50/60 Hz T85 10,000 cycles |
| | | 2 AMPS 250 VAC 50/60 Hz T85 10,000 cycles |
| | | R (resistive) 4 AMPS 30 VDC T85 10,000 cycles |
| | | D501, D502, D503, D508, D601, D602, D608 |
| | | GP (general purpose) 10 AMPS 125 VAC 50/60 Hz T85 10,000 cycles |
| | | 5 AMPS 250 VAC 50/60 Hz T85 10,000 cycles |
| | | R (resistive) 10 AMPS 30 VDC T85 10,000 cycles |

¹MOVABLE CONTACT: D10X and D20X MODELS: Copper, silver plated.
D50X and D60X MODELS: Coin silver, silver plated.



0.4VA @ 20V AC/DC Gold plated options available contact Customer Service.

AVAILABLE HARDWARE

**Insert
SP Only**

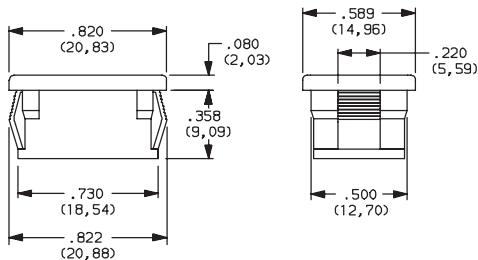

PART NO.
057190200 BLACK
Material: Nylon 6/6
Finish: Matte

**Recessed Actuator Guard,
SP Only**

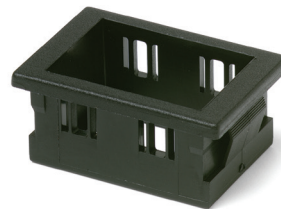

599D02000 BLACK
Material: 6/6 Nylon
Finish: Matte

Actuator Guard

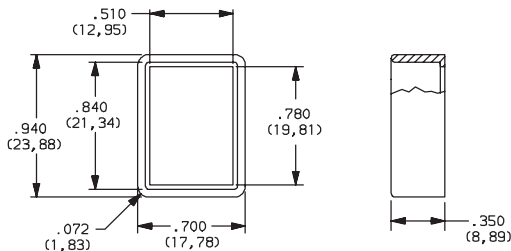

PART NO.
104C22000
Material: PBT thermoplastic
Finish: Matte

PART NO.

216C00000 IP54 SPLASH PROOF RUBBER BOOT

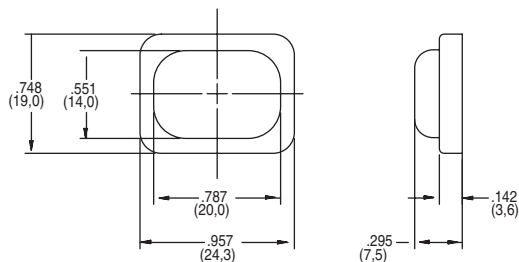

15 May 20

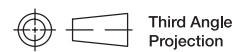

Dimensions are shown: Inches (mm)
Specifications and dimensions subject to change



Mouser Electronics

Authorized Distributor

Click to View Pricing, Inventory, Delivery & Lifecycle Information:

C&K Components:

[D102J12S202PQF](#) [D102J12G215QF](#) [D503J12S205](#) [D501J13S205DQA](#) [D501J12S215DQF](#)

C&K Switches:

[057190200](#)