













## CR Series

### Round Single Pole Specialty Rocker Switches

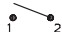
NO. POLES	MODEL NO.	SWITCH FUNCTION			CONNECTED TERMINALS			SCHEMATIC
		Pos. 1	Pos. 2	Pos. 3	Pos. 1	Pos. 2	Pos. 3	
								
		C&K marking on opposite side			C&K marking on opposite side			
SP	CR101	ON	NONE	ON	2-3	N/A	2-1	
	CR102	ON	NONE	OFF				 OR  For 7 & 8 Illuminated Versions
								 

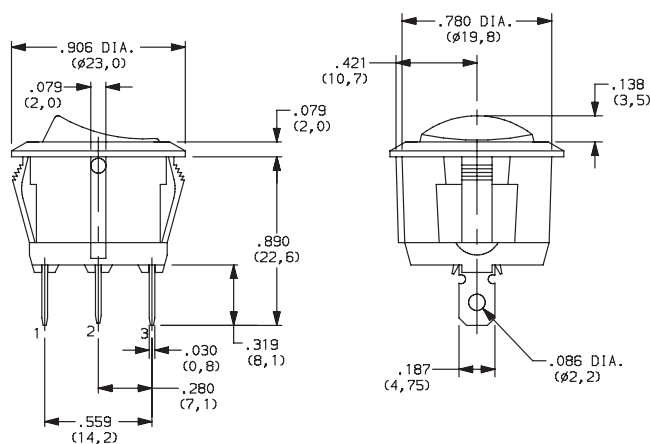

**J1** ROCKER

### J3 ILLUMINATED ROCKER

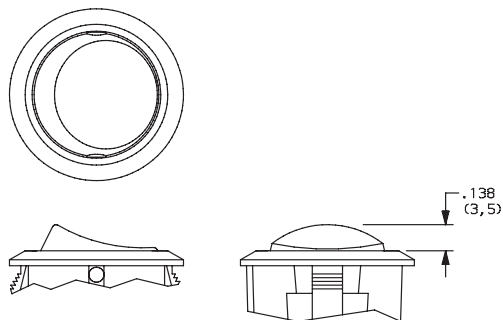

**NOTE:** J3 actuator available with the combination of 7 & 8 lamp ratings and CR102 switch function only.

**J2** TWO-TONE ROCKER

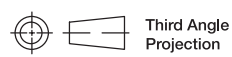
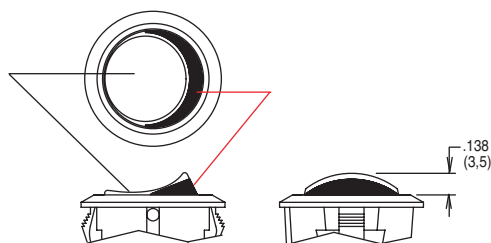

Dimensions are shown: Inches (mm)  
Specifications and dimensions subject to change

# CR Series Round Single Pole Specialty Rocker Switches

## ACTUATOR



### J4 CIRCLE, ILLUMINATED ROCKER

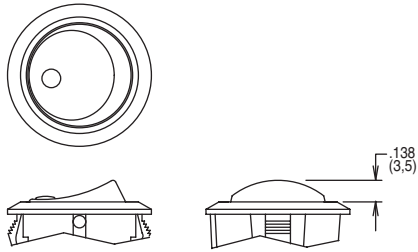

**NOTE:** Available with the combination of CR102 switch function and 7 & 8 lamp ratings only.

### J5 OVAL, ILLUMINATED ROCKER

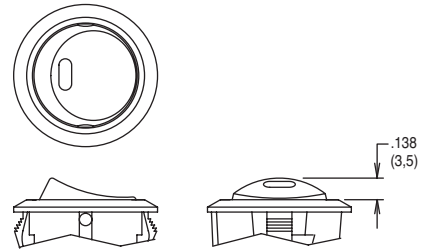

**NOTE:** Available with the combination of CR102 switch function and 6 lamp rating only.

### JN PADDLE, ROCKER

### JP PADDLE, ILLUMINATED ROCKER

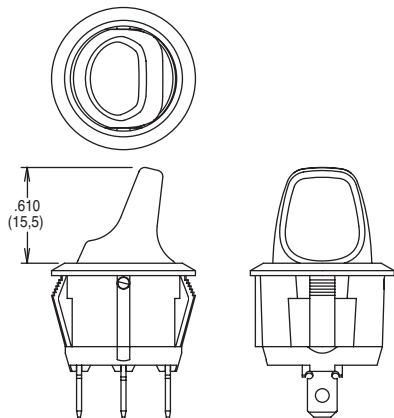

**NOTE:** JP actuator available with the combination of CR102 switch function and 7 & 8 lamp ratings only.

## ACTUATOR COLOR



ACTUATOR	OPTION CODE	ACTUATOR COLOR
<b>J1</b>	<b>2</b>	BLACK
	<b>1</b>	WHITE
	<b>3</b>	RED
<b>J3, J4 J5, JP</b>	<b>R</b>	RED, ILLUMINATED
	<b>A</b>	AMBER, ILLUMINATED
	<b>G</b>	GREEN, ILLUMINATED

<b>J2</b>	OPTION CODE	ACTUATOR COLOR	
		TOP	BOTTOM
	<b>1</b>	WHITE	RED
	<b>2</b>	WHITE	BLACK
	<b>3</b>	RED	WHITE
	<b>4</b>	BLACK	WHITE
	<b>5</b>	BLACK	RED

J2 actuator only

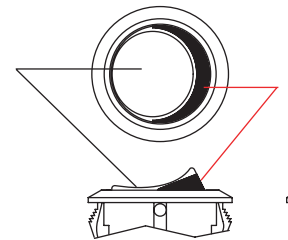

## MOUNTING STYLE/COLOR



### S2 SNAP-IN, BLACK

### S1 SNAP-IN, WHITE

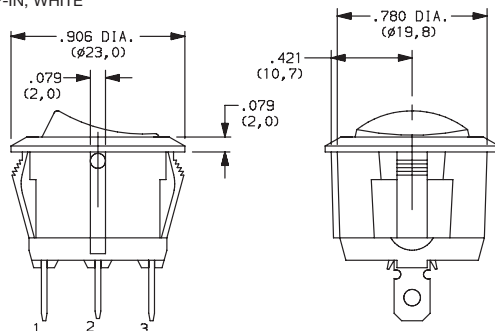

### PANEL MOUNTING

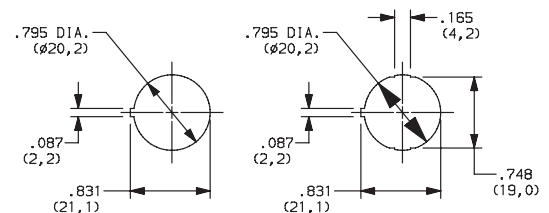

Panel thickness:  
2.0 - 3.0 mm

Panel thickness:  
0.7 - 3.0 mm



Dimensions are shown: Inches (mm)

Specifications and dimensions subject to change

Rocker





G

**C&K**

## CR Series Round Single Pole Specialty Rocker Switches

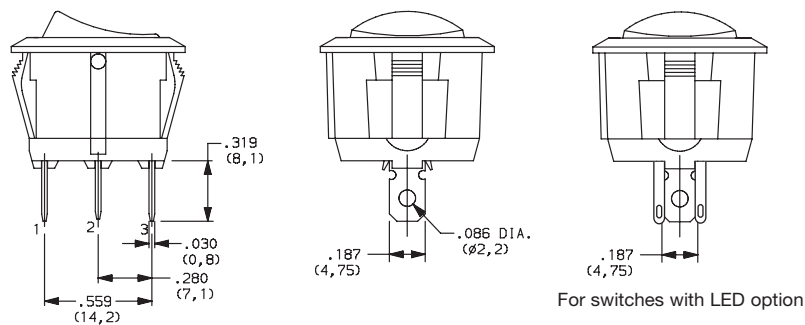
**15** .187" QUICK CONNECT



OPTION CODE	CONTACT AND TERMINAL MATERIAL	RATINGS		
QF	SILVER	POWER	16 AMPS @ 125 VAC; 10 AMPS @ 250 VAC	

\* Note: See Technical Data section of this catalog for RoHS compliant and compatible definitions and specifications.

**(NONE)** NO LAMP

## 6 LED RATING @ 10 mA $V_f=1.85V$

**7** 125 VAC 33k $\Omega$  NEON

**8** 250 VAC 150kΩ NEON

## ACCESSORIES

**377C00000** IP65 SPLASH PROOF RUBBER BOOT

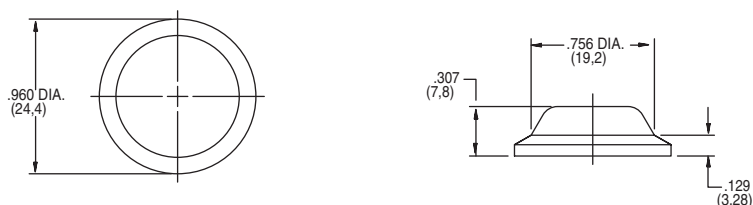

Third Angle Projection

Dimensions are shown: Inches (mm)  
Specifications and dimensions subject to change

# Mouser Electronics

Authorized Distributor

Click to View Pricing, Inventory, Delivery & Lifecycle Information:

## C&K Switches:

[CR101J12S215QF](#) [CR101J11S115QF](#) [CR101J11S215QF](#) [CR102J3GS215QF8](#) [CR102J3RS215QF7](#)  
[CR102JPRS215QF7](#) [CR102J3AS215QF8](#) [CR102J11S215QF](#) [CR102J12S215QF](#) [CR102J5RS215QF6](#)  
[CR102J4RS215QF7](#) [CR102J3GS215QF7](#) [CR102J3RS215QF8](#) [CR102JPRS215QF8](#) [CR102J23S215QF](#)  
[CR102J3AS215QF7](#) [CR102J22S215QF](#) [CR102J5AS215QF6](#) [CR102J5GS215QF6](#) [CR102J25S215QF](#)