

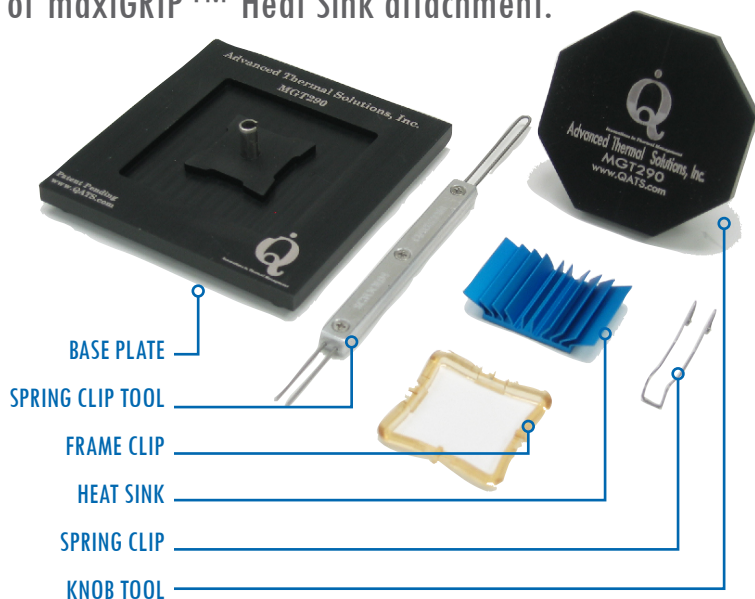

maxiGRIP™ Tool

Aluminum tool for installation and removal of maxiGRIP™ Heat Sink attachment.



Part Number	Component Size (mm)
MGT170	17x17
MGT190	19x19
MGT210	21x21
MGT230	23x23
MGT250	25x25
MGT270	27x27
MGT290	29x29
MGT300	30x30
MGT310	31x31
MGT325	32.5x32.5
MGT330	33x33
MGT350	35x35
MGT375	37.5x37.5
MGT400	40x40
MGT425	42.5x42.5
MGT450	45x45

INSTALLATION GUIDE

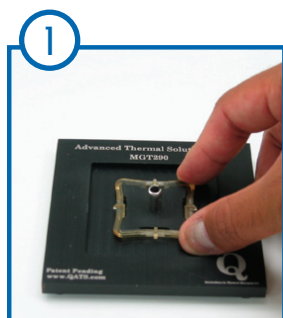

Place Frame Clip into pocket of tooling Base Plate.

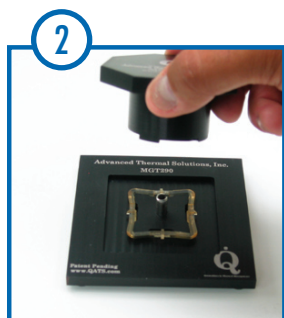

Position the Knob Tool over the Frame Clip

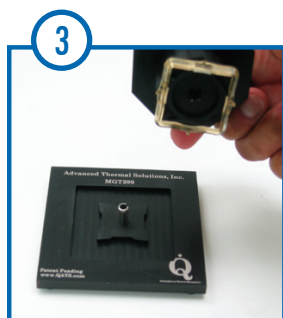

Rotate the knob tool 45° clockwise locking the Frame Clip to the Knob Tool and lift away from base plate.

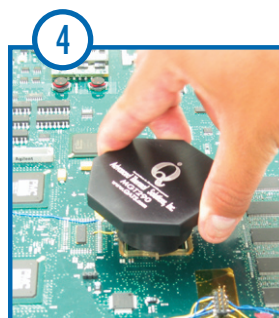

Position the Knob Tool with Frame Clip over the component, rotate 45° counter-clockwise releasing the Frame Clip



Lift to remove the Knob Tool - leaving the Frame Clip attached to the component.

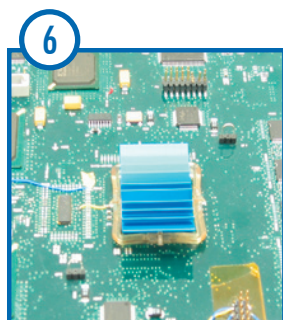

Place the Heat Sink squarely in the Frame Clip over the component. Note the direction of air flow when placing your Heat Sink.

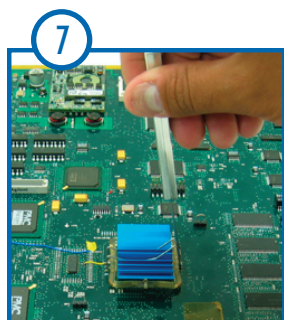

Secure the "Open End" of the Spring Clip under the lip of the frame clip.

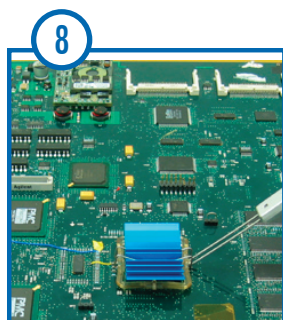

Using the "Forked End" of the Spring Clip tool, "latch over" the "Closed End" of the Spring Clip on to the Frame Clip tab.

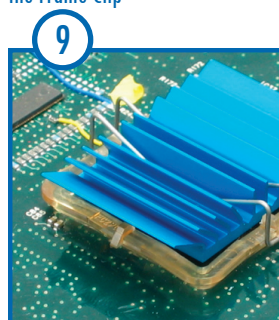

Inspect the installation. Double check to make sure the Heat Sink is securely attached.

For more information, please contact Advanced Thermal Solutions, Inc.
p: 781-769-2800, ats-hq@qats.com or www.qats.com

Mouser Electronics

Authorized Distributor

Click to View Pricing, Inventory, Delivery & Lifecycle Information:

Advanced Thermal Solutions:

[MGT190](#) [MGT210](#) [MGT230](#) [MGT250](#) [MGT270](#) [MGT290](#) [MGT300](#) [MGT310](#) [MGT325](#) [MGT330](#) [MGT350](#)
[MGT375](#) [MGT400](#) [MGT425](#) [MGT450](#) [MGT170](#)