

Our RF Termination Series is available in 2.40mm, 2.92mm, 3.50mm, N-type and SMA series. The range also includes standard feed-thru load and RF load versions with male, female, jack and plug genders.

Our terminations (also known as RF loads or Dummy loads) have some precision designs and offer a frequency range as high as 50 GHz.



Key Features:

- ⬢ 50-ohm Impedance
- ⬢ Insulation resistance >5000MΩ
- ⬢ Durability >500 Cycles
- ⬢ Available in Male and Female Threads
- ⬢ Available in Plug or Jack
- ⬢ Beryllium Copper Contact Pin
- ⬢ Body Material available in Stainless Steel Passivation

### 2.40mm Termination Series



RFTERM240P05W

- ⬡ Max Voltage 335V
- ⬡ Operating Temperature -65C to +165C (0.5W) -55C to +125C (1W)
- ⬡ Frequency Range 0-40GHz
- ⬡ VSWR <1.20 (0.5W) <1.25 (1W)
- ⬡ Dielectric withstanding Voltage >750V
- ⬡ Available in 0.5W and 1W

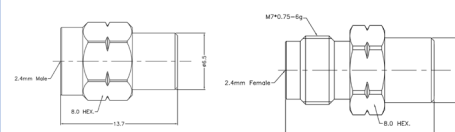

Part Number	Fitting	Plug or Jack	Watts
RFTERM240P05W	240	Plug	05W
RFTERM240J05W	240	Jack	05W
RFTERM240P1W	240	Plug	1W
RFTERM240J1W	240	Jack	1W

### 2.92mm Termination Series



RFTERM292P05W

- ⬡ Max Voltage 335V
- ⬡ Operating Temperature -65C to +165C (0.5W) -55C to +125C (1W)
- ⬡ Frequency Range 0-40GHz
- ⬡ VSWR <1.15 (1W) <1.20 (2W)
- ⬡ Dielectric withstanding Voltage >750V
- ⬡ Available in 1W and 2W

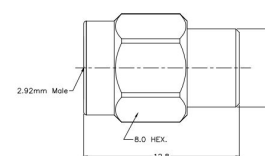

Part Number	Fitting	Plug or Jack	Watts
RFTERM292P05W	292	Plug	05W
RFTERM292J05W	292	Jack	05W
RFTERM292P1W	292	Plug	1W
RFTERM292J1W	292	Jack	1W

### 3.50mm Termination Series



RFTERM350P1W

- ⬡ Max Voltage 335V
- ⬡ Operating Temperature -65C to +165C
- ⬡ Frequency Range 0-40GHz
- ⬡ VSWR <1.15 (1W) <1.20 (2W)
- ⬡ Dielectric withstanding Voltage >750V
- ⬡ Available in 1W and 2W

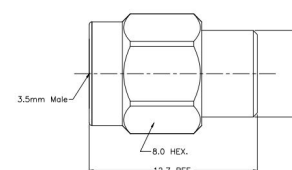

Part Number	Fitting	Plug or Jack	Watts
RFTERM350P1W	350	Plug	1W
RFTERM350J1W	350	Jack	1W
RFTERM350P2W	350	Plug	2W
RFTERM350J2W	350	Jack	2W

N Type Termination Series



RFTERMNP2W

- Max Voltage 335V
- Operating Temperature -40C to +85C
- Frequency Range 0-18GHz
- VSWR <1.20
- Dielectric withstanding Voltage >1500V
- Available in 2W

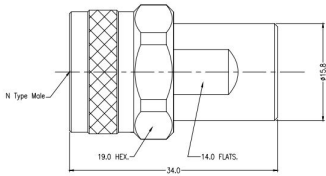

Part Number	Fitting	Plug or Jack	Watts
RFTERMNP2W	N	Plug	2W
RFTERMNJ2W	N	Jack	2W

SMA Termination Series



RFTERMSMAP1W

- Max Voltage 335V
- Operating Temperature -65C to +165C
- Frequency Range 0-18GHz
- VSWR <1.15 (1W) <1.20 (2W)
- Dielectric withstanding Voltage >750V
- Available in 1W and 2W

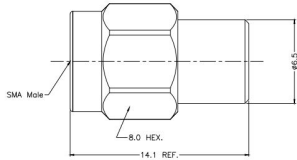

Part Number	Fitting	Plug or Jack	Watts
RFTERMSMAP1W	SMA	Plug	1W
RFTERMSMAJ1W	SMA	Jack	1W
RFTERMSMAP2W	SMA	Plug	2W
RFTERMSMAJ2W	SMA	Jack	2W

#### Electrical:

Insulation Resistance:	>5000MOhm
Impedance:	50Ohm
Centre Contact Resistance:	<3.0mOhms
Outer Contact Resistance:	<2.0mOhms

#### Mechanical:

Centre Contact Retention:	>20N
Coupling Torque:	0.80Nm to 1.10Nm
Coupling Torque (APC-7) RPC 7:	0.70Nm to 1.10Nm
Coupling Torque RPC N:	1.36Nm
Cycles:	>500
Cycles (APC-7) RPC N:	>500
Cycles (APC-7) RPC 7:	>5000

#### Material

Body:	Passivation of Stainless Steel
Contact:	Beryllium Copper
Insulator:	Adapter ASTM D 1710 UNFILLED ULTEM 1000/PEI
RoHS:	Compliant

Mount Hole Distance	Code
6.35mm	A
7.16mm	B
8.60mm	C
8.65mm	D
8.90mm	E
10.20mm	F
12.20mm	G
12.70mm	H
18.30mm	I

Socket Diameter	Code
0.23mm	A
0.30mm	B
0.38mm	C
0.46mm	D
0.51mm	E
0.91mm	F

Flange Mount Length	Code
9.50mm	A
10.16mm	B
12.70mm	C
14.00mm	D
15.80mm	E
17.50mm	F
25.40mm	G

Function	Code
Straight	A
Right Angle	B
Edge Launch	C
CMC	D
End Launch	E

PCB Thickness	Code
0.61mm	A
0.87mm	B
1.78mm	C
1.88mm	D

Function CMC	Code
Microstrip Line	A
Stripline	B

Seal Position	Code
SMA Side	A
N Side	B

Pin Diameter	Code
0.30mm	A
0.38mm	B
0.60mm	C
0.64mm	D
0.75mm	E
0.80mm	F
0.86mm	G
0.87mm	H
1.00mm	I
1.04mm	J
1.20mm	K
1.27mm	L
1.50mm	M
2.70mm	N

Cable Spec	Code
STA 142	G
UFB142A	G
-GORE 3507	G
1401 Cable	G

# Mouser Electronics

Authorized Distributor

Click to View Pricing, Inventory, Delivery & Lifecycle Information:

[Bulgin:](#)

[RFTERM240J05W](#) [RFTERM240J1W](#) [RFTERM240P05W](#) [RFTERM240P1W](#) [RFTERMSMAP1W](#) [RFTERMSMAP2W](#)  
[RFTERM350P1W](#) [RFTERM350P2W](#) [RFTERMNJ2W](#) [RFTERMNP2W](#) [RFTERMSMAJ1W](#) [RFTERMSMAJ2W](#)  
[RFTERM292J05W](#) [RFTERM292J1W](#) [RFTERM292P05W](#) [RFTERM292P1W](#) [RFTERM350J1W](#) [RFTERM350J2W](#)