

PART NAME	30.5mm PUSHBUTTON ENCLOSURE	PART No.	SPB-3923	REVISION DATE	5-16-19
-----------	-----------------------------	----------	----------	---------------	---------

MATERIAL - 14 GA. [2.0mm] STEEL  
 FINISH - SMOOTH GRAY POWDERCOAT  
 UL LISTED TYPE DTOV2

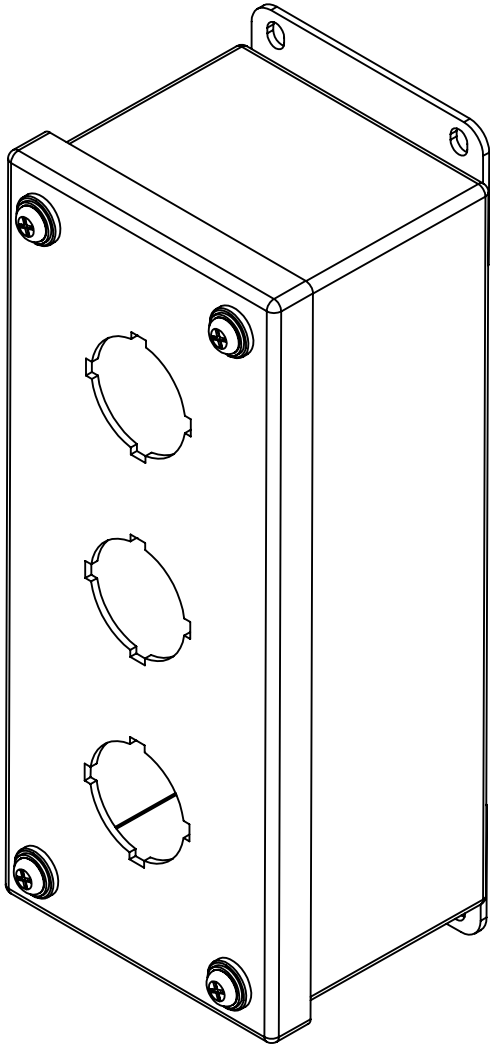
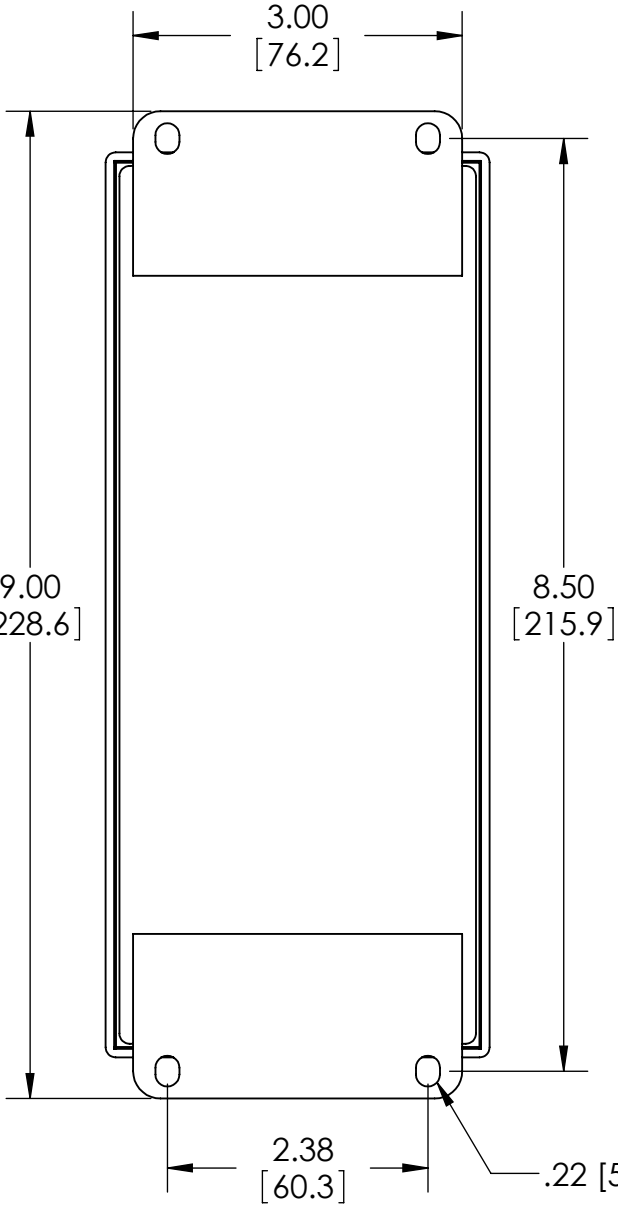
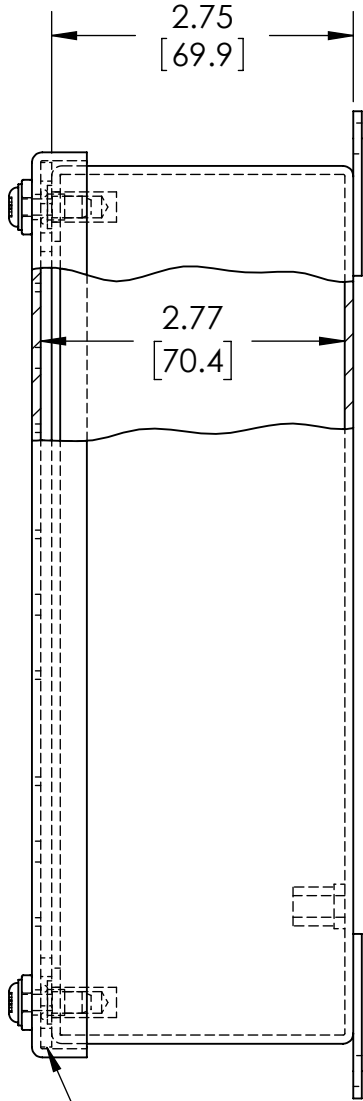
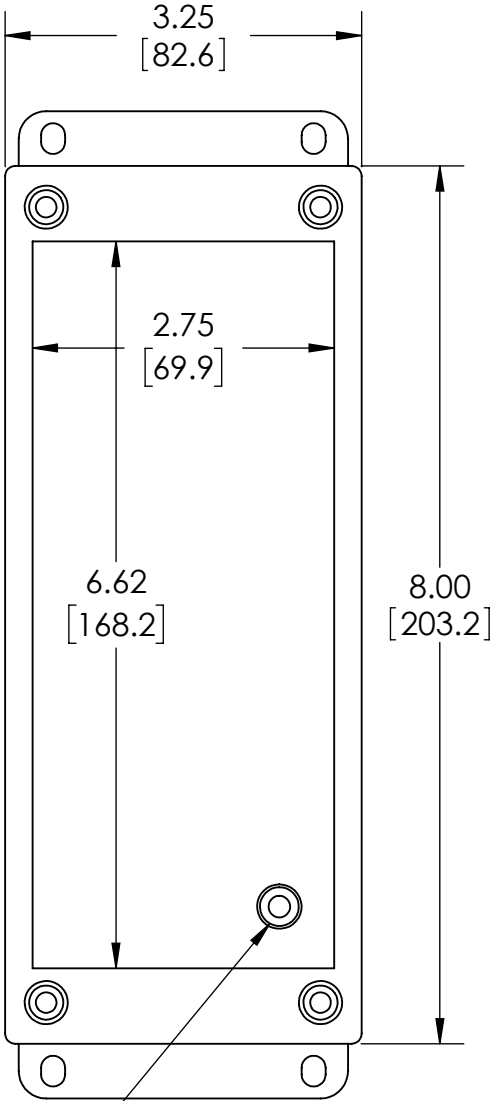
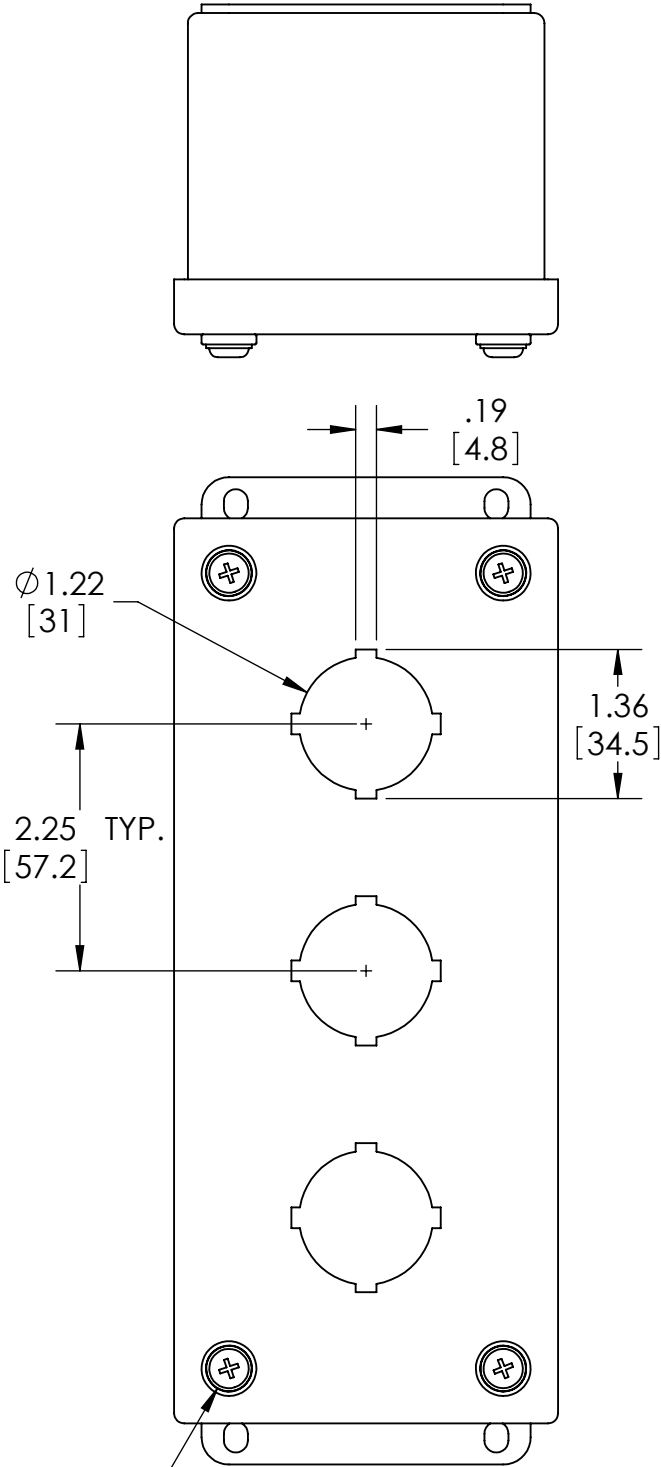

CAPTIVE SCREW M5x0.8 x 16mm LG., WASHER HEAD, PHILLIPS DRIVE, STEEL, ZINC PLATED, WITH SEALING WASHER, NEOPRENE, BLACK AND O-RING, BUNA-N, BLACK

**COVER REMOVED**  
 WELD STANDOFF M5x0.8 x 12mm LG. FOR GROUNDING [SUPPLIED WITH (1) SCREW M5x0.8 x 10mm LG., PAN HEAD, PHILLIPS DRIVE, STEEL, ZINC PLATED AND (1) LOCKWASHER, INTERNAL TOOTH, STEEL, ZINC PLATED]

ONE-PIECE DIE-CUT GASKET (.25[6.3] THK. PORON #4701-41-15250-04 - BLACK) INSIDE COVER.

.22 [5.6] x .28 [7.1] OBLONG

# Mouser Electronics

Authorized Distributor

Click to View Pricing, Inventory, Delivery & Lifecycle Information:

[Bud Industries:](#)

[SPB-3923](#)