

DRAWING FOR REFERENCE

WE RESERVE THE RIGHT TO MAKE CHANGES TO OUR STANDARD PRODUCTS. PLEASE CONSULT WITH BUD INDUSTRIES PRIOR TO USING THIS DRAWING FOR DESIGN PURPOSE.

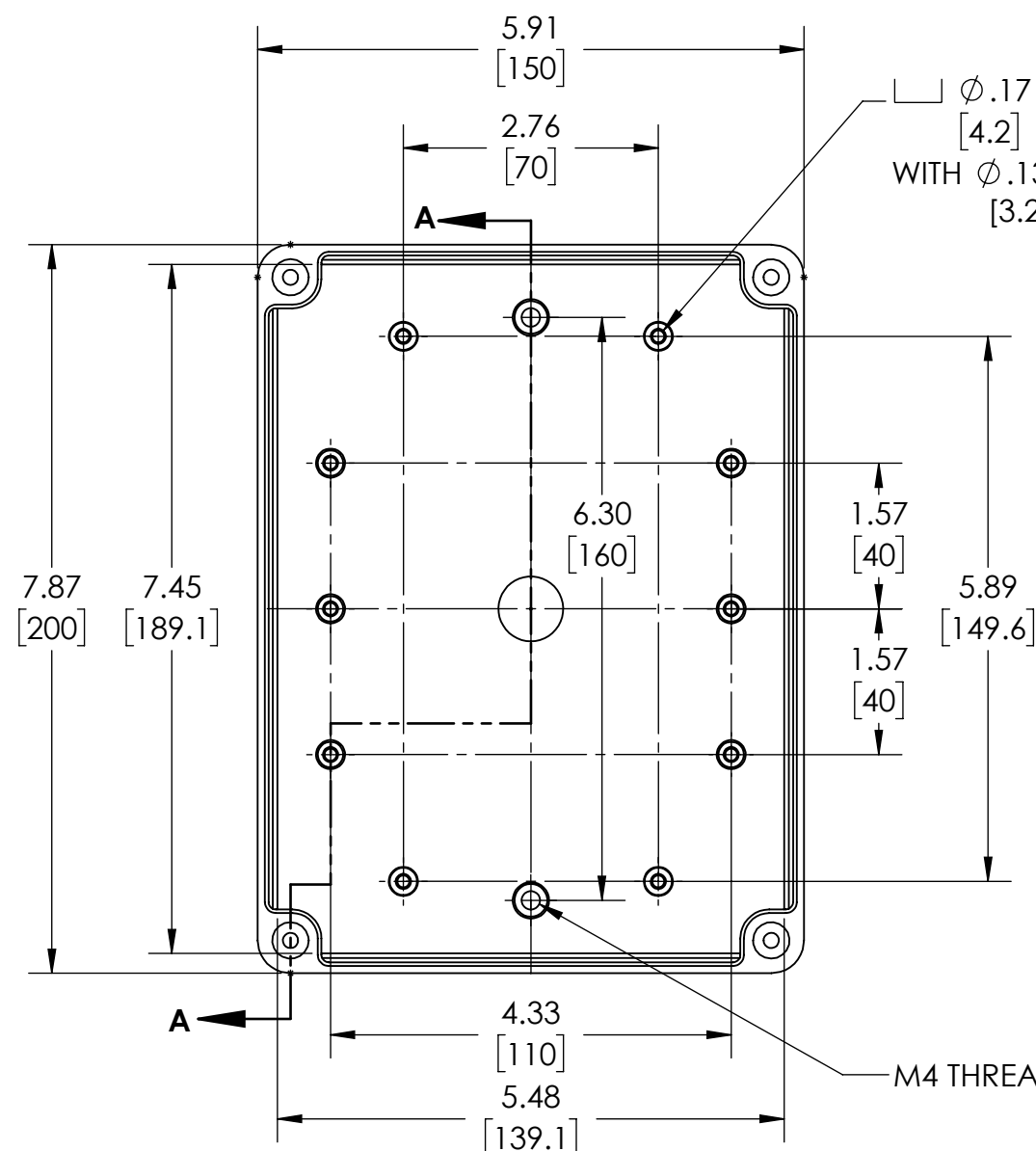

COVER NOT SHOWN

WITH $\phi .17 \times .04 \nabla$
 [4.2] [1]
 WITH $\phi .13 \times .25 \nabla$ HOLE (10X)
 [3.2] [6.4]

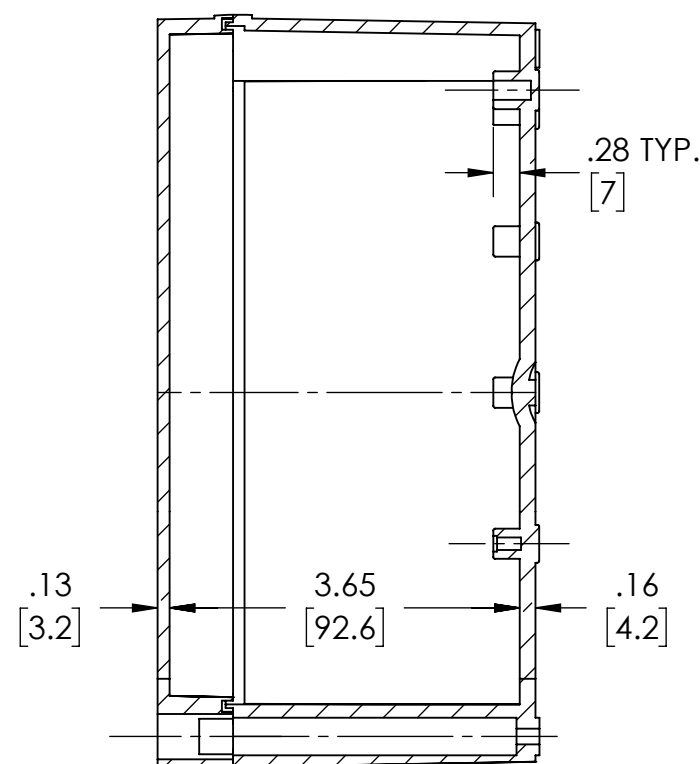

SECTION A-A

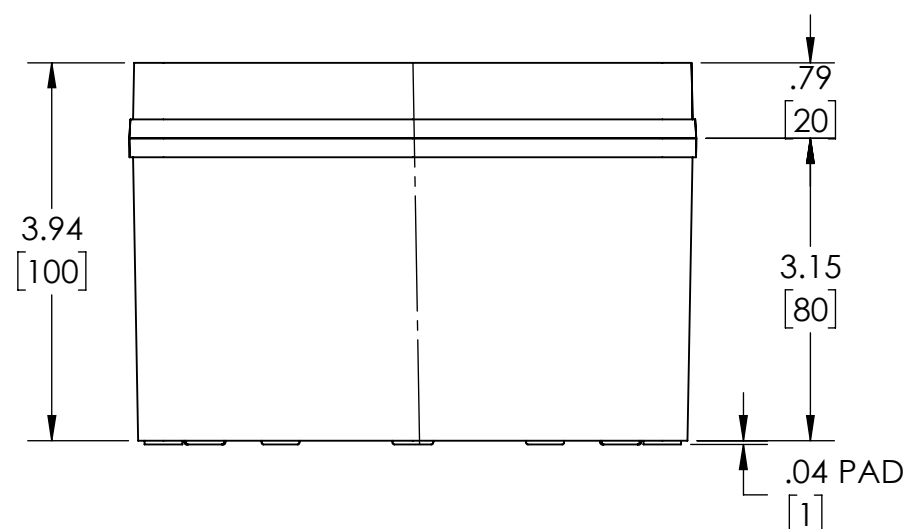
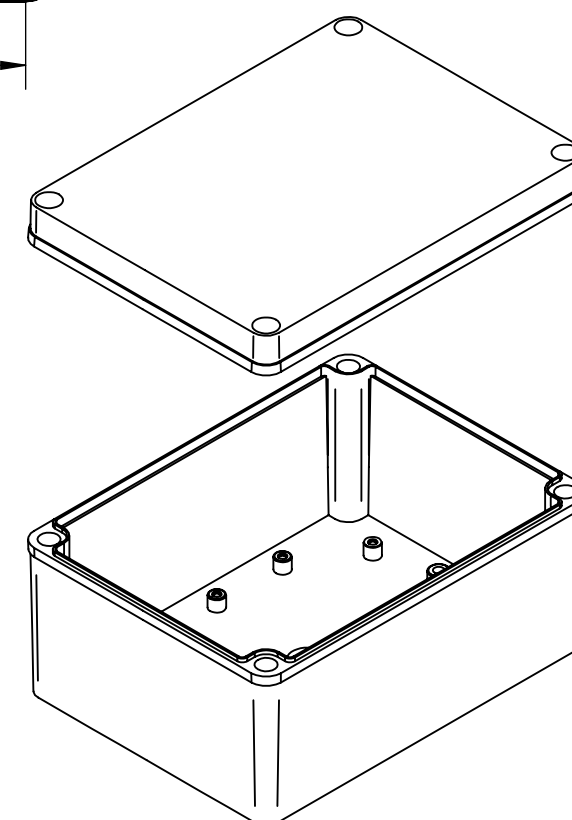
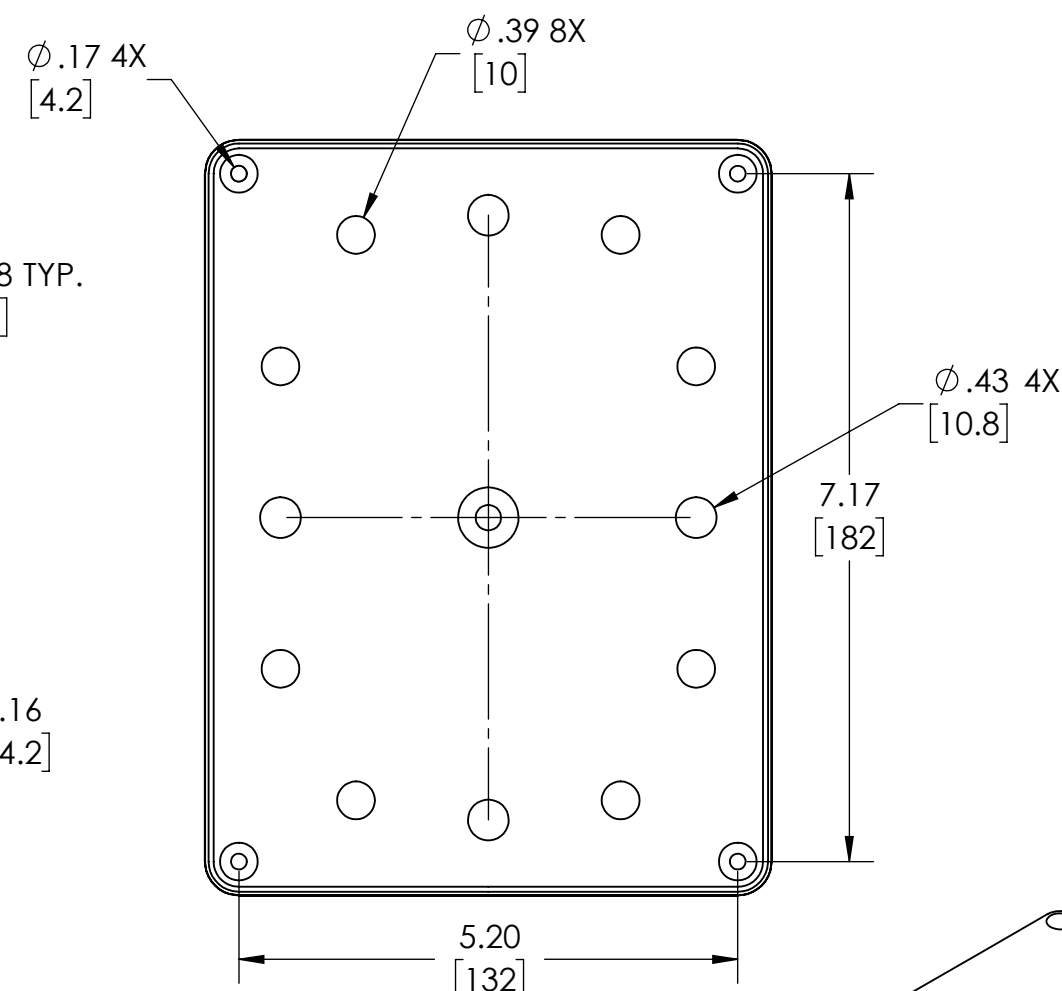

NOTES:

- NOTES:
- 1- MATERIAL: BODY - POLYCARBONATE WITH 10% FIBERGLASS COVER - POLYCARBONATE
 - 2- COLOR: NO SUFFIX - GRAY BODY & GRAY COVER
(-C) SUFFIX - GRAY BODY & CLEAR COVER
 - 3- COVER ATTACHES WITH NON-METALLIC CAPTIVE SCREWS
(ITEMS NOT SHOWN)
 - 4- SUPPLIED WITH TWO M4 x 8mm LG. PAN HEAD SCREWS
(ITEMS NOT SHOWN)
 - 5- DIMENSIONS ARE INCH [MM]

OPTIONAL ACCESSORIES:

- OPTIONAL ACCESSORIES:
STEEL INTERNAL PANEL #PTX-25328
PLASTIC INTERNAL PANEL #PTX-25328-P
MOUNTING BRACKET KIT (STAINLESS STEEL) #NBX-10922
MOUNTING BRACKET KIT (PLASTIC) #PIX-4117

Mouser Electronics

Authorized Distributor

Click to View Pricing, Inventory, Delivery & Lifecycle Information:

Bud Industries:

[PTS-25338](#) [PTS-25312-C](#) [PTS-25301](#) [PTS-25319](#) [PTS-25317](#) [PTS-25312](#) [PTS-25310](#) [PTS-25302](#) [PTS-25304](#)
[PTS-25308](#) [PTS-25319-C](#) [PTS-25342](#) [PTS-25349](#) [PTS-25323-C](#) [PTS-25323](#) [PTS-25328](#) [PTS-25301-C](#) [PTS-](#)
[25349-C](#) [PTS-25302-C](#) [PTS-25304-C](#) [PTS-25338-C](#) [PTS-25342-C](#) [PTS-25317-C](#) [PTS-25308-C](#) [PTS-25310-C](#)
[PTS-25328-C](#)