

THE INFORMATION CONTAINED IN THIS DRAWING IS THE SOLE PROPERTY OF
BUD INDUSTRIES INC. ANY REPRODUCTION IN PART OR WHOLE WITHOUT
THE WRITTEN PERMISSION OF BUD INDUSTRIES INC. IS PROHIBITED.

DWG. NO.	AN-2900	
ISSUE	REVISIONS	
A	UPDATED DRAWING 8-8-08 DAB	

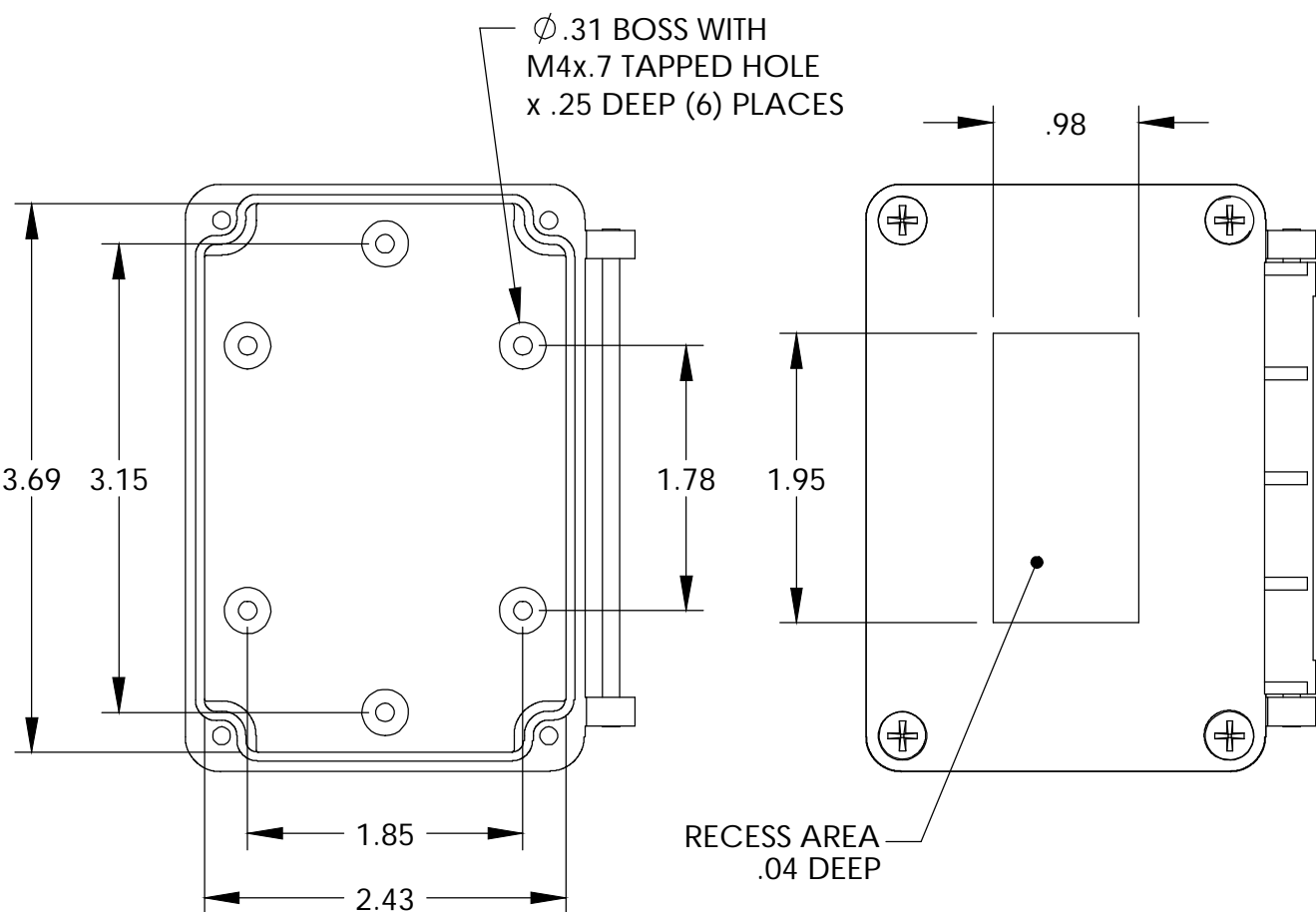

VIEW LESS COVER

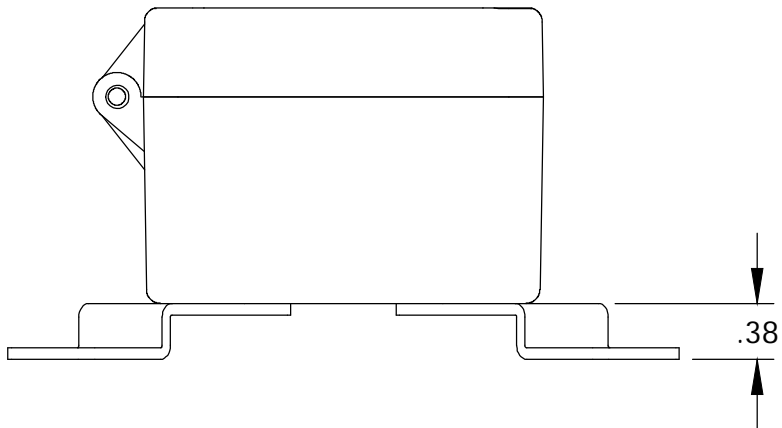
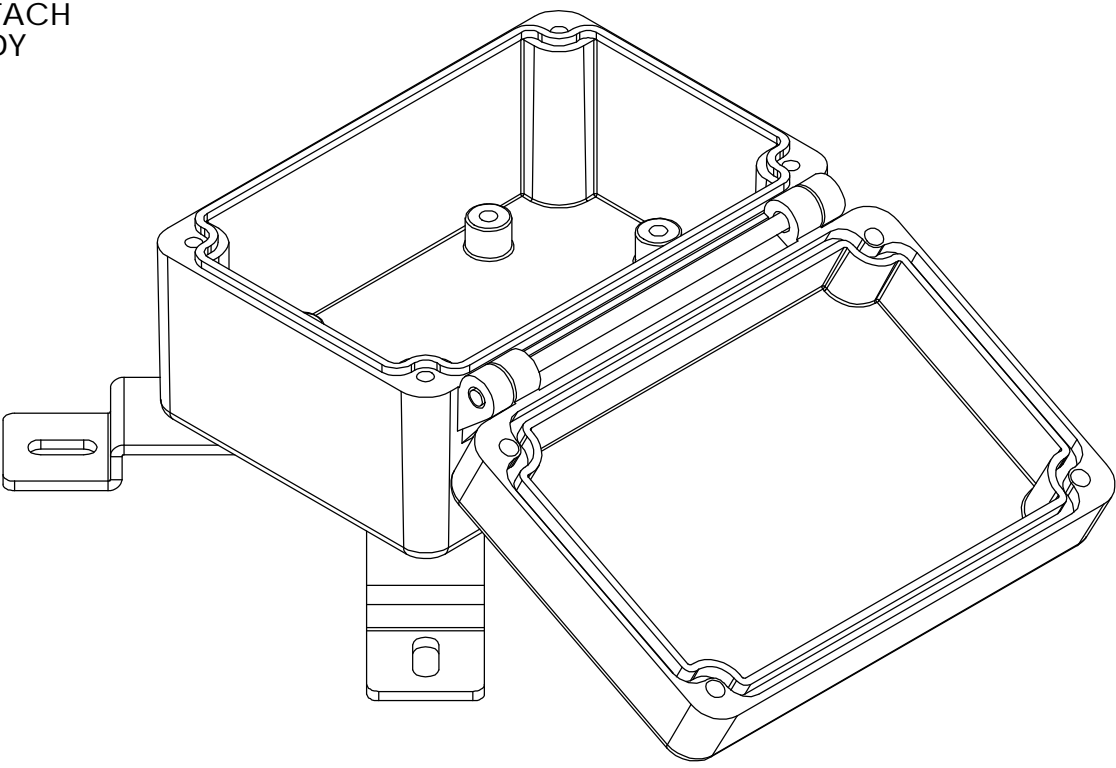
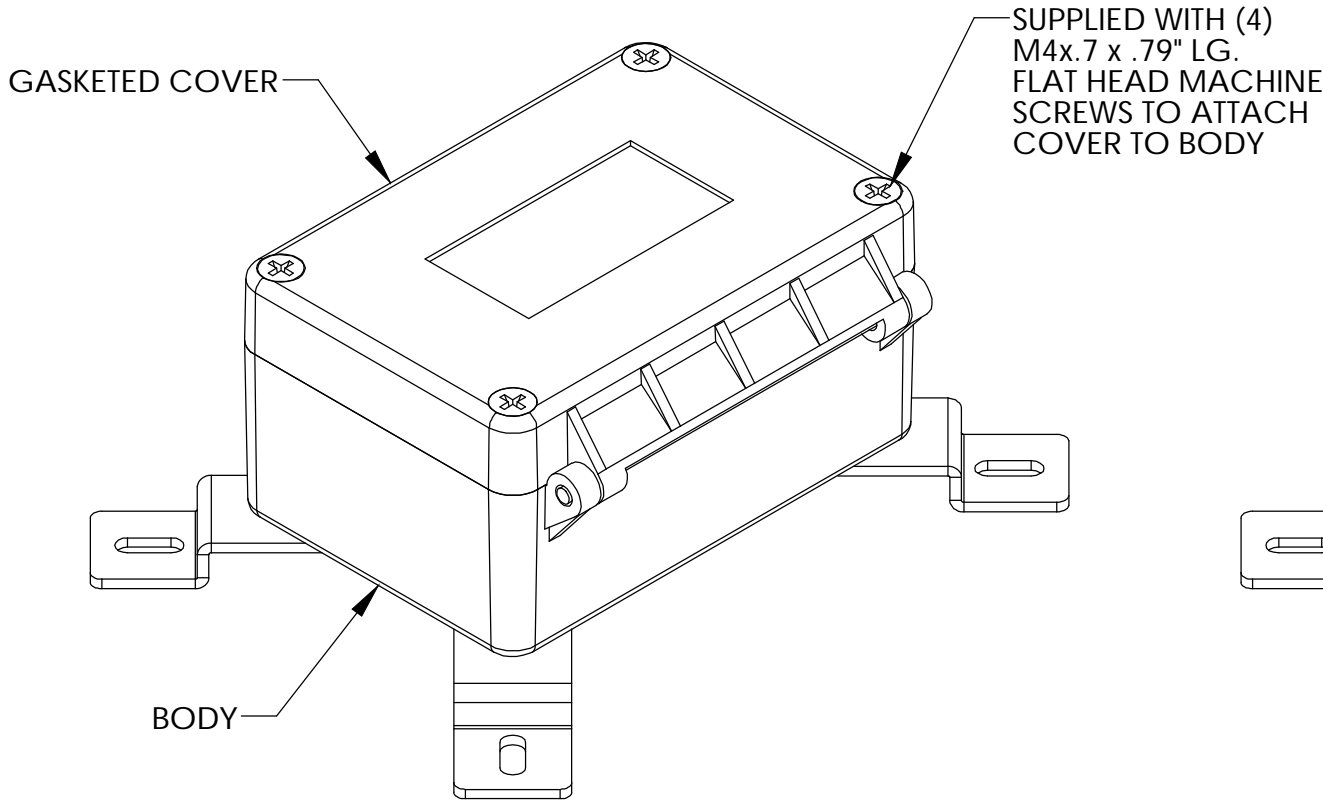
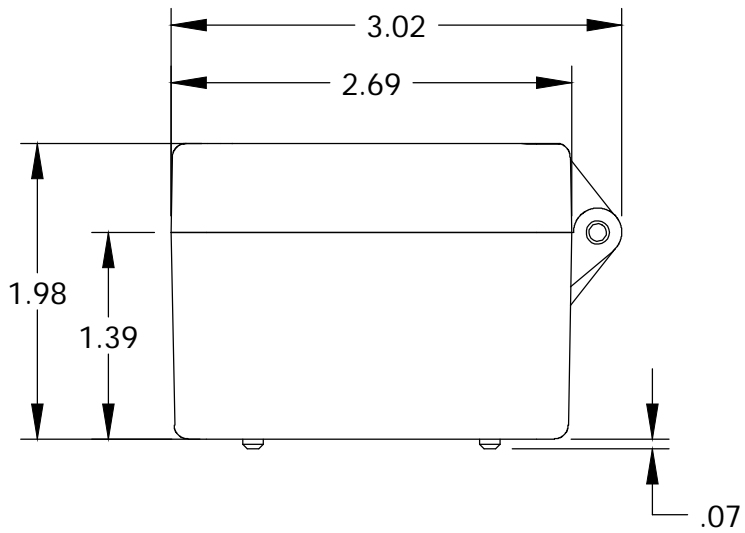

M4x.7 TAPPED HOLE
.40 DEEP IN BODY
(4) PLACES FOR WALL
MOUNT BRACKETS

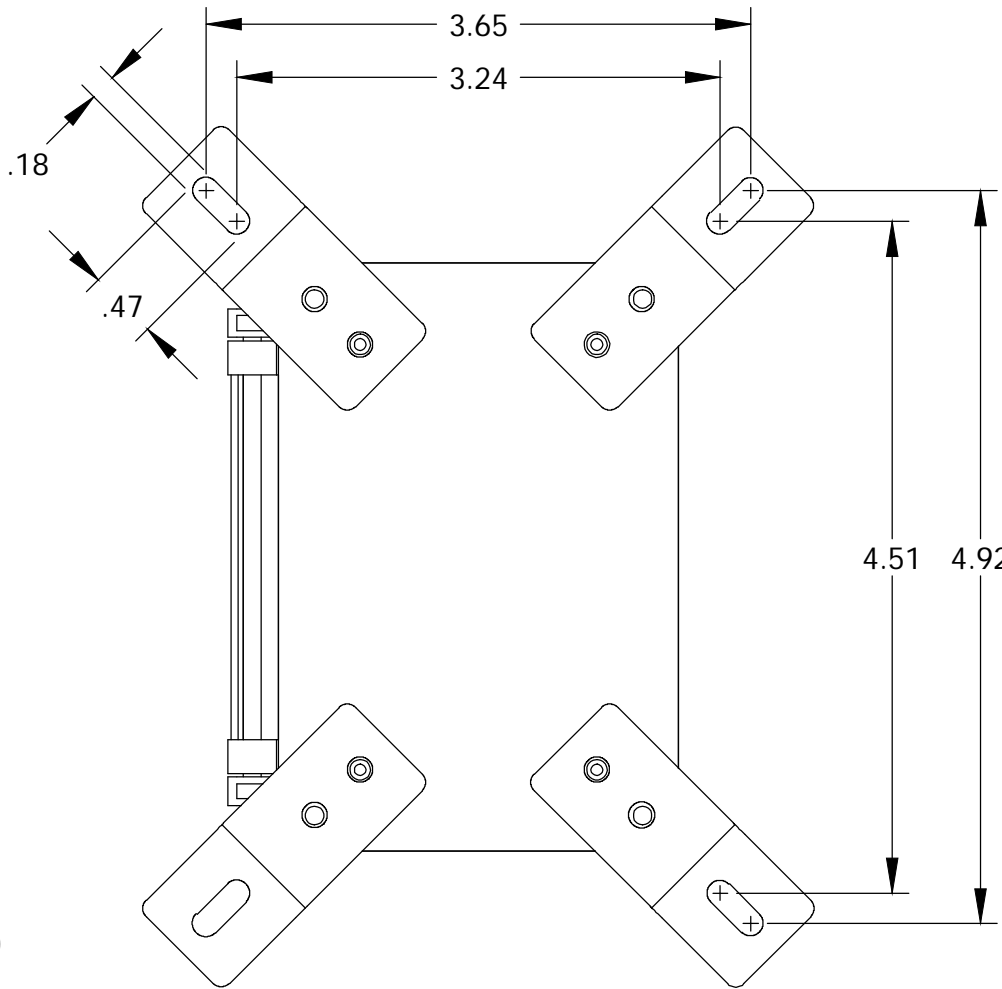
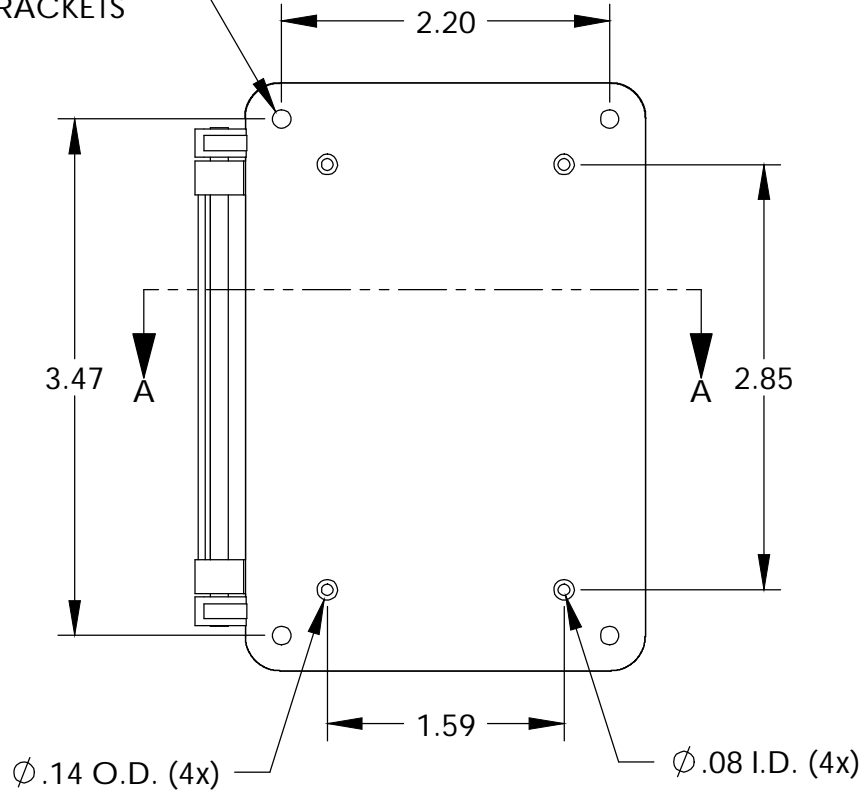
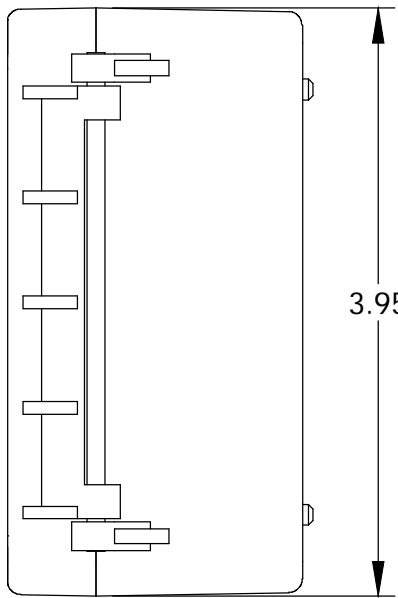

REFERENCE SHOWN WITH MOUNTING BRACKETS
ASSEMBLED (SHIPPED UNASSEMBLED AND
SUPPLIED WITH M4x.7 x .33" LG. PAN HD. SCREWS)

MATERIAL: ALUMINUM ADC-12
FINISH: SMOOTH BLACK POWDERCOAT

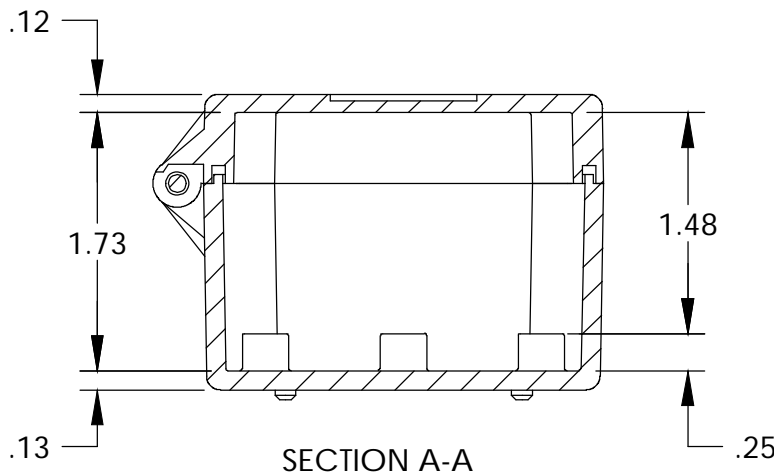

SECTION A-A

PARTS LIST

+/- .005 BETWEEN HOLE CENTERS +/- .015 FROM SHEARED EDGE +/- .032 FROM A BENT SURFACE +/- .062 BETWEEN ASSEMBLED SURFACES UNLESS OTHERWISE SPECIFIED		CAD GENERATED DRAWING. DO NOT MANUALLY UPDATE	
APPROVALS		DATE	
DRAWN		DP	
CHECKED		5/31/05	
APPROVED			

BUD INDUSTRIES INC.

NEMA HINGED BOX

FINISH	AS NOTED	SCALE	DWG. NO.	REV.
QTY.	USED ON	DO NOT SCALE DRAWING	AN-2900	
		CAD FILE:	SHEET 1 OF 1	

Mouser Electronics

Authorized Distributor

Click to View Pricing, Inventory, Delivery & Lifecycle Information:

[Bud Industries:](#)

[AN-2900](#)