

DASH NO.	M CODE	MADE FROM
----------	--------	-----------

GSD

REVISIONS

ISSUE	CHANGES
2	CN 27545 C SD 11/07/85

KTH-2042

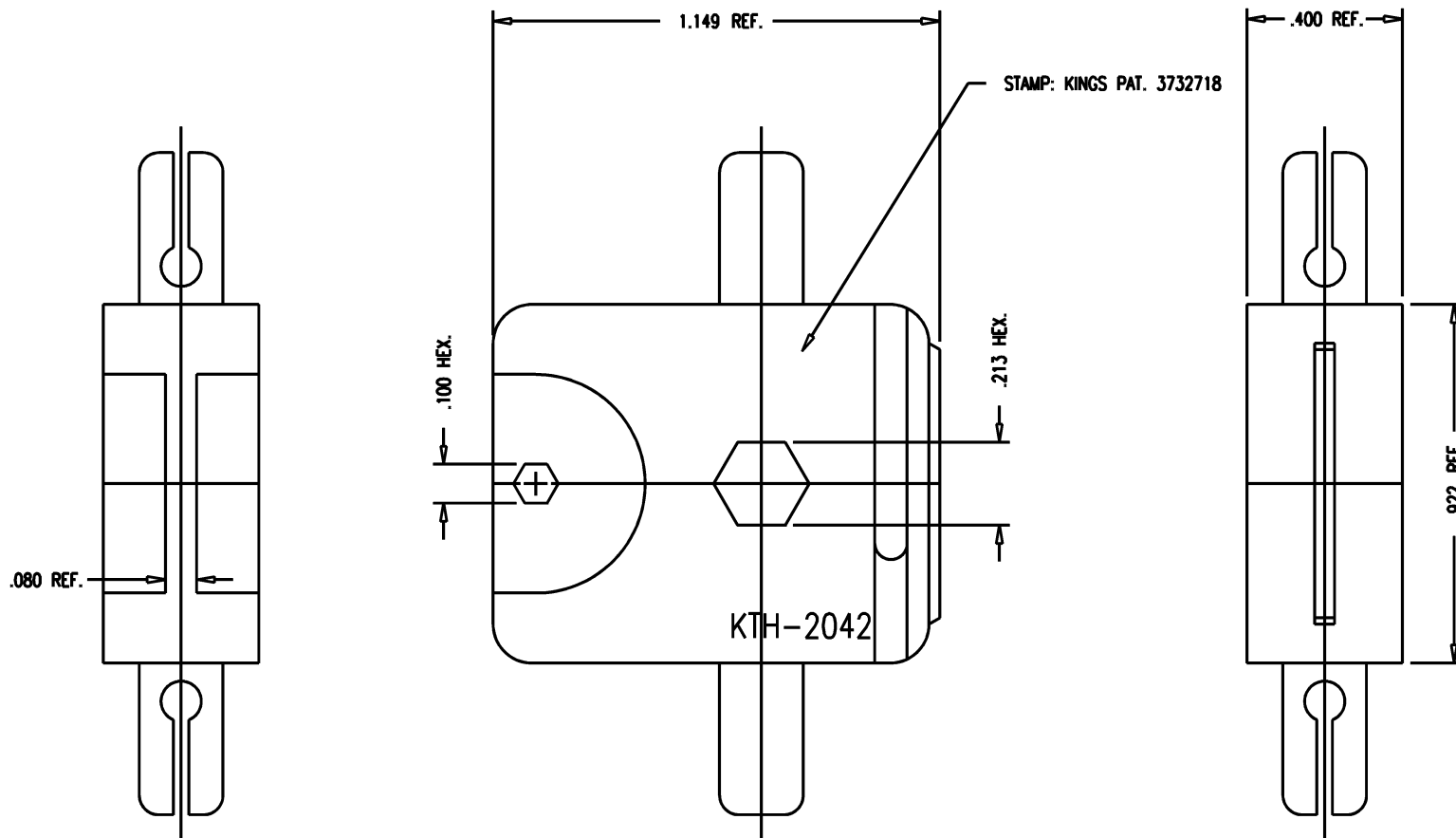

KTH-2042

NOTES:

1. FOR USE WITH RG-55, 58, 141, 142, 223, ITT BA 13077A & BA 14349 CABLE GROUPS.
2. MATERIAL: ALLOY STEEL
3. FINISH: BLACK OXIDE

WJM1290

SCALE 3:1

APPROX SURFACE AREA

USED ON

REF:

DIE, CRIMP

DRAWN WJM	DATE 08/19/91
DESIGN MJB	DATE 08/26/91
APPR.	DATE

KINGS
ELECTRONICS CO., INC.
TUCKAHOE, NEW YORK 10707

KTH-2042

GSD

Mouser Electronics

Authorized Distributor

Click to View Pricing, Inventory, Delivery & Lifecycle Information:

[Winchester Interconnect:](#)

[KTH-2042](#)