

SD

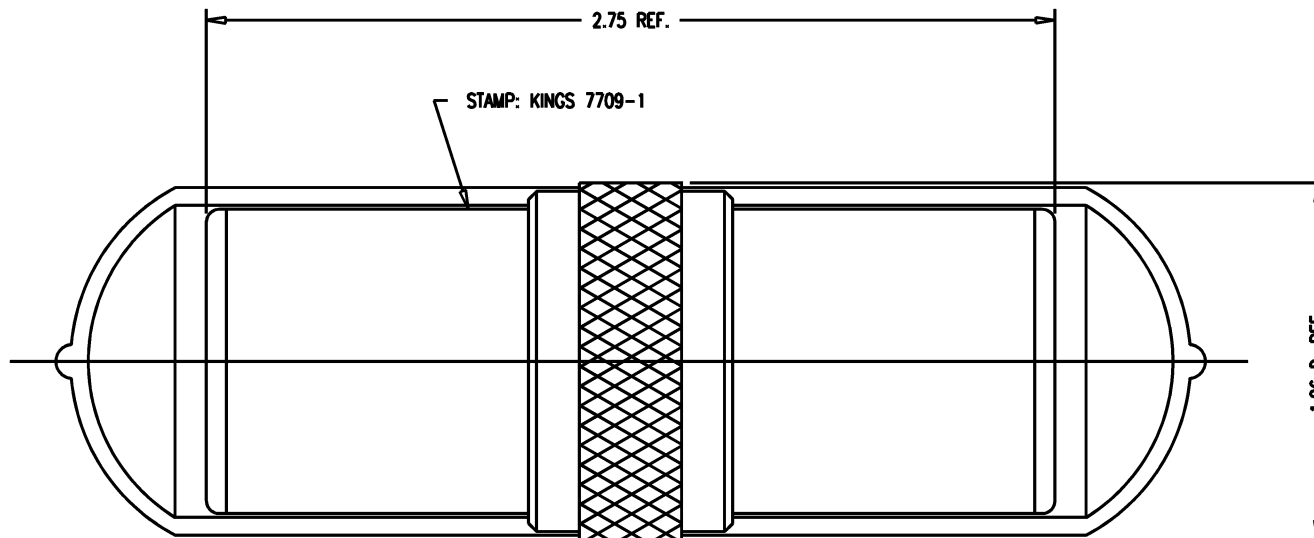

## NOTES:

- MATERIALS:
  - INSULATORS-TEFLON, ASTM-D-4894
  - CAP-VINYL
  - CENTER CONTACT
  - OUTER CONTACT SPRING } BER. COP., ASTM-B-196
  - INSERT
  - ALL OTHER METAL PARTS-BRASS, ASTM-B16
- FINISHES:
  - CENTER CONTACT
  - OUTER CONTACT SPRINGS } GOLD PLATE PER MIL-G-45204
  - ALL OTHER METAL PARTS-KINGS TARNISH RESISTANT NICKEL FINISH (TR-5)
- ELECTRICAL CHARACTERISTICS:
  - NOMINAL IMPEDANCE: 75 OHMS
  - FREQUENCY RANGE: DC-500 MHZ
  - VOLTAGE BREAKDOWN: CENTER CONDUCTOR/INNER GROUND: 1500 VRMS
  - INNER GROUND/OUTER GROUND: 500 VRMS

SD

7709-1

## REVISIONS

ISSUE	CHANGES
0	ER 35439 KH 04/20/95
1	CN 37274 D PG 03/11/97

7709-1G

SCALE 2:1

APPROX SURFACE AREA

USED ON

REF: KP-8040-000-000

ADAPTER, F-F, TRI-LOC  
SERIAL DIGITAL

DRAWN KH	DATE 04/20/95
DESIGN DW	DATE 04/21/95
APPR.	DATE

**KINGS**  
ELECTRONICS CO., INC.  
TUCKAHOE, NEW YORK 10707

7709-1

# Mouser Electronics

Authorized Distributor

Click to View Pricing, Inventory, Delivery & Lifecycle Information:

[Winchester Interconnect:](#)

[7709-1](#)