

DASH NO.	M CODE	MADE FROM
----------	--------	-----------

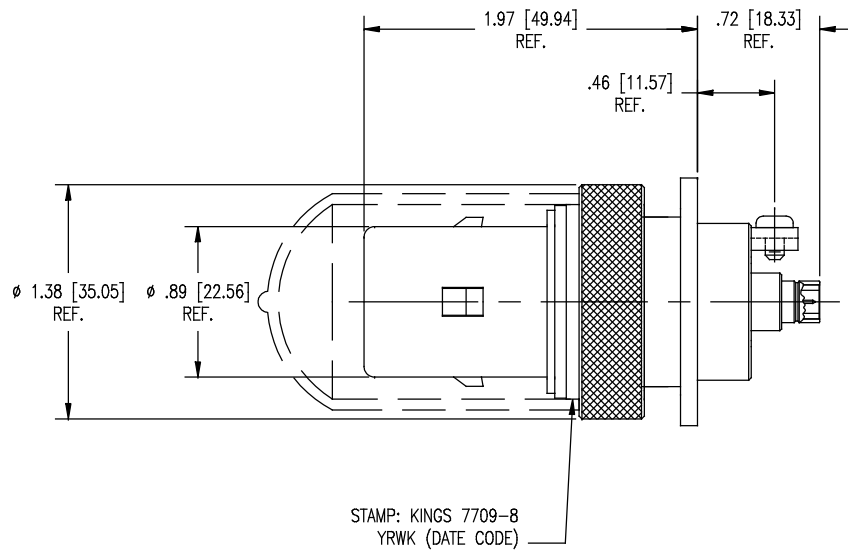

#### NOTES:

- MATERIALS:**  
 INSULATORS: TEFLON, ASTM-D4894  
 GASKETS: SILICONE RUBBER, A-A-59588  
 CONDUCTIVE GASKETS: CONSIL C 87-10004, 60-70 DUROMETER  
 CONTACT TIPS: DELRIN 150  
 PROTECTIVE CAPS: VINYL  
 BODY: BERYLLIUM COPPER, ASTM-B196  
 ALL OTHER METAL PARTS: BRASS, ASTM-B16
- FINISHES:**  
 CENTER CONTACT: HARD GOLD PLATE, ASTM-B488  
 ALL OTHER METAL PARTS: NICKEL PLATE, SAE-AMS-QQ-N-290
- ELECTRICAL CHARACTERISTICS:**  
 NOMINAL IMPEDANCE: 75 OHMS  
 FREQUENCY RANGE: DC TO 500 MHz  
 WORKING VOLTAGE: 500 VRMS
- MECHANICAL CHARACTERISTICS:**  
 AXIAL PULL: 150 LBS.  
 OFF AXIS TORQUE: 110 IN-LBS.
- SIMILAR TO:** LEMO AZG-4A (MAY BE USED ON GRASSVALLEY/THOMPSON LDK-5000/LDK-6000 MARK2 WORLDCAM CAMERA)

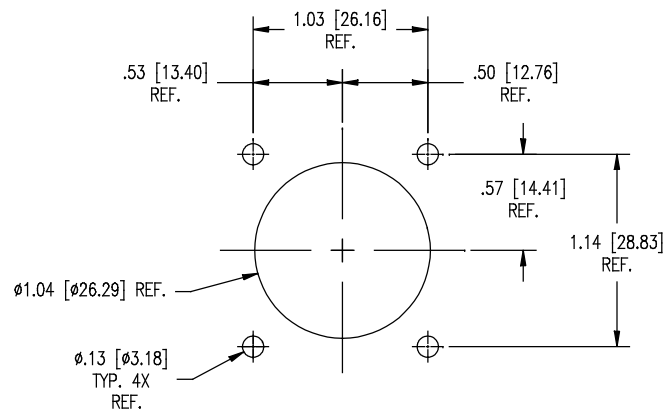
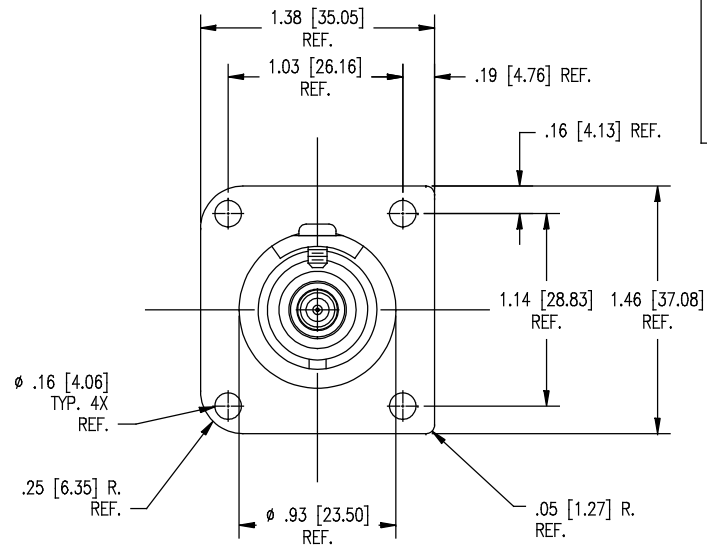

MOUNTING HOLE

GSD

GSD

7709-8

REVISIONS	
ISSUE	CHANGES
1	ER 39549 JPK 07/28/06
2	CN 39561 E JPK 08/07/06

7709-8SD
----------

SCALE	3 : 2
APPROX SURFACE AREA	N/A
USED ON	
REF:	EQR 904
ADPT, TRI-LOC TO SMB	
DRAWN	J. KENNEDY
DATE	05/23/05
DESIGN	J. KENNEDY
DATE	05/20/05
APPR.	
DATE	

<b>KINGS</b> ELECTRONICS CO., INC. ROCK HILL, SOUTH CAROLINA 29730
--

7709-8
--------

# Mouser Electronics

Authorized Distributor

Click to View Pricing, Inventory, Delivery & Lifecycle Information:

[Winchester Interconnect:](#)

[7709-8](#)