

GSD

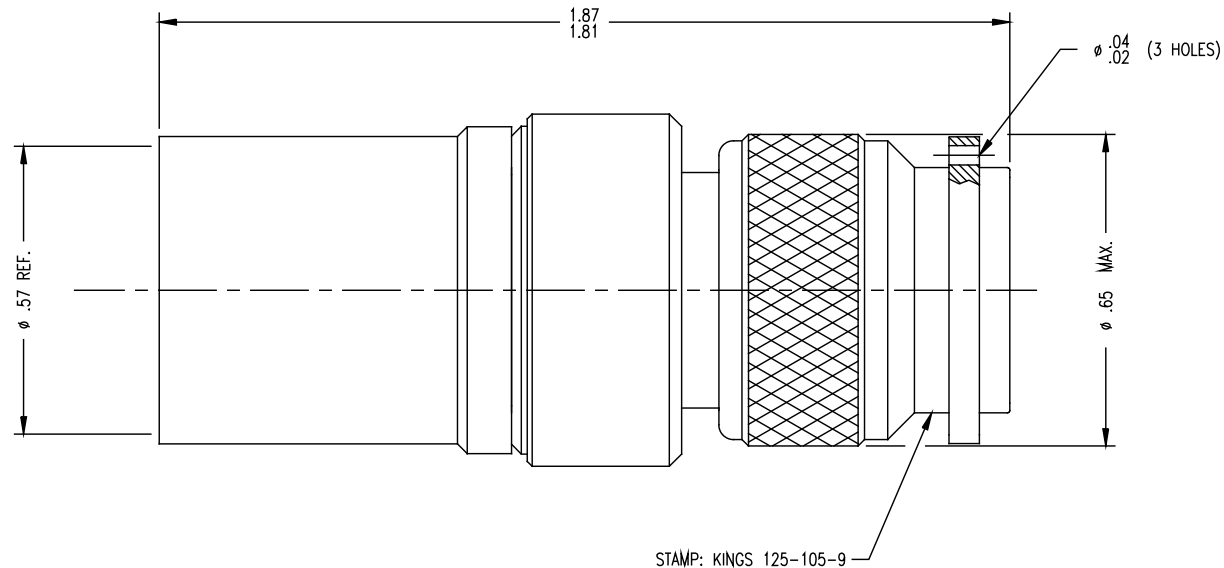

NOTES:

1. FOR USE WITH BOEING S280W503-6 & ADAMS RUSSELL FC48Z CABLE.
2. FOR CABLING INSTRUCTIONS SEE 3-546-2.
3. FOR CRIMPING USE DIE KTH-2229.
4. INTERFACE PER MIL-STD-348, FIG. 313-1.
5. CENTER CONTACT, 1-7446-1MA9, SUPPLIED UNASSEMBLED.
6. MARK PACKAGE: KINGS 125-105-9
XXXX (DATE CODE)
7. MATERIALS:
INSULATOR: TEFLON, ASTM-D4894
K-GRIP SLEEVE: COM. BRONZE, ASTM-B140
OUTER CONTACT: BER. COPPER, ASTM-B196
GASKET: SILICONE RUBBER, A-A-59588
C-RING: PHOSPHOR BRONZE, ASTM-B103
ALL OTHER METAL PARTS: BRASS, ASTM-B16
8. FINISHES:
CENTER CONTACT: GOLD PLATE, PER MIL-G-45204
OUTER CONTACT: SILVER PLATE PER QQ-S-365
ALL OTHER METAL PARTS: KINGS TARNISH RESISTANT NICKEL FINISH (TR-5)
9. ELECTRICAL CHARACTERISTICS:
NOMINAL IMPEDANCE: 50 OHMS
WORKING VOLTAGE: 500 VRMS
FREQUENCY RANGE: DC TO 11 GHZ

STAMP: KINGS 125-105-9

125-105-9

REVISIONS

ISSUE	CHANGES	
	DATE	BY
0	ER 35986 ME 12/19/94	
1	CN 35776 E KH 02/24/95	
2	CN 39557 E DRK 08/04/06	

SCALE 4:1

APPROX SURFACE AREA

WAS: E-18477

USED ON

REF: LOCKHEED

PLUG, TNC

DRAWN	MJB	DATE	08/09/94
DESIGN	CT	DATE	08/09/94
APPR.		DATE	

KINGS

ELECTRONICS CO., INC.
ROCK HILL, SOUTH CAROLINA 29730

125-105-9

GSD

Mouser Electronics

Authorized Distributor

Click to View Pricing, Inventory, Delivery & Lifecycle Information:

[Winchester Interconnect:](#)

[125-105-9](#)