

DO NOT  
SCALE FROM  
THIS PRINT

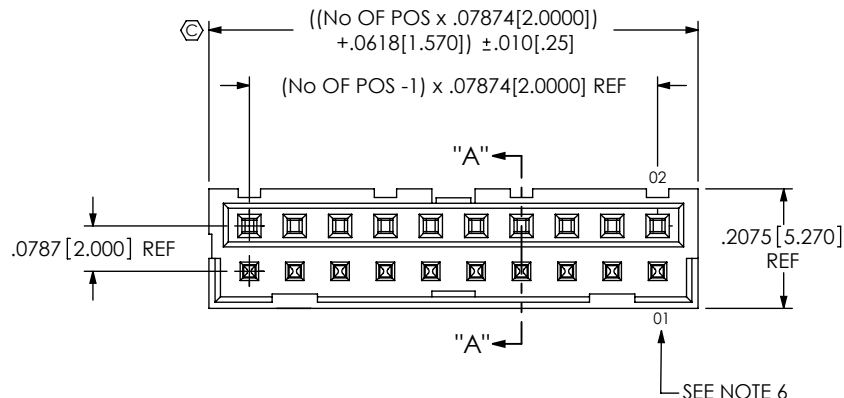

FIG 1  
LS2-110-01-X-D SHOWN

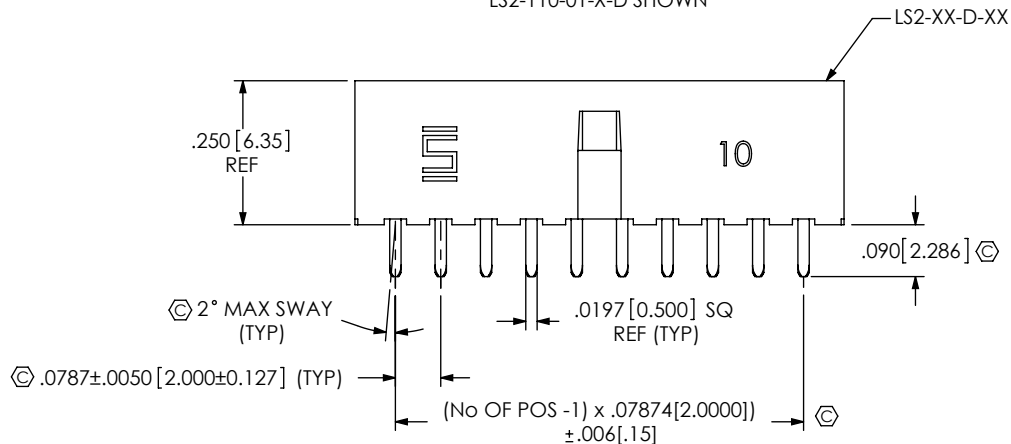

TABLE 2

STYLE	OPTION	TERMINAL	CONTACT
-01	---	T-1S13-20-XXX-2	C-79-01-XXX
	-RA1	T-1S13-03-XXX-2	C-79-12-XXX
	-RA2	T-1S13-10-XXX-2	C-79-12-XXX
-02	---	T-1S13-13-XXX-2	C-79-12-XXX

NOTES:

1. Ⓢ REPRESENTS A CRITICAL DIMENSION.
2. BURR ALLOWANCE: .003[.08] MAX.
3. MAXIMUM CUT FLASH: .015[.38].
4. MINIMUM PUSHOUT FORCE: TERMINALS: 2 LBS, CONTACTS: .5 LBS.
5. MAXIMUM ALLOWABLE BOW: .002 INCH/INCH AFTER ASSEMBLY.
6. SEE APPLICATION VIEWS (SHEET 3) FOR POSITION 01 LOCATION.
7. ALL PIN TO PIN DIMENSIONS TO BE MEASURED FROM TIP TO TIP.
8. DIMENSION TO BE MEASURED AT BEND.
9. SHEAR TAILS TO DIMENSION SHOWN.

LS2-1XX-XX-XX-D-XXX-X

No OF POSITIONS  
-05, -10, -15, -20,  
-25, -30  
(PER ROW)

LEAD STYLE  
-01: THROUGH HOLE  
-02: SURFACE MOUNT  
(SEE FIG 2)

PLATING SPECIFICATION  
-F: FLASH SELECTIVE GOLD  
(USE T-1S13-XX-F-2 & C-79-XX-F)  
-FM: FLASH SELECTIVE GOLD  
MATTE TIN REMAINDER  
(USE T-1S13-XX-F-2 & C-79-XX-F)  
-L: LIGHT SELECTIVE GOLD  
(USE T-1S13-XX-L-2 & C-79-XX-L)  
-LM: LIGHT SELECTIVE GOLD  
MATTE TIN REMAINDER  
(USE T-1S13-XX-L-2 & C-79-XX-L)  
-S: SELECTIVE GOLD  
(USE T-1S13-XX-S-2 & C-79-XX-S)  
-SM: SELECTIVE GOLD  
MATTE TIN REMAINDER  
(USE T-1S13-XX-S-2 & C-79-XX-S)  
-G: GOLD  
(USE T-1S13-XX-G-2 & C-79-XX-G)  
-H: HEAVY GOLD  
(USE T-1S13-XX-H-2 & C-79-XX-H)

OPTION  
-K: POLYIMIDE FILM PAD  
(USE K-DOT-.246-.375-.005, SEE FIG 5)  
[LEAD STYLE -02 ONLY]  
-A: ALIGNMENT PIN  
(USE LS2-XX-D-XX-A, SEE FIG 6)  
[LEAD STYLE -02 ONLY]  
-TR: TAPE & REEL

TAIL OPTION  
-RA1: RIGHT ANGLE-  
SHROUD DOWN (SEE FIG 3)  
-RA2: RIGHT ANGLE-  
SHROUD UP (SEE FIG 4)  
[AVAILABLE ONLY ON LEAD STYLE -01]

ROW SPECIFICATION  
-D: DOUBLE (USE LS2-XX-D-XX)

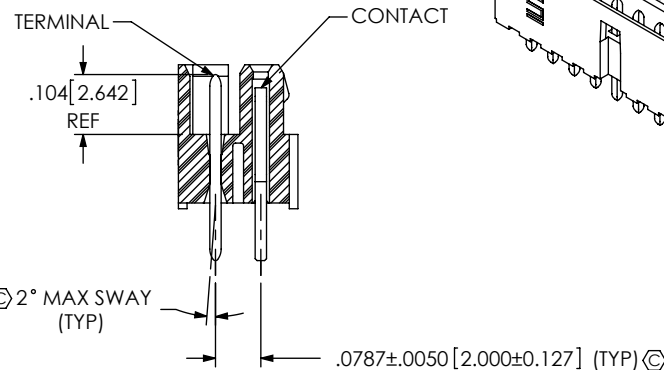

SECTION "A"-"A"

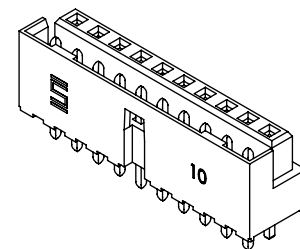

UNLESS OTHERWISE SPECIFIED,  
DIMENSIONS ARE IN INCHES.

TOLERANCES ARE:

DECIMALS ANGLES  
.XX: ±.01 [.3] 2°  
.XXX: ±.005 [.13]  
.XXXX: ±.0020 [.051]

PROPRIETARY NOTE

THIS DOCUMENT CONTAINS INFORMATION  
CONFIDENTIAL AND PROPRIETARY TO  
SAMTEC, INC. AND SHALL NOT BE REPRODUCED  
OR TRANSFERRED TO OTHER DOCUMENTS OR  
DISCLOSED TO OTHERS OR USED FOR ANY  
PURPOSE OTHER THAN THAT WHICH IT WAS  
OBTAINED WITHOUT THE EXPRESSED WRITTEN  
CONSENT OF SAMTEC, INC.

MATERIAL: DO NOT SCALE DRAWING  
INSULATOR: LCP, COLOR: BLACK  
SOCKET: PHOS BRONZE  
TERMINAL: PHOS BRONZE

SHEET SCALE: 3:1

**samtec**

520 PARK EAST BLVD, NEW ALBANY, IN 47150  
PHONE: 812-944-6733 FAX: 812-948-5047  
e-Mail: info@SAMTEC.com code: 55322

DESCRIPTION:

2mm TERMINAL/SOCKET COMBO

DWG. NO.

LS2-1XX-XX-XX-D-XXX-X

BY: DEAN P

4/24/2002

SHEET 1 OF 4

# REVISION S

**FIG 2**  
LS2-110-02-X-D SHOWN  
[DIFFERENT AS SHOWN, OTHERWISE SAME AS FIG. 1]

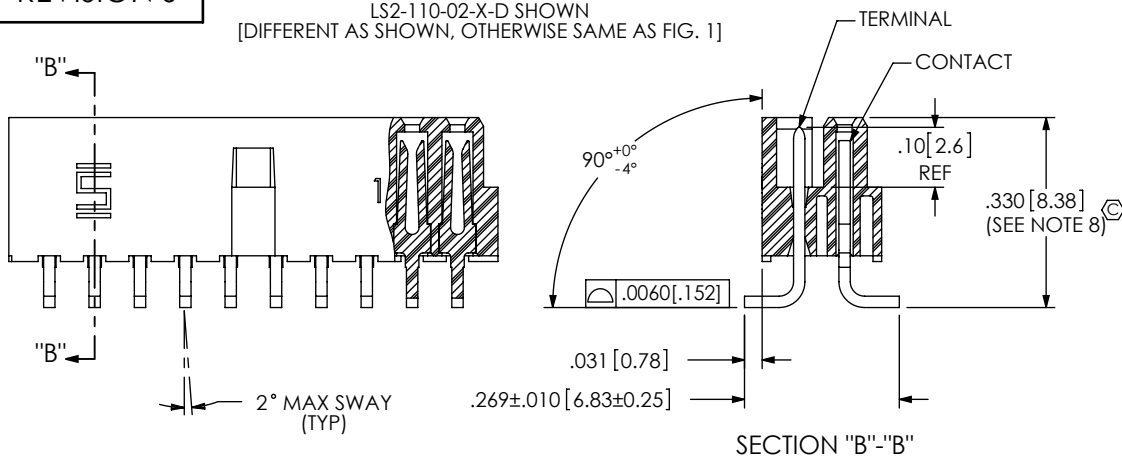

## STYLE -02-D IN-PROCESS VIEWS

IN-PROCESS 1

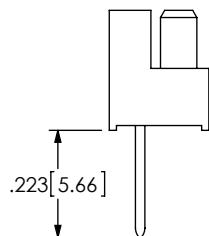

IN-PROCESS 2

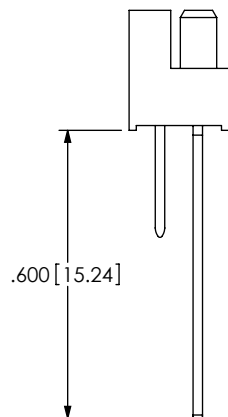

IN-PROCESS 3

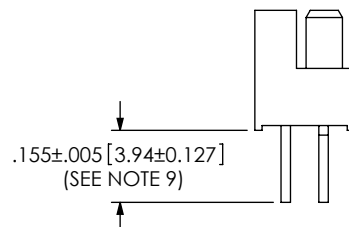

**FIG 6**

-A: ALIGNMENT PIN OPTION  
LS2-110-02-X-D-A SHOWN  
[DIFFERENT AS SHOWN, OTHERWISE SAME AS FIG 2]

LS2-XX-D-XX-A

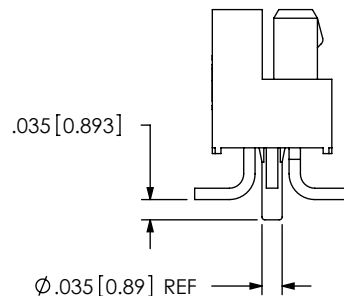
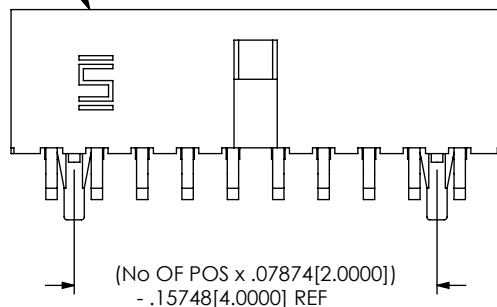

F:\DWG\MISC\MKTG\LS2-1XX-XX-XX-D-XXX-X-MKT.SLDDRW

## PACKAGING VIEWS

STYLE -01

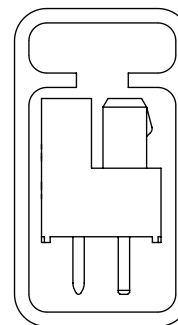

TUBE: PT-1-24-04-09  
PLUG: TP-07

STYLE -02

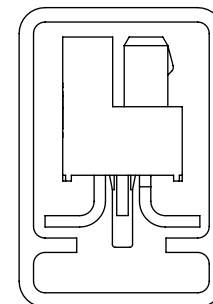

TUBE: PT-1-24-01-123  
PLUG: TP-03

STYLE -01-RA1

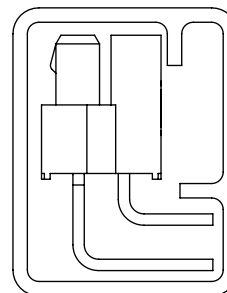

TUBE: PT-1-24-01-124  
PLUG: TP-07

STYLE -01-RA2

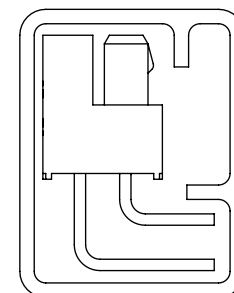

TUBE: PT-1-24-01-124  
PLUG: TP-07

### PROPRIETARY NOTE

THIS DOCUMENT CONTAINS INFORMATION  
CONFIDENTIAL AND PROPRIETARY TO  
SAMTEC, INC. AND SHALL NOT BE REPRODUCED  
OR TRANSFERRED TO OTHER DOCUMENTS OR  
DISCLOSED TO OTHERS OR USED FOR ANY  
PURPOSE OTHER THAN THAT WHICH IT WAS  
OBTAINED WITHOUT THE EXPRESSED WRITTEN  
CONSENT OF SAMTEC, INC.

DO NOT SCALE DRAWING

SHEET SCALE: 3:1

**samtec**

520 PARK EAST BLVD, NEW ALBANY, IN 47150  
PHONE: 812-944-6733 FAX: 812-948-5047  
e-Mail: info@SAMTEC.com code: 55322

DESCRIPTION:  
2mm TERMINAL/SOCKET COMBO

DWG. NO.  
LS2-1XX-XX-XX-D-XXX-X

BY: DEAN P 4/24/2002 SHEET 2 OF 4

REVISION S

IN-PROCESS 1

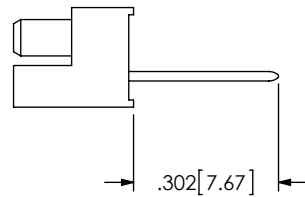

IN-PROCESS 2

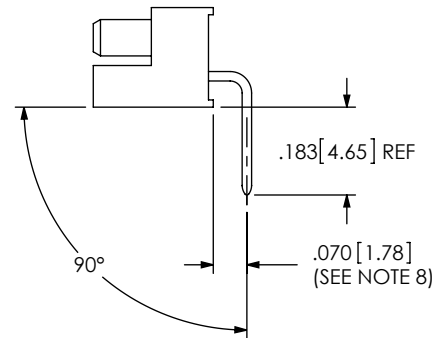

IN-PROCESS 1

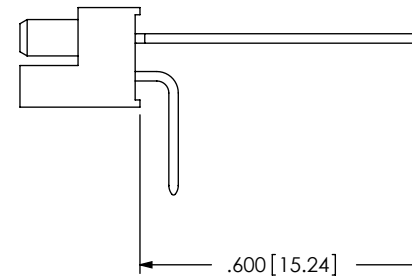

IN-PROCESS 4

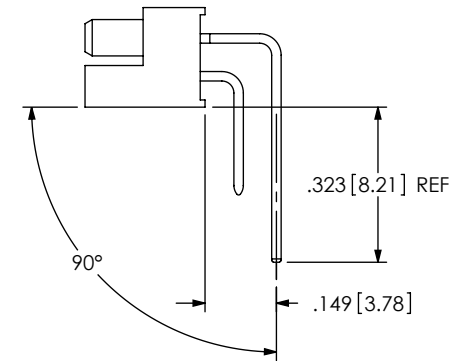

### STYLE -01-RA1 IN-PROCESS VIEWS

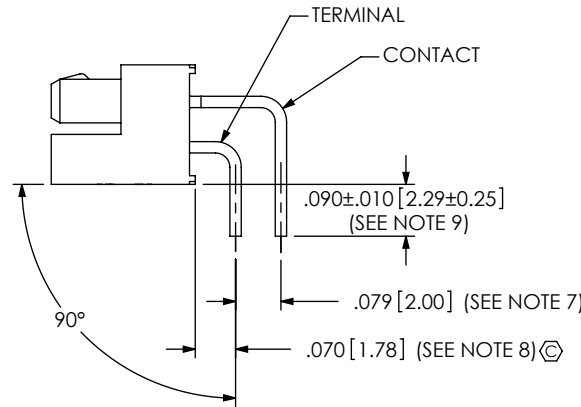
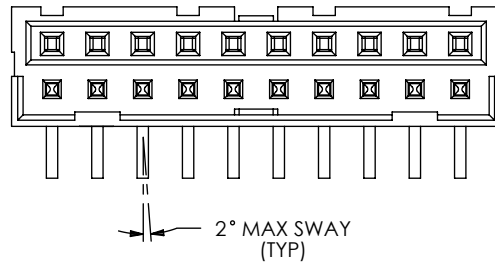
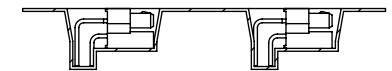
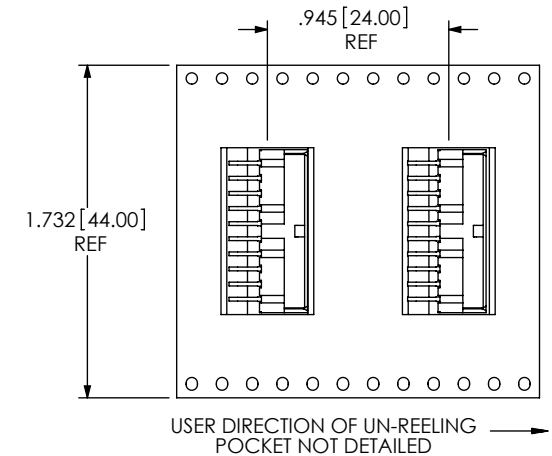

FIG 3  
LS2-110-01-X-D-RA1 SHOWN  
[DIFFERENT AS SHOWN, OTHERWISE SAME AS FIG 1]  
\* AVAILABLE ONLY ON LEAD STYLE -01 \*



### STYLE-01-RA1 PACKAGING VIEW

PARTS MUST BE ORIENTED PER THE DESIGN OF THE POCKET AND POCKET TOOL. POCKETS DESIGNED AFTER REVISION Q MUST ORIENT PARTS PER THIS VIEW.

### APPLICATION VIEWS

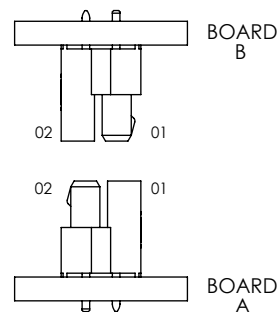

PARALLEL  
BOARD-TO-BOARD

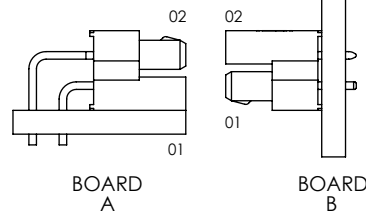

PERPENDICULAR  
BOARD-TO-BOARD

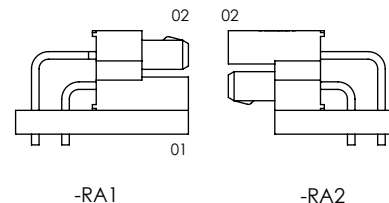

IN-LINE PARALLEL  
BOARD-TO-BOARD

F:\DWG\MISC\MKTG\LS2-1XX-XX-XX-D-XXX-X-MKT.SLDDRW

#### PROPRIETARY NOTE

THIS DOCUMENT CONTAINS INFORMATION CONFIDENTIAL AND PROPRIETARY TO SAMTEC, INC. AND SHALL NOT BE REPRODUCED OR TRANSFERRED TO OTHER DOCUMENTS OR DISCLOSED TO OTHERS OR USED FOR ANY PURPOSE OTHER THAN THAT WHICH IT WAS OBTAINED WITHOUT THE EXPRESSED WRITTEN CONSENT OF SAMTEC, INC.

DO NOT SCALE DRAWING

SHEET SCALE: 3:1

**samtec**

520 PARK EAST BLVD, NEW ALBANY, IN 47150  
PHONE: 812-944-6733 FAX: 812-948-5047  
e-Mail: info@SAMTEC.com code: 55322

DESCRIPTION:  
2mm TERMINAL/SOCKET COMBO

DWG. NO.  
LS2-1XX-XX-XX-D-XXX-X

BY: DEAN P 4/24/2002 SHEET 3 OF 4

## IN-PROCESS 1

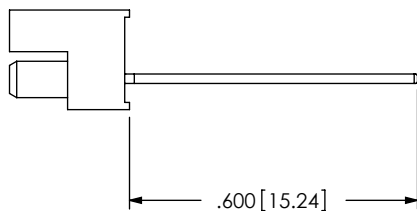

## IN-PROCESS 2

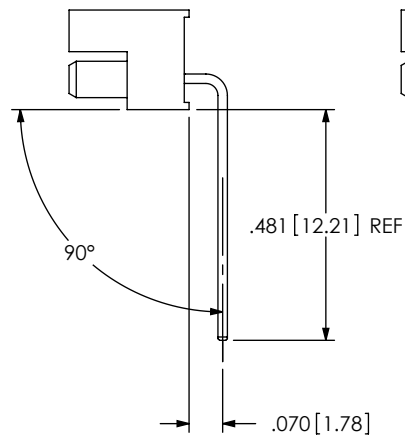

## IN-PROCESS 3

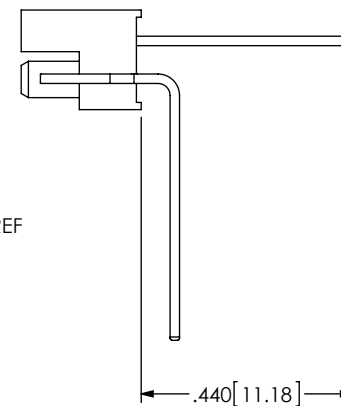

## IN-PROCESS 4

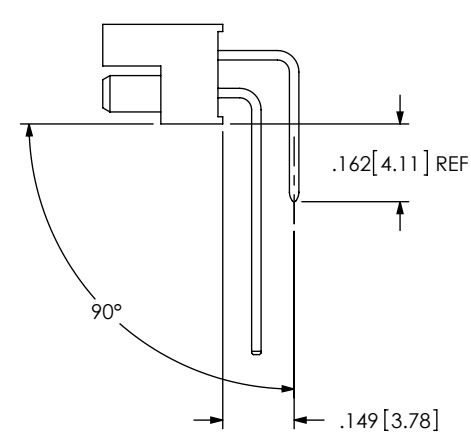

## STYLE -01-RA2 IN-PROCESS VIEWS

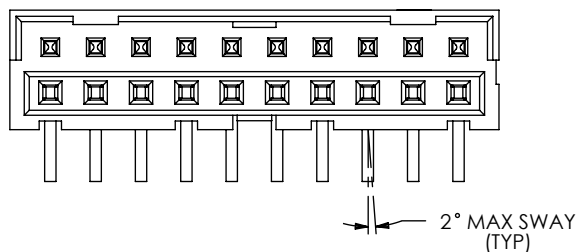

FIG 4

LS2-110-01-X-D-RA2 SHOWN  
[DIFFERENT AS SHOWN, OTHERWISE SAME AS FIG 1]

\* AVAILABLE ONLY ON LEAD STYLE -01 \*

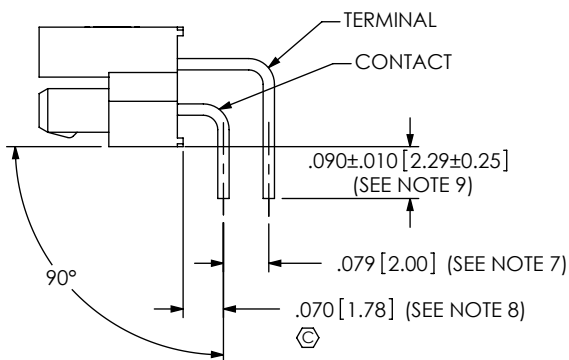
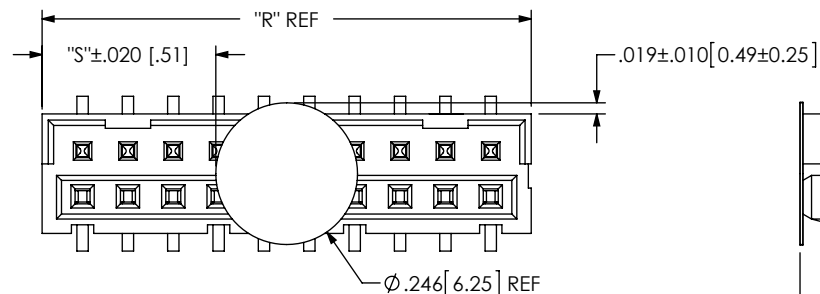
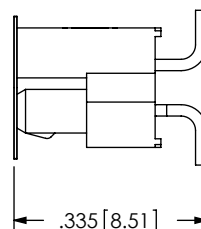

FIG 5

-K: POLYIMIDE FILM PAD OPTION



NOTE:  
"R" = (No OF POS x .07874 [2.0000]) + .06181 [1.570]  
"S" = ("R" - .2460 [6.248]) / 2



F:\DWG\MISC\MKTG\LS2-1XX-XX-XX-D-XXX-X-MKT.SLDDRW

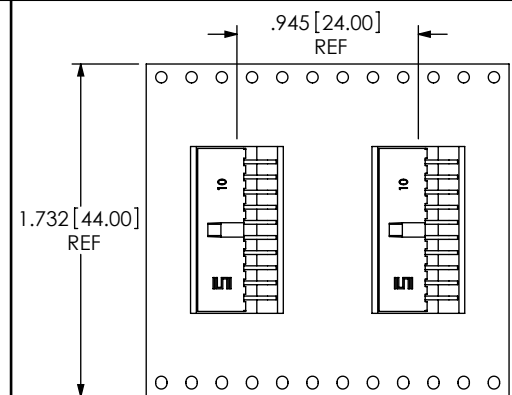

USER DIRECTION OF UN-REELING  
POCKET NOT DETAILED

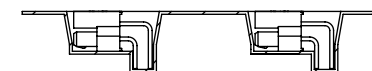

STYLE-01-RA2 PACKAGING VIEW  
PARTS MUST BE ORIENTED PER THE DESIGN  
OF THE POCKET AND POCKET TOOL.  
POCKETS DESIGNED AFTER REVISION Q MUST  
ORIENT PARTS PER THIS VIEW.

## PROPRIETARY NOTE

THIS DOCUMENT CONTAINS INFORMATION  
CONFIDENTIAL AND PROPRIETARY TO  
SAMTEC, INC. AND SHALL NOT BE REPRODUCED  
OR TRANSFERRED TO OTHER DOCUMENTS OR  
DISCLOSED TO OTHERS OR USED FOR ANY  
PURPOSE OTHER THAN THAT WHICH IT WAS  
OBTAINED WITHOUT THE EXPRESSED WRITTEN  
CONSENT OF SAMTEC, INC.

DO NOT SCALE DRAWING

SHEET SCALE: 3:1

**samtec**

520 PARK EAST BLVD, NEW ALBANY, IN 47150  
PHONE: 812-944-6733 FAX: 812-948-5047  
e-Mail: info@SAMTEC.com code: 55322

DESCRIPTION:

2mm TERMINAL/SOCKET COMBO

DWG. NO.

LS2-1XX-XX-XX-D-XXX-X

BY: DEAN P

4/24/2002

SHEET 4 OF 4

# Mouser Electronics

Authorized Distributor

Click to View Pricing, Inventory, Delivery & Lifecycle Information:

[Samtec:](#)

[LS2-110-01-F-D-RA1-TR](#)