

DO NOT
SCALE FROM
THIS PRINT

DESIGNED & DIMENSIONED
IN MILLIMETERS[INCHES]

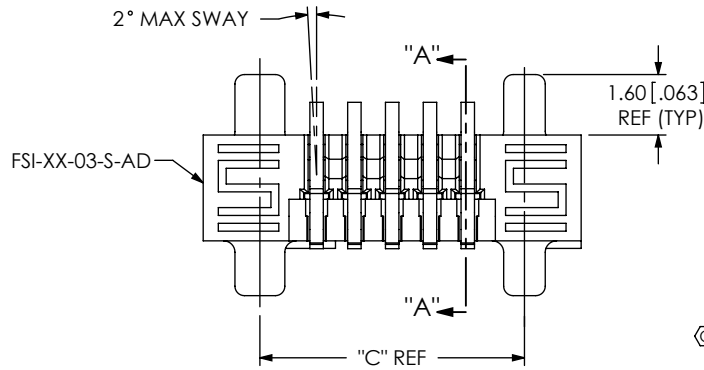
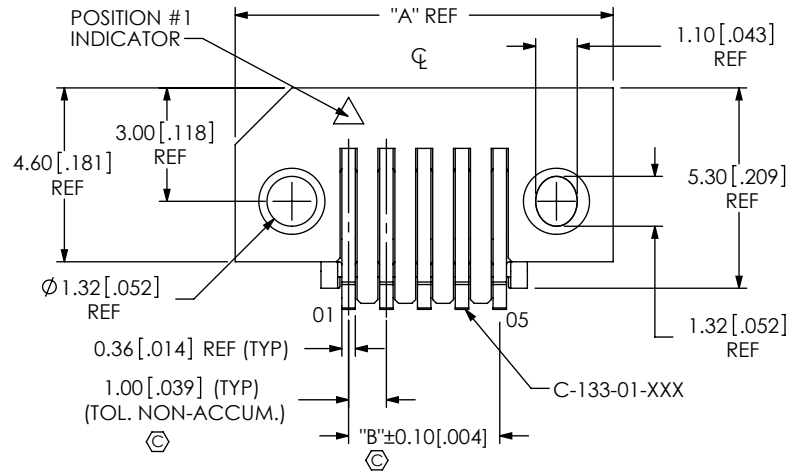

| TABLE 3 | |
|-------------|---------------|
| BODY HEIGHT | "D" |
| -03 | 3.00 [0.118] |
| -06 | 6.00 [0.236] |
| -10 | 10.00 [0.394] |

| TABLE 2 | |
|--------------|-------------|
| No. OF POS. | COPLANARITY |
| -05 THRU -35 | 0.10 [.004] |
| -40 THRU -50 | 0.15 [.006] |

FIG 1
(FSI-105-03-X-S-AD-TR SHOWN)

| TABLE 1 | | | |
|------------|---------------|-----------------|-----------------|
| No. OF POS | "A" | "B" | "C" |
| -05 | 10.00 [0.394] | 4.000 [0.1575] | 7.000 [0.2756] |
| -10 | 15.00 [0.591] | 9.000 [0.3543] | 12.000 [0.4724] |
| -15 | 20.00 [0.787] | 14.000 [0.5512] | 17.000 [0.6693] |
| -20 | 25.00 [0.984] | 19.000 [0.7480] | 22.000 [0.8661] |
| -25 | 30.00 [1.181] | 24.000 [0.9449] | 27.000 [1.0630] |
| -30 | 35.00 [1.378] | 29.000 [1.1417] | 32.000 [1.2598] |
| -35 | 40.00 [1.575] | 34.000 [1.3386] | 37.000 [1.4567] |
| -40 | 45.00 [1.772] | 39.000 [1.5354] | 42.000 [1.6535] |
| -45 | 50.00 [1.969] | 44.000 [1.7323] | 47.000 [1.8504] |
| -50 | 55.00 [2.165] | 49.000 [1.9291] | 52.000 [2.0472] |

FSI-1XX-XX-X-S-X-XX-XX

No OF POSITIONS
THREADED: -10, -20, -30, -40, -50
NON-THREADED: -05 THRU -50
[IN MULTIPLES OF 5]

BODY HEIGHT
-03: 3mm (USE C-133-01-XXX)
-06: 6mm (USE C-133-02-XXX)
-10: 10mm (USE C-133-03-XXX)

PLATING SPECIFICATION
-L: 10μ" MIN Au/50μ" Ni IN CONTACT, TIN ON TAIL (-06 & -10 BODY HEIGHT ONLY)
-S: 30μ" MIN Au/50μ" Ni IN CONTACT, TIN ON TAIL (-06 & -10 BODY HEIGHT ONLY)
-G: 10μ" MIN Au/50μ" Ni IN CONTACT, 3μ" MIN Au/50μ" Ni ON TAIL (-03 BODY HEIGHT ONLY)
-H: 30μ" MIN Au/50μ" Ni IN CONTACT, 3μ" MIN Au/50μ" Ni ON TAIL (-03 BODY HEIGHT ONLY)

ROW SPECIFICATION
-S: SINGLE ROW

OPTION
-XX: BLANK FOR TUBED PARTS.
-TR: TAPE & REEL PACKAGING.
-WT: WELD TAB (SEE FIG 2)
(USE WT-54-01-X)
(FOR -06 & -10 HEIGHT OPTIONS)
(NOT AVAILABLE WITH THREADED INSERT OPTION)
-K: POLYIMIDE FILM PAD
(USE K-DOT-.256-.375-.005)
(AVAILABLE ONLY ON POSITIONS 40 & 50 WITH ANY THREADED INSERT OPTIONS)

ALIGNMENT PIN LOCATION
-AT: TOP SIDE (USE FSI-XX-XX-S-AT-X)
-AB: BOTTOM SIDE (USE FSI-XX-XX-S-AB-X)
-AD: DUAL (TOP & BOTTOM)
(USE FSI-XX-XX-S-AD-X)
(BLANK FOR NO ALIGNMENT PIN)

THREADED INSERT OPTION
-XX: BLANK FOR NON-THREADED INSERT
-E: THREADED INSERT
(SEE TABLE 6, SHT 3)
-M: THREADED INSERT
(SEE TABLE 6, SHT 3)

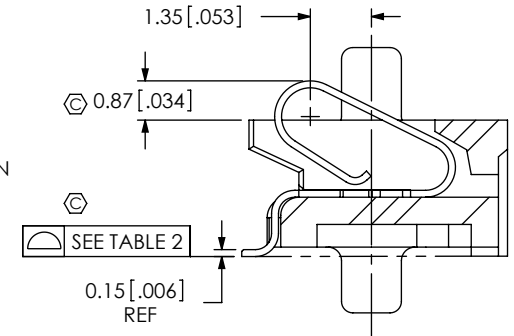
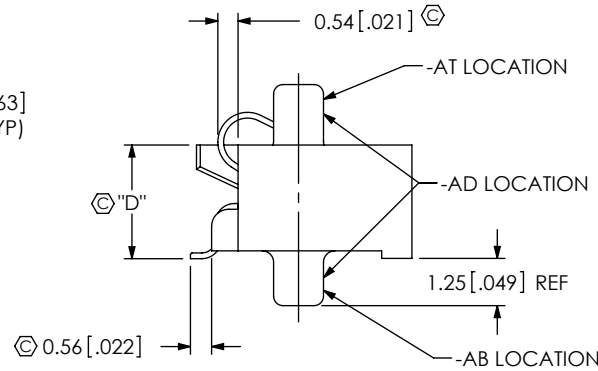

SECTION "A"- "A"
SCALE 6 : 1

NOTES:

- Ⓢ REPRESENTS A CRITICAL DIMENSION.
- MINIMUM PUSHOUT FORCE: 8 oz.
- LOAD INSERTS IN THE DIRECTION OF THE ARROW USING THERMAL INSERTION.
THREADED INSERT BODY HEIGHT: -03 TO BE FLUSH TO 0.13 [.005] BELOW HOUSING SURFACE.
BODY HEIGHT: -06 AND -10 TO BE FLUSH TO 0.90 [.035] BELOW HOUSING SURFACE.
- THREADED INSERT OPTION WITH -03 BODY HEIGHT MUST BE ABLE TO HANDLE 20 in-oz's OF TORQUE MIN WITHOUT ROTATING OR "LOOSENING", WITH -06 & -10 BODY HEIGHT MUST BE ABLE TO HANDLE 54 in-oz's OF TORQUE MIN WITHOUT ROTATING OR "LOOSENING".
- MINIMUM THREADED INSERT RETENTION: -03 BODY HEIGHT: 7 lbs, -06 & -10 BODY HEIGHT: 50 lbs.
- NOTE DELETED.
- HEAT STAKE FORM WILL PRODUCE RETENTION FLANGE AS SHOWN, GAP TO BE 0.25 [.010] MAX AFTER ASSEMBLY. ONLY FOR -06 & -10 BODY HEIGHT.
- NOT RECOMMENDED FOR INVERTED REFLOW SOLDER.
- FOR QUANTITIES UP TO 49 PCS, NO LEADER, TRAILER OR REEL WILL BE SUPPLIED, FOR QUANTITIES OF 50-124 PCS, NO LEADER OR TRAILER WILL BE SUPPLIED.

UNLESS OTHERWISE SPECIFIED,
DIMENSIONS ARE IN MILLIMETERS.
TOLERANCES ARE:
DECIMALS ANGLES
X.X: ±0.3 [.01]
X.XX: ±0.13 [.005]
X.XXX: ±0.051 [.0020]

PROPRIETARY NOTE
THIS DOCUMENT CONTAINS INFORMATION
CONFIDENTIAL AND PROPRIETARY TO
SAMTEC, INC. AND SHALL NOT BE REPRODUCED
OR TRANSFERRED TO OTHER DOCUMENTS OR
DISCLOSED TO OTHERS OR USED FOR ANY
PURPOSE OTHER THAN THAT WHICH IT WAS
OBTAINED WITHOUT THE EXPRESSED WRITTEN
CONSENT OF SAMTEC, INC.

MATERIAL: DO NOT SCALE DRAWING
INSULATOR: LCP COLOR: BLACK.
CONTACT: BeCu
INSERT: BRASS

SHEET SCALE: 1:0.2

samtec

520 PARK EAST BLVD, NEW ALBANY, IN 47150
PHONE: 812-944-6733 FAX: 812-948-5047
e-Mail: info@SAMTEC.com code 55322

DESCRIPTION:
1mm SINGLE ELEMENT INTERFACE

DWG. NO.
FSI-1XX-XX-X-S-X-XX-XX

BY: ROY LUO 06/14/2010 SHEET 1 OF 6

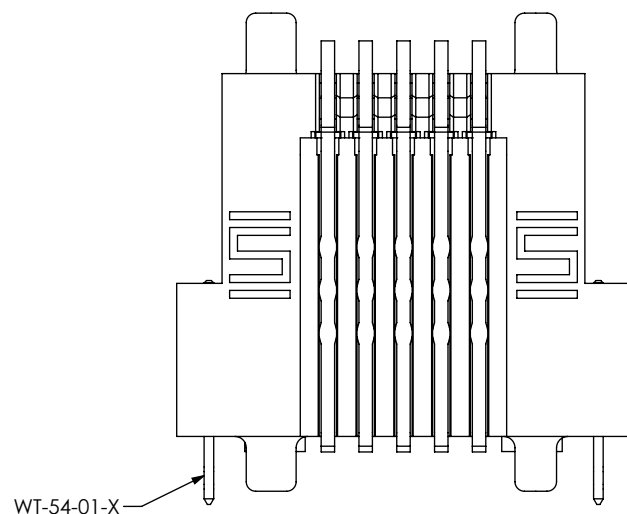
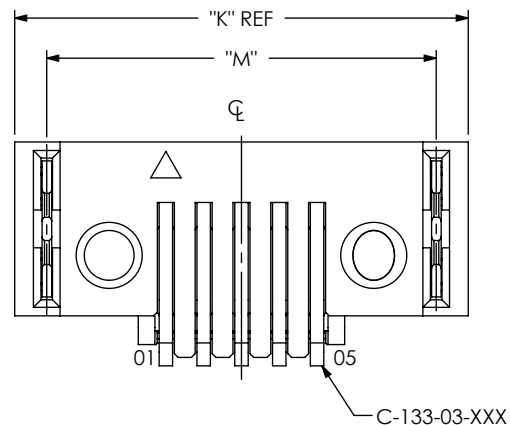
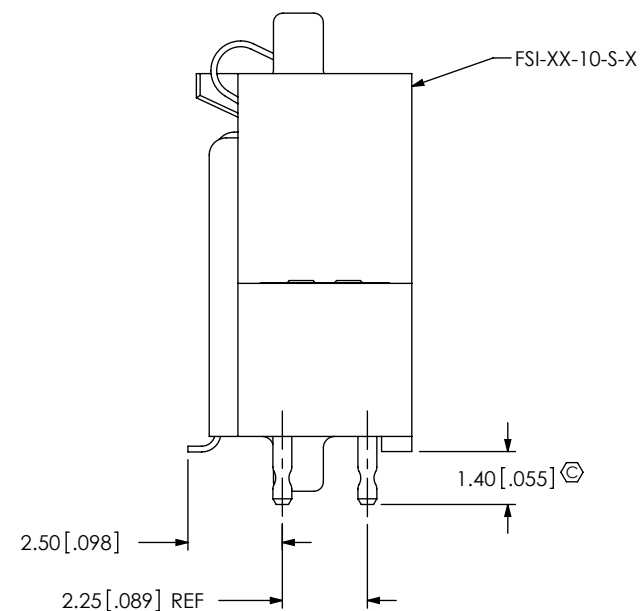

FIG 2
-WT OPTIONS
(FSI-105-10-X-S-AD-WT SHOWN)
(SAME AS FIG 1, EXCEPT AS SHOWN)
(FOR -06 & -10 HEIGHT ONLY)
(NOT AVAILABLE WITH THREADED INSERT OPTION)

| TABLE 4 | | |
|------------|---------------|-----------------|
| No. OF POS | "K" | "M" |
| -05 | 12.00 [0.472] | 10.305 [0.4057] |
| -10 | 17.00 [0.669] | 15.305 [0.6026] |
| -15 | 22.00 [0.866] | 20.305 [0.7994] |
| -20 | 27.00 [1.063] | 25.305 [0.9963] |
| -25 | 32.00 [1.260] | 30.305 [1.1931] |
| -30 | 37.00 [1.457] | 35.305 [1.3900] |
| -35 | 42.00 [1.654] | 40.305 [1.5868] |
| -40 | 47.00 [1.850] | 45.305 [1.7837] |
| -45 | 52.00 [2.047] | 50.305 [1.9805] |
| -50 | 57.00 [2.244] | 55.305 [2.1774] |



PROPRIETARY NOTE

THIS DOCUMENT CONTAINS INFORMATION
CONFIDENTIAL AND PROPRIETARY TO
SAMTEC, INC. AND SHALL NOT BE REPRODUCED
OR TRANSFERRED TO OTHER DOCUMENTS OR
DISCLOSED TO OTHERS OR USED FOR ANY
PURPOSE OTHER THAN THAT WHICH IT WAS
OBTAINED WITHOUT THE EXPRESSED WRITTEN
CONSENT OF SAMTEC, INC.

DO NOT SCALE DRAWING

SHEET SCALE: 5:1

samtec

520 PARK EAST BLVD, NEW ALBANY, IN 47150
PHONE: 812-944-6733 FAX: 812-948-5047
e-Mail: info@SAMTEC.com code 55322

DESCRIPTION:
1mm SINGLE ELEMENT INTERFACE

DWG. NO.
FSI-1XX-XX-X-S-X-XX-XX

BY: ROY LUO 06/14/2010 SHEET 2 OF 6

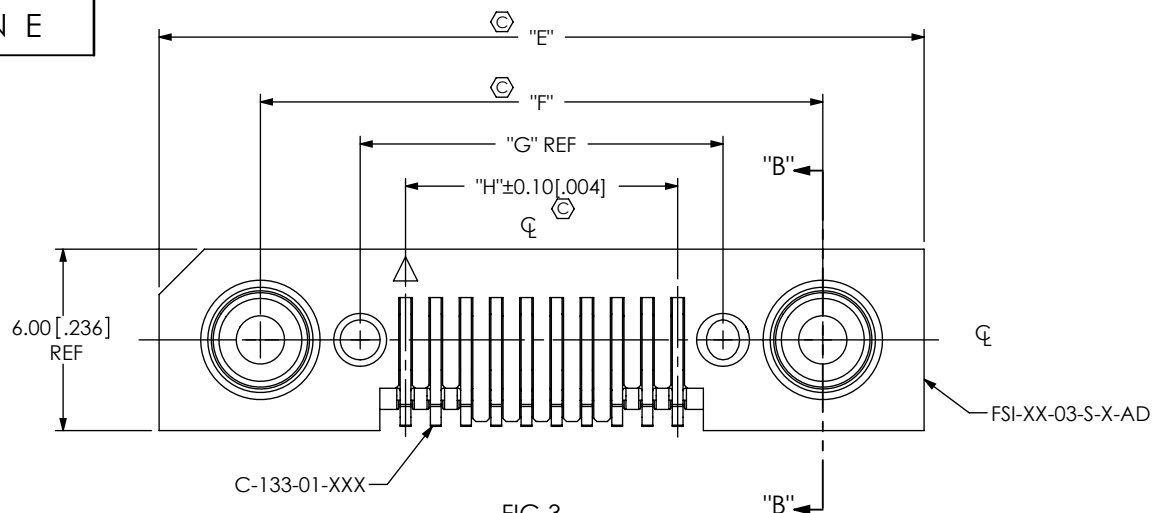
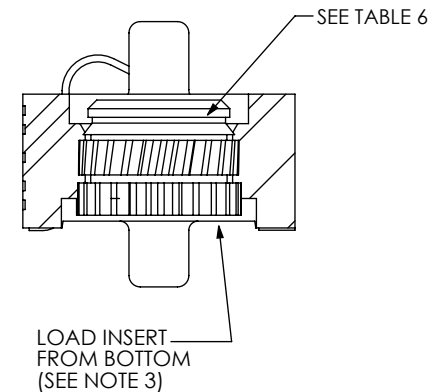

FIG 3
-M & -E THREADED OPTIONS
(FSI-110-03-X-S-X-AD-TR SHOWN)
(SAME AS FIG 1, EXCEPT AS SHOWN)
(FOR -10, -20 & -30 POS ONLY)



SECTION "B"- "B"
SCALE 6:1

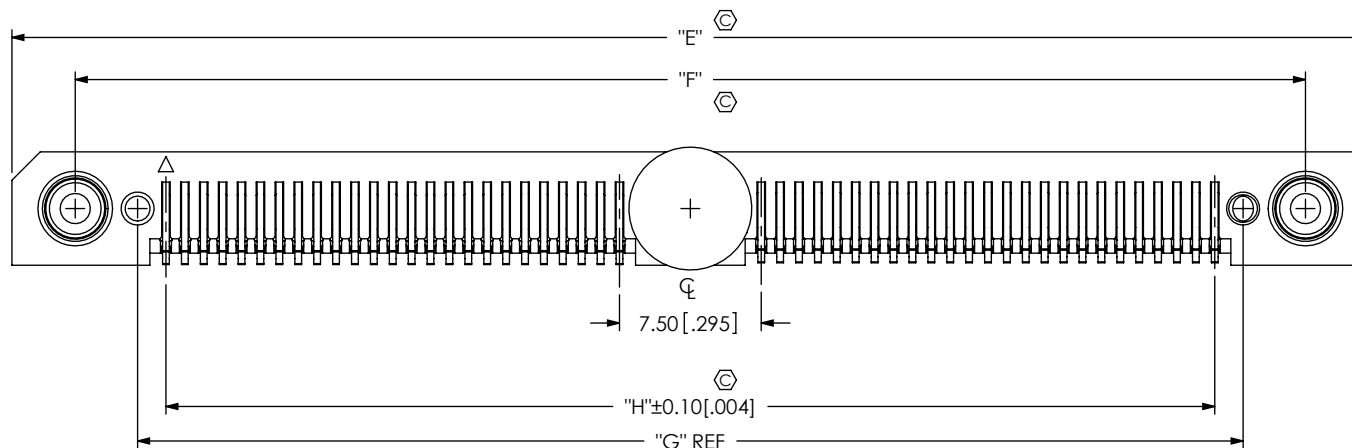

FIG 4
-M & -E THREADED OPTIONS
(FSI-150-03-X-S-X-AD-K SHOWN)
(SAME AS FIG 3, EXCEPT AS SHOWN)
(FOR -40 & -50 POS ONLY)

TABLE 5

| No. OF POS | "E" | "F" | "G" | "H" |
|------------|---------------|---------------|-----------------|-----------------|
| -10 | 25.30 [0.996] | 18.60 [0.732] | 12.000 [0.4724] | 9.000 [0.3543] |
| -20 | 35.30 [1.390] | 28.60 [1.126] | 22.000 [0.8661] | 19.000 [0.7480] |
| -30 | 45.30 [1.783] | 38.60 [1.520] | 32.000 [1.2598] | 29.000 [1.1417] |
| -40 | 61.80 [2.433] | 55.10 [2.169] | 48.500 [1.9094] | 45.500 [1.7913] |
| -50 | 71.80 [2.827] | 65.10 [2.563] | 58.500 [2.3031] | 55.500 [2.1850] |

F:\DWG\MISC\MKTG\FSI-1XX-XX-X-S-X-XX-XX-MKT.SLDDRW

TABLE 6

| OPTION | BODY HEIGHT | INSERT | THREADED |
|--------|-------------|-----------------|----------|
| -E | -03 | INS-C-2-56-100 | 2 x 56 |
| | -06 & -10 | INS-19-2-56-157 | 2 x 56 |
| -M | -03 | INS-C-M2-100-N | M2.0 x 4 |
| | -06 & -10 | INS-19-M2-157-N | M2.0 x 4 |

PROPRIETARY NOTE

THIS DOCUMENT CONTAINS INFORMATION
CONFIDENTIAL AND PROPRIETARY TO
SAMTEC, INC. AND SHALL NOT BE REPRODUCED
OR TRANSFERRED TO OTHER DOCUMENTS OR
DISCLOSED TO OTHERS OR USED FOR ANY
PURPOSE OTHER THAN THAT WHICH IT WAS
OBTAINED WITHOUT THE EXPRESSED WRITTEN
CONSENT OF SAMTEC, INC.

DO NOT SCALE DRAWING

SHEET SCALE: 5:1

samtec

520 PARK EAST BLVD, NEW ALBANY, IN 47150
PHONE: 812-944-6733 FAX: 812-948-5047
e-Mail: info@SAMTEC.com code 55322

DESCRIPTION:

1mm SINGLE ELEMENT INTERFACE

DWG. NO.

FSI-1XX-XX-X-S-X-XX-XX

BY: ROY LUO 06/14/2010 SHEET 3 OF 6

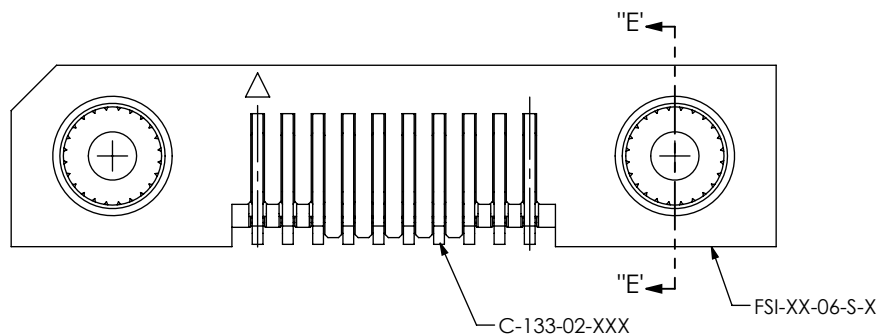
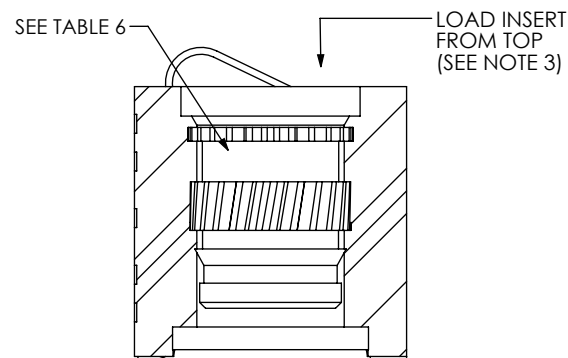
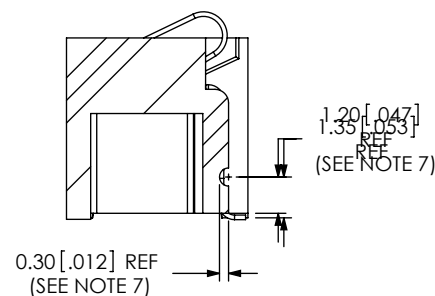
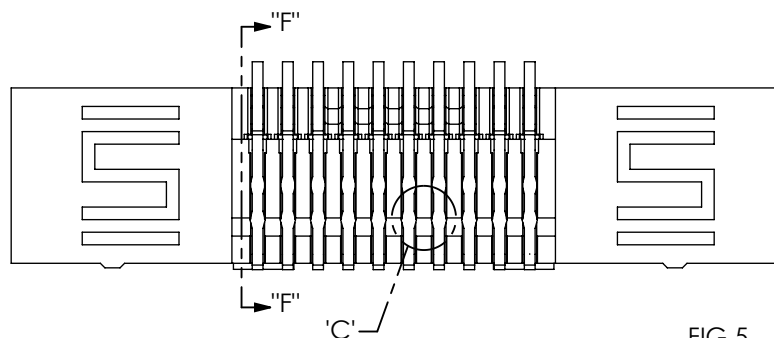
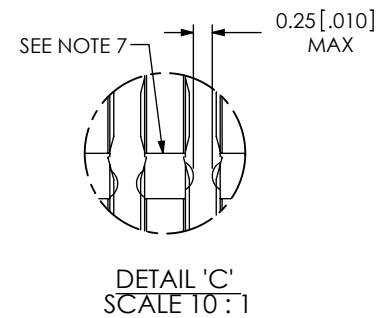

FIG 5
(FSI-110-06-X-S-X-TR SHOWN)
(SAME AS FIG 3, EXCEPT AS SHOWN)
(FOR -10, -20 & -30 POS ONLY)



SECTION "E"-"E"
SCALE 6 : 1



SECTION "F"-"F"
SCALE 4 : 1

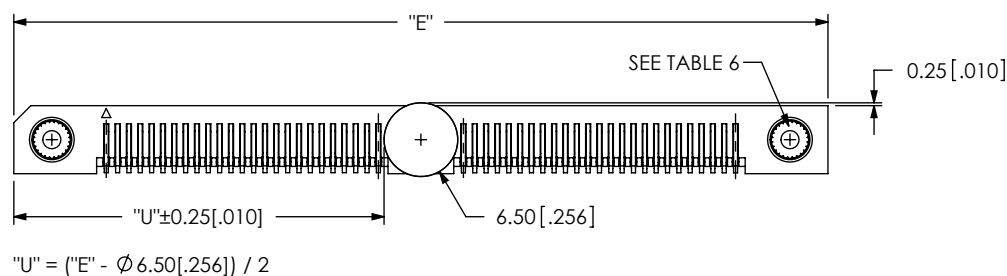
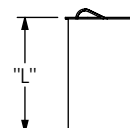
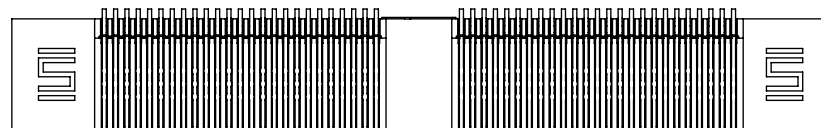

FIG 6
(FSI-150-10-X-S-X-K SHOWN)
(SAME AS FIG 5, EXCEPT AS SHOWN)
(FOR -40 & -50 POS ONLY)



| TABLE 9 | |
|-------------|---------------|
| BODY HEIGHT | "L" |
| -3 | 3.13 [0.123] |
| -06 | 6.13 [0.241] |
| -10 | 10.13 [0.399] |

F:\DWG\MISC\MKTG\FSI-1XX-XX-X-S-XX-XX-MKT.SLDRW

PROPRIETARY NOTE

THIS DOCUMENT CONTAINS INFORMATION
CONFIDENTIAL AND PROPRIETARY TO
SAMTEC, INC. AND SHALL NOT BE REPRODUCED
OR TRANSFERRED TO OTHER DOCUMENTS OR
DISCLOSED TO OTHERS OR USED FOR ANY
PURPOSE OTHER THAN THAT WHICH IT WAS
OBTAINED WITHOUT THE EXPRESSED WRITTEN
CONSENT OF SAMTEC, INC.

DO NOT SCALE DRAWING

SHEET SCALE: 1:0.2

samtec

520 PARK EAST BLVD, NEW ALBANY, IN 47150
PHONE: 812-944-6733 FAX: 812-948-5047
e-Mail: info@SAMTEC.com code 55322

DESCRIPTION:
1mm SINGLE ELEMENT INTERFACE

DWG. NO.
FSI-1XX-XX-X-S-X-XX-XX

BY: ROY LUO 06/14/2010 SHEET 4 OF 6

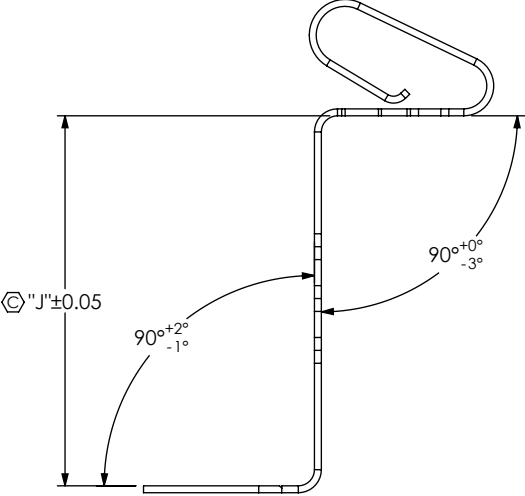
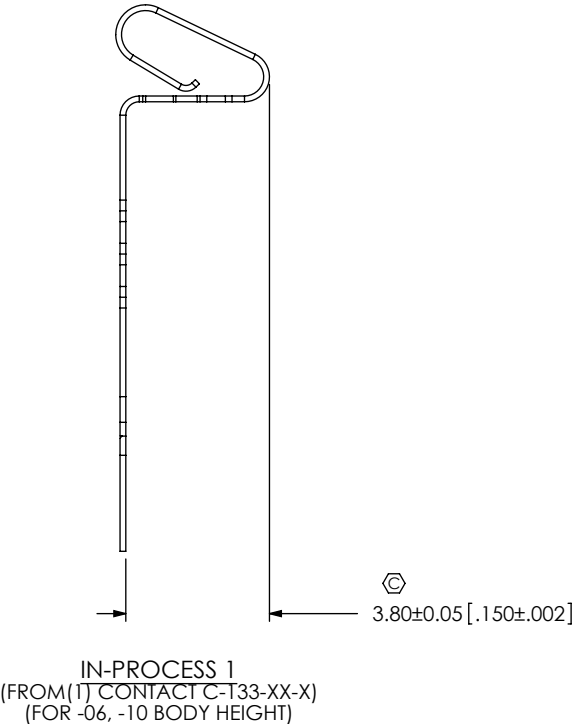

| TABLE 8 | |
|-------------|--------------|
| BODY HEIGHT | "J" |
| -06 | 4.15 [0.163] |
| -10 | 8.15 [0.321] |

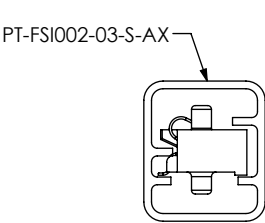

PACKAGING VIEW
FSI-1XX-03-X-S-XX

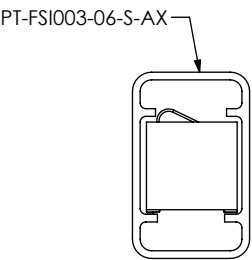

PACKAGING VIEW
FSI-1XX-06-X-S-XX

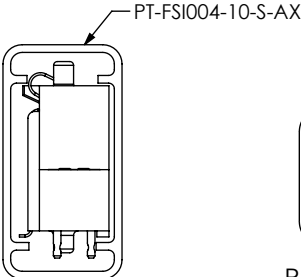

PACKAGING VIEW
FSI-1XX-10-X-S-XX

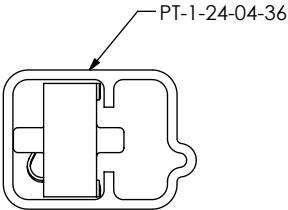

PACKAGING VIEW
FSI-1XX-03-X-S-E-XX
FSI-1XX-03-X-S-M-XX

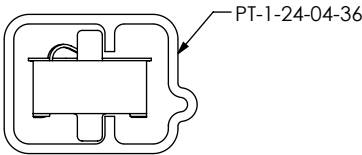

PACKAGING VIEW
FSI-1XX-03-X-S-E-XX-K
FSI-1XX-03-X-S-M-XX-K

| PACKAGING TABLE | | |
|-----------------------|-------------------|-------|
| BODY HEIGHT | TUBE | PLUG |
| -03 | PT-FSI002-03-S-AX | TP-09 |
| -03 (-M & -E OPTIONS) | PT-1-24-04-36 | TP-09 |
| -06 | PT-FSI003-06-S-AX | TP-09 |
| -10 | PT-FSI004-10-S-AX | TP-09 |

PROPRIETARY NOTE
THIS DOCUMENT CONTAINS INFORMATION
CONFIDENTIAL AND PROPRIETARY TO
SAMTEC, INC. AND SHALL NOT BE REPRODUCED
OR TRANSFERRED TO OTHER DOCUMENTS OR
DISCLOSED TO OTHERS OR USED FOR ANY
PURPOSE OTHER THAN THAT WHICH IT WAS
OBTAINED WITHOUT THE EXPRESSED WRITTEN
CONSENT OF SAMTEC, INC.

DO NOT SCALE DRAWING

SHEET SCALE: 6:1

520 PARK EAST BLVD, NEW ALBANY, IN 47150
PHONE: 812-944-6733 FAX: 812-948-5047
e-Mail info@SAMTEC.com code 55322

| | |
|------------------------|------------------------------|
| DESCRIPTION: | 1mm SINGLE ELEMENT INTERFACE |
| DWG. NO. | FSI-1XX-XX-X-S-X-XX-XX |
| BY: ROY LUO 06/14/2010 | SHEET 5 OF 6 |

| | | |
|---|--|--------------|
| <p>PROPRIETARY NOTE</p> <p>THIS DOCUMENT CONTAINS INFORMATION CONFIDENTIAL AND PROPRIETARY TO SAMTEC, INC. AND SHALL NOT BE REPRODUCED OR TRANSFERRED TO OTHER DOCUMENTS OR DISCLOSED TO OTHERS OR USED FOR ANY PURPOSE OTHER THAN THAT WHICH IT WAS OBTAINED WITHOUT THE EXPRESSED WRITTEN CONSENT OF SAMTEC, INC.</p> <p>DO NOT SCALE DRAWING</p> <p>SHEET SCALE: 1:0.2</p> |  <p>520 PARK EAST BLVD, NEW ALBANY, IN 47150 PHONE: 812-944-6733 FAX: 812-948-5047 e-Mail: info@SAMTEC.com code 55322</p> | |
| | DESCRIPTION: 1mm SINGLE ELEMENT INTERFACE | |
| | DWG. NO. FSI-1XX-XX-X-S-X-XX-XX | |
| | BY: ROY LUO 06/14/2010 | SHEET 6 OF 6 |

Mouser Electronics

Authorized Distributor

Click to View Pricing, Inventory, Delivery & Lifecycle Information:

[Samtec:](#)

[FSI-110-06-L-S-AB](#)