

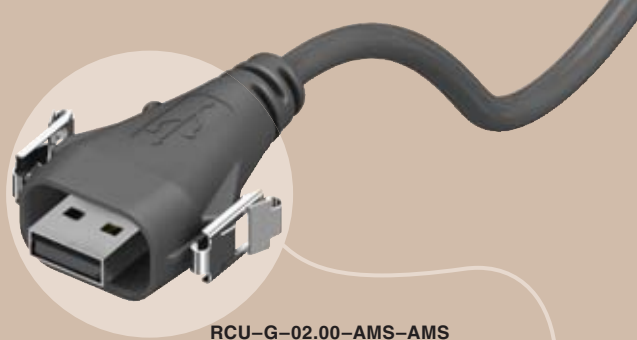

## RCU SERIES



RCU-G-02.00-AMS-AMS

# IP68 SEALED USB CABLE PLUG

## SPECIFICATIONS

For complete specifications see [www.samtec.com?RCU](http://www.samtec.com?RCU)

**Insulator Material:**

Glass Filled Thermoplastic

**Contact Material:**

Phosphor Bronze

**Shield Material:**

Phosphor Bronze

**Wire:**

20 AWG (Power),

25 AWG (Signal),

28 AWG (Drain)

**Mates with:**  
RPCU, RPB

## ALSO AVAILABLE

Dust Cap:

-AMS = DCRU-01-01-C-01

-BMS = DCRU-02-01-C-01

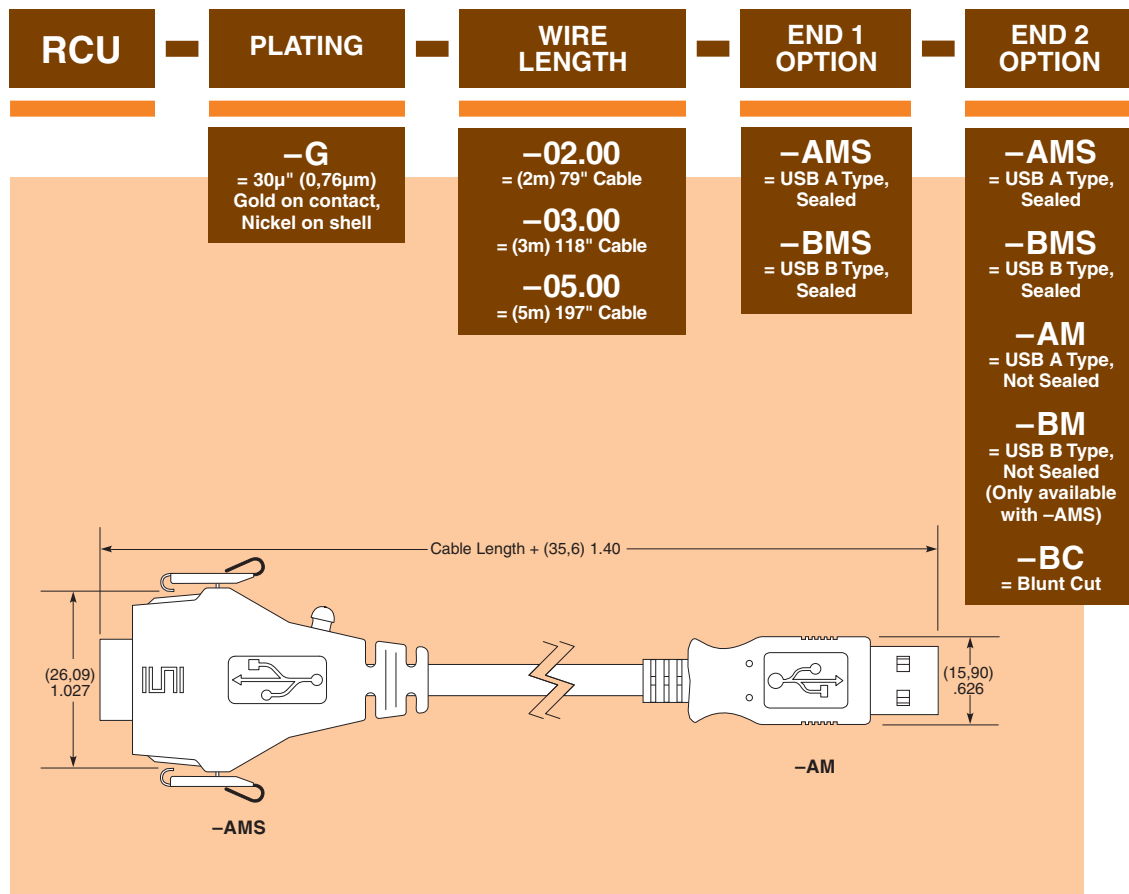
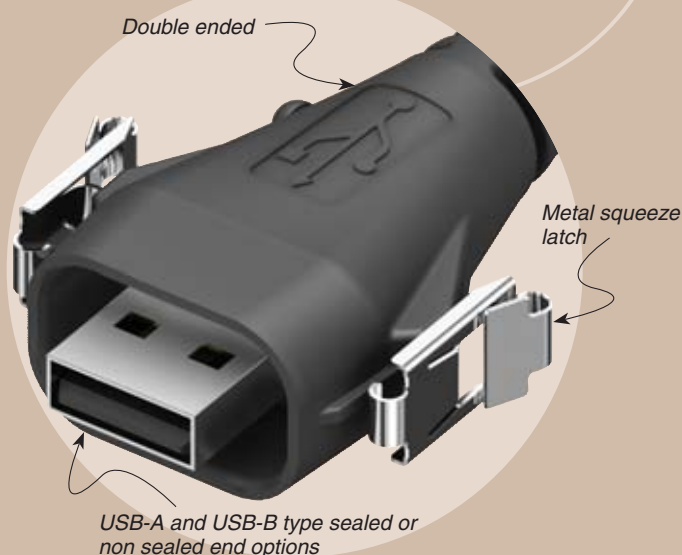

Due to technical progress, all designs, specifications and components are subject to change without notice.

[WWW.SAMTEC.COM](http://WWW.SAMTEC.COM)

# Mouser Electronics

Authorized Distributor

Click to View Pricing, Inventory, Delivery & Lifecycle Information:

Samtec:

[RCU-G-05.00-AMS-AMS](#) [RCU-G-05.00-AMS-BC](#) [RCU-G-05.00-BMS-BMS](#)