

NOTES:

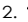
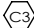
- 1. HIDDEN LINES ARE USED TO SHOW POLARIZATION WHEN USING -N OPTION.
- 2.  REPRESENTS A CRITICAL DIMENSION.
- 3. FFSD CABLE ASSEMBLIES ARE LEAD FREE.
- 4. ALL ASSEMBLIES TO BE 100% ELECTRICALLY TESTED  FOR SHORTS AND OPENS.
- 5. ALL ASSEMBLIES TO BE 100% HI-POT TESTED AT 630V.
- 6. STRAIN RELIEF TO WITHSTAND 5LB[22N] STRAIGHT PULL.

FIG. 1  
(FFSD-10-D-XX.XX-01-X-N SHOWN)

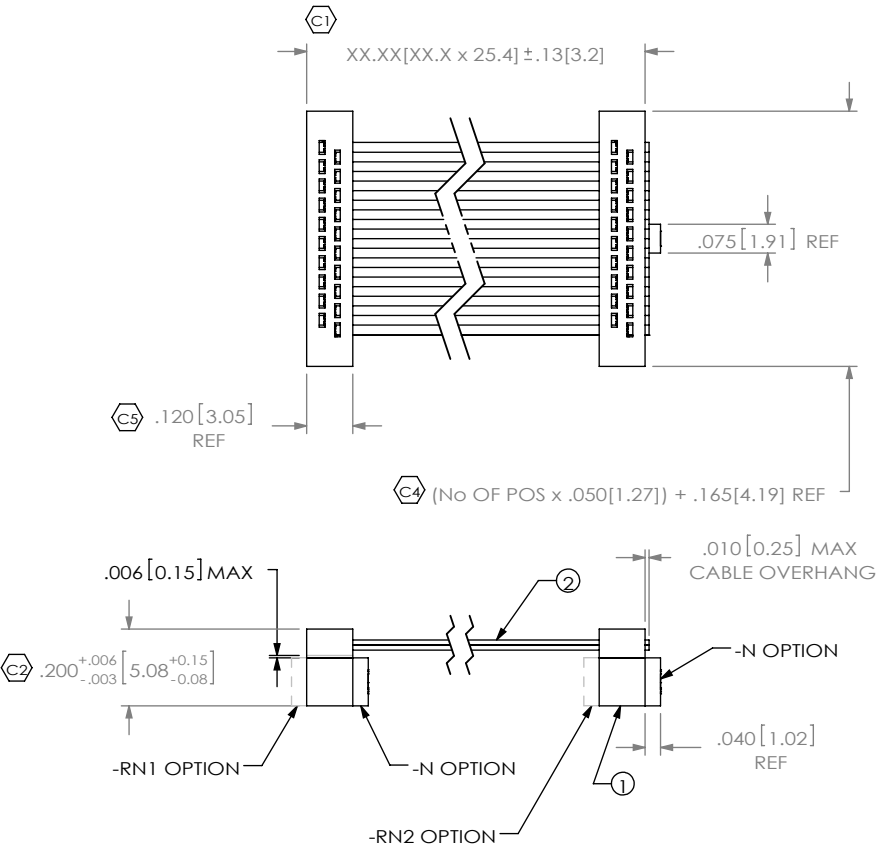


FIG. 3  
(FFSD-10-X-XX.XX-01-X-N-RW SHOWN)

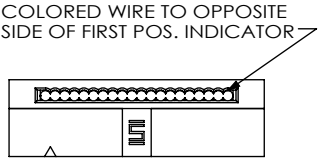


TABLE 1	
ITEM #	PART
1	FFSD-XX-01-X-N-XX
2	CB-XX-30-7/38-025-GR
3	FFSD-XX-01-X-N-SR1
4	FFSR-XX-01
5	FFSD-XX-01-X-N-SR2
6	FFSR-XX-02

F:\DWG\MISC\Mktg\FFSD-XX-X-XX.XX-01-X-X-XXX-MKT.SLDDRW

FFSD-XX-X-XX.XX-01-X-X-XXX

No OF POSITIONS  
-02 THRU -25  
(PER ROW)

END ASSEMBLY  
-S: SINGLE END  
-D: DOUBLE END

ASSEMBLY LENGTH  
(2.00[50.8] MINIMUM)

LEAD STYLE

PLATING OPTIONS

- LEAVE BLANK FOR STANDARD, USE C-67-L
- S: USE C-67-S
- F: USE C-67-F

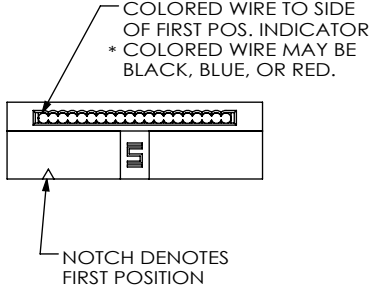
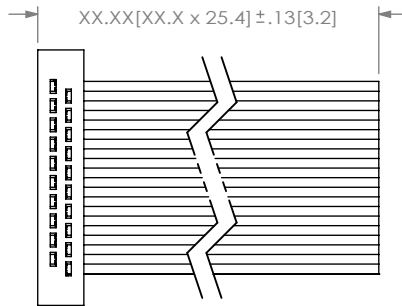
OPTION

- RW: REVERSE WIRING
- D"XX": DAISY CHAIN (MINIMUM 2.00[50.8], 1.00[25.4] INCREMENTS)
- R: REVERSED
- RN1: REVERSE POLARIZATION NOTCH
- RN2: REVERSE POLARIZATION NOTCH
- M: MIDDLE REVERSE
- O: OUTSIDE REVERSE
- SR: STRAIN RELIEF (NOT AVAILABLE WITH -S, -O, -M, -R, OR -DXX) (SOLD AS ASSEMBLIES ONLY)

STANDARD POLARIZATION NOTCH

- N: POLARIZATION NOTCH (NOT AVAILABLE IN -02 THRU -04) (LEAVE BLANK FOR -02, -03, -04)

FIG. 2  
(FFSD-10-S-XX.XX-01-X-N SHOWN)  
(SAME AS FIG. 1, DIFFERENT AS SHOWN)



UNLESS OTHERWISE SPECIFIED, DIMENSIONS ARE IN INCHES. TOLERANCES ARE:

DECIMALS	ANGLES
.XX: $\pm .01$ [.3]	2°
.XXX: $\pm .005$ [.13]	
.XXXX: $\pm .0020$ [.051]	

PROPRIETARY NOTE  
THIS DOCUMENT CONTAINS INFORMATION CONFIDENTIAL AND PROPRIETARY TO SAMTEC, INC. AND SHALL NOT BE REPRODUCED OR TRANSFERRED TO OTHER DOCUMENTS OR DISCLOSED TO OTHERS OR USED FOR ANY PURPOSE OTHER THAN THAT WHICH IT WAS OBTAINED WITHOUT THE EXPRESSED WRITTEN CONSENT OF SAMTEC, INC.

MATERIAL: DO NOT SCALE DRAWING SHEET SCALE: 2:1  
INSULATORS: PBT, COLOR: BLACK  
CONTACT: BeCu  
CABLE: TINNED COPPER, COLOR: GRAY  
PLATING: .000010 GOLD OVER .000050 NICKEL  
REMAINDER: .000200 REF TIN OVER .000050 NICKEL

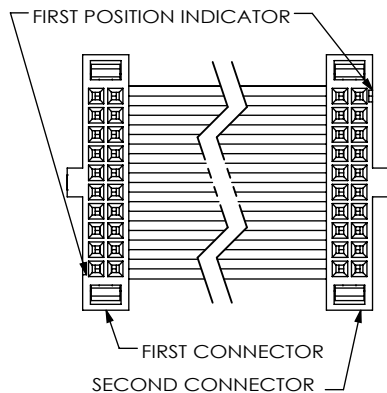


520 PARK EAST BLVD, NEW ALBANY, IN 47150  
PHONE: 812-944-6733 FAX: 812-948-5047  
e-Mail: info@SAMTEC.com code: 55322

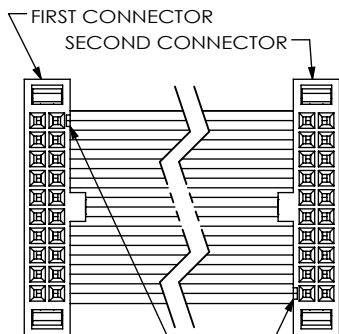
DESCRIPTION:  
.050 x .050 DOUBLE ROW FEMALE IDC ASSEMBLY  
DWG. NO.

FFSD-XX-X-XX.XX-01-X-X-XXX

**FIG. 3**  
(FFSD-10-D-XX.XX-01-X-N-RN1 SHOWN)  
(SAME AS FIG. 1, DIFFERENT AS SHOWN)



(FFSD-10-D-XX.XX-01-X-N-RN2 SHOWN)  
(SAME AS FIG. 1, DIFFERENT AS SHOWN)

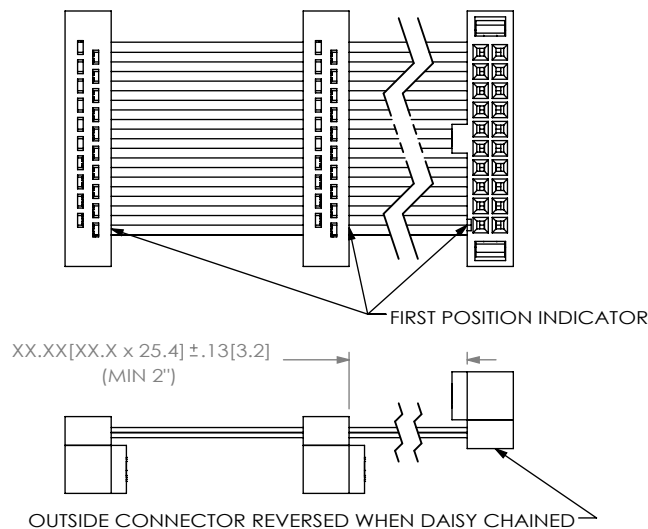


FIRST POSITION INDICATOR

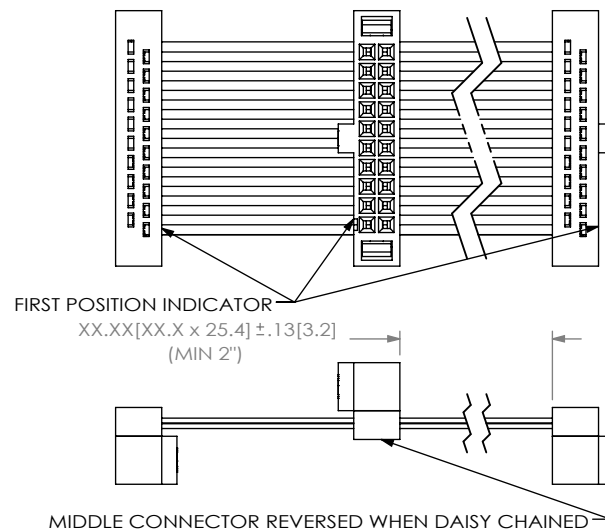
NOTE:  
-RN1 = REVERSE NOTCH ON 1ST CONNECTOR ONLY  
( NOT AVAILABLE WITH -R OPTION)  
-RN2 = REVERSE NOTCH ON 2ND CONNECTOR ONLY  
(NOT AVAILABLE WITH -R OPTION)

(REVERSE NOTCH NOT AVAILABLE WITH -RW OR ANY  
DAISY CHAIN OPTIONS)

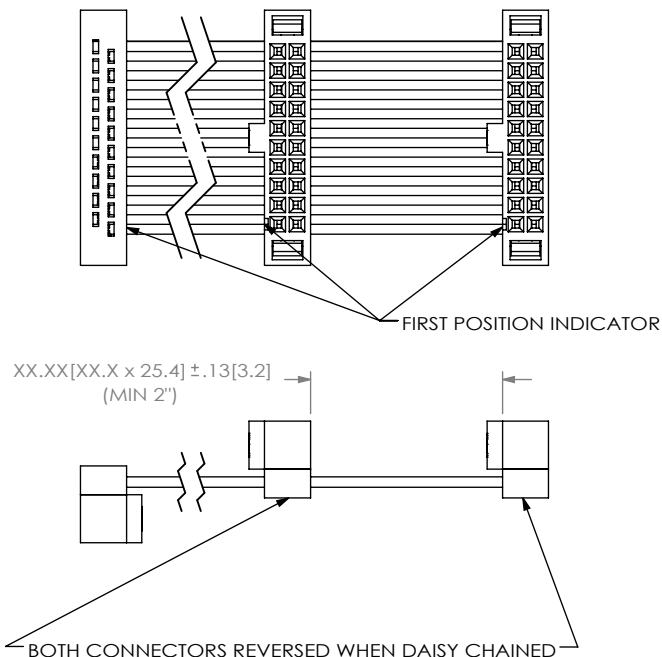
**FIG. 4**  
(FFSD-10-D-XX.XX-01-X-N-DXX-O SHOWN)  
(SAME AS FIG. 1, DIFFERENT AS SHOWN)  
(2.00[50.8] MINIMUM, 1.00[25.4] INCREMENTS)



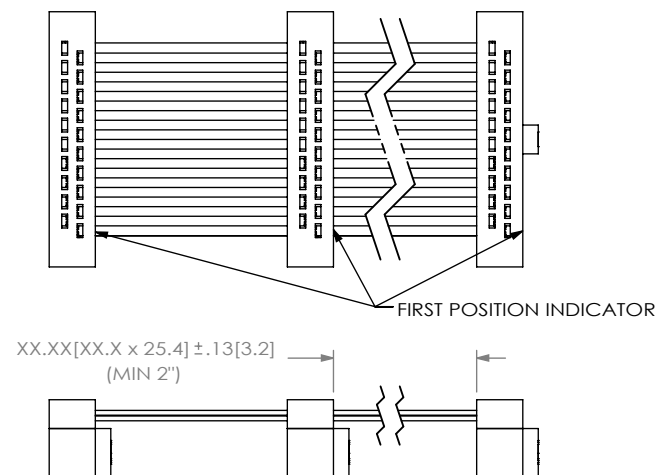
**FIG. 5**  
(FFSD-10-D-XX.XX-01-X-N-DXX-M SHOWN)  
(SAME AS FIG. 1, DIFFERENT AS SHOWN)  
(2.00[50.8] MINIMUM, 1.00[25.4] INCREMENTS)



**FIG. 6**  
(FFSD-10-D-XX.XX-01-X-N-DXX-R SHOWN)  
(SAME AS FIG. 1, DIFFERENT AS SHOWN)  
(NOT AVAILABLE WITH -RN1 OR -RN2 OPTION)  
(2.00[50.8] MINIMUM, 1.00[25.4] INCREMENTS)



**FIG. 7**  
(FFSD-10-D-XX.XX-01-X-N-DXX SHOWN)  
(SAME AS FIG. 1, DIFFERENT AS SHOWN)  
(2.00[50.8] MINIMUM, 1.00[25.4] INCREMENTS)



**PROPRIETARY NOTE**

THIS DOCUMENT CONTAINS INFORMATION  
CONFIDENTIAL AND PROPRIETARY TO  
SAMTEC, INC. AND SHALL NOT BE REPRODUCED  
OR TRANSFERRED TO OTHER DOCUMENTS OR  
DISCLOSED TO OTHERS OR USED FOR ANY  
PURPOSE OTHER THAN THAT WHICH IT WAS  
OBTAINED WITHOUT THE EXPRESSED WRITTEN  
CONSENT OF SAMTEC, INC.

DO NOT SCALE DRAWING

SHEET SCALE: 2:1

**samtec**

520 PARK EAST BLVD, NEW ALBANY, IN 47150  
PHONE: 812-944-6733 FAX: 812-948-5047  
e-Mail: info@SAMTEC.com code: 55322

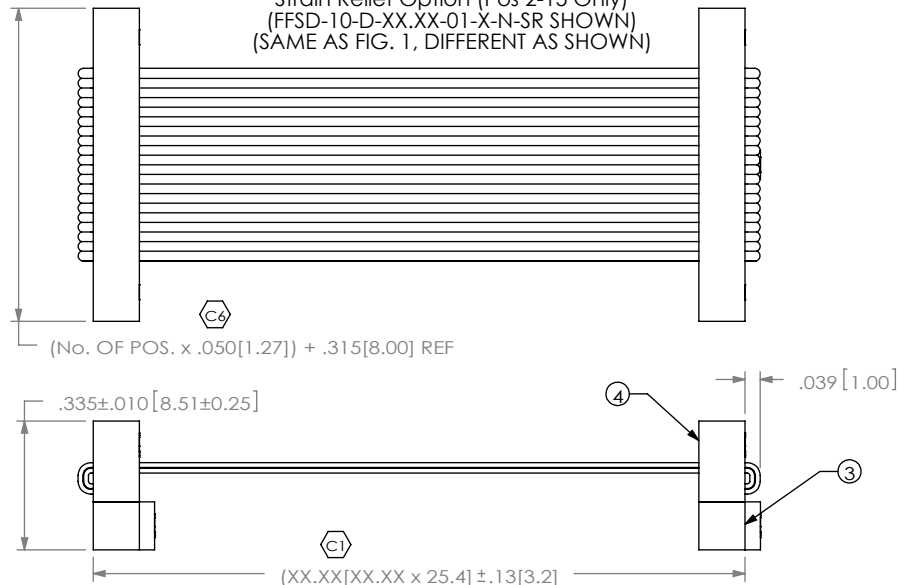
DESCRIPTION:  
.050 x .050 DOUBLE ROW FEMALE IDC ASSEMBLY

DWG. NO.  
FFSD-XX-X-XX.XX-01-X-X-XXX

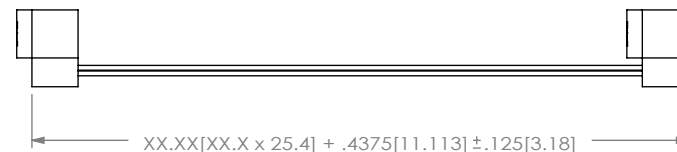
BY: T NEWTON 02/15/2008 SHEET 2 OF 3

**FIG. 9**

Strain Relief Option (Pos 2-15 Only)  
(FFSD-10-D-XX.XX-01-X-N-SR SHOWN)  
(SAME AS FIG. 1, DIFFERENT AS SHOWN)



**IN-PROCESS 1**  
(2-15 POS -SR ONLY)



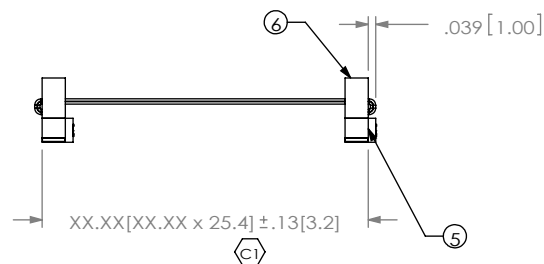
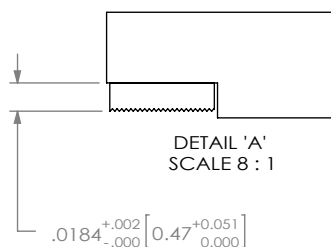
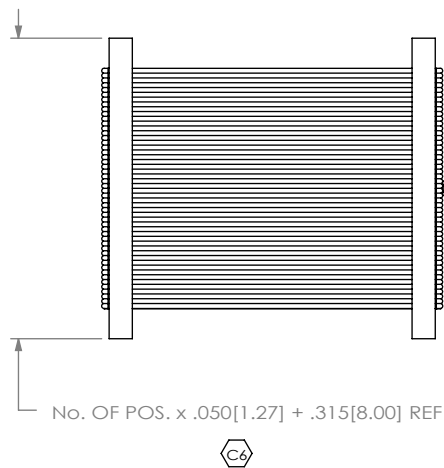
**IN-PROCESS 2**  
(2-15 POS -SR ONLY)



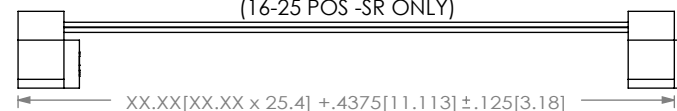
**FIG. 10**

Strain Relief Option (Pos 16-25 Only)  
(FFSD-25-D-XX.XX-01-X-N-SR SHOWN)  
(SAME AS FIG. 2, DIFFERENT AS SHOWN)

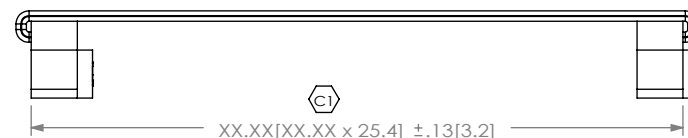
SCALE 1 : 1



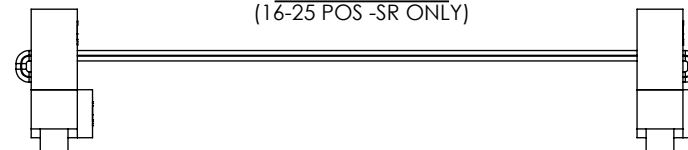
**IN-PROCESS 1**  
(16-25 POS -SR ONLY)



**IN-PROCESS 2**  
(16-25 POS -SR ONLY)



**IN-PROCESS 3**  
(16-25 POS -SR ONLY)



**PROPRIETARY NOTE**

THIS DOCUMENT CONTAINS INFORMATION  
CONFIDENTIAL AND PROPRIETARY TO  
SAMTEC, INC. AND SHALL NOT BE REPRODUCED  
OR TRANSFERRED TO OTHER DOCUMENTS OR  
DISCLOSED TO OTHERS OR USED FOR ANY  
PURPOSE OTHER THAN THAT WHICH IT WAS  
OBTAINED WITHOUT THE EXPRESSED WRITTEN  
CONSENT OF SAMTEC, INC.

DO NOT SCALE DRAWING

SHEET SCALE: 2:1

**samtec**

520 PARK EAST BLVD, NEW ALBANY, IN 47150  
PHONE: 812-944-6733 FAX: 812-948-5047  
e-Mail: info@SAMTEC.com code: 55322

DESCRIPTION:  
.050 x .050 DOUBLE ROW FEMALE IDC ASSEMBLY

DWG. NO.  
**FFSD-XX-X-XX.XX-01-X-X-XXX**

BY: T NEWTON 02/15/2008 SHEET 3 OF 3

# Mouser Electronics

Authorized Distributor

Click to View Pricing, Inventory, Delivery & Lifecycle Information:

Samtec:

[FFSD-17-D-02.00-01-N-RN1](#) [FFSD-02-D-02.00-01-R](#) [FFSD-08-D-02.00-01-N-RN2](#) [FFSD-10-D-02.00-01-N-RN1](#)  
[FFSD-15-D-02.00-01-F-N-RN1](#) [FFSD-20-D-02.00-01-F-N-RN2](#) [FFSD-25-D-02.00-01-F-N-R](#)