



DO NOT  
SCALE FROM  
THIS PRINT

1.  REPRESENTS A CRITICAL DIMENSION.
2. MINIMUM PUSHOUT FORCE: .5 LB.
3.  COPLANARITY: .004[0.10] = POS 05 THRU 26  
.006[0.15] = POS 27 THRU 50
4. TUBE ALL POSITIONS. PARTS TO BE TUBED WITH NOTCH GOING WITH ARROW.
5. PINS CAN BE ORIENTED IN ANY DIRECTION; BOTH ROWS MUST FACE SAME WAY.
6. SEE NOTCH FOR PROPER ORIENTATION.
7.  MAXIMUM PIN HEIGHT VARIATION: .003[0.08] FROM PIN TO PIN AND ROW TO ROW, MUST BE MEASURED BETWEEN ADJACENT PINS.
8. DUE TO HIGH AMOUNT OF INSERTION FORCE NEEDED, THE -LC OPTION IS NOT COMPATIBLE WITH AUTO PLACEMENT. SAMTEC RECOMMENDS MANUAL PLACEMENT FOR ALL ASSEMBLIES WITH THE -LC OPTION.
9. DIMENSION TO BE MEASURED AT BEND.

\*DIMENSIONS N/A FOR -N OPTION

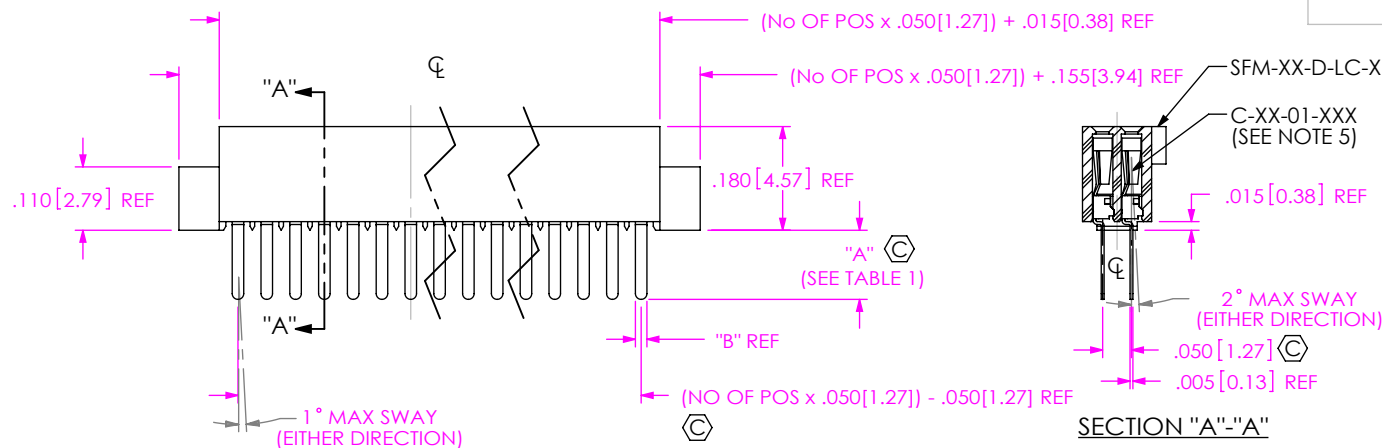
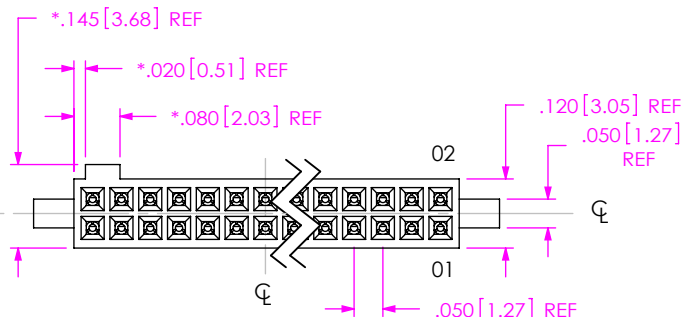

FIG 1  
THROUGH HOLE/STRAIGHT MODIFIED

TABLE 1		
SUFFIX	TAIL LENGTH "A"	TAIL WIDTH "B"
-X1	.120[3.05]	.020[0.51]
-X3	.075[1.91]	.016[0.41]

**ANY CHANGES MADE TO THIS PRINT MUST ALSO BE MADE TO THE SFC PRINT**

SFM-1XX-XX-XXX-D-XXX

## No OF POSITIONS

ALL POSITIONS AVAILABLE  
-02 THRU -50  
(USE BODY: SFM-XX-D-XX-X)

LEAD STYLE

- 01: THROUGH HOLE  
(USE CONTACT: C-44-01-XXX)  
(SEE FIG 1, SHT 1)
- 02: SURFACE MOUNT  
(USE CONTACT: C-44-02-XXX)  
(SEE FIG 2, SHT 2)
- 03: STRAIGHT MODIFIED  
(USE CONTACT: C-44-03-XXX)  
(SEE FIG 1, SHT 1)
- L1: THROUGH HOLE (LOW INSERTION)  
(USE CONTACT: C-61-01-XXX)  
(SEE FIG 1, SHT 1)
- L2: SURFACE MOUNT (LOW INSERTION)  
(USE CONTACT: C-61-02-XXX)  
(SEE FIG 2, SHT 2)
- L3: STRAIGHT MODIFIED (LOW INSERTION)  
(USE CONTACT: C-61-03-XXX)  
(SEE FIG 1, SHT 1)
- T1: THROUGH HOLE (PHOS BRONZE)  
(USE CONTACT: C-119-01-XXX)  
(SEE FIG 1, SHT 1)
- T2: SURFACE MOUNT (PHOS BRONZE)  
(USE CONTACT: C-119-02-XXX)  
(SEE FIG 2, SHT 2)

## — OPTIONS

(LEAVE BLANK FOR STANDARD AND USE SFM-XX-D)  
 -N: NO POLARIZATION MATH  
 (USE SFM-XX-D-XX-N)  
 -A: ALIGNMENT PIN (USE SFM-XX-D-A-X)  
 (SEE FIG 4, SHT 2)  
 -LC: LOCKING CLIP (SEE FIG 6, SHT 3 & NOTE 8)  
 (AVAILABLE ON ALL LEADS)  
 -P: PICK AND PLACE PAD  
 (SEE FIG 5, SHT 2)  
 (AVAILABLE ON 5 THRU 50 POSITION ONLY)  
 -TR: TAPE & REEL (SEE SHT 4)  
 (NOT AVAILABLE WITH -DS OPTION)  
 -K: POLYIMIDE FILM PAD (.005[0.13] THICKNESS)  
 (SEE FIG 3, SHT 2) (USE K-DOT-.157-.250-.005)  
 -SN: SOLDER NAIL FOR .062 BOARD  
 (SFM-XX-D-SN AND WT-27-01-T)  
 (AVAILABLE WITH LEAD STYLE -02, -L2 & -T2)  
 (NOT AVAILABLE WITH -A & -LC)  
 -SN2: SOLDER NAIL FOR .093 BOARD  
 (SFM-XX-D-SN AND WT-27-02-T)  
 (AVAILABLE WITH LEAD STYLE -02, -L2 & -T2)  
 (NOT AVAILABLE WITH -A & -LC)  
 -DS: DUAL SCREW DOWN FOR .062 BOARD  
 (SEE FIG 8, SHT 3)  
 (ONLY AVAILABLE WITH -01, -02 AND -03 LEAD  
 STYLE) (NOT AVAILABLE WITH OPTIONS -N, -A,  
 -LC, -P, -TR, -K, -SN AND SN2), (USES SFM-XX-D-DS,  
 CPS-RR-XX-XX-X, ACCRT-01 AND WT-27-XX-T  
 ALWAYS FILLED)

## BODY SPECIFICATION

-D: DOUBLE ROW

## — PLATING SPECIFICATION

- S: 30µ" SELECTIVE GOLD IN CONTACT AREA,  
MATTE TIN ON TAIL
- F: 3µ" FLASH SELECTIVE GOLD IN CONTACT AREA,  
MATTE TIN ON TAIL
- H: 30µ" HEAVY GOLD IN CONTACT AREA,  
3µ" GOLD ON TAIL
- L: 10µ" LIGHT SELECTIVE GOLD IN CONTACT AREA,  
MATTE TIN ON TAIL
- STL: 30µ" SELECTIVE GOLD IN CONTACT AREA,  
TIN/LEAD (90/10+/-5%) TAIL  
(ONLY AVAILABLE ON -02 OR -L2 LEADSTYLES)
- SM: 30µ" SELECTIVE GOLD IN CONTACT AREA,  
MATTE TIN ON TAIL
- FM: 3µ" FLASH SELECTIVE GOLD IN CONTACT AREA,  
MATTE TIN ON TAIL
- LM: 10µ" LIGHT SELECTIVE GOLD IN CONTACT AREA,  
MATTE TIN ON TAIL

## SECTION "A"- "A"

UNLESS OTHERWISE SPECIFIED,  
DIMENSIONS ARE IN INCHES.

TOLERANCES ARE:

DECIMALS	ANGLES
----------	--------

XX:  $\pm .01$  [0.3]

.XXX:  $\pm .005$  [0.13]

.XXXX:  $\pm .0020$  [0.051]

---

PROPRIETARY NOTE

THIS DOCUMENT CONTAINS CONFIDENTIAL AND PROPRIETARY INFORMATION AND ALL DESIGN, MANUFACTURING, REPRODUCTION, USE, PATENT RIGHTS AND SALES RIGHTS ARE EXPRESSLY RESERVED BY SAMTEC, INC. THIS DOCUMENT SHALL NOT BE DISCLOSED, IN WHOLE OR PART, TO ANY UNAUTHORIZED PERSON OR ENTITY NOR REPRODUCED, TRANSFERRED OR INCORPORATED IN ANY OTHER PROJECT IN ANY MANNER WITHOUT THE EXPRESS WRITTEN CONSENT OF SAMTEC, INC.

**MATERIAL:**

DO NOT SCALE DRAWING

SHEET SCALE: 3:1

INSULATOR: LCP UL 94V-O. COLOR: BLACK

CONTACT: TIGER EYE: BeCu

TIGER EYE LITE: PHOSPHOR BRONZE

DESCRIPTION:

.050 x .050 SOCKET STRIP DOUBLE ROW ASSEMBLY

DWG. NO.

SFM-1XX-XX-XXX-D-XXX

BY: JORDAN 12/11/89

SHEET 1 OF 4

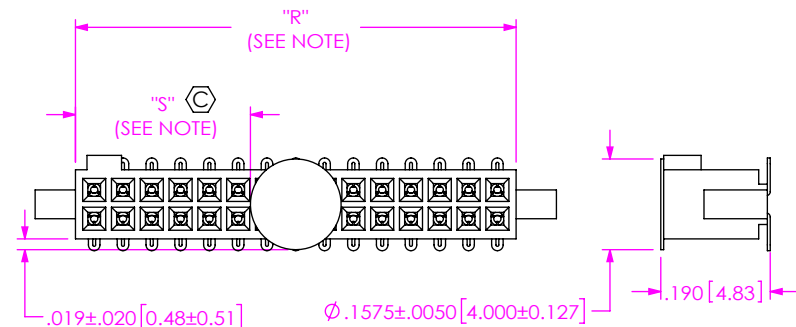
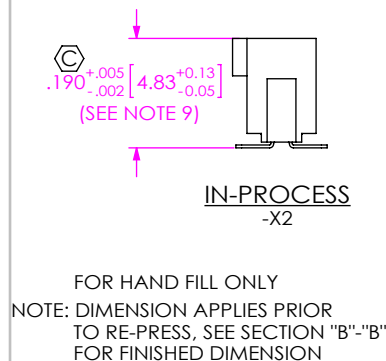
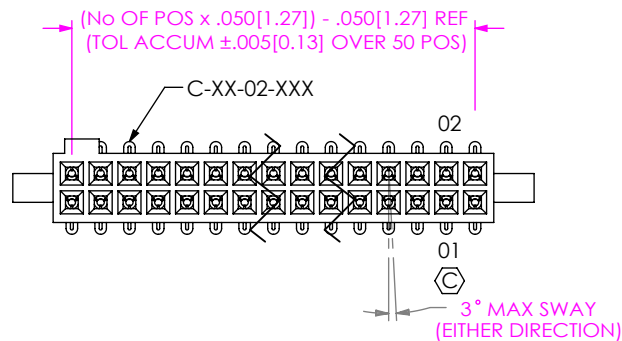

FIG 3  
-K: POLYIMIDE FILM PAD  
(SAME AS FIG 1, DIFFERENT AS SHOWN)  
NOTE: "R" = USED MEASURED DIMENSION REF  
"S" = {"R" - .1575[4.000]}/2±.020[0.51]

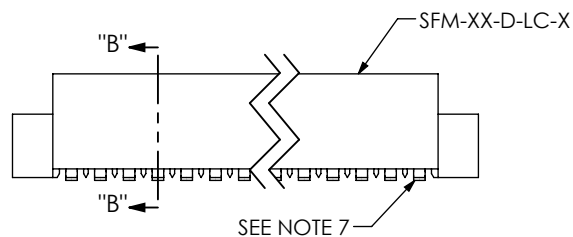

FIG 2  
-X2: SURFACE MOUNT  
(SAME AS FIG 1, DIFFERENT AS SHOWN)

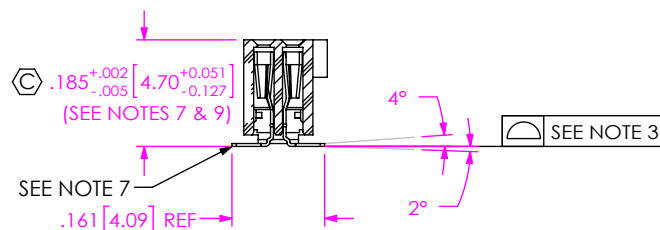

TABLE 2	
POS.	"A"
ODD	{(No. OF POS x .050[1.27])/2} - .1895[4.813]
EVEN	{(No. OF POS x .050[1.27])/2} - .2145[5.448]

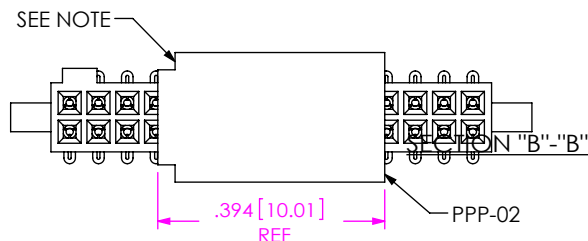

FIG 5  
-P: PICK AND PLACE PAD  
(PAD TO BE ORIENTED AS SHOWN FOR 5-12 POSITION PARTS)  
(FOR 13-50 POSITION PARTS, PAD MAY BE ORIENTED IN EITHER DIRECTION)  
(SAME AS FIG 1, DIFFERENT AS SHOWN)

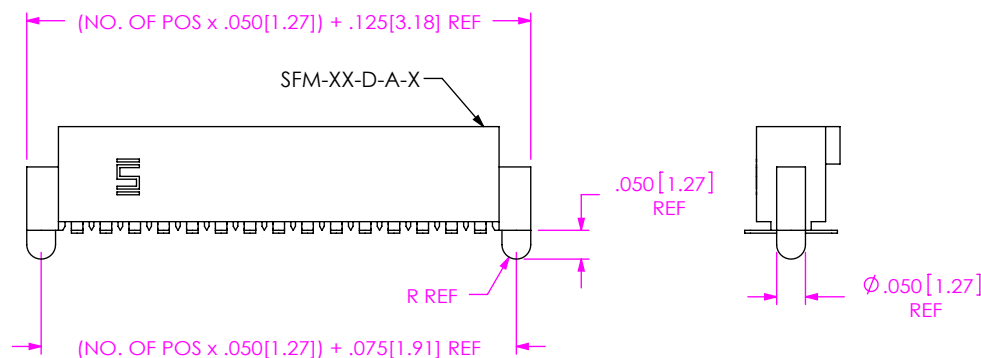
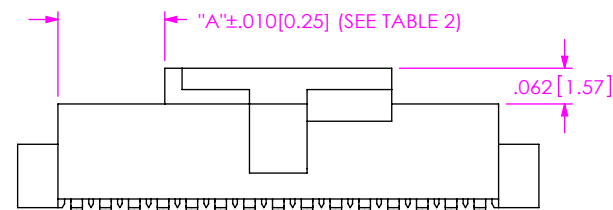
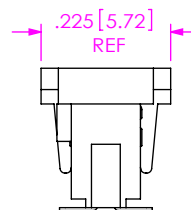

FIG 4  
-A: ALIGNMENT PIN  
(SAME AS FIG 1, DIFFERENT AS SHOWN)



PROPRIETARY NOTE  
THIS DOCUMENT CONTAINS CONFIDENTIAL AND PROPRIETARY INFORMATION AND ALL DESIGN, MANUFACTURING, REPRODUCTION, USE, PATENT RIGHTS AND SALES RIGHTS ARE EXPRESSLY RESERVED BY SAMTEC, INC. THIS DOCUMENT SHALL NOT BE DISCLOSED, IN WHOLE OR PART, TO ANY UNAUTHORIZED PERSON OR ENTITY NOR REPRODUCED, TRANSFERRED OR INCORPORATED IN ANY OTHER PROJECT IN ANY MANNER WITHOUT THE EXPRESS WRITTEN CONSENT OF SAMTEC, INC.

DO NOT SCALE DRAWING  
SHEET SCALE: 3:1

**samtec**

520 PARK EAST BLVD, NEW ALBANY, IN 47150  
PHONE: 812-944-6733 FAX: 812-948-5047  
e-Mail: info@SAMTEC.com code 55322

DESCRIPTION:  
.050 x .050 SOCKET STRIP DOUBLE ROW ASSEMBLY

DWG. NO.  
**SFM-1XX-XX-XXX-D-XXX**

BY: JORDAN 12/11/89 SHEET 2 OF 4

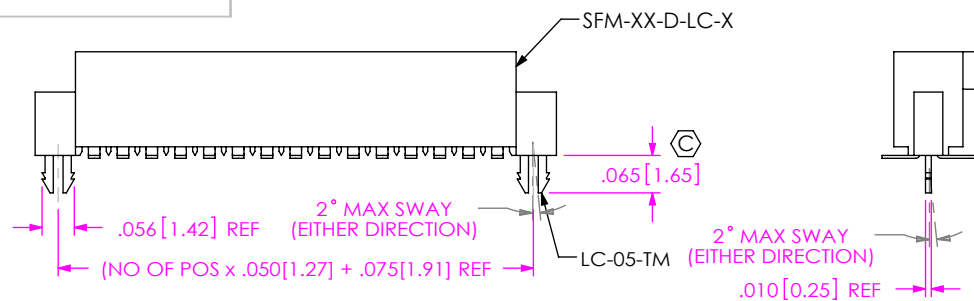
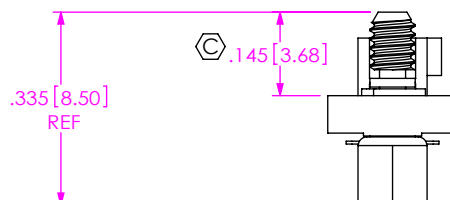

FIG 6  
-LC: LOCKING CLIP  
(SAME AS FIG 1, DIFFERENT AS SHOWN)  
(AVAILABLE IN ALL LEADS)

TABLE 4		
LEAD STYLE	"D"	WT-27
-01	.081	-01
-02	.081	-01
-03	.115	-02



.070 [1.78]  
REF

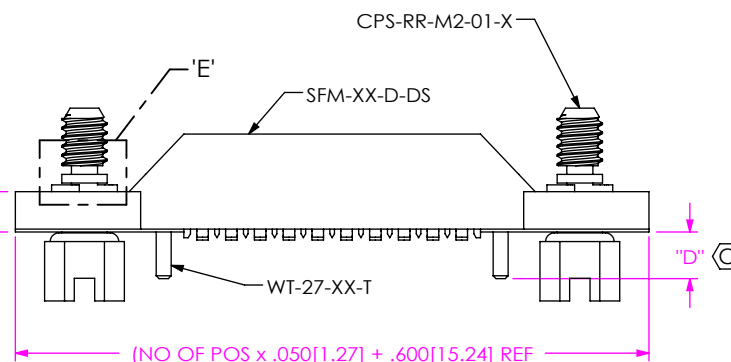
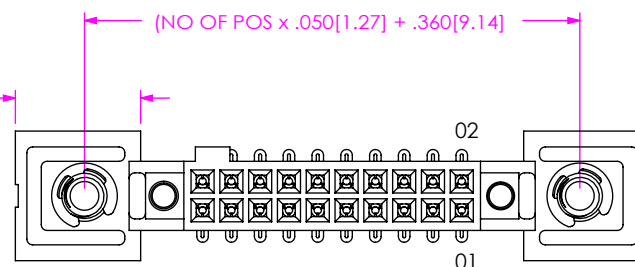

FIG 8  
-DS: DUAL SCREW DOWN  
(SAME AS FIG 2, DIFFERENT AS SHOWN)

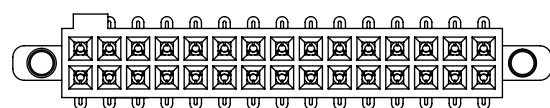

TABLE 3	
OPTION	"C"
-SN	.076 [1.93]
-SN2	.110 [2.79]

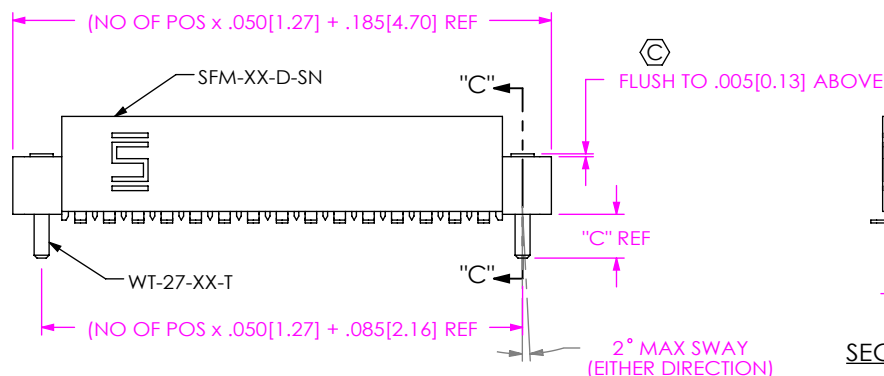

FIG 7  
-SNX: SOLDER NAIL  
(SAME AS FIG 1, DIFFERENT AS SHOWN)

F:\DWG\MISC\MKTG\SFM-1XX-XX-XXX-D-XXX-MKT.SLDDRW

PROPRIETARY NOTE  
THIS DOCUMENT CONTAINS CONFIDENTIAL AND PROPRIETARY INFORMATION AND ALL DESIGN, MANUFACTURING, REPRODUCTION, USE, PATENT RIGHTS AND SALES RIGHTS ARE EXPRESSLY RESERVED BY SAMTEC, INC. THIS DOCUMENT SHALL NOT BE DISCLOSED, IN WHOLE OR PART, TO ANY UNAUTHORIZED PERSON OR ENTITY NOR REPRODUCED, TRANSFERRED OR INCORPORATED IN ANY OTHER PROJECT IN ANY MANNER WITHOUT THE EXPRESS WRITTEN CONSENT OF SAMTEC, INC.

DO NOT SCALE DRAWING

SHEET SCALE: 3:1

**samtec**

520 PARK EAST BLVD, NEW ALBANY, IN 47150  
PHONE: 812-944-6733 FAX: 812-948-5047  
e-Mail: info@SAMTEC.com code 55322

DESCRIPTION:  
.050 x .050 SOCKET STRIP DOUBLE ROW ASSEMBLY

DWG. NO.  
**SFM-1XX-XX-XXX-D-XXX**

BY: JORDAN 12/11/89 SHEET 3 OF 4

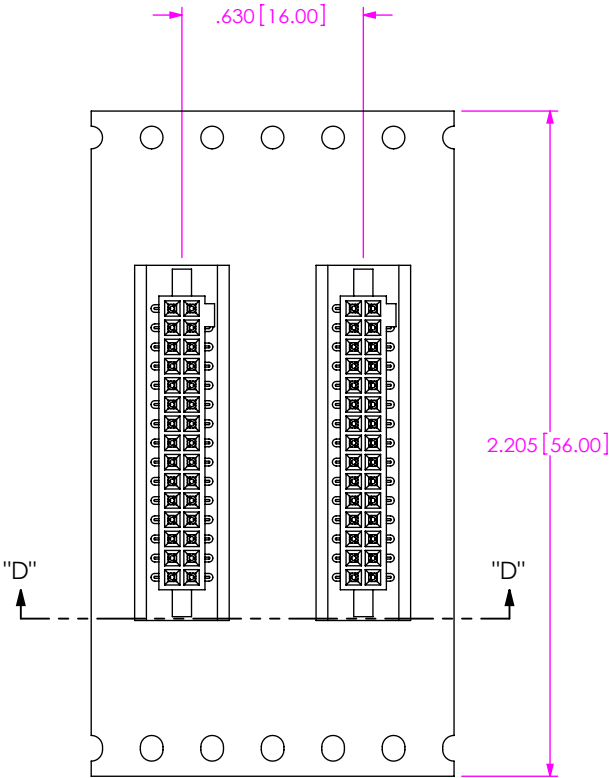

UNWINDING DIRECTION →

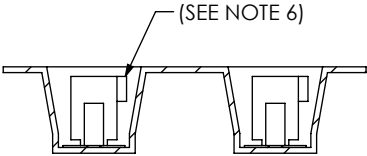

(SEE NOTE 6)

SECTION "D"-"D"  
SCALE 2 : 1

PACKAGING VIEW  
-TR: TAPE AND REEL

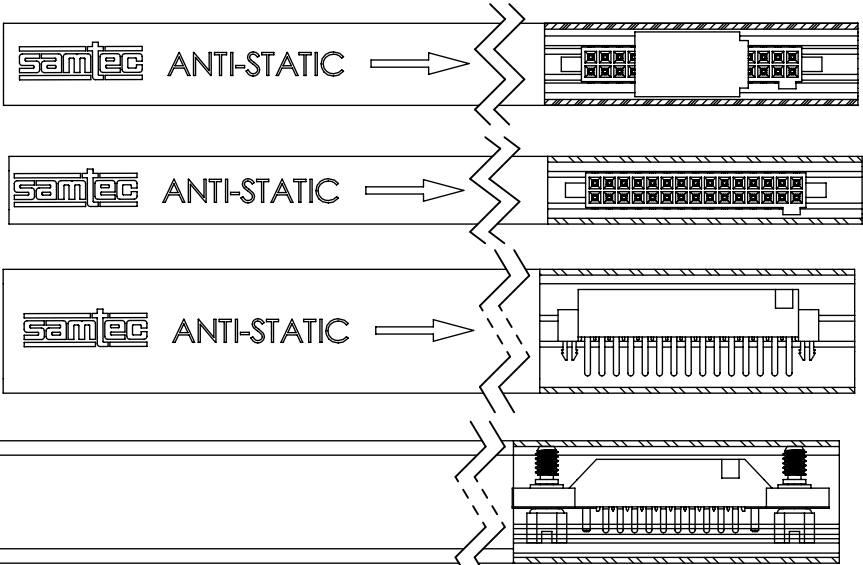
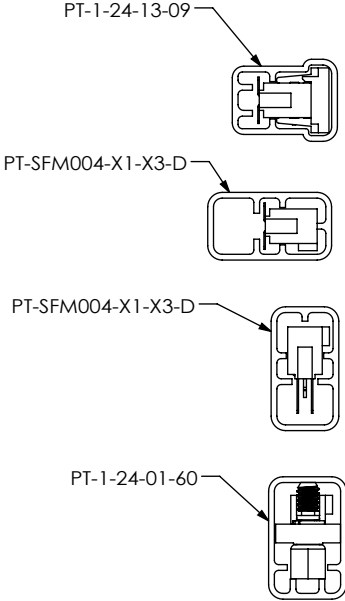

LEAD STYLE	PACKAGING TUBE	PLUG
-105-X2-X-D, -105X2-X-D-LC, -105-X2-D-A, -105-X2-D-K-LC, -105-X2-X-D-K, -105-X2-X-D-A-K	PT-1-24-14-09	TP-24-02
-X1-D, -X3-D, -X1-D-LC, -X3-D-LC, (NO P&P PAD), -X1-D-A, -X3-D-A, -X1-D-K, -X3-D-K, -X1-A-K, -X3-A-K	PT-SFM004-X1-X3-D	TP-24-02
-X1-D-P, -X1-D-LC-P (WITH P&P PAD), X1-D-A-P	PT-1-24-02-17	TP-09
-X2-D, -X2-D-K, -X2-D-LC (NO P&P PAD), -X2-D-A, -X2-D-K-A, -X2-D-LC-K, -X2-D-SNX	PT-SFM004-X1-X3-D	TP-24-02
-X2-D-P, -X3-D-P, -X2-D-LC-P (WITH P&P PAD), -X2-D-A-P, -X3-D-A-P, -X2-D-P-SNX	PT-1-24-13-09	TP-24
-01-DS, -02-DS, -03-DS	PT-1-24-01-60	TP-03

**\*FOR MACHINE LOADING OF TUBES FOR PARTS W/O PADS USE PT-1-24-14-09, TP-24-02**

5 POS -01 AND -03 LEAD STYLES MAY BE TUBED USING PT-1-24-15-09, TP-24-02  
2 POS -X1 STYLE TO BE TUBED IN PT-1-24-15-09

PACKAGING VIEW  
PACKAGE PARTS IN TUBES AS SHOWN (SEE NOTE 4)

F:\DWG\MISC\MKTG\SFM-1XX-XX-XXX-D-XXX-MKT.SLDDRW

<p><b>PROPRIETARY NOTE</b></p> <p>THIS DOCUMENT CONTAINS CONFIDENTIAL AND PROPRIETARY INFORMATION AND ALL DESIGN, MANUFACTURING, REPRODUCTION, USE, PATENT RIGHTS AND SALES RIGHTS ARE EXPRESSLY RESERVED BY SAMTEC, INC. THIS DOCUMENT SHALL NOT BE DISCLOSED, IN WHOLE OR PART, TO ANY UNAUTHORIZED PERSON OR ENTITY NOR REPRODUCED, TRANSFERRED OR INCORPORATED IN ANY OTHER PROJECT IN ANY MANNER WITHOUT THE EXPRESS WRITTEN CONSENT OF SAMTEC, INC.</p> <p>DO NOT SCALE DRAWING</p> <p>SHEET SCALE: 1.5:1</p>	<p>520 PARK EAST BLVD, NEW ALBANY, IN 47150 PHONE: 812-944-6733 FAX: 812-948-5047 e-Mail info@SAMTEC.com code 55322</p> <p>DESCRIPTION: .050 x .050 SOCKET STRIP DOUBLE ROW ASSEMBLY</p> <p>DWG. NO. <b>SFM-1XX-XX-XXX-D-XXX</b></p> <p>BY: JORDAN 12/11/89 SHEET 4 OF 4</p>
---	--

# Mouser Electronics

Authorized Distributor

Click to View Pricing, Inventory, Delivery & Lifecycle Information:

[Samtec:](#)

[SFM-104-T2-S-D-TR](#) [SFM-136-02-F-D-A](#) [SFM-103-01-L-D-K](#) [SFM-107-L2-H-D-A-K-TR](#) [SFM-125-L1-F-D-A](#) [SFM-110-03-S-D-K-TR](#) [SFM-107-01-S-D-TR](#) [SFM-105-T2-F-D-TR](#) [SFM-136-L2-L-D-A](#) [SFM-117-02-L-D-A-P-TR](#) [SFM-110-01-L-D-A-TR](#) [SFM-120-01-S-D-A-K-TR](#) [SFM-108-02-F-D-A-K-TR](#) [SFM-106-T1-L-D-A-K](#) [SFM-105-T2-H-D-K-TR](#) [SFM-115-L1-S-D-K-TR](#) [SFM-120-02-H-D-K-TR](#) [SFM-113-02-L-D-A-P](#) [SFM-120-L2-H-D-A-P](#) [SFM-112-03-L-D-A](#) [SFM-120-03-L-D-LC-K](#) [SFM-115-02-F-D-A-K](#) [SFM-115-T1-F-D-A](#) [SFM-111-02-S-D-A-K](#) [SFM-110-02-S-D-LC-N](#) [SFM-130-01-L-D-P-TR](#) [SFM-125-01-L-D-K](#) [SFM-128-02-S-D-A-P](#) [SFM-120-01-L-D-P](#) [SFM-130-03-S-D-K-TR](#) [SFM-120-L2-F-D-A-K-TR](#) [SFM-122-01-S-D-A](#) [SFM-115-L3-F-D-A-K-TR](#) [SFM-135-03-S-D-A-K](#) [SFM-130-L1-F-D-A](#) [SFM-103-T2-L-D-A-K-TR](#) [SFM-120-03-S-D-K-TR](#) [SFM-104-02-S-D-TR](#) [SFM-105-L3-L-D-K](#) [SFM-140-02-H-D-A-P](#) [SFM-110-L1-S-D-LC-K-TR](#) [SFM-111-02-S-D-A-TR](#) [SFM-108-01-L-D-K](#) [SFM-108-03-F-D-A](#) [SFM-105-L3-F-D-K](#) [SFM-118-L2-S-D-A-P-TR](#) [SFM-121-02-L-D-A-K](#) [SFM-127-02-S-D-A](#) [SFM-125-01-S-D-A-K-TR](#) [SFM-140-L1-S-D-LC-K](#) [SFM-106-02-F-D-A-K](#) [SFM-105-T1-F-D-K-TR](#) [SFM-119-L2-S-D-A](#) [SFM-104-03-S-D-LC](#) [SFM-130-T1-L-D-TR](#) [SFM-117-02-S-D-K-TR](#) [SFM-111-02-L-D-A-K](#) [SFM-112-02-L-D-P-TR](#) [SFM-104-L3-S-D-LC](#) [SFM-103-02-S-D-LC-K-TR](#) [SFM-105-02-STL-D-LC-P](#) [SFM-120-T1-F-D-A](#) [SFM-108-T2-F-D-K-TR](#) [SFM-104-02-S-D-LC-K-TR](#) [SFM-110-L1-L-D-A-K](#) [SFM-112-02-L-D-LC-P-TR](#) [SFM-136-L2-S-D-A-K](#) [SFM-103-L2-L-D-LC-TR](#) [SFM-115-T1-L-D-K-TR](#) [SFM-115-03-S-D-A-TR](#) [SFM-120-T2-H-D-A-K-TR](#) [SFM-133-02-H-D-LC](#) [SFM-112-02-L-D-A-P-TR](#) [SFM-135-01-L-D-P](#) [SFM-110-L3-F-D-A](#) [SFM-104-L2-S-D-LC-K](#) [SFM-104-T1-S-D-TR](#) [SFM-123-02-L-D-A-K-TR](#) [SFM-115-T2-H-D-A-K-TR](#) [SFM-119-02-L-D-LC](#) [SFM-125-L1-L-D-A-K](#) [SFM-130-T1-S-D-K-TR](#) [SFM-111-02-L-D-A-TR](#) [SFM-130-L2-F-D-A-P](#) [SFM-118-02-S-D-A-K](#) [SFM-119-02-L-D-P-TR](#) [SFM-124-02-L-D-A-K-TR](#) [SFM-135-L1-F-D-A](#) [SFM-125-01-S-D-A-P-TR](#) [SFM-112-T2-S-D-LC-P-TR](#) [SFM-108-T2-S-D-P](#) [SFM-115-L3-S-D-A-P-TR](#) [SFM-108-02-L-D-TR](#) [SFM-117-02-F-D-A](#) [SFM-125-T1-L-D-K-TR](#) [SFM-105-02-STL-D-LC-K](#) [SFM-115-01-L-D-K-TR](#) [SFM-110-01-L-D-A-P](#) [SFM-116-02-H-D-A](#) [SFM-116-01-L-D-LC](#)