

SS-132-G-2

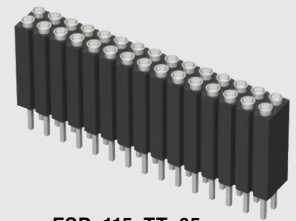

ESD-115-TT-05

(2.54 mm) .100"

SS, SD, ESD, ESS, HSS SERIES

# PRECISION MACHINED SOCKET STRIPS

## Mates with:

TS, TD, HTS, BBS,  
BBD, BBL, BDL, BHS

## SPECIFICATIONS

For complete specifications see [www.samtec.com?SS](http://www.samtec.com?SS),  
[www.samtec.com?ESS](http://www.samtec.com?ESS),  
[www.samtec.com?SD](http://www.samtec.com?SD),  
[www.samtec.com?ESD](http://www.samtec.com?ESD) or  
[www.samtec.com?HSS](http://www.samtec.com?HSS)

### Insulator Material:

SS, SD, ESS, ESD= Black G.F. Polyester  
HSS= Black Liquid Crystal Polymer

### Contact:

BeCu

### Shell:

Brass except Style 5A

Phosphor Bronze

### Plating:

Au over 50  $\mu$ " (1.27  $\mu$ m) Ni or

Sn over 50  $\mu$ " (1.27  $\mu$ m) Ni

### Operating Temp Range:

-55 °C to +125 °C

### Lead Size Range:

(0.38 mm to 0.56 mm)

.015" to .022" DIA

### RoHS Compliant:

Yes

### Lead-Free Solderable:

SS, SD, ESS, ESD:

No, LeadWave only

HSS: Yes

## RECOGNITIONS

For complete scope of recognitions see [www.samtec.com/quality](http://www.samtec.com/quality)



FILE NO. E111594

TYPE STRIP	1	NO. PINS PER ROW	PLATING OPTION	LEAD STYLE	OPTION	OTHER OPTION
------------	---	------------------	----------------	------------	--------	--------------

**01 thru 32**

= SS, ESS Series

**01 thru 36**

= HSS, SD & ESD Series

**SS**

= Standard  
Single Row Socket

**HSS**

= High Temp  
Single Row Socket

**ESS**

= Elevated Single Row Socket

Styles -5A & -05 socket  
heads not countersunk.

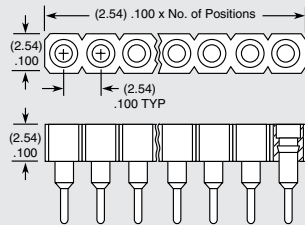

**SD**

= Standard Double  
Row Socket

**ESD**

= Elevated Double  
Row Socket

Style -5A not available.  
Styles -5A & -05 socket  
heads not countersunk.

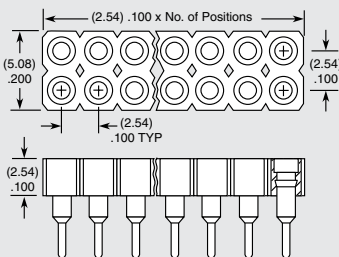

**PLATING  
OPTION**

**-S**

= 10  $\mu$ " (0.25  $\mu$ m) Gold contact,  
Tin shell  
(Styles 2 & 22 only)

**-T**

= 30  $\mu$ " (0.76  $\mu$ m) Gold contact,  
Tin shell

**-G**

= 30  $\mu$ " (0.76  $\mu$ m) Gold contact,  
10  $\mu$ " (0.25  $\mu$ m) Gold shell

**-TT**

= Tin contact and shell  
(Styles 1, 2, 4, and 05  
except LIF N/A)

LIF= Low Insertion Force

**OPTION**

**-L** = Locking  
Socket

Add -L suffix for locking  
lead socket in end positions.  
Requires Style -2 or -22 and  
.035"  $\pm$  .003 DIA board hole.

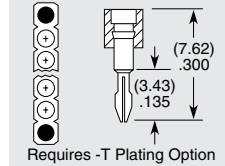

Requires -T Plating Option

**OTHER  
OPTION**

**-N**  
= Non  
Flush

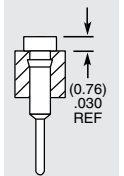

N/A Style -5A

## ALSO AVAILABLE (MOQ Required)

- Locking lead option on ESS and ESD series

**-1A, -1B or -1C**

For LIF specify -21A, -21B or -21C  
(SS, HSS, SD)

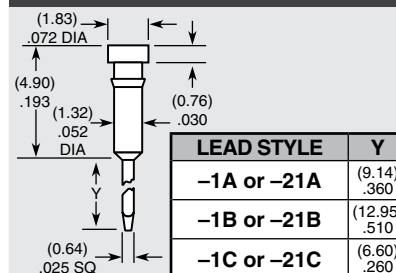

LEAD STYLE	Y
-1A or -21A	(9.14) .360
-1B or -21B	(12.95) .510
-1C or -21C	(6.60) .260

**-2, -22\*, -5A,  
or -38\***

\*For LIF specify -22 or -38 (SS, HSS, SD)

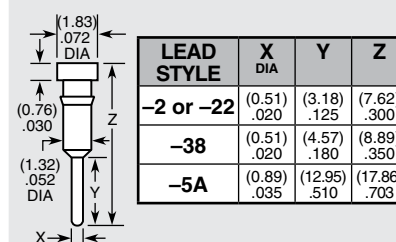

LEAD STYLE	X DIA	Y	Z
-2 or -22	(0.51) .020	(3.18) .125	(7.62) .300
-38	(0.51) .020	(4.57) .180	(8.89) .350
-5A	(0.89) .035	(12.95) .510	(17.86) .703

Locking lead available. See OPTION.

**-03, -04, -05**

For LIF specify -23  
(ESS, ESD)

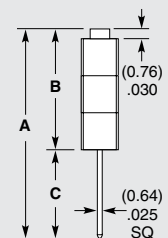

LEAD STYLE	A	B	C
-05	(17.86) .703	(13.46) .530	(4.39) .173
-03 or -23	(11.51) .453	(8.38) .330	(3.12) .123
-04	(14.05) .553	(10.92) .430	(3.12) .123

**Note:**  
Some lengths, styles and  
options are non-standard,  
non-returnable.

# Mouser Electronics

Authorized Distributor

Click to View Pricing, Inventory, Delivery & Lifecycle Information:

## Samtec:

[ESS-104-T-03](#) [ESS-105-G-03](#) [ESS-106-T-03](#) [ESS-118-G-04](#) [ESS-102-G-04](#) [ESS-110-G-04](#) [ESS-103-G-04](#) [ESS-120-TT-03](#) [ESS-103-T-03](#) [ESS-120-T-03](#) [ESS-106-G-04](#) [ESS-104-G-03](#) [ESS-119-T-03](#) [ESS-116-T-03](#) [ESS-112-G-04](#) [ESS-107-G-04](#) [ESS-112-T-03](#) [ESS-113-T-03](#) [ESS-101-G-03](#) [ESS-114-T-03](#) [ESS-109-T-03](#) [ESS-116-G-04](#) [ESS-120-T-05](#) [ESS-132-G-03](#) [ESS-120-G-04](#) [ESS-104-G-04](#) [ESS-105-T-03](#) [ESS-105-G-04](#) [ESS-101-T-03](#) [ESS-108-T-03](#) [ESS-129-TT-05](#) [ESS-102-G-05](#) [ESS-108-TT-05](#) [ESS-107-T-27](#) [ESS-101-TT-03](#) [ESS-101-TT-04](#) [ESS-107-T-28](#) [ESS-108-T-23](#) [ESS-102-TT-05](#) [ESS-103-G-03](#) [ESS-102-T-04](#) [ESS-112-TT-05](#) [ESS-104-T-23](#) [ESS-102-G-03](#) [ESS-117-T-05](#) [ESS-116-T-04](#) [ESS-110-T-04](#) [ESS-115-T-04](#) [ESS-102-T-05](#) [ESS-102-G-08](#) [ESS-102-T-08](#) [ESS-101-TT-05](#) [ESS-102-TT-04](#) [ESS-101-G-04](#) [ESS-102-TT-23](#) [ESS-102-TT-25](#) [ESS-102-G-25](#) [ESS-102-G-26](#) [ESS-101-T-04](#) [ESS-102-T-23](#) [ESS-102-T-25](#) [ESS-102-TT-03](#) [ESS-102-TT-08](#) [ESS-101-TT-07](#) [ESS-101-TT-25](#) [ESS-101-T-05](#) [ESS-101-G-05](#) [ESS-101-T-23](#) [ESS-102-G-06](#) [ESS-102-TT-24](#) [ESS-101-G-08](#) [ESS-101-G-23](#) [ESS-101-G-25](#) [ESS-102-G-24](#) [ESS-102-T-03](#) [ESS-103-G-05](#) [ESS-126-TT-24](#) [ESS-128-T-03](#) [ESS-131-G-04](#) [ESS-132-G-26](#) [ESS-132-G-28](#) [ESS-132-TT-06](#) [ESS-132-TT-08](#) [ESS-125-G-08](#) [ESS-126-T-03](#) [ESS-127-T-04](#) [ESS-127-TT-04](#) [ESS-129-G-03](#) [ESS-130-T-04](#) [ESS-132-G-04](#) [ESS-116-TT-24](#) [ESS-118-G-03](#) [ESS-119-G-03](#) [ESS-122-G-04](#) [ESS-122-G-24](#) [ESS-123-T-04](#) [ESS-125-T-25](#) [ESS-125-TT-04](#) [ESS-126-TT-03](#) [ESS-126-TT-04](#)