

DO NOT  
SCALE FROM  
THIS PRINT

DO NOT UPDATE  
OR ADD REVISION WITHOUT  
APPROVAL THROUGH THE  
STANDARDS GROUP

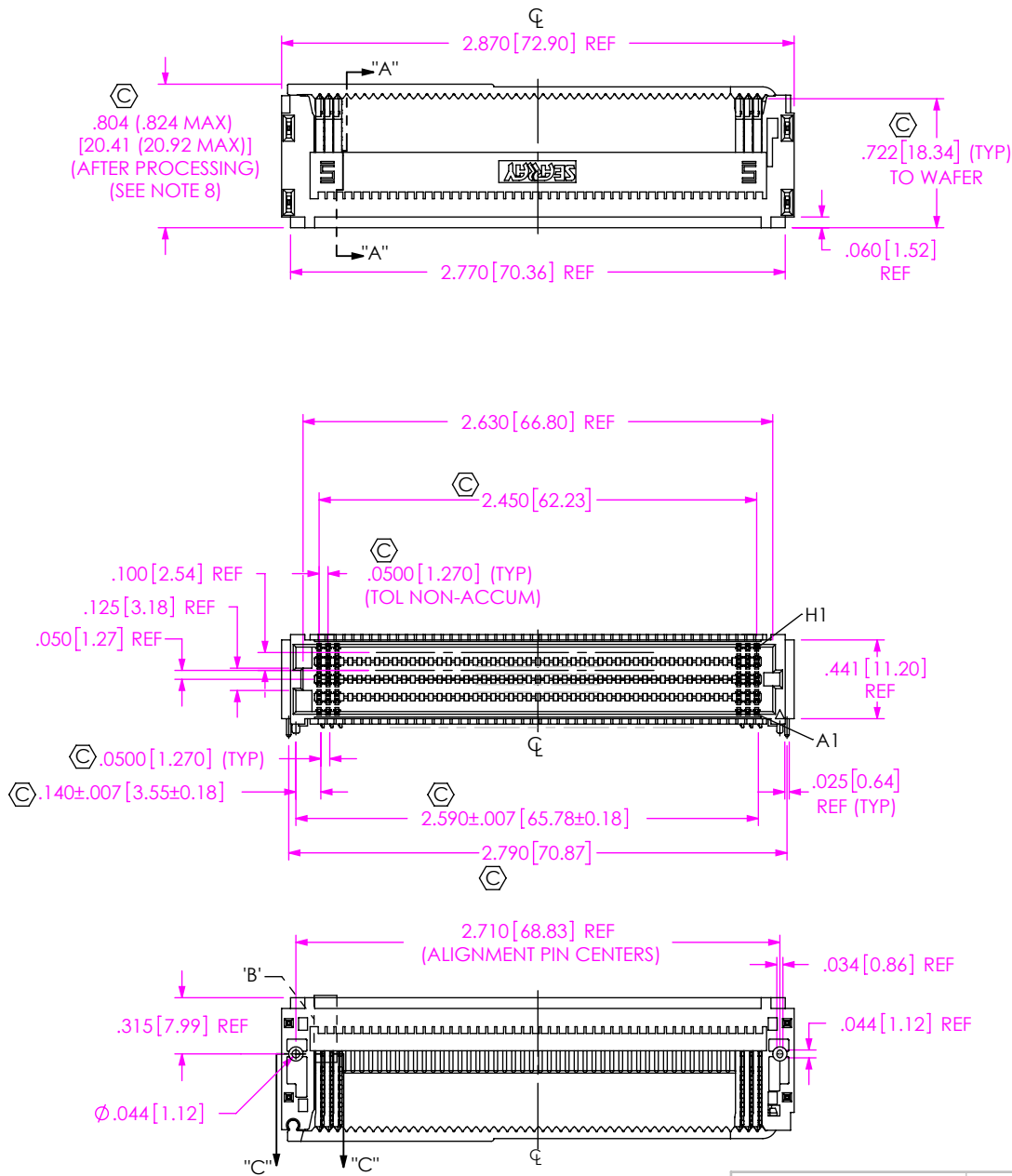

- NOTES:
1. VITA 74 CONNECTOR.
  2. Ⓢ REPRESENTS A CRITICAL DIMENSION.
  3. MINIMUM PUSH-OUT FORCE: .50 LBS[2.2N].
  4. INSPECT DIMENSION AT 4 CORNERS OF PART.
  5. FEATURE REQUIRED FOR VISION INSPECTION.
  6. A 20~30°C TEMPERATURE DIFFERENCE MAY EXIST BETWEEN THIS HIGH-DENSITY COMPONENT AND THE BOARD SURFACE DURING REFLOW. SAMTEC RECOMMENDS A THERMAL STUDY BE PERFORMED.
  7. CHECK DIMENSION ON FIRST AND LAST ROW OF TAILS.
  8. SOME RELAXATION/WARPING OF THE BACK STRAP IS ACCEPTABLE AFTER PROCESSING.
  9. PARTS TO BE BULK LAYER FOAM TUBES TRAYS TAPE & REEL.
  10. ORDERS WILL BE PACKAGED ACCORDING TO THE SAMTEC PACKAGING EFFICIENCY STANDARDS (SPES) FOUND ON WWW.SAMTEC.COM
  11. ATTACH LABEL "SEAX-0001" TO EACH TAPE & REEL PACKAGE.

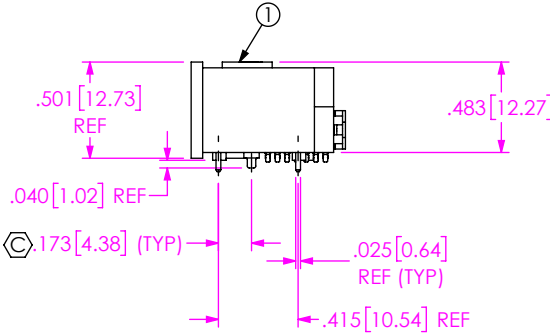

UNLESS OTHERWISE SPECIFIED,  
DIMENSIONS ARE IN INCHES.

TOLERANCES ARE:

DECIMALS	ANGLES
.XX: ±.01 [0.3]	2°
.XXX: ±.005 [0.13]	
.XXXX: ±.0020 [0.051]	

PROPRIETARY NOTE  
THIS DOCUMENT CONTAINS CONFIDENTIAL AND PROPRIETARY INFORMATION AND ALL DESIGN, MANUFACTURING, REPRODUCTION, USE, PATENT RIGHTS AND SALES RIGHTS ARE EXPRESSLY RESERVED BY SAMTEC, INC. THIS DOCUMENT SHALL NOT BE DISCLOSED, IN WHOLE OR PART, TO ANY UNAUTHORIZED PERSON OR ENTITY NOR REPRODUCED, TRANSFERRED OR INCORPORATED IN ANY OTHER PROJECT IN ANY MANNER WITHOUT THE EXPRESS WRITTEN CONSENT OF SAMTEC, INC.



520 PARK EAST BLVD, NEW ALBANY, IN 47150  
PHONE: 812-944-6733 FAX: 812-948-5047  
e-Mail: info@SAMTEC.com code 55322

ITEM NO.	PART NO.	QUANTITY	MATERIAL
1	S-SEAF-50-01-L-08-2-RA-TR	1.0000	LCP, COLOR: BLACK/PHOS BRONZE/LEAD FREE SOLDER
2	CT-SEAF107MS	.01333	CONDUCTIVE POLYMER
3	SEAX-0001	1.0000	LABEL

PLATING: DO NOT SCALE DRAWING SHEET SCALE: 1:1  
CONTACTS: CONTACT AREA: .000030 GOLD OVER .000050 NICKEL  
REMAINDER: .000200 REF TIN OVER .000050 NICKEL  
WELD TAB: ENTIRE PIN: .000200 REF TIN OVER .000050 NICKEL  
SOLDER COMPOSITION: 95.5% TIN / 3.8% SILVER / .7% COPPER CHARGE TAIL

DESCRIPTION: VITA 74 SEAF-RA (LEAD FREE)  
DWG. NO. ASP-161074-04  
BY: J. BROWNING 09/22/2021 SHEET 1 OF 3

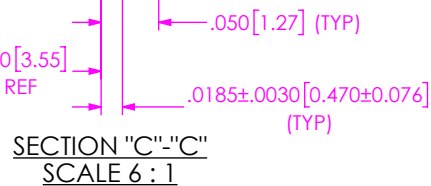
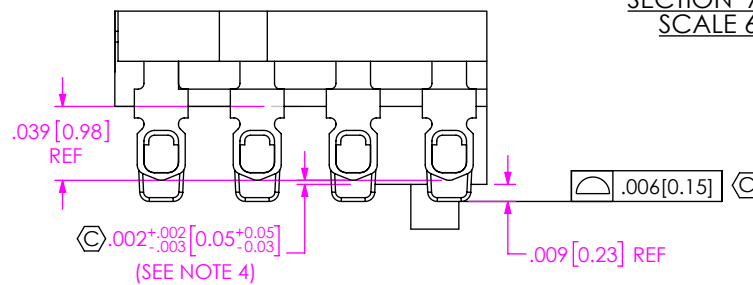
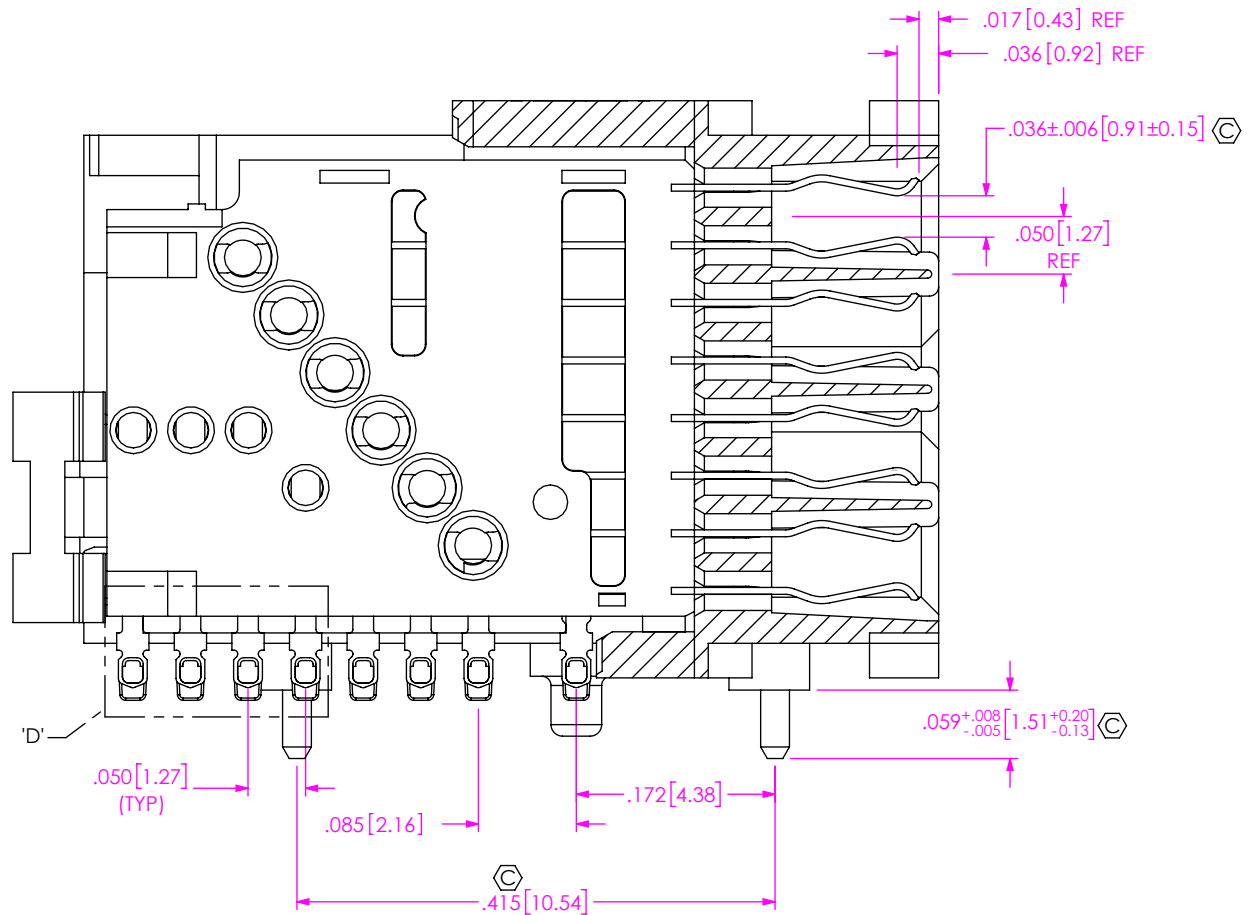
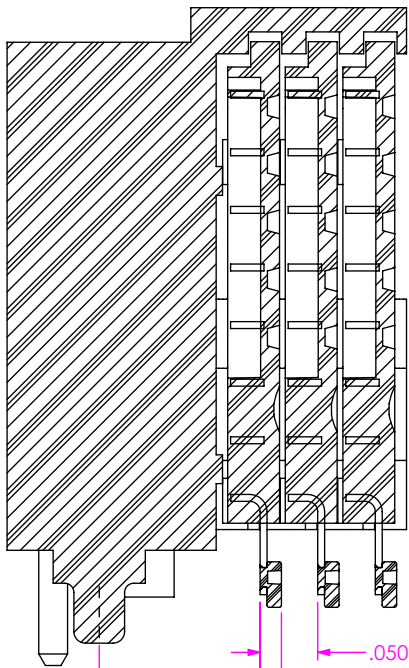
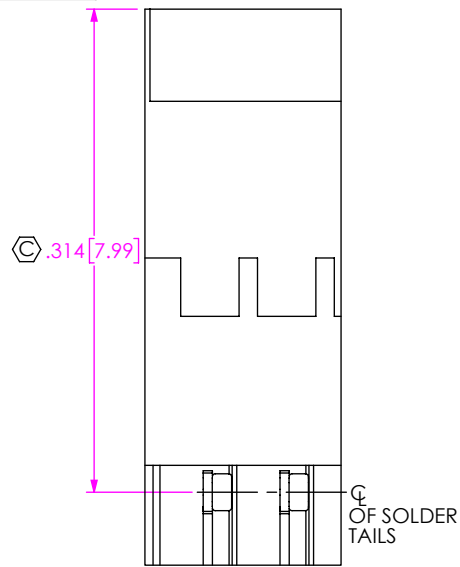

**PROPRIETARY NOTE**  
THIS DOCUMENT CONTAINS CONFIDENTIAL AND PROPRIETARY INFORMATION AND ALL DESIGN, MANUFACTURING, REPRODUCTION, USE, PATENT RIGHTS AND SALES RIGHTS ARE EXPRESSLY RESERVED BY SAMTEC, INC. THIS DOCUMENT SHALL NOT BE DISCLOSED, IN WHOLE OR PART, TO ANY UNAUTHORIZED PERSON OR ENTITY NOR REPRODUCED, TRANSFERRED OR INCORPORATED IN ANY OTHER PROJECT IN ANY MANNER WITHOUT THE EXPRESS WRITTEN CONSENT OF SAMTEC, INC.

DO NOT SCALE DRAWING

SHEET SCALE: 3:2

**samtec**

520 PARK EAST BLVD, NEW ALBANY, IN 47150  
PHONE: 812-944-6733 FAX: 812-948-5047  
e-Mail info@SAMTEC.com code 55322

DESCRIPTION: VITA 74 SEAF-RA (LEAD FREE)

DWG. NO. ASP-161074-04

BY: J. BROWNING 09/22/2021 SHEET 2 OF 3

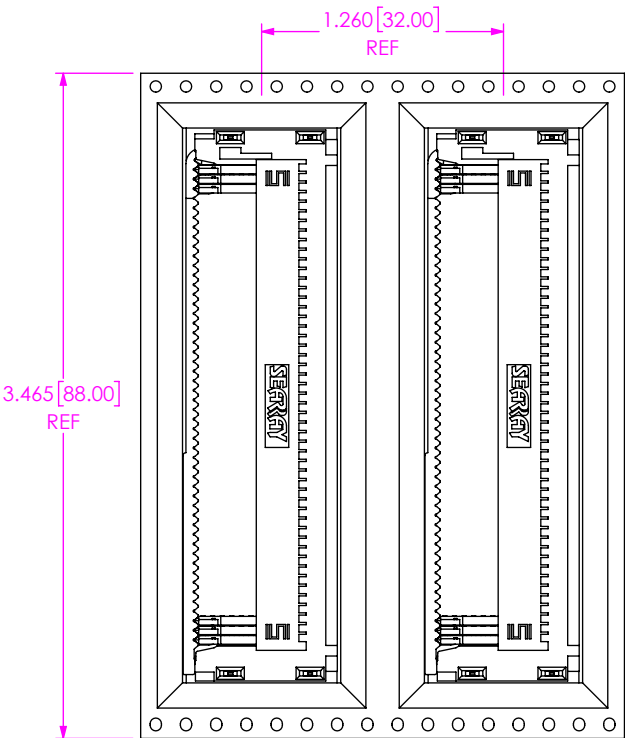

USER DIRECTION OF UN-REELING →  
POCKET NOT DETAILED

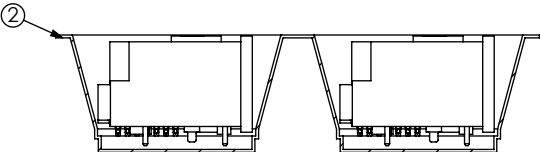

PACKAGING VIEW

PROPRIETARY NOTE

THIS DOCUMENT CONTAINS CONFIDENTIAL AND PROPRIETARY INFORMATION AND ALL DESIGN, MANUFACTURING, REPRODUCTION, USE, PATENT RIGHTS AND SALES RIGHTS ARE EXPRESSLY RESERVED BY SAMTEC, INC. THIS DOCUMENT SHALL NOT BE DISCLOSED, IN WHOLE OR PART, TO ANY UNAUTHORIZED PERSON OR ENTITY NOR REPRODUCED, TRANSFERRED OR INCORPORATED IN ANY OTHER PROJECT IN ANY MANNER WITHOUT THE EXPRESS WRITTEN CONSENT OF SAMTEC, INC.

SHEET SCALE: 1:2



520 PARK EAST BLVD, NEW ALBANY, IN 47150  
PHONE: 812-944-6733 FAX: 812-948-5047  
e-Mail: info@SAMTEC.com code 55322

DESCRIPTION:  
VITA 74 SEAF-RA (LEAD FREE)

DWG. NO.  
ASP-161074-04

BY: J. BROWNING 09/22/2021 SHEET 3 OF 3

# Mouser Electronics

Authorized Distributor

Click to View Pricing, Inventory, Delivery & Lifecycle Information:

[Samtec:](#)

[ASP-161074-04](#)