

16 mm IP68 FIELD TERMINATION KIT

SPECIFICATIONS

For complete specifications and processing guidelines see www.samtec.com?ACRK-16

Terminal Material:

Brass

Contact Material:

Brass/BeCu

Operating Temp Range:

-10 °C to +105 °C

Housing:

-P: Thermoplastic

-M: Zinc Alloy

RoHS Compliant:

Yes

Mates with:

ACP-16, ACPK-16

| CURRENT RATING | | |
|----------------|--|-------------|
| LEAD STYLE | PINS POWERED | CCC per PIN |
| -01 | 14 | 1.3 A |
| -02 | 10 | 2.6 A |
| -06 | 2 (plus 8 signal pins powered @ 1A) | 11.6 A |

For general reference only. See www.samtec.com?ACRK-16 for complete test data or contact AccliMate@samtec.com for applications requiring higher current carrying capacity.

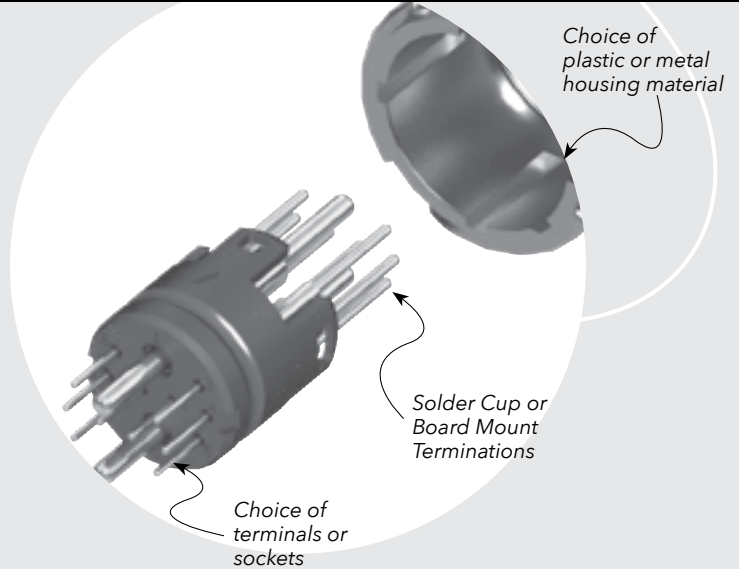

DUST CAPS

- DCA-ACR-16-M-X (Metal)
- DCA-ACR-16-P-X (Plastic)



- Visit sealedio.samtec.com for a complete list of sealed systems

PANEL OPENING

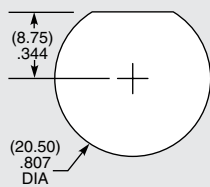

NOTE

For complete specifications and processing guidelines see www.samtec.com?ACRK-16

Note:
Some lengths, styles and options are non-standard, non-returnable.

| ACRK | 16 | LEAD STYLE | PLATING | GENDER | TERMINATION | HOUSING MATERIAL | KEY |
|------|----|--|---|--|---|--|----------------------------|
| | | -01 = 0.5 mm DIA (14) (26-30 AWG) -02 = 1.0 mm DIA (10) (20-24 AWG) -06 = 1.5 mm DIA (2) (14-18 AWG) + 0.5 mm DIA (8) (26-30 AWG) | -G = 10 μ" (0.25 μm) Gold over 50 μ" (1.27 μm) Ni on contact (0.5) .020 DIA (14) | -T = Terminal -S = Socket | -C = Solder Cup -B1 = (1.60 mm) .062" Board Mount (1.0) .040 DIA (10) | -P = Plastic -M = Metal | -1 = Orange, 45° |
| | | | -01 | | | -02 | |
| | | | -B1 END SHOWN | | | -C END SHOWN | -06 |

Mouser Electronics

Authorized Distributor

Click to View Pricing, Inventory, Delivery & Lifecycle Information:

Samtec:

[ACRK-16-02-H-S-C-M-1](#) [ACRK-16-01-G-S-B1-P-1](#) [ACRK-16-01-G-S-C-M-1](#) [ACRK-16-01-G-S-B1-M-1](#) [ACRK-16-01-G-S-C-P-1](#)