

ACCLIMATE™

ACRK-16-02-G-S-B1-P-1

ACRK-16-01-G-T-B1-P-1

ACRK-16-06-G-T-B1-M-1

ACRK-16 SERIES

# 16 mm IP68 FIELD TERMINATION KIT

## SPECIFICATIONS

For complete specifications and processing guidelines see [www.samtec.com?ACRK-16](http://www.samtec.com?ACRK-16)

### Terminal Material:

Brass

### Contact Material:

Brass/BeCu

### Operating Temp Range:

-10 °C to +105 °C

### Housing:

-P: Thermoplastic

-M: Zinc Alloy

### RoHS Compliant:

Yes

### Mates with:

ACP-16, ACPK-16

CURRENT RATING		
LEAD STYLE	PINS POWERED	CCC per PIN
-01	14	1.3 A
-02	10	2.6 A
-06	2 (plus 8 signal pins powered @ 1A)	11.6 A

For general reference only. See [www.samtec.com?ACRK-16](http://www.samtec.com?ACRK-16) for complete test data or contact [AccliMate@samtec.com](mailto:AccliMate@samtec.com) for applications requiring higher current carrying capacity.

## DUST CAPS

- DCA-ACR-16-M-X (Metal)
- DCA-ACR-16-P-X (Plastic)



- Visit [sealedio.samtec.com](http://sealedio.samtec.com) for a complete list of sealed systems

## PANEL OPENING

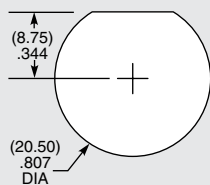

## NOTE

For complete specifications and processing guidelines see [www.samtec.com?ACRK-16](http://www.samtec.com?ACRK-16)

**Note:**  
Some lengths, styles and options are non-standard, non-returnable.

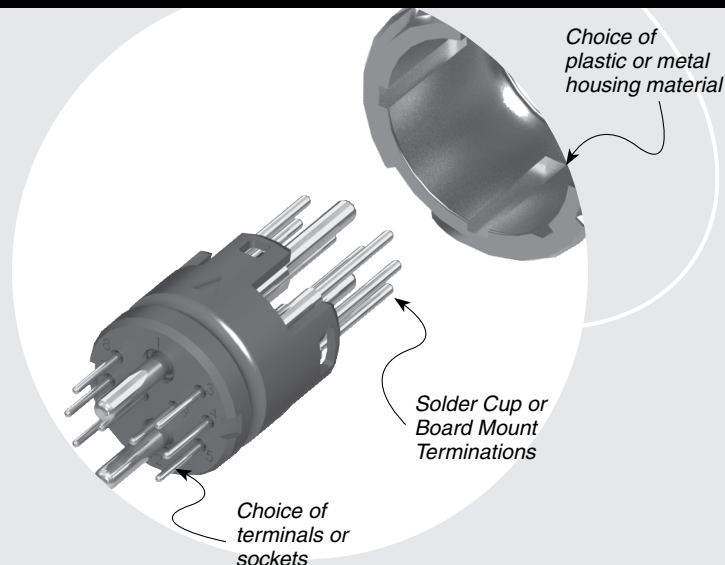

ACRK	16	LEAD STYLE	PLATING	GENDER	TERMINATION	HOUSING MATERIAL	KEY
		<b>-01</b> = 0.5 mm DIA (14) (26-30 AWG)  <b>-02</b> = 1.0 mm DIA (10) (20-24 AWG)  <b>-06</b> = 1.5 mm DIA (2) (14-18 AWG) + 0.5 mm DIA (8) (26-30 AWG)	<b>-G</b> = 10 μ" (0.25 μm) Gold over 50 μ" (1.27 μm) Ni on contact  (0.5) .020 DIA (14)	<b>-T</b> = Terminal  <b>-S</b> = Socket  (1.0) .040 DIA (10)	<b>-C</b> = Solder Cup  <b>-B1</b> = (1.60 mm) .062" Board Mount  (0.5) .020 DIA (8)	<b>-P</b> = Plastic  <b>-M</b> = Metal	<b>-1</b> = Orange, 45°
			 -01			 -02	
			 -B1 END SHOWN			 -C END SHOWN	
						 -06	

# Mouser Electronics

Authorized Distributor

Click to View Pricing, Inventory, Delivery & Lifecycle Information:

Samtec:

[ACRK-16-02-H-S-C-M-1](#) [ACRK-16-01-G-S-B1-P-1](#) [ACRK-16-01-G-S-C-M-1](#) [ACRK-16-01-G-S-B1-M-1](#) [ACRK-16-01-G-S-C-P-1](#)